

STATE OF MAINE
TO
CITY OF PORTLAND
4916/26

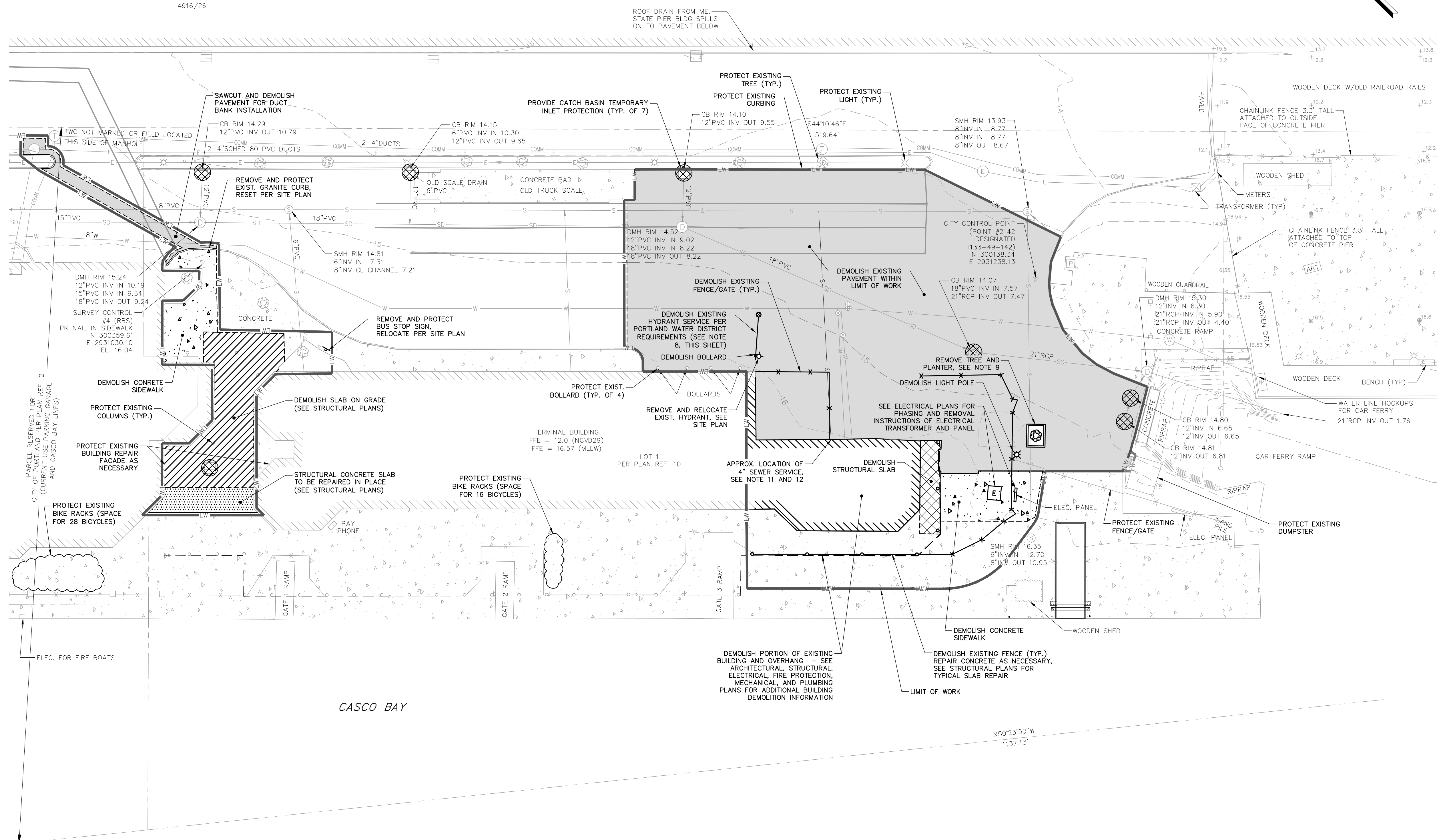

DEMOLITION GENERAL NOTES:

1. THE WORD "DEMOLISH" SHALL MEAN THE REMOVAL AND PROPER DISPOSAL OF AN ITEM.
2. THE UNDERGROUND UTILITIES INFORMATION SHOWN ON THESE PLANS HAVE BEEN COMPILED BY ROYAL RIVER SURVEY OF YARMOUTH, MAINE, FROM FIELD SURVEY INFORMATION AND EXISTING DRAWINGS. THE UTILITY LOCATIONS SHOWN IN PLAN ARE APPROXIMATE AND REQUIRE FIELD VERIFICATION BY THE CONTRACTOR. ALL INVERTS AND PIPE SIZES SHALL BE VERIFIED PRIOR TO CONSTRUCTION. CONTRACTOR SHALL NOTIFY ALL UTILITIES PRIOR TO COMMENCING WORK, ALLOWING SUFFICIENT TIME TO LOCATE AND MARK THE LOCATION OF BURIED UTILITIES. CONTRACTOR SHALL CONTACT "DIG SAFE", TELEPHONE 888-344-7233, PRIOR TO EXCAVATION.
3. CONTRACTOR SHALL MAINTAIN A SECURE WORK SITE, AND SHALL INSTALL AND MAINTAIN SAFETY AND SECURITY MEASURES, SUCH AS FENCING, BARRIERS, SIGNAGE, AND TRAFFIC CONTROL DEVICES, APPROPRIATE SECURITY AND SAFETY MEASURES SHALL BE IN PLACE DURING NON-WORKING HOURS. NO TRENCH SHALL BE LEFT OPEN DURING NON-WORKING HOURS. SITE SAFETY IS THE RESPONSIBILITY OF THE CONTRACTOR, DURING BOTH WORKING AND NON-WORKING HOURS.
4. CONTRACTOR SHALL PROVIDE AND MAINTAIN EROSION AND SEDIMENTATION CONTROL MEASURES, IN ACCORDANCE WITH THESE PLANS AND THE LATEST EDITION OF THE MAINE DEPARTMENT OF ENVIRONMENTAL PROTECTION'S BEST MANAGEMENT PRACTICES MANUAL. KEEP ALL ADJACENT PAVED AREAS FREE OF DUST, MUD AND DEBRIS. STREETS AND WALKWAYS SHALL BE SWEEPED REGULARLY, AND TEMPORARY CONSTRUCTION ENTRANCES SHALL BE UTILIZED DURING CONSTRUCTION.
5. COORDINATE CONSTRUCTION ACTIVITY WITH UTILITY COMPANIES, EMERGENCY SERVICES, CITY AND THE OWNER'S REPRESENTATIVE.
6. PROPERLY PROTECT AND DO NOT DISTURB PROPERTY IRONS AND MONUMENTS NOT INDICATED ON THE DRAWINGS FOR REMOVAL. IF DISTURBED, THE PROPERTY MONUMENT SHALL BE RESET AT THE CONTRACTOR'S EXPENSE, BY A REGISTERED LAND SURVEYOR APPROVED BY THE OWNER. PROPERTY MONUMENTS SHALL BE RESET IN ACCORDANCE WITH CITY OF PORTLAND STANDARDS.
7. EXISTING PAVEMENT SHALL BE REMOVED FROM SITE. PAVEMENT SHALL NOT BE MIXED WITH CONCRETE.
8. DEMOLISH EXISTING HYDRANT AND RETIRE EXISTING HYDRANT SWIVEL PER PORTLAND WATER DISTRICT REQUIREMENTS. REMOVE GATE VALVE AND CAP TEE AT MAIN. NOTIFY PORTLAND FIRE DEPARTMENT PRIOR TO REMOVAL/REPLACEMENT OF HYDRANT.
9. CONTRACTOR SHALL REMOVE GRANITE CURB FROM PLANTER AND DELIVER TO CITY. CONTRACTOR SHALL COORDINATE REMOVAL OF TREE WITH CITY.
10. PRIOR TO ABANDONING OR DEMOLISHING STORMWATER OR SANITARY SEWER LATERAL, THE CONTRACTOR SHALL ACQUIRE A PERMIT FROM THE DEPARTMENT OF PUBLIC SERVICES. THE APPLICANT SHALL PROVIDE A 48 HOUR NOTICE TO THE SEWER MAINTENANCE DIVISION STATING THE DATE AND TIME THAT THE CONTRACTOR WISHES TO COMPLETE THE WORK. ALL WORK TO ABANDON OR DEMOLISH LATERALS SHALL BE DONE IN ACCORDANCE WITH UTILITIES' STANDARDS. CONTRACTOR SHALL BE RESPONSIBLE FOR ALL FEES ASSOCIATED WITH ABANDONMENT OF UTILITY SERVICES.
11. BASE BID: CONTRACTOR SHALL PERFORM TEST PITS AS NECESSARY TO FIELD VERIFY THE LOCATION AND DEPTH OF THE EXISTING SEWER SERVICE. CONTRACTOR SHALL PERFORM TV INSPECTION OF SEWER SERVICE TO DETERMINE SIZE AND CONDITION OF PIPE. CONTRACTOR SHALL PROVIDE RESULTS OF FIELD INSPECTIONS TO ENGINEER FOR VERIFICATION OF DESIGN.
12. ALTERNATE #4: CONTRACTOR SHALL DEMOLISH EXISTING SEWER SERVICE AS NECESSARY AND PROVIDE NEW SEWER SERVICE, 4" PVC WITH WYE CONNECTION AT MAIN. COORDINATE CONNECTION OF NEW SERVICE AND RETIREMENT OF EXISTING SERVICE AS NECESSARY WITH CITY OF PORTLAND PUBLIC SERVICES. SEE PLUMBING PLANS FOR ADDITIONAL WORK WITHIN BUILDING FOOTPRINT.
13. ALL BENCHES, BIKE RACKS, TRASH CANS, AND OTHER MOVABLE SITE APPURTENANCES SHALL BE REMOVED AND DELIVERED TO OWNER.

DEMOLITION LEGEND

EXISTING BUILDING	
SAWCUT PAVEMENT/CONCRETE	
EXISTING WATER SERVICE	
EXISTING FENCE	
EXISTING HYDRANT	
EXISTING GATE VALVE	
EXISTING LIGHT POLE	
EXISTING SIGN	
EXISTING TREE AND PLANTER	
CATCH BASIN INLET PROTECTION	
SLAB ON GRADE DEMOLITION	
STRUCTURAL SLAB DEMOLITION	
STRUCTURAL CONCRETE SLAB REPAIR	
CONCRETE SIDEWALK DEMOLITION	



41 Hutchins Drive
Portland, Maine 04102
800.426.4262
www.woodardcurran.com
COMMITMENT & INTEGRITY DRIVE RESULTS

CASCO BAY FERRY TERMINAL
RENOVATIONS & ADDITIONS
56 COMMERCIAL STREET
PORTLAND, MAINE 04101

FEDERAL PROJECT NO. FBD-1836 (300) X
STATE WIN NO. 18363.10

SEAL: LAUREN JANE SWETT
12284
5/14/2013

THIS DRAWING IS THE PROPERTY OF SCOTT SIMONS ARCHITECTS (SSA) AND IS NOT TO BE COPIED OR REPRODUCED IN PART OR WHOLE.
2013 © SCOTT SIMONS ARCHITECTS, LLC

REVISION:

1	
2	
3	
4	
5	
6	

DATE OF ISSUE: MAY 14, 2013
PROJECT NUMBER: 2011-0270
STATUS: ISSUED FOR BIDDING

DEMOLITION PLAN

C-100

\\PORTLAND\Projects\224974_CBIID-Terminal Renovation\wba\Drawings\20381901-C200A.dwg, May 13, 2013, 8:23am

