

140 MARGINAL WAY

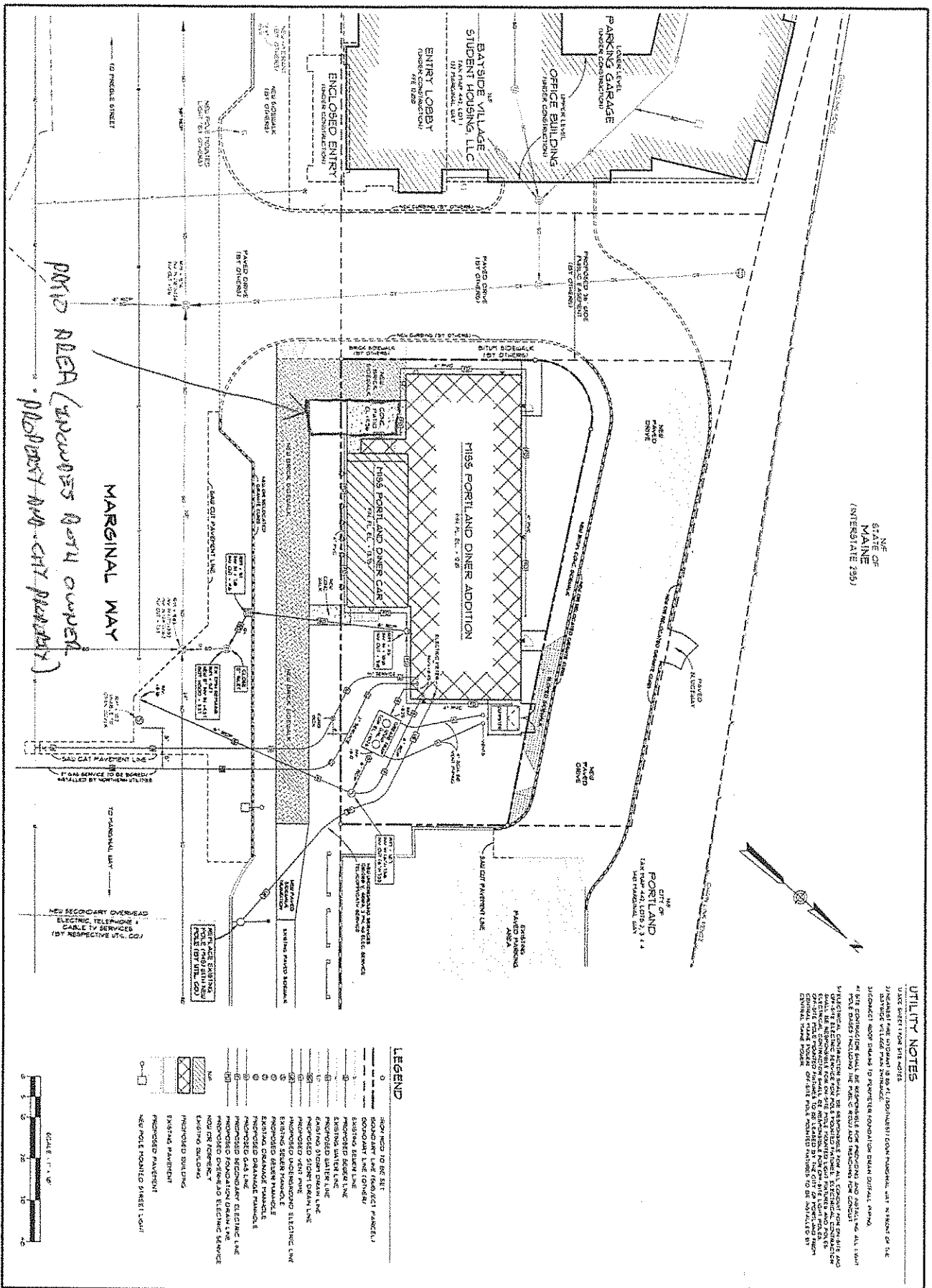

STATE OF MAINE  
(INTERSTATE 1951)

CITY OF PORTLAND  
140 MARGINAL WAY

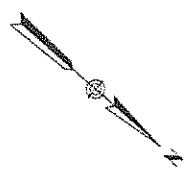

UTILITY NOTES

1. SEE EXISTING SITE ASSES.  
2. EXISTING AND PROPOSED UTILITIES SHOWN FOR INFORMATION ONLY. ALL UTILITIES SHOWN ARE BASED ON RECORD DRAWINGS AND FIELD SURVEY. ALL UTILITIES SHOWN ARE BASED ON RECORD DRAWINGS AND FIELD SURVEY. ALL UTILITIES SHOWN ARE BASED ON RECORD DRAWINGS AND FIELD SURVEY.  
3. ALL UTILITIES SHOWN ARE BASED ON RECORD DRAWINGS AND FIELD SURVEY. ALL UTILITIES SHOWN ARE BASED ON RECORD DRAWINGS AND FIELD SURVEY.  
4. ALL UTILITIES SHOWN ARE BASED ON RECORD DRAWINGS AND FIELD SURVEY. ALL UTILITIES SHOWN ARE BASED ON RECORD DRAWINGS AND FIELD SURVEY.

LEGEND

- 0 HIGH AND TO BE SET
- 1 EXISTING WATER MAIN
- 2 EXISTING SEWER MAIN
- 3 EXISTING WATER MAIN
- 4 EXISTING SEWER MAIN
- 5 EXISTING WATER MAIN
- 6 EXISTING SEWER MAIN
- 7 EXISTING WATER MAIN
- 8 EXISTING SEWER MAIN
- 9 EXISTING WATER MAIN
- 10 EXISTING SEWER MAIN
- 11 EXISTING WATER MAIN
- 12 EXISTING SEWER MAIN
- 13 EXISTING WATER MAIN
- 14 EXISTING SEWER MAIN
- 15 EXISTING WATER MAIN
- 16 EXISTING SEWER MAIN
- 17 EXISTING WATER MAIN
- 18 EXISTING SEWER MAIN
- 19 EXISTING WATER MAIN
- 20 EXISTING SEWER MAIN
- 21 EXISTING WATER MAIN
- 22 EXISTING SEWER MAIN
- 23 EXISTING WATER MAIN
- 24 EXISTING SEWER MAIN
- 25 EXISTING WATER MAIN
- 26 EXISTING SEWER MAIN
- 27 EXISTING WATER MAIN
- 28 EXISTING SEWER MAIN
- 29 EXISTING WATER MAIN
- 30 EXISTING SEWER MAIN
- 31 EXISTING WATER MAIN
- 32 EXISTING SEWER MAIN
- 33 EXISTING WATER MAIN
- 34 EXISTING SEWER MAIN
- 35 EXISTING WATER MAIN
- 36 EXISTING SEWER MAIN
- 37 EXISTING WATER MAIN
- 38 EXISTING SEWER MAIN
- 39 EXISTING WATER MAIN
- 40 EXISTING SEWER MAIN
- 41 EXISTING WATER MAIN
- 42 EXISTING SEWER MAIN
- 43 EXISTING WATER MAIN
- 44 EXISTING SEWER MAIN
- 45 EXISTING WATER MAIN
- 46 EXISTING SEWER MAIN
- 47 EXISTING WATER MAIN
- 48 EXISTING SEWER MAIN
- 49 EXISTING WATER MAIN
- 50 EXISTING SEWER MAIN
- 51 EXISTING WATER MAIN
- 52 EXISTING SEWER MAIN
- 53 EXISTING WATER MAIN
- 54 EXISTING SEWER MAIN
- 55 EXISTING WATER MAIN
- 56 EXISTING SEWER MAIN
- 57 EXISTING WATER MAIN
- 58 EXISTING SEWER MAIN
- 59 EXISTING WATER MAIN
- 60 EXISTING SEWER MAIN
- 61 EXISTING WATER MAIN
- 62 EXISTING SEWER MAIN
- 63 EXISTING WATER MAIN
- 64 EXISTING SEWER MAIN
- 65 EXISTING WATER MAIN
- 66 EXISTING SEWER MAIN
- 67 EXISTING WATER MAIN
- 68 EXISTING SEWER MAIN
- 69 EXISTING WATER MAIN
- 70 EXISTING SEWER MAIN
- 71 EXISTING WATER MAIN
- 72 EXISTING SEWER MAIN
- 73 EXISTING WATER MAIN
- 74 EXISTING SEWER MAIN
- 75 EXISTING WATER MAIN
- 76 EXISTING SEWER MAIN
- 77 EXISTING WATER MAIN
- 78 EXISTING SEWER MAIN
- 79 EXISTING WATER MAIN
- 80 EXISTING SEWER MAIN
- 81 EXISTING WATER MAIN
- 82 EXISTING SEWER MAIN
- 83 EXISTING WATER MAIN
- 84 EXISTING SEWER MAIN
- 85 EXISTING WATER MAIN
- 86 EXISTING SEWER MAIN
- 87 EXISTING WATER MAIN
- 88 EXISTING SEWER MAIN
- 89 EXISTING WATER MAIN
- 90 EXISTING SEWER MAIN
- 91 EXISTING WATER MAIN
- 92 EXISTING SEWER MAIN
- 93 EXISTING WATER MAIN
- 94 EXISTING SEWER MAIN
- 95 EXISTING WATER MAIN
- 96 EXISTING SEWER MAIN
- 97 EXISTING WATER MAIN
- 98 EXISTING SEWER MAIN
- 99 EXISTING WATER MAIN
- 100 EXISTING SEWER MAIN



**UTILITY PLAN**  
**MISS PORTLAND DINER**  
 MARGINAL WAY - PORTLAND, MAINE  
 PREPARED FOR  
**TOHAKS, LLC**  
 6 AMOR DRIVE, FARMING, NJ 07430

**SJR ENGINEERING, INC.**  
 21 HAYFLOWER ROAD  
 AUGUSTA, MAINE 04330  
 (207) 627-1616 Tel 4 Fax  
 11666617@eng.com

1	REV	2-28-08	REMOVE SITE LIGHTING AND SIGNAL NOTES
2	REV	3-10-08	CHANGED LOOP DRIVE TO 14" WIDE
3	REV	3-10-08	REVISIONS PER CITY REVIEW
4	REV	3-10-08	REVISIONS PER ARCHITECT'S REVIEW
5	REV	3-10-08	SUBMITTED TO ARCHITECT FOR REVIEW
6	REV	3-10-08	CHANGES

THIS PLAN SHALL NOT BE MODIFIED WITHOUT WRITTEN PERMISSION FROM SJR ENGINEERING, INC.

