

140 MARGINAL WAY

NF
STATE OF
(INTERSTATE 285)

UTILITY PLAN

MISS PORTLAND DINER
TOMPKS, LLC
140 MARGINAL WAY - PORTLAND, MAINE
PROJECT NO. 140-01

LEGEND

- IRON ROD TO BE SET
- BOUNDARY LINE (OTHER)
- EXISTING SEWER LINE
- EXISTING WATER LINE
- PROPOSED WATER LINE
- PROPOSED 6" PORT DRAIN LINE
- EXISTING SEWER MANHOLE
- PROPOSED UNDERGROUND ELECTRIC LINE
- EXISTING SEWER MANHOLE
- PROPOSED DRAINAGE MANHOLE
- PROPOSED SECONDARY ELECTRIC LINE
- PROPOSED FOUNDATION DRAIN LINE
- EXISTING UNDERGROUND ELECTRIC SERVICE
- EXISTING BUILDING
- PROPOSED PAVERMENT
- NEW POLE MOUNTED STREET LIGHT

UTILITY NOTES

1. USE SHEET 1 FOR FIRE WATER.
2. CONTRACTOR SHALL BE RESPONSIBLE FOR PROVIDING AND INSTALLING ALL LIGHT FIXTURES AND LIGHTING FIXTURES.
3. CONTRACTOR SHALL BE RESPONSIBLE FOR PROVIDING AND INSTALLING ALL LIGHT FIXTURES AND LIGHTING FIXTURES.
4. CONTRACTOR SHALL BE RESPONSIBLE FOR PROVIDING AND INSTALLING ALL LIGHT FIXTURES AND LIGHTING FIXTURES.
5. CONTRACTOR SHALL BE RESPONSIBLE FOR PROVIDING AND INSTALLING ALL LIGHT FIXTURES AND LIGHTING FIXTURES.
6. CONTRACTOR SHALL BE RESPONSIBLE FOR PROVIDING AND INSTALLING ALL LIGHT FIXTURES AND LIGHTING FIXTURES.
7. CONTRACTOR SHALL BE RESPONSIBLE FOR PROVIDING AND INSTALLING ALL LIGHT FIXTURES AND LIGHTING FIXTURES.
8. CONTRACTOR SHALL BE RESPONSIBLE FOR PROVIDING AND INSTALLING ALL LIGHT FIXTURES AND LIGHTING FIXTURES.
9. CONTRACTOR SHALL BE RESPONSIBLE FOR PROVIDING AND INSTALLING ALL LIGHT FIXTURES AND LIGHTING FIXTURES.
10. CONTRACTOR SHALL BE RESPONSIBLE FOR PROVIDING AND INSTALLING ALL LIGHT FIXTURES AND LIGHTING FIXTURES.

REVISIONS

NO.	DATE	DESCRIPTION
1	11-15-13	ISSUED FOR PERMIT
2	11-15-13	ISSUED FOR PERMIT
3	11-15-13	ISSUED FOR PERMIT
4	11-15-13	ISSUED FOR PERMIT
5	11-15-13	ISSUED FOR PERMIT

SCALE: 1" = 10'

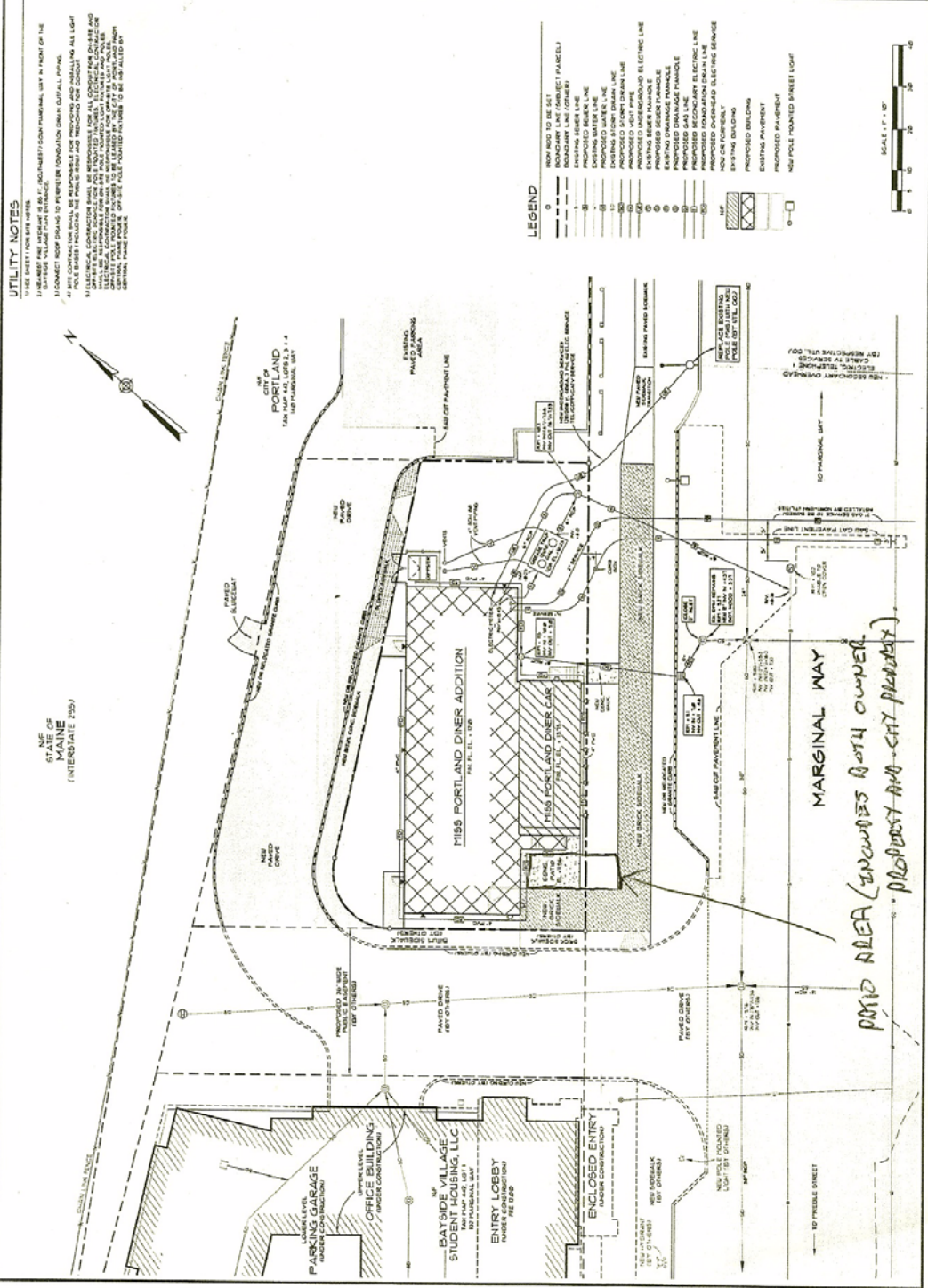

Paved Area (enclosed by both owner - properties and city property)