

- NOTES:
1. REFER TO SHEET NO. 12 EROSION & SEDIMENTATION CONTROL DETAILS FOR ADDITIONAL INFORMATION.
 2. CONTRACTOR SHALL SWEEP AND MAINTAIN MARGINAL WAY FREE OF DUST AND DEBRIS AS REQUIRED DURING CONSTRUCTION.
 3. CONTRACTOR SHALL INSTALL & MAINTAIN A STABILIZED CONSTRUCTION ENTRANCE FROM MARGINAL WAY ONTO THE SITE IF BECOMES EVIDENT DURING CONSTRUCTION THAT EXCESSIVE OFFTRACKING OF DEBRIS AND DIRT IS OCCURRING AT THE EXISTING SITE ENTRANCE.

Prepared For:
Applicant:
SOUTHERN MAINE STUDENT HOUSING, LLC
 247 Commercial Street
 Rockport, Maine 04856
 Tel: (207) 236-4067

Prepared By:
MITCHELL & ASSOCIATES
 Landscape Architects
 The Staples School
 70 Center Street
 Portland, Maine 04101
 Tel: (207) 774-4427

GP Gorrill-Palmer
 Consulting Engineers, Inc.
 Traffic and Civil Engineering Services
 15 Shaker Road
 Gray, ME 04039
 207-657-6910
 FAX: 207-657-6912

BAYSIDE VILLAGE
A STUDENT HOUSING COMPLEX
120 Marginal Way
Portland, Maine

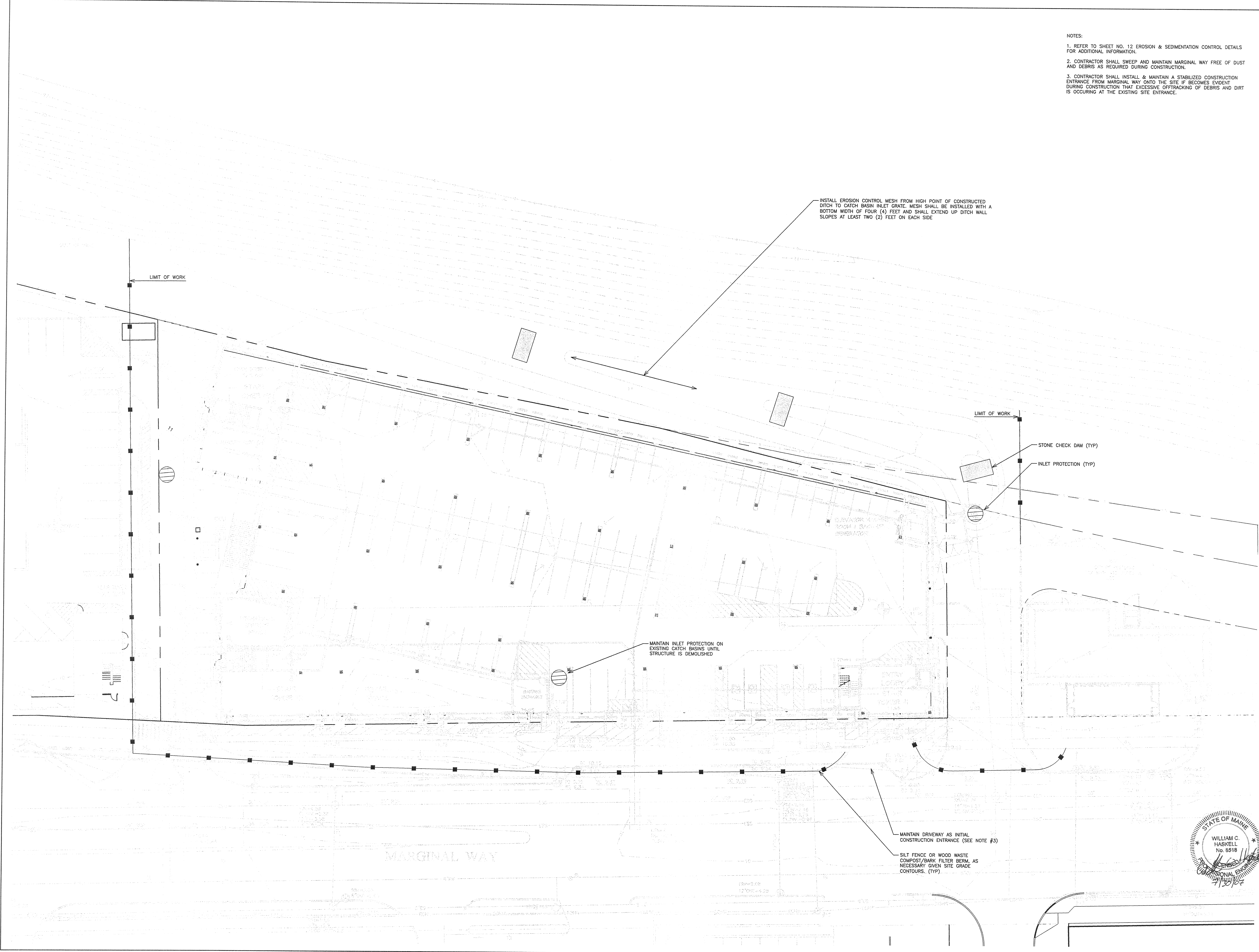

Date:
 JUNE 15, 2007

Issued For:
 CONSTRUCTION

Revisions:
 JUNE 26, 2007 - REVISED UTILITY AND ROOF DRAINAGE
 JULY 17, 2007 - CONSTRUCTION DRAWINGS

Reproduction or reuse of this document without the expressed written consent of Mitchell & Associates is prohibited.

Title:
 EROSION AND SEDIMENTATION CONTROL PLAN

Scale: 1"=20'
 0 10 20 40 ft.

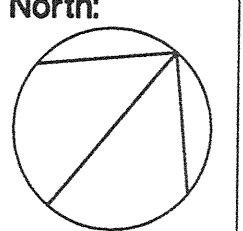
North: 
Sheet No.:
6

