

**LEGEND**

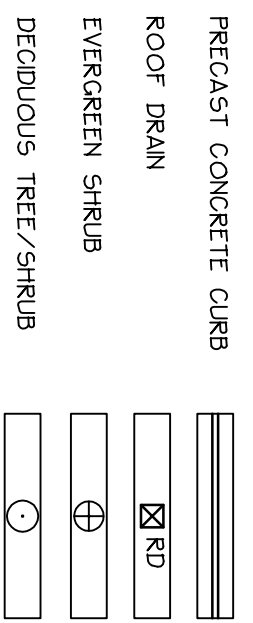

**PLANT LIST - ROOF DECK**

KEY	QTY	BOTANICAL NAME	COMMON NAME	SIZE
TREES				
1	2	ACER GINNALA 'FLAME'	FLAME ASH MAPLE	6' GLIMP
2	5	PAULS 'PROFUSION'	PROFUSION FLOWERING CRAB	1 1/2" CAL
3	4	RNUS DENSI 'ORA'	WEeping PINE	#6
4	3	PRUNUS FABRIE 'WESTWOOD'	KOREAN SUNK PEAR	6'-8"
SHRUBS				
1	4	CORNUS SERICEA 'FARROW'	FARROW RED TING DOGWOOD	#3
2	6	FOTHEUCOIL 'CARPENT'	DIAMER BOTTLEBRUSH	#3
3	12	LUNIFERIUS 'COREN CARPET'	GREEN CARPET JUNIFER	#2
4	11	POTENTILLA FRUTICOSA 'ABBOTTSWOOD'	ABBOTTSWOOD POTENTILLA	#2
5	6	RNUS STYVESTRIS 'HILLSIDE CREPPER'	HILLSIDE CREPPER PINE	#2
6	15	RHODODENDRON 'WINDLEAM'	WINDLEAM RHODODENDRON	#2
7	18	SPRAEA X BIMALDA 'NEON FLASH'	NEON FLASH SPRAEA	#5
8	2	VIKORUN X BURWOODII 'MOHAWK'	MOHAWK VIKORUN	#5
PERENNIALS AND GRASSES				
1	125	AQUILEGIA CANADENSIS	CANADIAN COLUMBINE	4" POT
2	175	AURNIA SAKATILIS 'COMPACTUM'	BAKSET OF GOLD	4" POT
3	125	ARBERIA MARITIMA 'PINK LUSTRANCA'	SEA THRIFT	4" POT
4	124	ALLUM 'SCHOENORALUM'	CHIVE	4" POT
5	50	ARCHTOSTAPHYLOS 'LIVA URESI'	BEARBERRY	-
6	15	DIANTHUS 'ALPINEUS'	ALPINE PINKS	-
7	24	DIANTHUS 'DELTOIDES 'BRILLIANT'	MADEN PINKS	-
8	45	HEMOCOCALUS 'RUBY STELLA'	RUBY STELLA DAVILY	-
9	40	HEMOCOCALUS 'STELLA D'ORO'	STELLA D'ORO DAVILY	-
10	50	LAVENDULA 'ANGUSTIFOLIA 'HIDCOLE SUPERIOR'	LAVENDER	-
11	50	LAVENDULA 'ANGUSTIFOLIA 'SARTINE'	CREPPING LAVIOPF	-
12	150	LIROPE 'SICCANIA'	LIROPE	-
13	15	RUBECOLA	CONFLOWER	-
14	100	SALVIA 'PRATENSIS 'EVELINE'	SAGE	-
15	75	SALVIA 'PRATENSIS 'PINK DELIGHT'	FRUCTION FLOWER	-
16	15	SCABIOSA 'COLUMBARIA 'BUTTERFLY BLUE'	DRAGON'S BLOOD STONECROP	-
17	100	SEDUM 'ALBUM 'CORAL CARPET'	STONECROP	-
18	150	SEDUM 'DRAGON'S BLOOD'	DRAGON'S BLOOD STONECROP	-
19	30	SEDIUM 'KATISCHATIUM 'WIENHOFSTEHANER GOLD'	STONECROP	-
20	150	SEDIUM 'INDICORIFOLIUM 'DIFRUSUM'	STONECROP	-
21	30	VERONICA 'PROSTRATA 'AZTEC GOLD'	AZTEC GOLD SPEEDWELL	-
22	195	VERONICA 'PROSTRATA 'AZTEC GOLD'	AZTEC GOLD SPEEDWELL	-
23	176	FANCIUM 'ANARUM 'DEWEY BLUE'	DEWEY BLUE SWITCHGRASS	4" POT

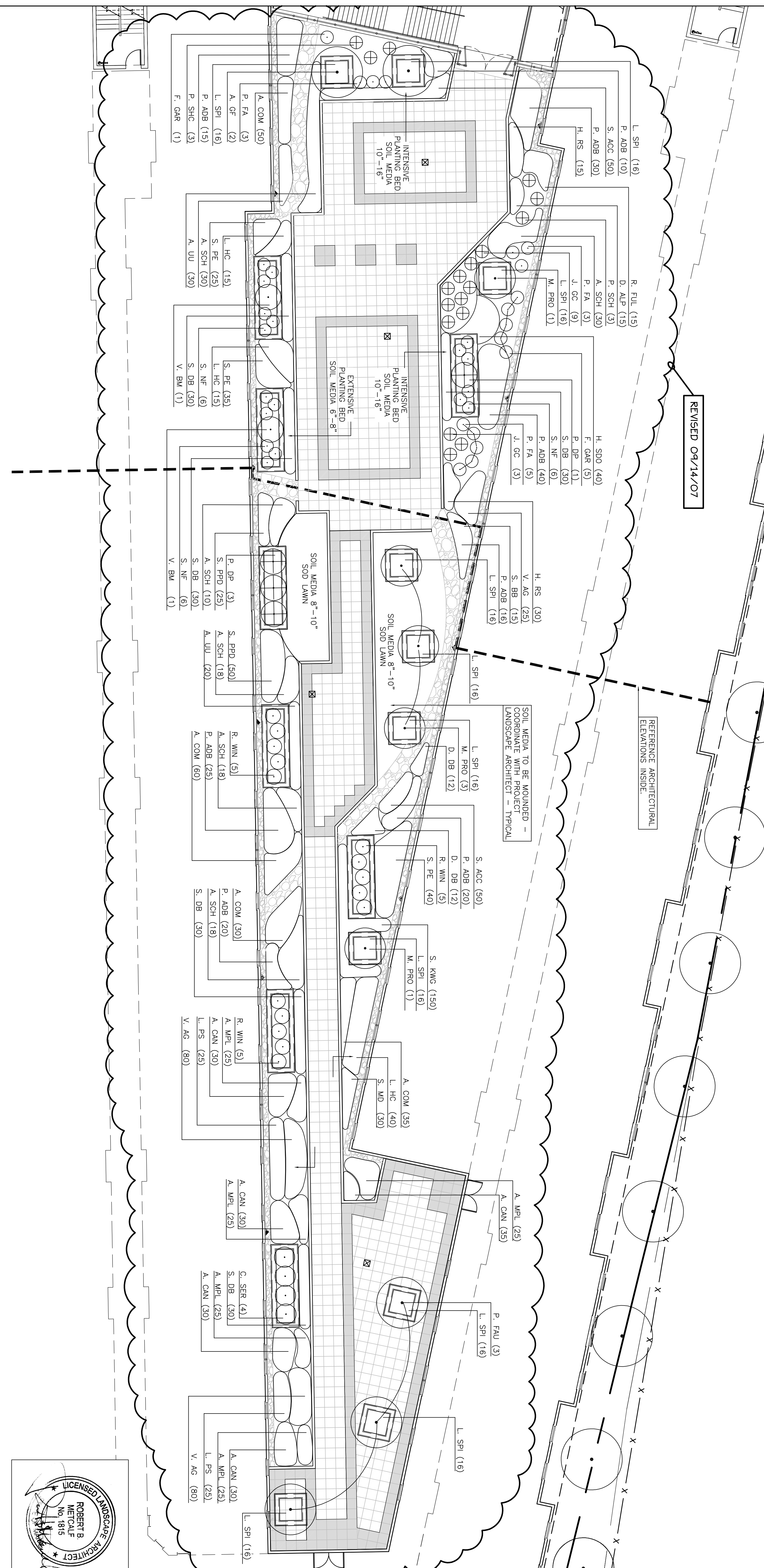

# BAYSIDE VILLAGE

## A STUDENT HOUSING COMPLEX

132 Marginal Way Portland, Maine

**Prepared For:**  
SOUTHERN MAINE STUDENT  
LANDSCAPE ARCHITECTS  
247 Commercial Street  
Rockport, Maine 04856  
Tel: (207) 298-4087

**Prepared By:**  
MITCHELL & ASSOCIATES  
Landscape Architects  
70 Center Street  
Portland, Maine 04101  
Tel: (207) 774-4427

**GP**  
Gorjill-Palmier  
Consulting Engineers, Inc.  
15 Shaker Road  
Orono, ME 04469  
207-687-8990  
Fax: 207-687-8812

**pizzagalli**  
LANDSCAPE ARCHITECTS

**Date:** AUGUST 15, 2007

**Issued For:** CONSTRUCTION

**Revisions:**  
August 30, 2007 - Revised and Issued for Pricing  
September 14, 2007 - Revised and Issued for Construction

Reproduction or reuse of this document without the written consent of Mitchell & Associates is prohibited.

**Title:** COURTYARD PLANTING PLAN

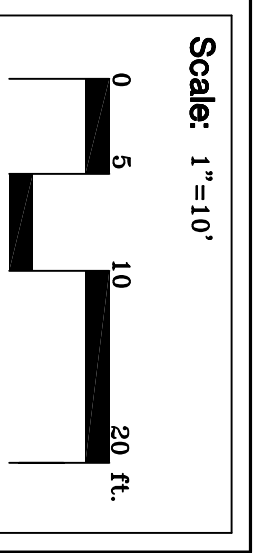

**North:**

**Sheet No.:** 5a

