

NOTE:

- SEE SHEET E-001 FOR LEGEND AND GENERAL NOTES.

ESB
E.S. BOULOS CO
 ELECTRICAL CONTRACTORS

45 BRADLEY DRIVE
 WESTBROOK, ME 04092
 TEL: (207) 464-3706
 FAX: (207) 464-1833

SM
RT

ARCHITECTURE ENGINEERING PLANNING

SWRT
 144 Fore Street/P.O. Box 618
 Portland, Maine 04104
 tel. (207) 772-3846
 fax. (207) 772-1070

KEYED NOTE:

- SEE SHEET EL101A FOR LOCATION OF SECOND THREE WAY SWITCH.

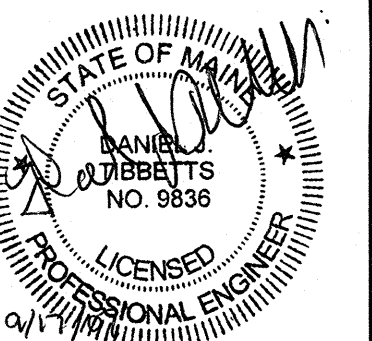
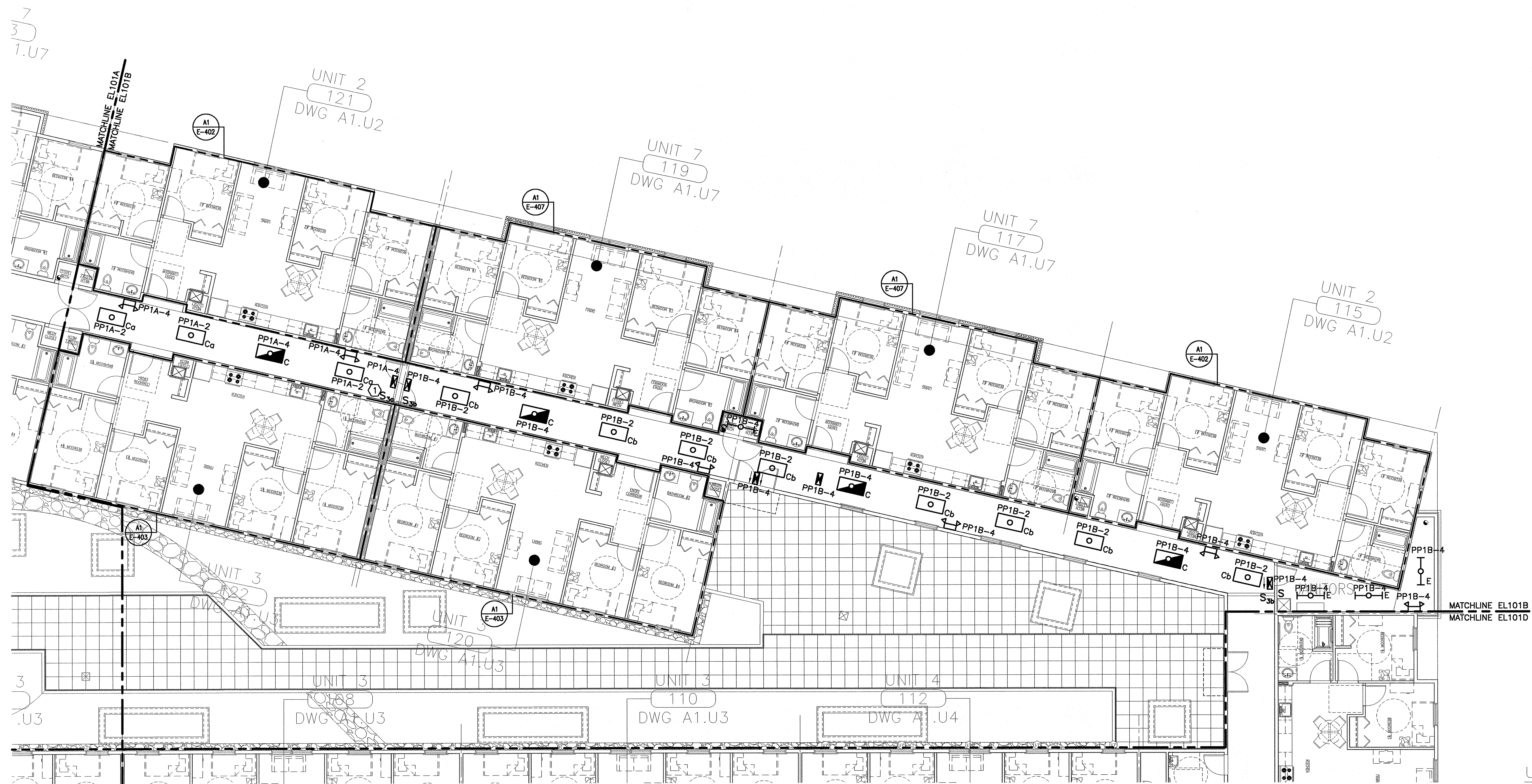

BAYSIDE VILLAGE
STUDENT HOUSING COMPLEX
 PORTLAND, ME

PROJECT TITLE:
 CURRENT ISSUE STATUS:

REV	DESCRIPTION	DATE
0	ISSUED FOR CONSTRUCTION	9-14-07

GRAPHIC SCALE:
 0" 1"
 SCALE: 1/8"=1'-0"
 PROJECT MANAGER: DJT
 JC/DRAWN BY: CDS
 A/E OF RECORD: DJT
 CAD FILE: EL101B-07125
 PROJECT NO: 07125
 DATE: 9-14-07

SHEET TITLE:
FIRST FLOOR LIGHTING PLAN B

SHEET No.
EL101B

A1 FIRST FLOOR PLAN

1/8"=1'-0"