

**1 REFLECTED CEILING LEGEND**  
 REFERENCED FROM: SCALE: 1/4" = 1'-0"

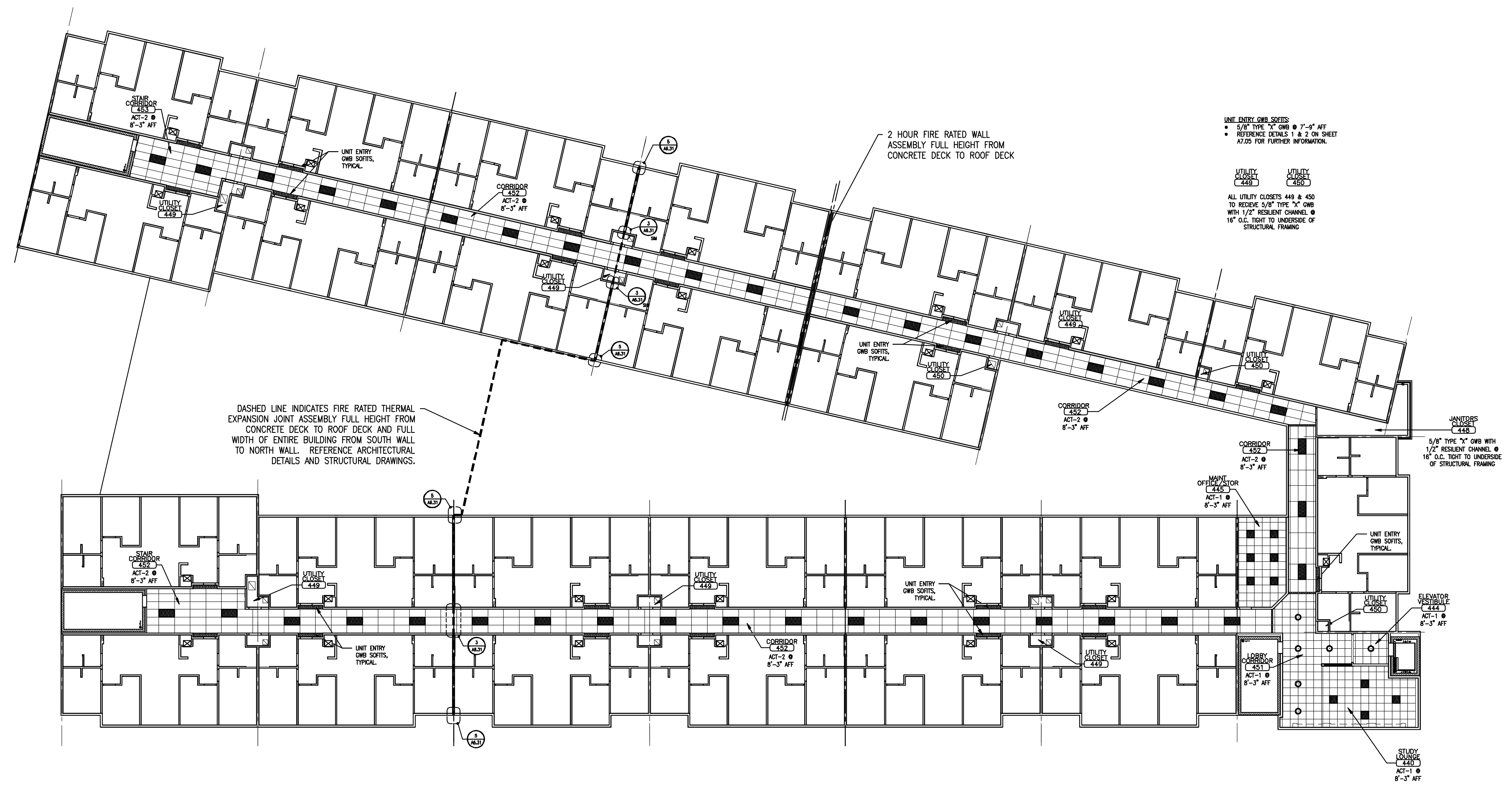

**A OVERALL REFLECTED CEILING PLAN - FOURTH FLOOR**  
 REFERENCED FROM: SCALE: 1/16" = 1'-0"

**CWS Architects**  
 Architecture  
 Space Planning  
 Value Design  
 434 Cumberland Avenue  
 Portland, ME 04101  
 Phone: (207) 774-4441  
 Fax: (207) 774-4016  
 www.CWSArch.com



Owner: **SOUTHERN MAINE STUDENT HOUSING LLC**  
 247 COMMERCIAL STREET  
 ROCKPORT, MAINE 04856  
 TEL: (207) 236-4067

Contractor: **PIZZAGALLI CONSTRUCTION**  
 131 PRESUMPSCOT STREET  
 PORTLAND, ME 04103  
 TEL: (207) 874-2323  
 FAX: (207) 874-2727

**BAYSIDE VILLAGE - A STUDENT HOUSING COMPLEX**  
 132 MARGINAL WAY  
 PORTLAND, MAINE

Project No: 2006-432-BVP

Drawing Title:  
**OVERALL REFLECTED CEILING PLAN - FOURTH FLOOR**

Scale: 1/16" = 1'-0"  
 Date: SEPTEMBER 14, 2007

- Revisions:
- △
  - △
  - △
  - △
  - △
  - △

Drawing Number:  
**A2.40**