

C

ENLARGED PLAN - FOURTH FLOOR - AREA C

REFERENCED FROM: SCALE: 1/4" = 1'-0"

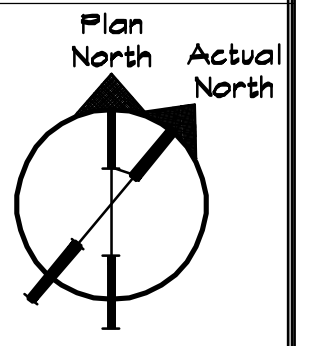
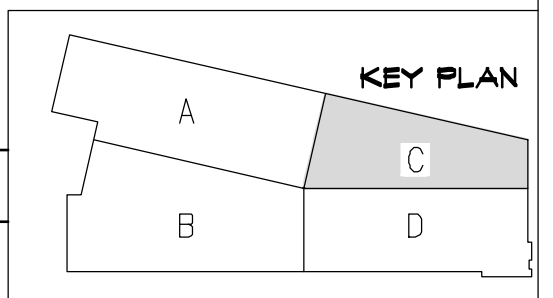

CWS Architects
 Architecture
 Space Planning
 Value Design
 434 Cumberland Avenue
 Portland, ME 04101
 Phone: (207) 774-4441
 Fax: (207) 774-4016
 www.CWSarch.com



Owner: **SOUTHERN MAINE STUDENT HOUSING LLC**
 247 COMMERCIAL STREET
 ROCKPORT, MAINE 04856
 TEL: (207) 236-4067
 Contractor: **PIZZAGALLI CONSTRUCTION**
 131 PRESUMPSCOT STREET
 PORTLAND, ME 04103
 TEL: (207) 874-2323
 FAX: (207) 874-2727

BAYSIDE VILLAGE - A STUDENT HOUSING COMPLEX
 132 MARGINAL WAY
 PORTLAND, MAINE

Project No: 2006-432BVP

Drawing Title: **ENLARGED PLAN - FOURTH FLOOR - AREA C**

Scale: 1/8" = 1'-0"
 Date: SEPTEMBER 14, 2007

- Revisions:
- △
 - △
 - △
 - △
 - △
 - △

Drawing Number:

A1.43

ISSUED FOR CONSTRUCTION