



CWS Architects

Architecture  
Space Planning  
Value Design

434 Cumberland Avenue  
Portland, ME 04101  
Phone: (207) 774-4441  
Fax: (207) 774-4016

www.CWSarch.com

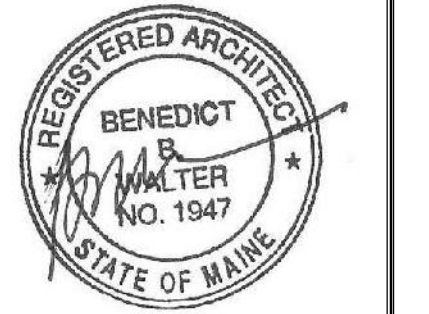

Owner:  
**SOUTHERN MAINE STUDENT HOUSING LLC**  
247 COMMERCIAL STREET  
ROCKPORT, MAINE 04856  
TEL: (207) 236-4067

Contractor:  
**PIZZAGALLI CONSTRUCTION**  
131 PRESUMPSCOT STREET  
PORTLAND, ME 04103  
TEL: (207) 874-2323  
FAX: (207) 874-2727

**BAYSIDE VILLAGE - A STUDENT HOUSING COMPLEX**

132 MARGINAL WAY  
PORTLAND, MAINE

Project No: 2006-432/BVP

Drawing Title:  
**ENLARGED PLAN - SECOND FLOOR - AREA C**

Scale: 1/8" = 1'-0"

Date: SEPTEMBER 14, 2007

Revisions:

- △
- △
- △
- △
- △

Drawing Number:

**A1.23**



**C** ENLARGED PLAN - SECOND FLOOR - AREA C  
REFERENCED FROM: SCALE: 1/4" = 1'-0"

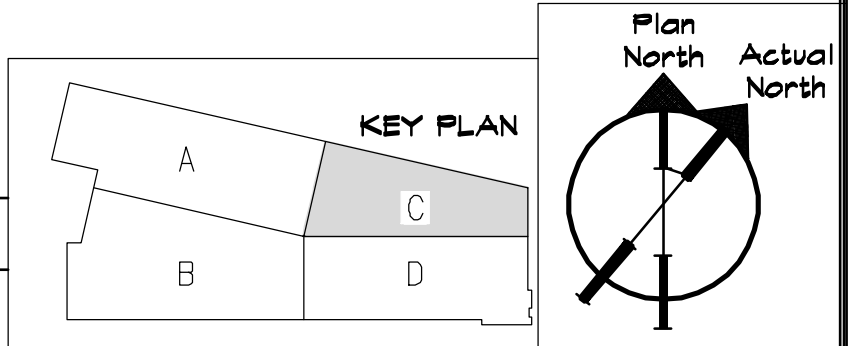

ISSUED FOR CONSTRUCTION