

DASHED LINE INDICATES FIRE RATED THERMAL EXPANSION JOINT ASSEMBLY FULL HEIGHT FROM CONCRETE DECK TO ROOF DECK AND FULL WIDTH OF ENTIRE BUILDING FROM SOUTH WALL TO NORTH WALL. REFERENCE ARCHITECTURAL DETAILS AND STRUCTURAL DRAWINGS.

A ENLARGED PLAN - SECOND FLOOR AREA A
 REFERENCED FROM: SCALE: 1/8" = 1'-0"

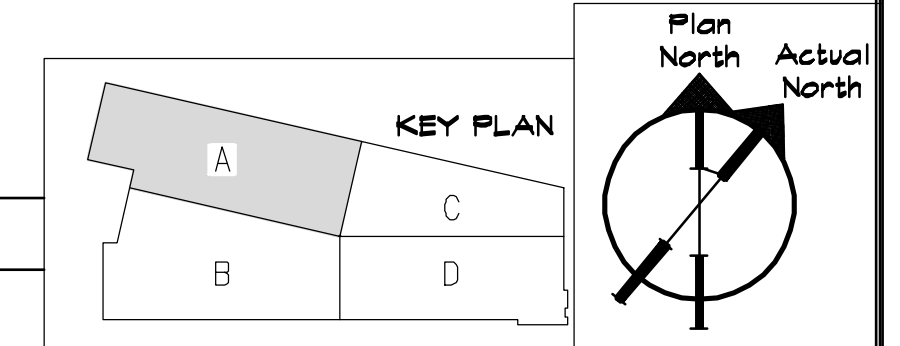

CWS
CWS Architects
 Architecture
 Space Planning
 Value Design
 434 Cumberland Avenue
 Portland, ME 04101
 Phone: (207) 774-4441
 Fax: (207) 774-4016
 www.CWSarch.com

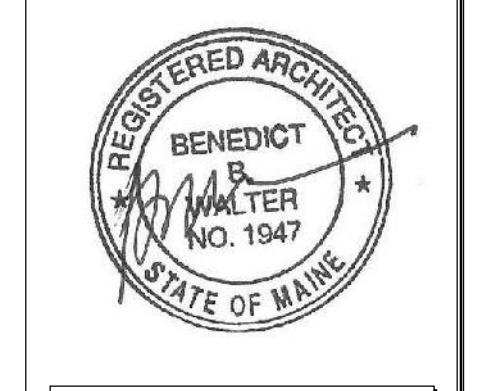

Owner: **SOUTHERN MAINE STUDENT HOUSING LLC**
 247 COMMERCIAL STREET
 ROCKPORT, MAINE 04856
 TEL: (207) 236-4067

Contractor: **PIZZAGALLI CONSTRUCTION**
 131 PRESUMPSCOT STREET
 PORTLAND, ME 04103
 TEL: (207) 874-2323
 FAX: (207) 874-2727

BAYSIDE VILLAGE - A STUDENT HOUSING COMPLEX
 132 MARGINAL WAY
 PORTLAND, MAINE

Project No: 2006-432.BVP
 Drawing Title: **ENLARGED PLAN - SECOND FLOOR - AREA A**

Scale: 1/8" = 1'-0"
 Date: SEPTEMBER 14, 2007
 Revisions:

- △
- △
- △
- △
- △

Drawing Number: **A1.21**