

Owner: **SOUTHERN MAINE STUDENT HOUSING LLC**
247 COMMERCIAL STREET
ROCKPORT, MAINE 04856
TEL: (207) 236-4067

Contractor: **PIZZAGALLI CONSTRUCTION**
131 PRESUMPSCOT STREET
PORTLAND, ME 04103
TEL: (207) 874-2323
FAX: (207) 874-2727

BAYSIDE VILLAGE - A STUDENT HOUSING COMPLEX

132 MARGINAL WAY
PORTLAND, MAINE

Project No: 2006-432/BVP

Drawing Title:
ENLARGED PLAN - FIRST FLOOR - AREA B

Scale: 1/8" = 1'-0"
Date: SEPTEMBER 14, 2007

Revisions:

- △
- △
- △
- △
- △

Drawing Number:

A1.12

Plan North
Actual North

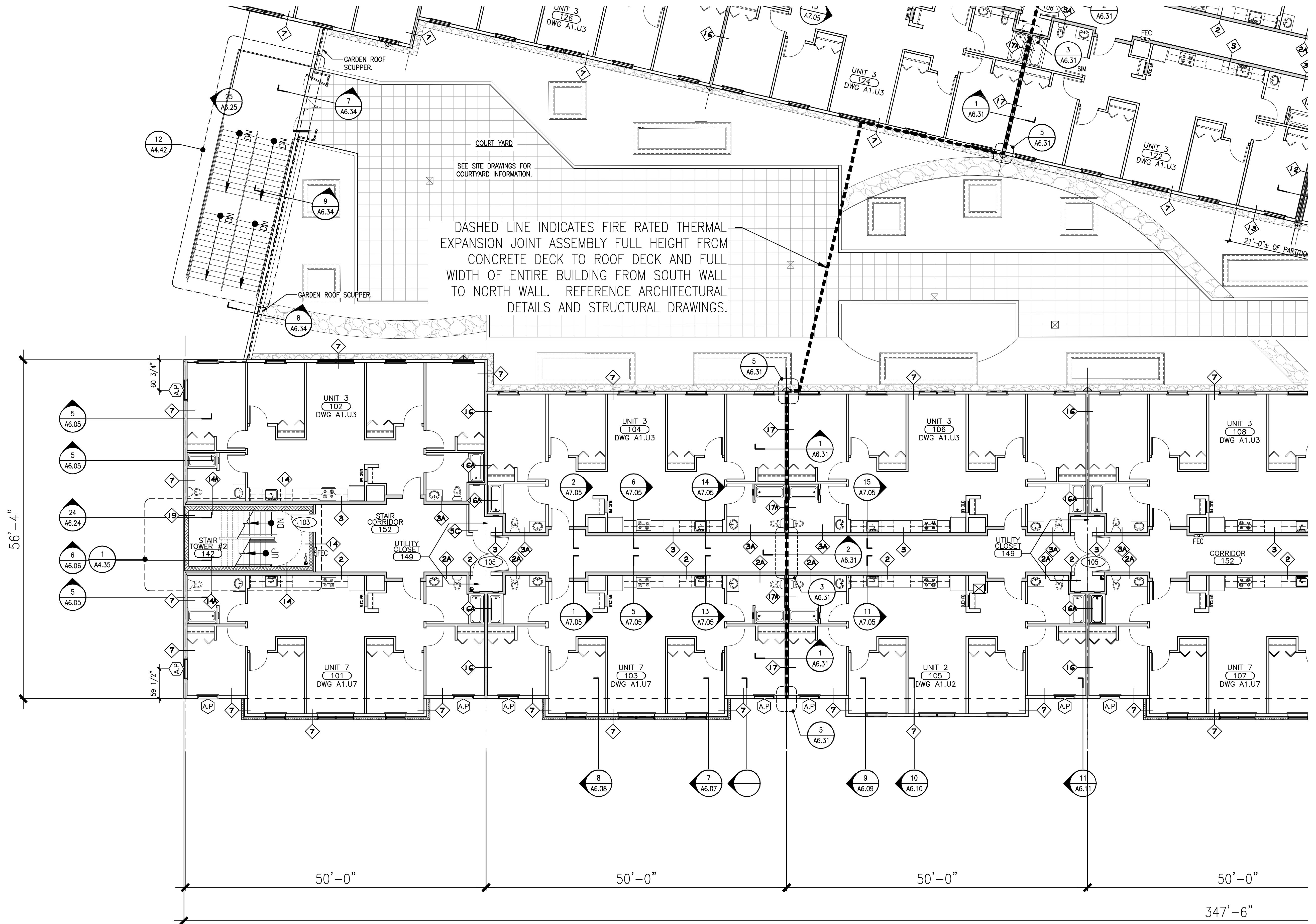
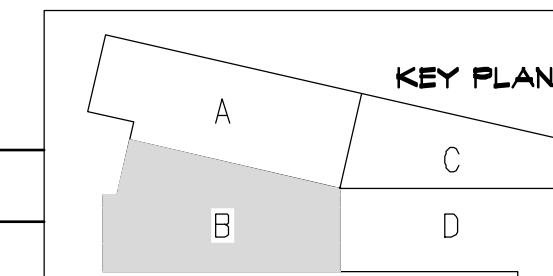
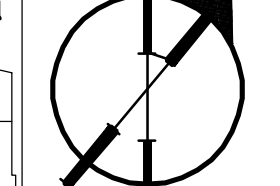

DASHED LINE INDICATES FIRE RATED THERMAL EXPANSION JOINT ASSEMBLY FULL HEIGHT FROM CONCRETE DECK TO ROOF DECK AND FULL WIDTH OF ENTIRE BUILDING FROM SOUTH WALL TO NORTH WALL. REFERENCE ARCHITECTURAL DETAILS AND STRUCTURAL DRAWINGS.

B ENLARGED PLAN - FIRST FLOOR - AREA B
REFERENCED FROM: SCALE: 1/8" = 1'-0"