

This page contains a detailed description of the Parcel ID you selected. Press the **New Search** button at the bottom of the screen to submit a new query.

Current Owner Information

Card Number 1 of 1

Parcel ID 439 D013001

Location 1206 WASHINGTON AVE

Land Use SINGLE FAMILY

Owner Address VACHON ERICA & TODD JTS
1206 WASHINGTON AVE
PORTLAND ME 04103

Book/Page 14258/260

Legal 439-D-13
WASHINGTON 1204-1206

5707 SF

Current Assessed Valuation

Land	Building	Total
\$64,000	\$122,100	\$186,100

Property Information

Year Built	Style	Story Height	Sq. Ft.	Total Acres	Bedrooms	Full Baths	Half Baths	Total Rooms	Attic	Basement
1927	Old Style	2	1504	0.131	3	2		7	None	Full

Outbuildings

Type	Quantity	Year Built	Size	Grade	Condition
GARAGE-WD/CB	1	1927	18X22	C	A

Sales Information

Date	Type	Price	Book/Page
10/30/1998	LAND + BLDING	\$92,500	14258-260
05/16/1992	LAND + BLDING		10138-042

Picture and Sketch

[Picture](#) [Sketch](#) [Tax Map](#)

[Click here](#) to view Tax Roll Information.

Any information concerning tax payments should be directed to the Treasury office at 874-8490 or [e-mailed](#).

New Search!

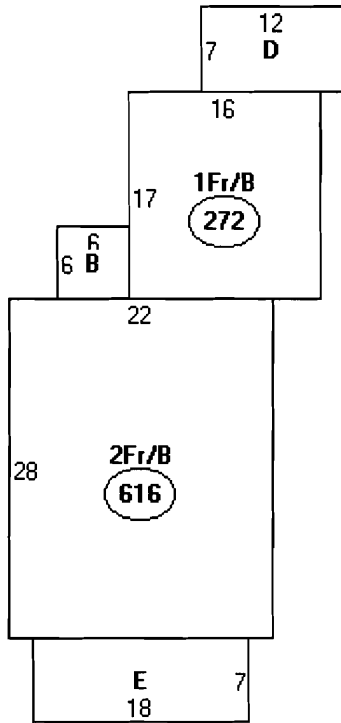

Descriptor/Area

A: 2Fr/B
616 sqft

B: EP
36 sqft

C: 1Fr/B
272 sqft

~~D: WD~~
~~84 sqft~~

E: EP
126 sqft

1050
396 garage

1446
208 deck

1654 ϕ

- no ~~need~~ permit for existing deck.
deck
- not on 1987 assessor's card.

