

THIS IS NOT A BOUNDARY SURVEY

This copyrighted document expires 01-18-18. Reproduction and/or dissemination after this date is unauthorized.

MORTGAGE INSPECTION OF: DEED BOOK 2413 PAGE 397 COUNTY Cumberland
PLAN BOOK 10 PAGE 123 LOT 50

ADDRESS: 1208 Washington Avenue, Portland, Maine

Job Number: 888-37

Inspection Date: 10-16-15

Scale: 1" = 25'

Client File #: 2015-958

Buyers: Scott Donaghy & ~~Deborah S.~~ Donaghy
& David Virella

Kellie Jo

KJD PJSD

DV

Seller: Executor of the Estate of Carmine Pesce

*as
P.R.*

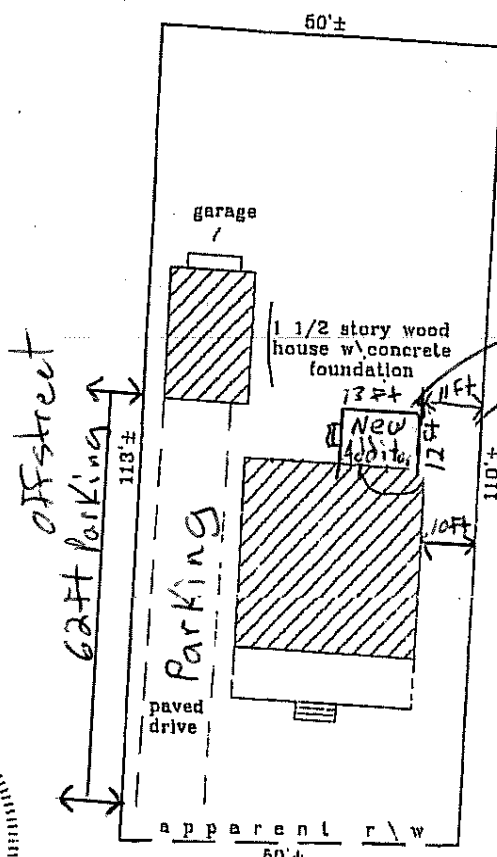

156 square feet Addition

NOTE: Lines of occupation are shown. A boundary survey may yield different results.

NOTE: Locus parcel is serviced by public water & sewer.

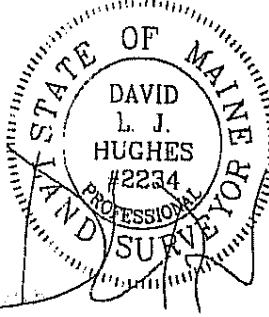

I HEREBY CERTIFY TO: Bay Area Title Services, Franklin American Mortgage Co. and its Title Insurer.

- Monuments found did not conflict with the deed description.
- The dwelling setbacks do not violate town zoning requirements.
- As delineated on the Federal Emergency Management Agency Community Panel 230051-0007C
- The structure does not fall within the special flood hazard zone
- The land does not fall within the special flood hazard zone
- A wetlands study has not been performed.

APPARENT EASEMENTS AND RIGHTS OF WAY ARE SHOWN. OTHER ENCUMBRANCES, RECORDED OR NOT, MAY EXIST. THIS SKETCH WILL NOT REVEAL ABUTTING DEED CONFLICTS, IF ANY.

Livingston-Hughes
Professional Land Surveyors
88 Guinea Road
Kennebunkport, Maine 04046
207-967-9761 phone 207-967-4831 fax
www.livingstonhughes.com

THIS SKETCH IS FOR MORTGAGE PURPOSES ONLY