

DISPLAY THIS CARD ON PRINCIPAL FRONTAGE OF WORK CITY OF PORTLAND

Please Read
Application And
Notes, If Any,
Attached

BUILDING INSPECTION

PERMIT

Permit Number: 020800

This is to certify that Hynn Bruce A & Cynthia J. Applicant

has permission to Erect a 8' x 12' Shed

AT 68 Edgewood Ave L 439 B004001

provided that the person or persons, firm or corporation accepting this permit shall comply with all of the provisions of the Statutes of Maine and of the ordinances of the City of Portland regulating the construction, maintenance and use of buildings and structures, and of the application on file in this department.

Apply to Public Works for street line and grade if nature of work requires such information.

Notification of inspection must be given and written permission procured before this building or part thereof is laid or closed-in.
HEAVY NOTICE IS REQUIRED.

A certificate of occupancy must be procured by owner before this building or part thereof is occupied.

OTHER REQUIRED APPROVALS

Fire Dept. _____

Health Dept. _____

Appeal Board _____

Other _____
Department Name

Jamie Bourke 7/25/02
Director - Building & Inspection Services

PENALTY FOR REMOVING THIS CARD

City of Portland, Maine - Building or Use Permit Application

389 Congress Street, 04101 Tel: (207) 874-8703, Fax: (207) 874-8716

PERMIT ISSUED

Permit No: 02-0800
Issue Date: 7/25/02

CBL: 439 B004001

Location of Construction: 68 Edgewood Ave	Owner Name: Hymn Bruce A & Cynthia J Jts	Owner Address: 68 Edgewood Ave PORTLAND	Phone: 797-4206
Business Name:	Contractor Name: Applicant	Contractor Address: Portland	Phone:
Lessee/Buyer's Name	Phone:	Permit Type: Additions - Dwellings	Zone: R-3

Past Use: Single Family	Proposed Use: Single Family	Permit Fee: \$30.00	Cost of Work: \$925.00	CEO District: 3
		FIRE DEPT: <input type="checkbox"/> Approved <input type="checkbox"/> Denied INSPECTION: Use Group: R-3 Type: SB BOCA 1999		

Proposed Project Description:
Erect a 8' x 12' Shed

Signature: _____ Date: 7/25/02

PEDESTRIAN ACTIVITIES DISTRICT (P.A.D.)

Action: Approved Approved w/Conditions Denied

Signature: _____ Date: _____

Permit Taken By: gad	Date Applied For: 07/02/2002	Zoning Approval
-------------------------	---------------------------------	------------------------

1. This permit application does not preclude the Applicant(s) from meeting applicable State and Federal Rules. 2. Building permits do not include plumbing, septic or electrical work. 3. Building permits are void if work is not started within six (6) months of the date of issuance. False information may invalidate a building permit and stop all work..	Special Zone or Reviews <input checked="" type="checkbox"/> Shoreland <i>within 250' but well over 75' to HWM</i> <input type="checkbox"/> Wetland <input checked="" type="checkbox"/> Flood Zone <i>zone panel 7</i> <input type="checkbox"/> Subdivision <input type="checkbox"/> Site Plan Maj <input type="checkbox"/> Minor <input type="checkbox"/> MM <input type="checkbox"/> Date: 7/25/02 JMB	Zoning Appeal <input type="checkbox"/> Variance <i>N/A</i> <input type="checkbox"/> Miscellaneous <input type="checkbox"/> Conditional Use <input type="checkbox"/> Interpretation <input type="checkbox"/> Approved <input type="checkbox"/> Denied Date: _____	Historic Preservation <input checked="" type="checkbox"/> Not in District or Landmark <input type="checkbox"/> Does Not Require Review <input type="checkbox"/> Requires Review <input type="checkbox"/> Approved <input type="checkbox"/> Approved w/Conditions <input type="checkbox"/> Denied Date: 7/25/02 JMB
--	---	--	--

CERTIFICATION

I hereby certify that I am the owner of record of the named property, or that the proposed work is authorized by the owner of record and that I have been authorized by the owner to make this application as his authorized agent and I agree to conform to all applicable laws of this jurisdiction. In addition, if a permit for work described in the application is issued, I certify that the code official's authorized representative shall have the authority to enter all areas covered by such permit at any reasonable hour to enforce the provision of the code(s) applicable to such permit.

SIGNATURE OF APPLICANT	ADDRESS	DATE	PHONE
RESPONSIBLE PERSON IN CHARGE OF WORK, TITLE		DATE	PHONE

1/7/03 - work is completed + appears to meet
conditions of permit. Tom M

Close out

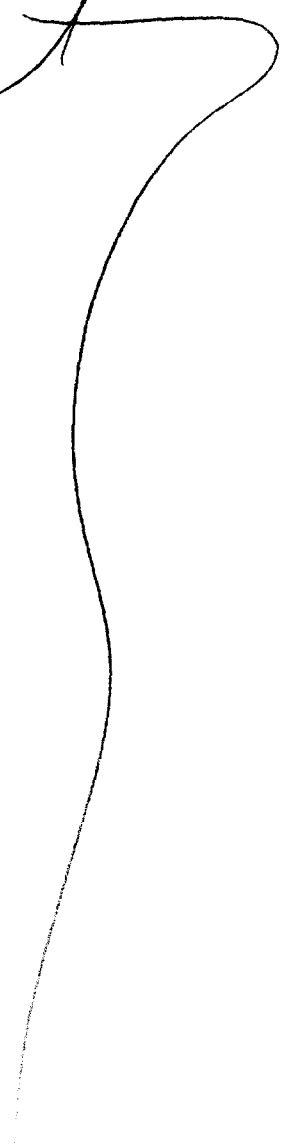

2-0800

Building

Approved

Jeanine Bourke



07/25/2002

07/23/2002



Jeanine Bourke

07/25/2002



All information on this page is confidential. Any deviation from this policy is a violation of the law and is subject to disciplinary action.

07/23/2002

gad

07/25/2002

lmb

02-0800

All Purpose Building Permit Application

If you or the property owner owes real estate or personal property taxes or user charges on any property within the City, payment arrangements must be made before permits of any kind are accepted.

Location/Address of Construction: <u>68 EDGEWOOD AVENUE</u> , <u>04103</u>		
Total Square Footage of Proposed Structure <u>96 s.f.</u>	Square Footage of Lot <u>8000 s.f.</u>	
Tax Assessor's Chart, Block & Lot Chart# <u>439</u> Block# <u>604 B</u> Lot# <u>004.5</u>	Owner: <u>BRUCE AND CYNTHIA HYMAN XX</u>	Telephone: <u>207-797-4206</u> <i>call</i>
Lessee/Buyer's Name (If Applicable)	Applicant name, address & telephone: <u>same as above</u>	Cost Of Work: \$ <u>925</u> Fee: \$ <u>30.00</u>
Current use: <u>Single family residence</u>		
If the location is currently vacant, what was prior use: _____		
Approximately how long has it been vacant: _____		
Proposed use: <u>New structure: storage shed</u>		
Project description: <u>8x12' shed</u>		
Contractor's name, address & telephone: <u>N/A Pre-build</u>		
Who should we contact when the permit is ready: <u>owner above</u>		
Mailing address: _____		
We will contact you by phone when the permit is ready. You must come in and pick up the permit and review the requirements before starting any work, with a Plan Reviewer. A stop work order will be issued and a \$100.00 fee if any work starts before the permit is picked up. PHONE: _____		

IF THE REQUIRED INFORMATION IS NOT INCLUDED IN THE SUBMISSIONS THE PERMIT WILL BE AUTOMATICALLY DENIED AT THE DISCRETION OF THE BUILDING/PLANNING DEPARTMENT, WE MAY REQUIRE ADDITIONAL INFORMATION IN ORDER TO APPROVE THIS PERMIT.

I hereby certify that I am the Owner of record of the named property, or that the owner of record authorizes the proposed work and that I have been authorized by the owner to make this application as his/her authorized agent. I agree to conform to all applicable laws of this jurisdiction. In addition, if a permit for work described in this application is issued, I certify that the Code Official's authorized representative shall have the authority to enter all areas covered by this permit at any reasonable hour to enforce the provisions of the codes applicable to this permit.

Signature of applicant: <u>Bruce Hyman</u>	Date: <u>7/2/02</u>
--	---------------------

This is NOT a permit, you may not commence ANY work until the permit is issued. If you are in a Historic District you may be subject to additional permitting and fees with the Planning Department on the 4th floor of City Hall

FOUNDATION PLAN
68 EDGEWOOD AVENUE

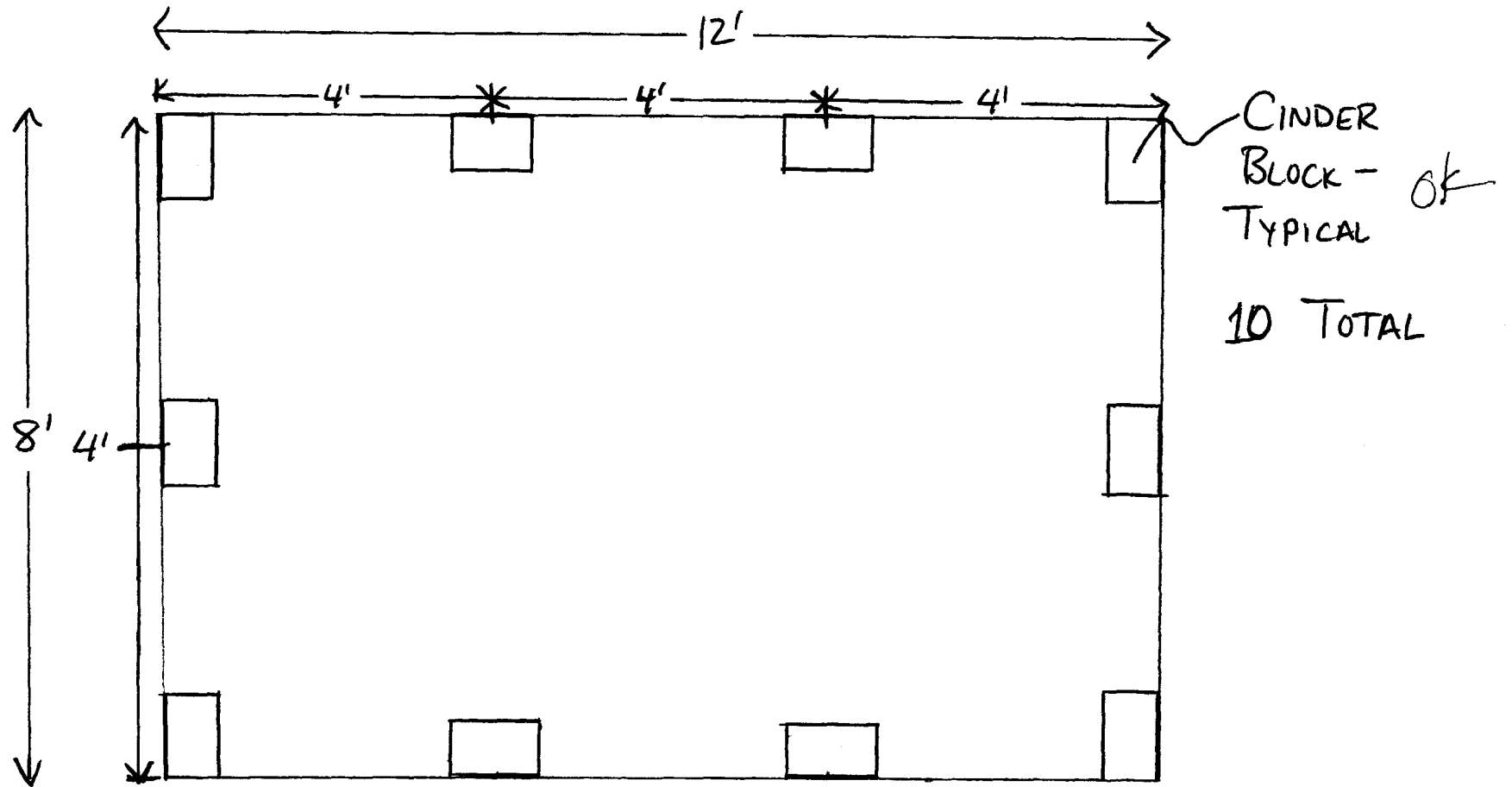

1" = 2'

ELEVATION PLAN
68 EDGEWOOD AVENUE
STORAGE SHED

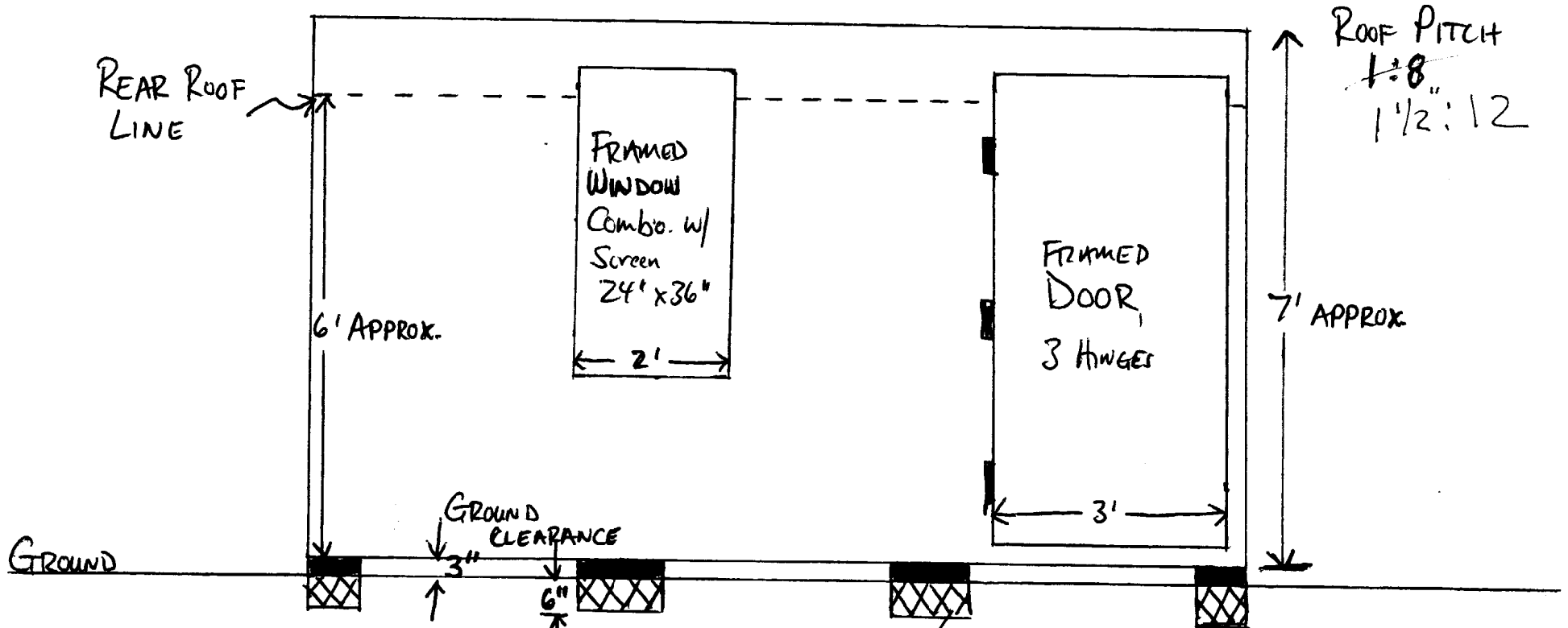

ROOF PITCH
~~1:8~~
1 1/2:12

7' APPROX.

CINDER
BLOCK
TYPICAL

CEDAR CLAPBOARD SIDING
'SHED ROOF' ~~(scribble)~~
ASPHALT ROOF

WALLS
2" x 4" 16" on center
PLYWOOD WALLS

FLOOR + ROOF
2" x 6" 16" on center of
PLYWOOD FLOOR, ROOFING
1" = 2'

Panel # 7

No 439

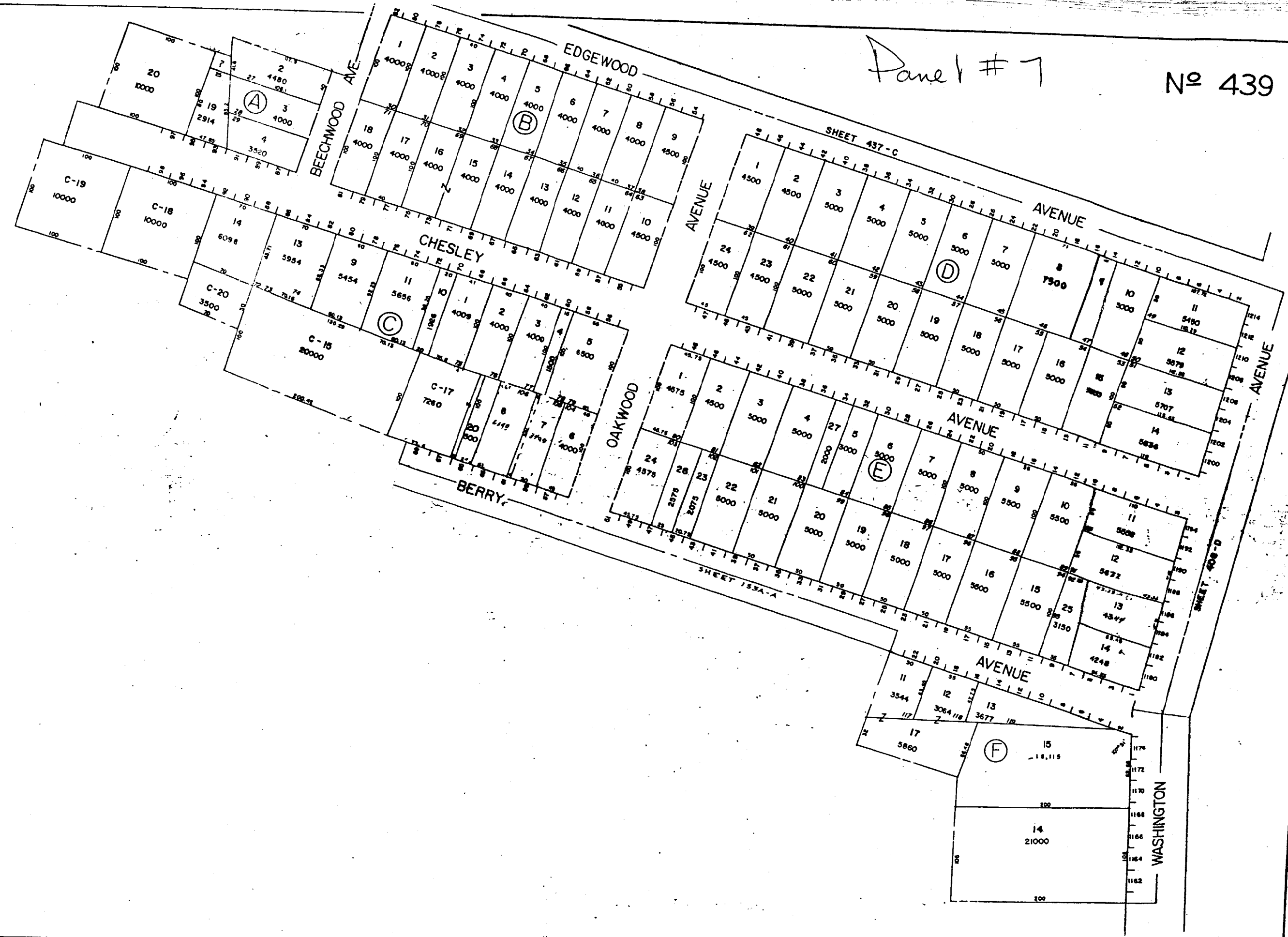

GRIBBON

SEARS WAY

EDGEWOOD AV

APPROX. EDGE OF PAVEMENT

OWNER: GRIMALDI

OWNER: ADAMS

Less Than 100 ft
MINIMUM setback 5' to All property lines

PROPERTY PIN

OWNER: GRIMALDI

PROPERTY PIN

Application for Building Permit Bruce and Cynthia Hyman 68 Edgewood Avenue Portland, ME 04103



1" = 20'

1:240

Source: City of Portland GIS, 1998.

10 0 10 20 30 Feet



BUILDING PERMIT INSPECTION PROCEDURES

Please call 874-8703 or 874-8693 to schedule your inspections as agreed upon

Permits expire in 6 months, if the project is not started or ceases for 6 months.

The Owner or their designee is required to notify the inspections office for the following inspections and provide adequate notice. Notice must be called in 48-72 hours in advance in order to schedule an inspection:

By initializing at each inspection time, you are agreeing that you understand the inspection procedure and additional fees from a "Stop Work Order" and "Stop Work Order Release" will be incurred if the procedure is not followed as stated below.

_____ **Pre-construction Meeting:** Must be scheduled with your inspection team upon receipt of this permit. Jay Reynolds, Development Review Coordinator at 874-8632 must also be contacted at this time, before any site work begins on any project other than single family additions or alterations.

_____ **Footing/Building Location Inspection:** Prior to pouring concrete

_____ **Re-Bar Schedule Inspection:** Prior to pouring concrete

_____ **Foundation Inspection:** Prior to placing ANY backfill

_____ **Framing/Rough Plumbing/Electrical:** Prior to any insulating or drywalling

_____ **Final/Certificate of Occupancy:** Prior to any occupancy of the structure or use. NOTE: There is a \$75.00 fee per inspection at this point.

Certificate of Occupancy is not required for certain projects. Your inspector can advise you if your project requires a Certificate of Occupancy. All projects DO require a final inspection

_____ **If any of the inspections do not occur, the project cannot go on to the next phase, REGARDLESS OF THE NOTICE OR CIRCUMSTANCES.**

_____ **CERIFICATE OF OCCUPANICES MUST BE ISSUED AND PAID FOR, BEFORE THE SPACE MAY BE OCCUPIED**

Cindy Arman
Signature of applicant/designee

7-30-02
Date

Chunlan Wang
Signature of Inspections Official

7/30/02
Date

CBL: 439 B004 Building Permit #: 020800