

DISPLAY THIS CARD ON PRINCIPAL FRONTAGE OF WORK

CITY OF PORTLAND

BUILDING INSPECTION

PERMIT

Please Read Application And Notes, If Any, Attached

PERMIT ISSUED JUN 15 2007 CITY OF PORTLAND

Permit Number: 070555 JUN 15 2007

This is to certify that FOURNIER KAROLINA / American Pool Service

has permission to 24' round above-ground swimming pool

AT 1282 WASHINGTON AVE 437 B069001

provided that the person or persons firm or corporation accepting this permit shall comply with all of the provisions of the Statutes of the State and of the Ordinances of the City of Portland regulating the construction, maintenance and use of buildings and structures, and of the application on file in this department.

Apply to Public Works for street line and grade if nature of work requires such information.

Notification of inspection must be given and when permission procured before this building or part thereof is loaded or enclosed-in 24 HOUR NOTICE IS REQUIRED.

A certificate of occupancy must be procured by owner before this building or part thereof is occupied.

OTHER REQUIRED APPROVALS

- Fire Dept.
Health Dept.
Appeal Board
Other Department Name

Handwritten signature and date 6/13/07

Director - Building & Inspection Services

PENALTY FOR REMOVING THIS CARD

# City of Portland, Maine - Building or Use Permit Application

389 Congress Street, 04101 Tel: (207) 874-8703, Fax: (207) 874-8716

Permit No: 07-0555	Issue Date:	CBL: 437 B069001
-----------------------	-------------	---------------------

Location of Construction: 1282 WASHINGTON AVE	Owner Name: FOURNIER KAROLINA	Owner Address: 1282 WASHINGTON AVE	Phone:
Business Name:	Contractor Name: American Pool Service	Contractor Address: Wales	Phone: 2075775108
Lessee/Buyer's Name	Phone:	Permit Type: Swimming Pools	Zone: R3

Past Use: Single Family	Proposed Use: Single Family 24' round above ground swimming pool	Permit Fee: \$50.00	Cost of Work: \$3,000.00	CEO District: 4
Proposed Project Description: 24' round above ground swimming pool		FIRE DEPT: <input type="checkbox"/> Approved <input type="checkbox"/> Denied <i>N/A</i>	INSPECTION: Use Group: <i>U</i> Type: <i>Pool</i> <i>TRC 2003</i>	
		Signature: <i>[Signature]</i>		

PEDESTRIAN ACTIVITIES DISTRICT (P.A.D.)		
Action: <input type="checkbox"/> Approved	<input type="checkbox"/> Approved w/Conditions	<input type="checkbox"/> Denied
Signature:	Date:	

Permit Taken By: dmartin	Date Applied For: 05/16/2007	<b>Zoning Approval</b>		
-----------------------------	---------------------------------	------------------------	--	--

- This permit application does not preclude the Applicant(s) from meeting applicable State and Federal Rules.
- Building permits do not include plumbing, septic or electrical work.
- Building permits are void if work is not started within six (6) months of the date of issuance. False information may invalidate a building permit and stop all work..

<b>Special Zone or Reviews</b> <input type="checkbox"/> Shoreland <input type="checkbox"/> Wetland <input type="checkbox"/> Flood Zone <input type="checkbox"/> Subdivision <input type="checkbox"/> Site Plan Maj <input type="checkbox"/> Minor <input type="checkbox"/> MM <input type="checkbox"/> Denied Date: <i>5/29/07</i>	<b>Zoning Appeal</b> <input type="checkbox"/> Variance <input type="checkbox"/> Miscellaneous <input type="checkbox"/> Conditional Use <input type="checkbox"/> Interpretation <input type="checkbox"/> Approved Date:	<b>Historic Preservation</b> <input checked="" type="checkbox"/> Not in District or Landmark <input type="checkbox"/> Does Not Require Review <input type="checkbox"/> Requires Review <input type="checkbox"/> Approved <input type="checkbox"/> Approved w/Conditions <input type="checkbox"/> Denied Date: <i>[Signature]</i>
---------------------------------------------------------------------------------------------------------------------------------------------------------------------------------------------------------------------------------------------------------------------------------------------------------------------------------------------------------	------------------------------------------------------------------------------------------------------------------------------------------------------------------------------------------------------------------------------------------	-------------------------------------------------------------------------------------------------------------------------------------------------------------------------------------------------------------------------------------------------------------------------------------------------------------------------------------------------------

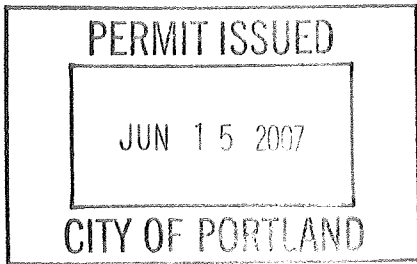

## CERTIFICATION

I hereby certify that I am the owner of record of the named property, or that the proposed work is authorized by the owner of record and that I have been authorized by the owner to make this application as his authorized agent and I agree to conform to all applicable laws of this jurisdiction. In addition, if a permit for work described in the application is issued, I certify that the code official's authorized representative shall have the authority to enter all areas covered by such permit at any reasonable hour to enforce the provision of the code(s) applicable to such permit.

SIGNATURE OF APPLICANT	ADDRESS	DATE	PHONE
RESPONSIBLE PERSON IN CHARGE OF WORK, TITLE		DATE	PHONE

Please call 874-8703 or 874-8693 to schedule your inspections as agreed upon

Permits expire in 6 months, if the project is not started or ceases for 6 months.

The Owner or their designee is required to notify the inspections office for the following inspections and provide adequate notice. Notice must be called in 48-72 hours in advance in order to schedule an inspection:

By initializing at each inspection time, you are agreeing that you understand the inspection procedure and additional fees from a "Stop Work Order" and "Stop Work Order Release" will be incurred if the procedure is not followed as stated below.

A Pre-construction Meeting will take place upon receipt of your building permit.

- Footing/Building Location Inspection: Prior to pouring concrete
- Re-Bar Schedule Inspection: Prior to pouring concrete
- Foundation Inspection: Prior to placing ANY backfill
- Framing/Rough Plumbing/Electrical: Prior to any insulating or drywalling
- Final/~~Certificate of Occupancy~~: Prior to any occupancy of the structure or use. NOTE: There is a \$75.00 fee per inspection at this point.

Certificate of Occupancy is not required for certain projects. Your inspector can advise you if your project requires a Certificate of Occupancy. All projects DO require a final inspection

If any of the inspections do not occur, the project cannot go on to the next phase, REGARDLESS OF THE NOTICE OR CIRCUMSTANCES.

CERTIFICATE OF OCCUPANCIES MUST BE ISSUED AND PAID FOR, BEFORE THE SPACE MAY BE OCCUPIED

*Marina St...*

Signature of Applicant/Designee

*Donna Martin Admin*

Signature of Inspections Official

6-15-07

Date

6-15-07

Date

CBL: 437 B 069 Building Permit #: 07-0555

6/18/07 - checked sketches for pool - 10ft from  
property lines + principal structure - OK.

Jury

**City of Portland, Maine - Building or Use Permit**

389 Congress Street, 04101 Tel: (207) 874-8703, Fax: (207) 874-8716

Permit No: 07-0555	Date Applied For: 05/16/2007	CBL: 437 B069001
-----------------------	---------------------------------	---------------------

Location of Construction: 1282 WASHINGTON AVE	Owner Name: FOURNIER KAROLINA	Owner Address: 1282 WASHINGTON AVE	Phone:
Business Name:	Contractor Name: American Pool Service	Contractor Address: Wales	Phone (207) 577-5108
Lessee/Buyer's Name	Phone:	Permit Type: Swimming Pools	

Proposed Use: Single Family 24' round above ground swimming pool	Proposed Project Description: 24' round above ground swimming pool
---------------------------------------------------------------------	-----------------------------------------------------------------------

Dept: Zoning      Status: Approved with Conditions      Reviewer: Marge Schmuckal      Approval Date: 05/29/2007

Note: Ok to Issue:

- 1) This property shall remain a single family dwelling. Any change of use shall require a separate permit application for review and approval.
- 2) Please note that a 10' setback is required to all property lines and to principal structures. Your pool is shown closer to accessory structures, which is allowable, but not recommended. Pools can leak or "let go" and may damage the structures that are closer than 10'.
- 3) This is NOT an approval for an additional dwelling unit. You SHALL NOT add any additional kitchen equipment including, but not limited to items such as stoves, microwaves, refrigerators, or kitchen sinks, etc. Without special approvals.
- 4) This permit is being approved on the basis of revised plans submitted on 5/25/07. Any deviations shall require a separate approval before starting that work.

Dept: Building      Status: Approved with Conditions      Reviewer: Tammy Munson      Approval Date: 06/13/2007

Note: Ok to Issue:

- 1) Separate permits are required for any electrical, plumbing, or HVAC systems.  
Separate plans may need to be submitted for approval as a part of this process.

**Comments:**

5/24/2007-mes: 5/24/07 called the owner - needs to have 10' between the pool and the principal structure, only showing 7'. She will remeasure and talk to her pool guy and will be sending me a revised plan.



# Pool Installation/Construction Permit Application

If you or the property owner owes real estate or personal property taxes or user charges on any property within the City, payment arrangements must be made before permits of any kind are accepted.

Location/Address of Construction: 1282 Washington Ave PORT ME 04103		
Total Square Footage of Proposed Structure	Square Footage of Lot 6500	
Tax Assessor's Chart, Block & Lot Chart#      Block#      Lot# Map 437-B-69	Owner: Karolina Fournier	Telephone: 207-272-4973 cell 207-878-7907 hm
Lessee/Buyer's Name (If Applicable)	Applicant name, address & telephone: Karolina Fournier 1282 Washington Avenue Portland ME 04103	Cost Of \$ Work: \$ 3000.00 Fee: \$ 48.00
Dimensions of pool: 24' Round <u>above</u> or below ground: _____		
Dimensions of decking and/or any platforms, sheds, or other structures: None		
Contractor's name, address & telephone: American Pool Service (207) 577-5108 Earl Osborne 375-7227 Wales, ME 04280		
Who should we contact when the permit is ready: Karolina Fournier → 5/24/07 Mailing address: Phone: 207-272-4973		

*called owner  
Needs 10' from the  
principal structure -  
she will  
make out  
revised plan*

Please submit all of the information outlined in the pool application checklist. Failure to do so could result in the automatic denial of your permit.

In order to be sure the City fully understands the full scope of the project, the Planning and Development Department may request additional information prior to the issuance of a permit. For further information visit us on-line at [www.portlandmaine.gov](http://www.portlandmaine.gov), stop by the Building Inspections office, room 315 City Hall or call 874-8703.

I hereby certify that I am the Owner of record of the named property, or that the owner of record authorizes the proposed work and that I have been authorized by the owner to make this application as his/her authorized agent. I agree to conform to all applicable laws of this jurisdiction. In addition, if a permit for work described in this application is issued, I certify that the Code Official's authorized representative shall have the authority to enter all areas covered by this permit at any reasonable hour to enforce the provisions of the codes applicable to this permit.

Signature of applicant: <i>K. Fournier</i>	Date: 5-7-07
--------------------------------------------	--------------

**This is not a permit; you may not commence ANY work until the permit is issued.**



## Pool Installation/Construction Checklist

All of the following information is required and must be submitted. Checking off each item as you prepare your application package will ensure your package is complete and will help to expedite the permitting process.

- A plot plan showing the shape and dimension of the lot, footprint of the pool and its distance from the actual property lines, and the principal structure. Include any decks or accessory structures
- A complete set of plans that include structural details, size and dimensions and a cross section showing the slope and depth ratios, or for above ground pool, design specifications. Often this information can be obtained from the manufacturer.
- N/A  A complete set of construction details for any accessory structures or decks including: pier or foundation layout, framing, fastenings, guards/handrails, baluster spacing and stair dimensions
- Details of required barrier protection including the design of fencing, gates, latches, ladders, or audible alarms (if applicable). Please show where they will be located and how they are constructed. This information can often be obtained from the manufacturer
- Proof of ownership is required if it is inconsistent with the assessors records

All pool installations must be conducted in compliance with the  
IRC 2003 Building Code Appendix G

Separate permits are required for HVAC, and electrical installations.

Permit Fee: \$30.00 for the first \$1000.00 construction cost, \$9.00 per additional \$1000.00 cost

**This is not a Permit; you may not commence any work until the Permit is issued.**

*New*

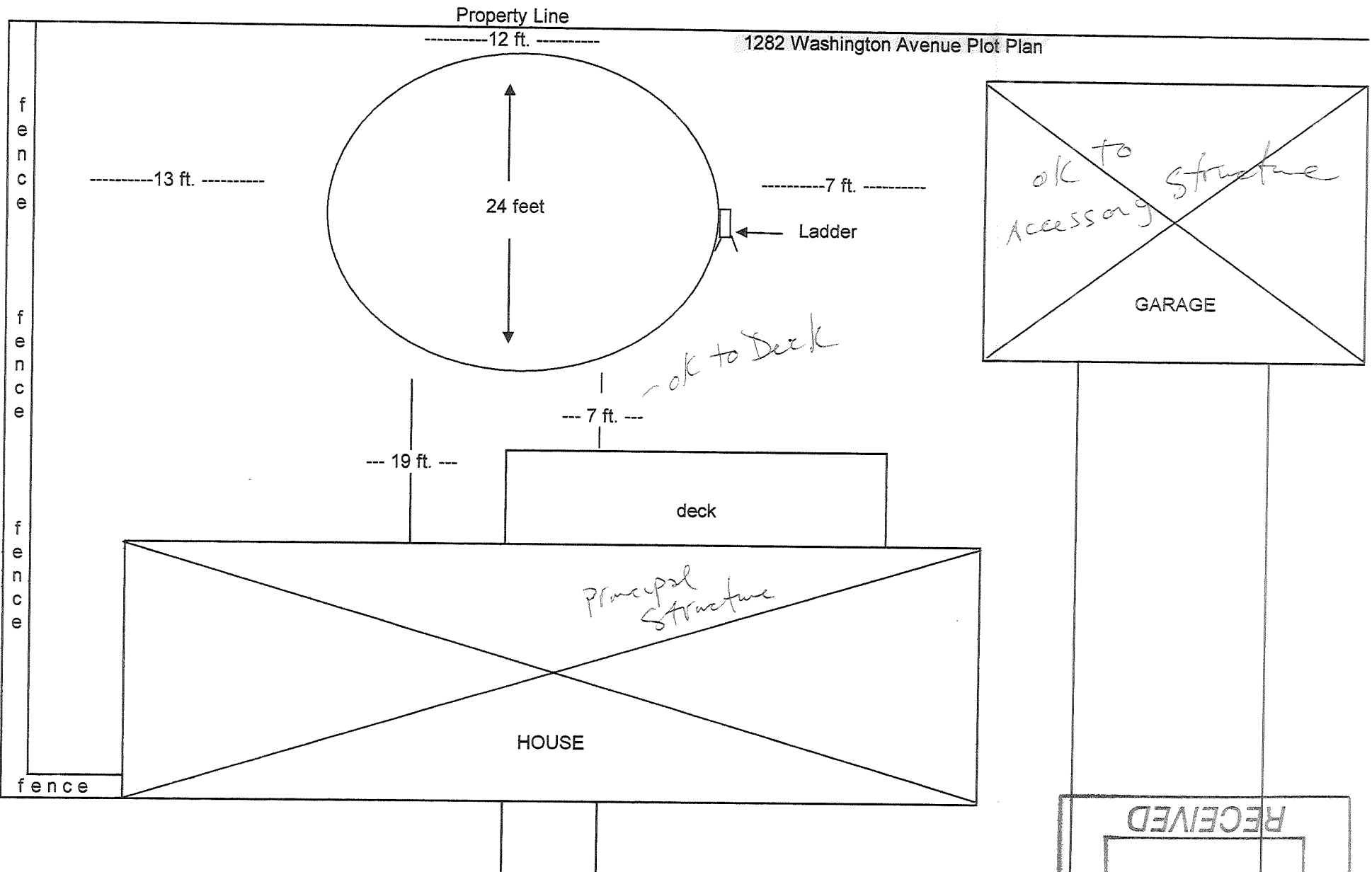

RECEIVED  
MAY 25 2007  
DEPT. OF BUILDING INSPECTION  
CITY OF PORTLAND, ME



When I did the original plot plan for 1282 Washington Avenue, I just put 10 feet away from the property lines because I knew that was what the code was; however, the actual distance is more. This plot plan shows the actual footage of the distances from the property lines. Also, the original plot plan did not show the deck on the back of the house. The 7 foot distance was from the deck edge. The pool itself will actually be 19 feet from the house, the primary structure. If the pool needs to be 10 feet away from the garage also, we can move it over to do that.

1282 Washington Avenue Plot Plan

Property Line

----- 10 ft. -----

----- 10 ft. -----

----- 7 ft. -----

24 feet

Ladder

----- 7 ft. -----

GARAGE

HOUSE

fence

fence

fence

fence

*Needs to be  
10' - called owner  
5/24/07 Ill send me  
she was plot plan  
a new plot plan*

*See  
revised plans  
10/5/15*

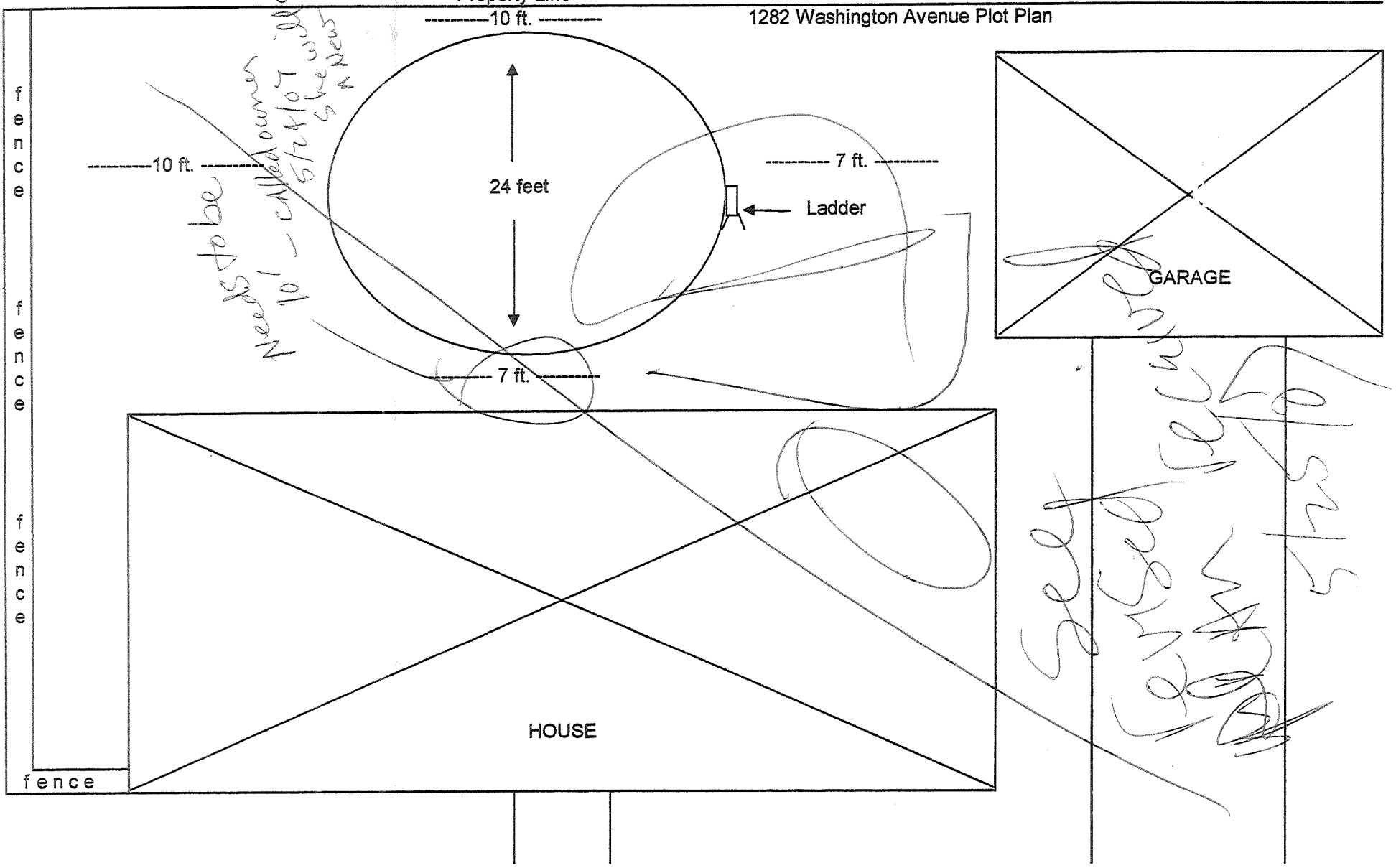

THIS IS NOT A BOUNDARY SURVEY

MORTGAGE INSPECTION OF: DEED BOOK 8989 PAGE 149 COUNTY Cumberland  
PLAN BOOK --- PAGE --- LOT ---

ADDRESS: 1282 Washington Avenue, Portland, Maine

Job Number: 400-74

Buyers: Karolina & Andrew Fournier

Inspection Date: 9-03-04

Scale: 1" = 20'

Sellers: Estate of Dorothy Richard

Client File#: 951428

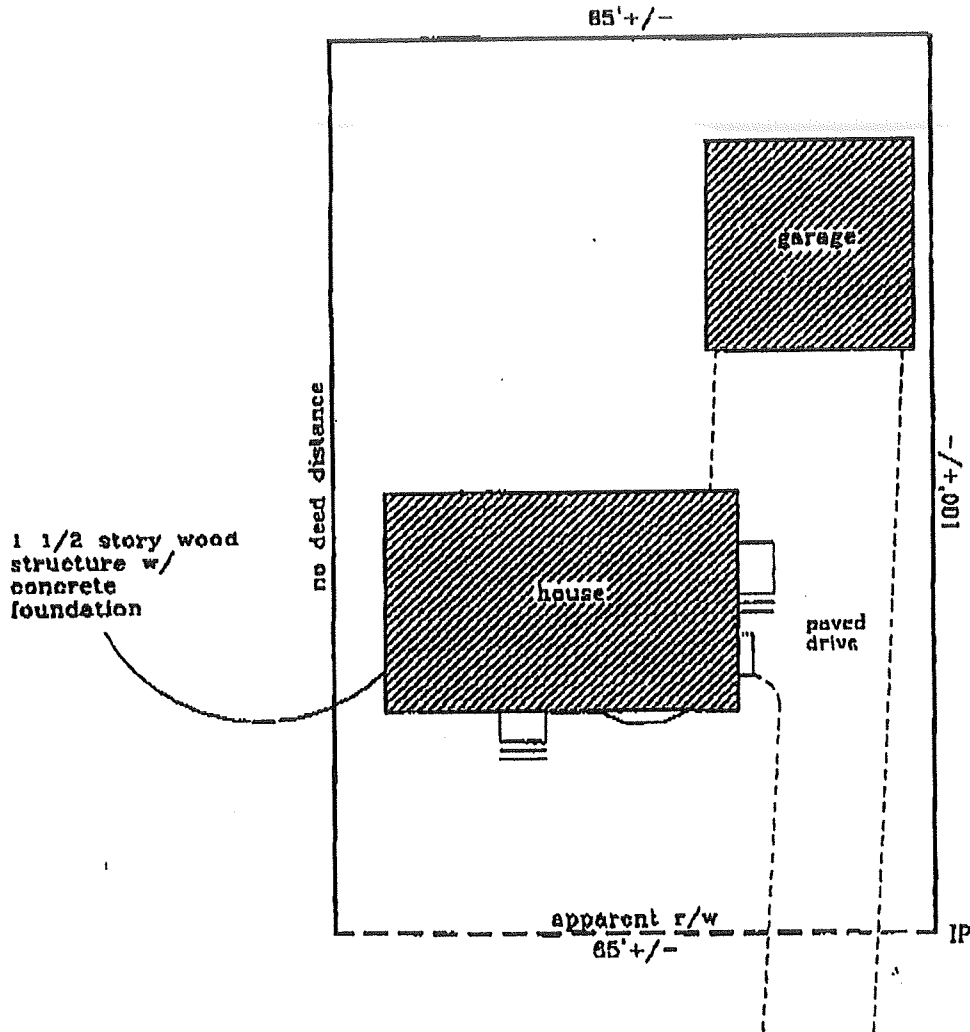

Note:  
Lines of occupation  
are shown.  
A boundary survey  
may yield different  
results.

*[Handwritten signature]*

Washington Avenue

to Allen Ave.

I HEREBY CERTIFY TO: Guaranty Title Co.; Banknorth Mortgage Group, and its title insurer.

Monuments found did not conflict with the deed description.  
The dwelling setbacks do not violate town zoning requirements.

As delineated on the Federal Emergency Management Agency Community Panel: 230051-0007 0

The structure does ~~not~~ fall within the special flood hazard zone.  
The land does ~~not~~ fall within the special flood hazard zone.  
A wetlands study has not been performed.

APPARENT EASEMENTS AND RIGHTS OF WAY ARE SHOWN. OTHER ENCUMBRANCES, RECORDED OR NOT, MAY EXIST. THIS SKETCH WILL NOT REVEAL ABUTTING DEED CONFLICTS, IF ANY.

copyright 1994

Livingston - Hughes

Professional Land Surveyors

86 Guinea Road

Kennebunkport - Maine 04045

207-967-9761 phone

207-967-4831 fax

THIS SKETCH IS FOR MORTGAGE PURPOSES ONLY

\*\*\* TOTAL PAGE.02 \*\*\*

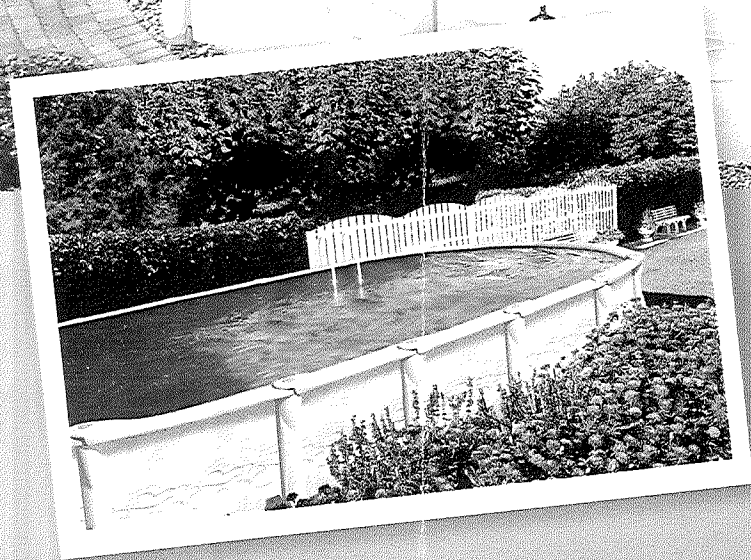
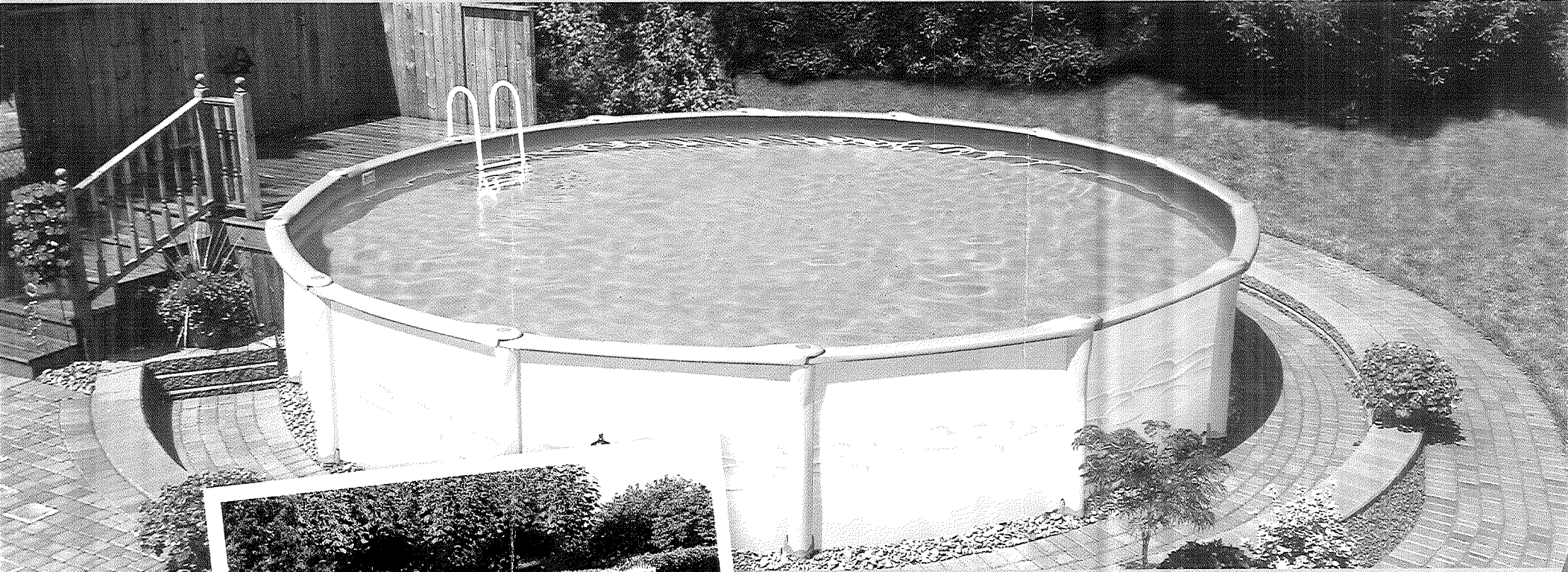

○ 12' 15' 18' 21' 24' 27'

○ 12' x 23' 15' x 30'

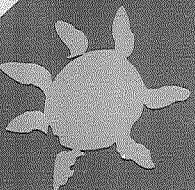



# DISCOVERY™ LX

ADVANTAGE 52

## Outer face

Internal ribbing offers:

- optimal liner and steel wall support
- enhanced stability



## Inner face

### TACKLING SYSTEM

A system that welds upper and lower top seat sections to better resist warping under weight



## UPRIGHT

### Outer face

Precise, soft curves

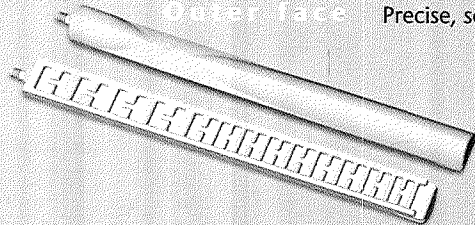

## Inner face

Ribbed molding enhances support, notably at the upright's base where water pressure is most intense



## BASE CROWN

A double-lock system around the bases of the uprights provides increased strength and solidity, as well as double protection that keeps joiner plates fixed and firm.



## EZ LOCK SYSTEM

- A system where the assembling piece is the tool
- Fast and easy installation
- Airtight adjustment

## INDEXING SYSTEM



- System<sup>1</sup> reinforces structural stability
- Parts assemble for perfect cohesion
- Regular and round contours

## SLIDE-IN JOINER PLATE

- Easy and fast installation due to insertion system integrated in upright design
  - No screws necessary
  - Maximum water-pressure resistance through a mechanism that prevents plate movement after insertion

## TOP SEAT

- Precise modular assembly
- Integrated seat cap
- Curved internal rib adjustable to all types of liner

## UPRIGHT

- Screw-less, monocoque system
- Modern and innovative style

## WALL CHANNEL

- Oversized rail for more wall stability
- Easy to install and 100% rust-proof
- Wall clip permits greater stability with ground shifts
- Built-in drainage slot allows easy water evacuation



## water safety

Insertion of pins in the appropriate anchor points, according to the dimensions desired

## Inner face

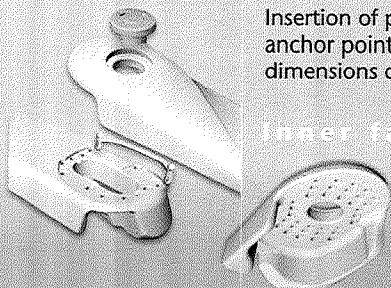

The purchase of an aboveground pool provides years of pleasure and fun, but it also involves water safety. Although we cannot supply a full-time lifeguard, we strongly recommend that you implement the following safety rules. These will help provide a pleasant atmosphere for you and your family.

- NEVER jump or dive in an aboveground pool.
- Maintain constant adult supervision when children are in or near any body of water.
- Read all of the safety, installation, and maintenance information contained in the instruction manual and Water Safety

brochure before you start installing your pool.

- Ask your city about any specific rules and regulations that apply to aboveground pools.
- Follow the instruction manual and maintenance instructions.
- Never remove applied or posted safety stickers or signs from your pool or pool area.
- Barriers to prevent unsupervised access especially by young children, should be built, installed and checked on a regular basis to ensure they are in good working order.

- Inspect your pool, barriers, alarms, and other related equipment on a regular basis in order to ensure they are in good working order and that they are safe.

The installation, maintenance and safety manual contains detailed tips and recommendations. They must be read, followed and applied on a regular basis, as they will prevent unnecessary accidents and will ensure many summers of pleasant, safe family fun.

**SWIM SAFELY AND STAY SAFE**  
Printed in Canada. Manufactured for South Central Pool by 2679965 Canada Inc., 9031 Salley Street, LaSalle (Quebec) CANADA

H8R 2C8. The dimensions, weights, illustrations and other specifications are approximate. The company reserves the right to modify and/or discontinue without notification any feature in any pool model.

1. U.S. Patent 6,412,122  
© Copyright 2003, 2679965 Canada Inc. B300-21A 09/03



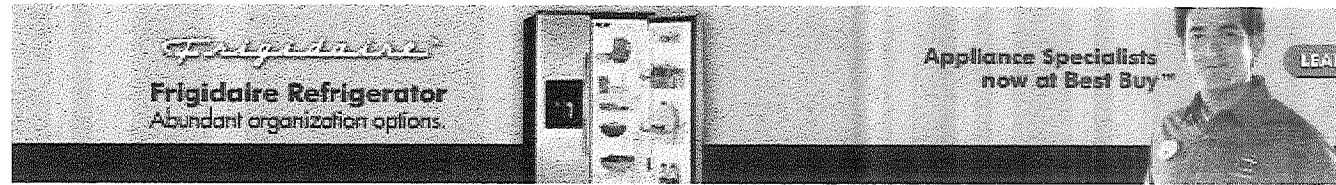

- Computers
- Electronics
- Gaming
- Home
- Clothing
- Babies & Kids
- Entertainment
- Sports
- Jewelry
- Health & Beauty

Search  All Categories



Home > Home and Garden > Garden > Biltmor Above - Ground Step - to - Ladder Entry System details and specs

## Biltmor Above - Ground Step - to - Ladder Entry System

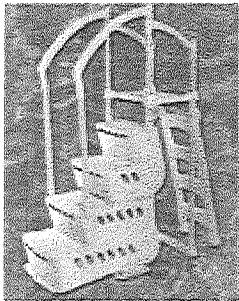

**Price Range:** \$260 - \$411

**Product rating:** Not yet rated

This rugged step/ladder entry system is all you need to enter and exit your pool if you dont have a deck. This system features the Biltmor step that will fit any pool up to 54" deep and makes getting out of your pool easy and safe. Attached to the step is a classic swings up and can be locked for safety. Both the Biltmor step and the classic ladder can support up to a 350-lb. swimmer. They are corrosion-proof polyethylene for years and years of use. The step and ladder system are easy to install and the top seat protects ) rail. This ladder provides the ultimate in ease of use with its extra deep ladder treads. It also comes with a self-closing, locking cover makes this ladder compliant with all local safety codes. The step and ladder entry system is backed by a 3-year warranty. Assembled Imported.

[Compare Prices from 4 Store\(s\)](#)

[Product Spec](#)

### Properties

Type	Swimming Pool and Spa Supplies
Swimming Pool and Spa Supply Type	Pool Steps and Ladders
Brand	Montgomery Ward



The Smart,  
Easy Way  
to Sanitize Your  
Pool Water

**POWER IONIZER**



SAFE • NATURAL • EFFECTIVE

- Dramatically reduces red eyes, itchy skin, fading bathing suits, discolored hair & odors.
- The Power Ionizer sends a precise quantity of copper and silver into your pool, which kills algae, bacteria and viruses. The result is clear, healthy, more natural pool water!
- A true, natural alternative daily sanitizer.

## Easy Incline #200200

- Tread Depth: 9.5" bottom to 6.5" top.
- Extra high, extra strong safety rails!
- Adjustable for 48" to 54" pools.
- Superior strength and durability!

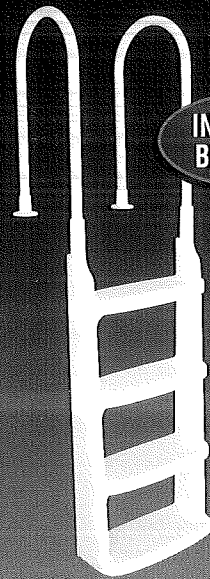

INDUSTRY  
BEST BUY

## Pro Series #200300

ECONOMY  
SERIES

- Promotional deck ladder.
- Extra high, extra strong safety rails!
- Adjustable for 48" to 54" pools.
- Superior strength and durability!

## Smart Lite #200680

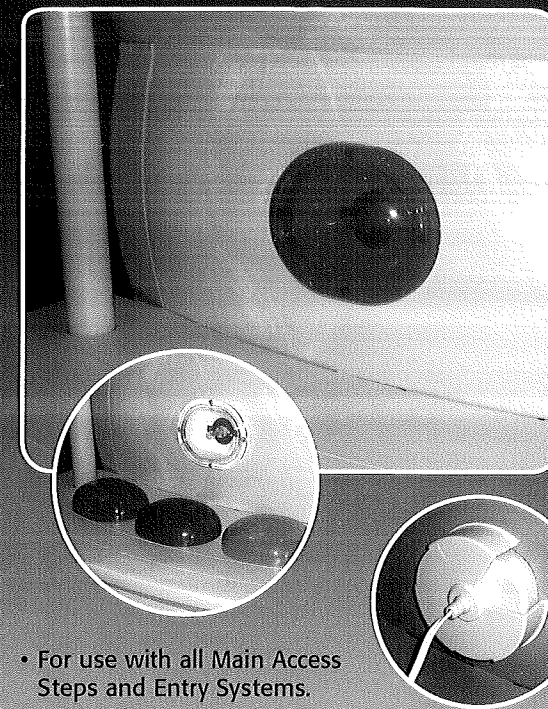

- For use with all Main Access Steps and Entry Systems.
- Installs quickly without tools or hardware!
- Interchangeable lens! Red, green, blue & clear.
- Enhance your swimming experience with underwater lighting!

**main Access**  
ENTRY SYSTEMS

Step Up  
to Safety

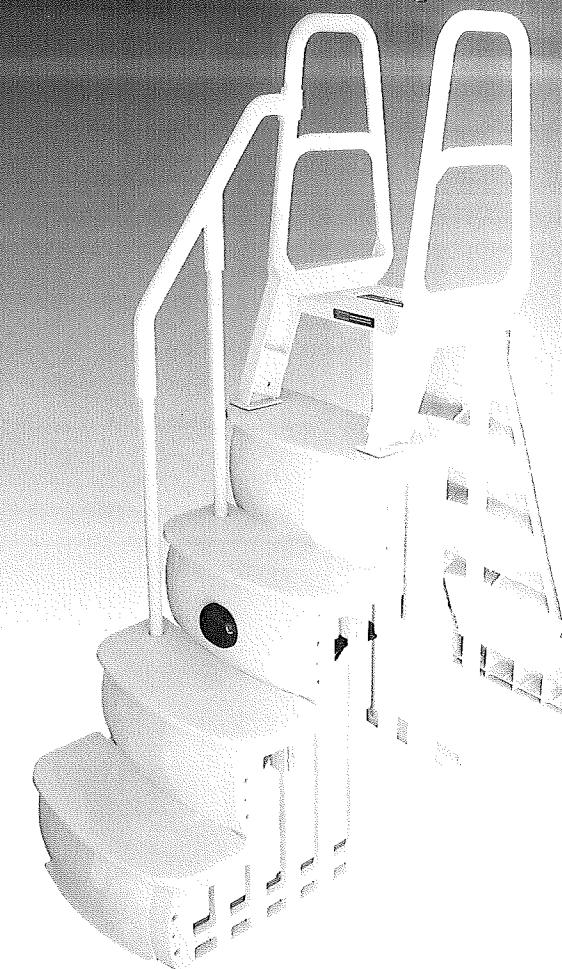

**main Access**  
ENTRY SYSTEMS

**1.888.333.1134**



## Smart Step System #200100T



- Features No-Swim Zone and Flow-Thru step design!
- Adjustable for 48"-54" pools.
- Superior strength, durability and stability!
- Easily converts to deck mount with Conversion Kit #200101T.

*\*Shown with optional Smart Lite*

## Easy Entry System #200800T

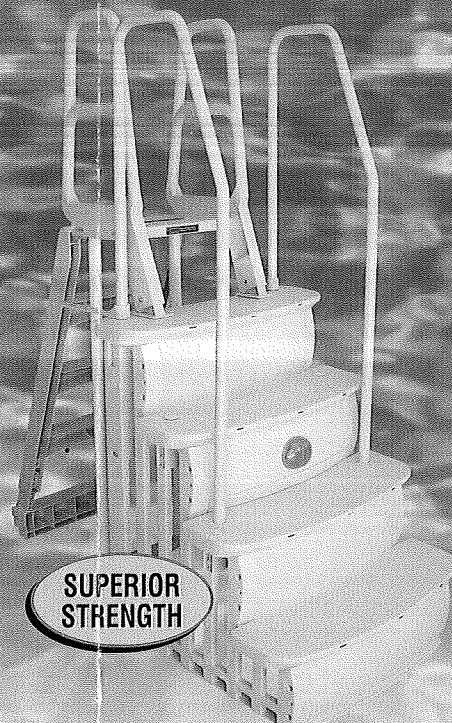

- Features No-Swim Zone and Flow-Thru step design!
- Extra wide 36" treads.
- Superior strength, durability and stability!
- Dual hand rails for added safety and security.
- Easily converts to deck mount!

*\*Shown with optional Smart Lite*

## Easy Entry Step #200400T

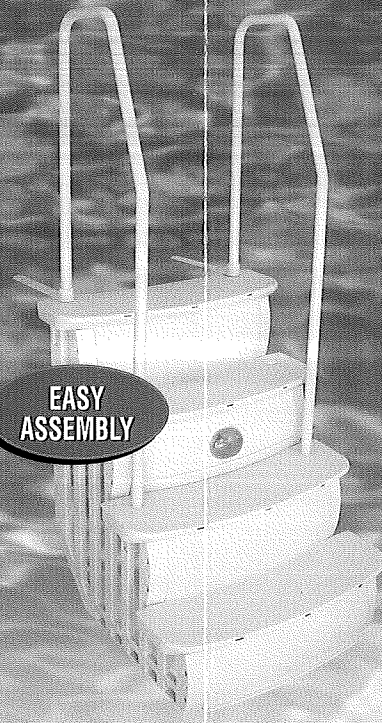

- Features No-Swim Zone and Flow-Thru step design!
- Extra wide 36" treads.
- Simple, quick assembly!
- Superior strength, durability and stability.
- Dual hand rails for added safety and security!
- For use with #200800T Easy Entry System or as deck mount.

*\*Shown with optional Smart Lite*

## iStep #200601T

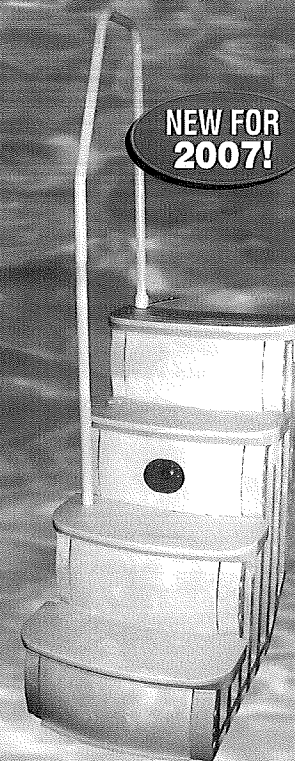

- Simple, convenient entry steps!
- Features No-Swim Zone and Flow-Thru step design.
- Adjustable for 48"-54" pools!
- Designed with smaller pools in mind to maximize swim area.

*\*Shown with optional Smart Lite*

## Brilliant Step System #200502T

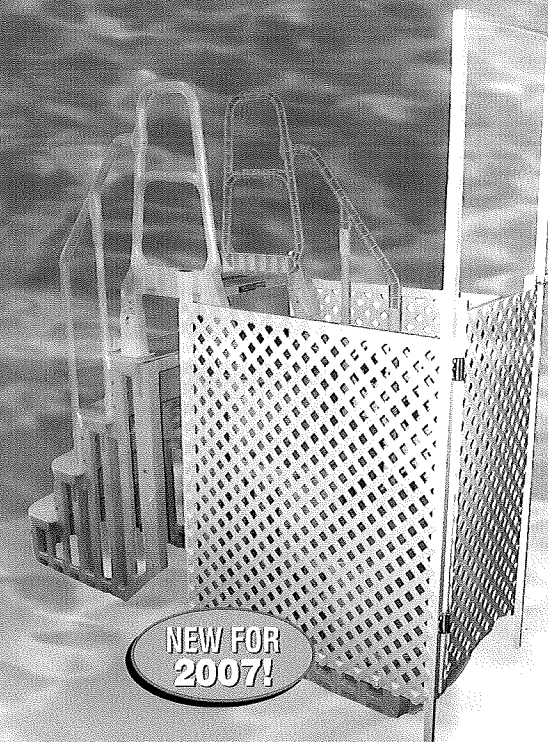

- Features Intelli-Gate™ ground level entry for safest access!
- Adjustable for 48"-54" pools.
- Strong, secure and durable!
- Smart Step on inside and outside of pool combine for superior strength.
- Intelli-Gate™ #200900T can be used with the #200100T or #200800T system!

*\*Optional Smart Lite available*

**main Access**  
ENTRY SYSTEMS

**1.888.333.1134**

**MAIN ACCESS STEPS, LADDERS AND ENTRY SYSTEMS MEET OR EXCEED NSPI-ANSI CODE REQUIREMENTS.**