

DESIGNER

CWS ARCHITECTS
ARCHITECTURE | INTERIOR DESIGN
434 CUMBERLAND AVENUE
PORTLAND, MAINE 04101
T: 207.774.4441
F: 207.774.4016
WWW.CWSARCH.COM

OWNER

NORTHFIELD GREEN
HOUSING PARTNERS LP.

ONE CITY CENTER, 4TH FLOOR
PORTLAND, MAINE 04101

PROJECT

NORTHFIELD GREEN

147 - 1ST ALLEN AVENUE
PORTLAND, MAINE 04101

DRAWING

BUILDING NO. 149
ATTIC REMOVALS PLAN

CWS PROJECT NUMBER: 16,010

REVISIONS

| NO. | DESCRIPTION |
|-----|-------------|
| | |
| | |
| | |
| | |

DRAWING NUMBER
AD1.23

SCALE: AS NOTED
DATE: 11/22/2017

ISSUED NOVEMBER 22, 2017

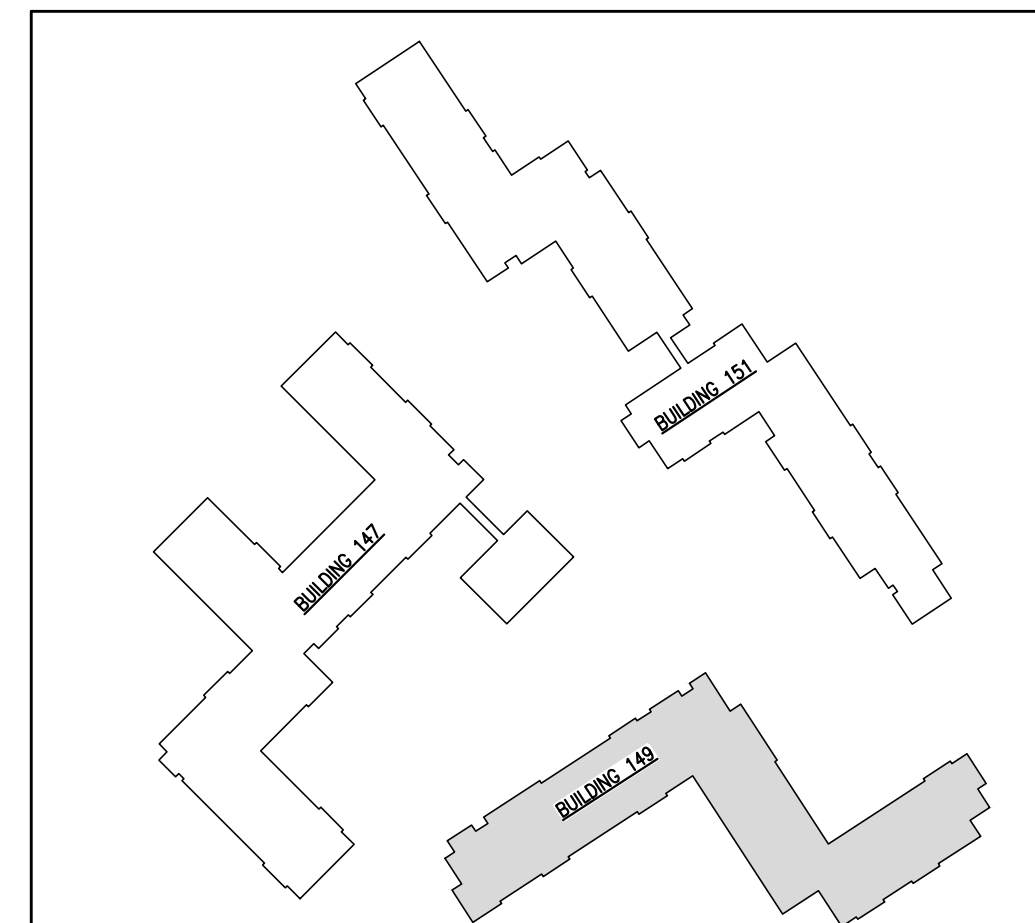
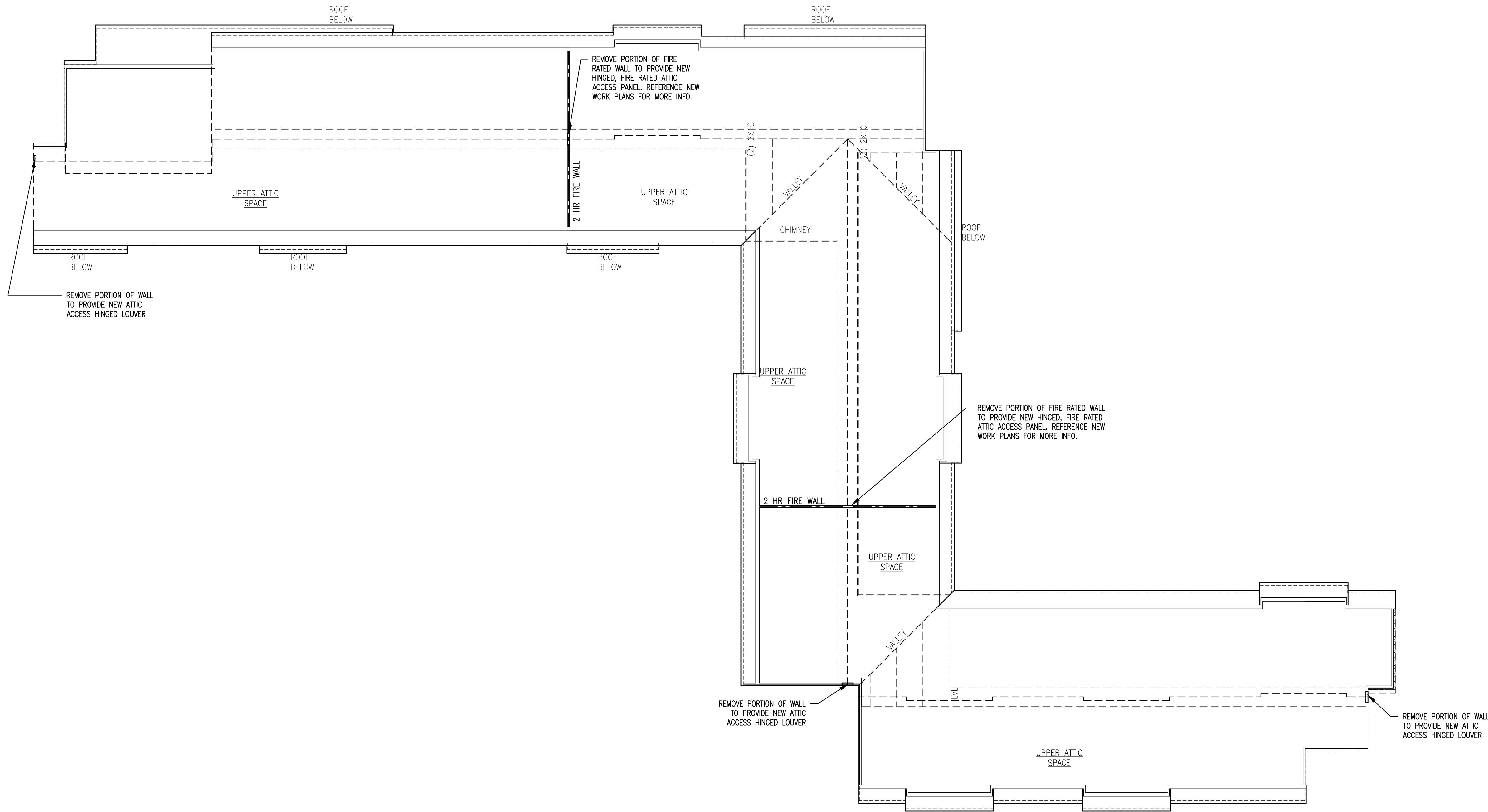

A5 BUILDING NO. 149 - ATTIC REMOVALS PLAN
REFERENCED FROM: TP2 SCALE: 1/16" = 1'-0"

G5 KEY PLAN
REFERENCED FROM: PLANS SCALE: NTS