

CWS ARCHITECTS
ARCHITECTURE | INTERIOR DESIGN
434 CUMBERLAND AVENUE
PORTLAND, MAINE 04101
T: 207.774.4441
F: 207.774.4016
WWW.CWSARCH.COM

DESIGNER

OWNER

NORTHFIELD GREEN
HOUSING PARTNERS LP.

ONE CITY CENTER, 4TH FLOOR
PORTLAND, MAINE 04101

PROJECT

NORTHFIELD GREEN

147 - 1ST ALLEN AVENUE
PORTLAND, MAINE 04101

DRAWING

WINDOW ELEVATIONS

CWS PROJECT NUMBER: 16.010

REVISIONS

NO.	DATE	DESCRIPTION

DRAWING NUMBER

A8.21

SCALE: AS NOTED

DATE: 11/22/2017

ISSUED NOVEMBER 22, 2017

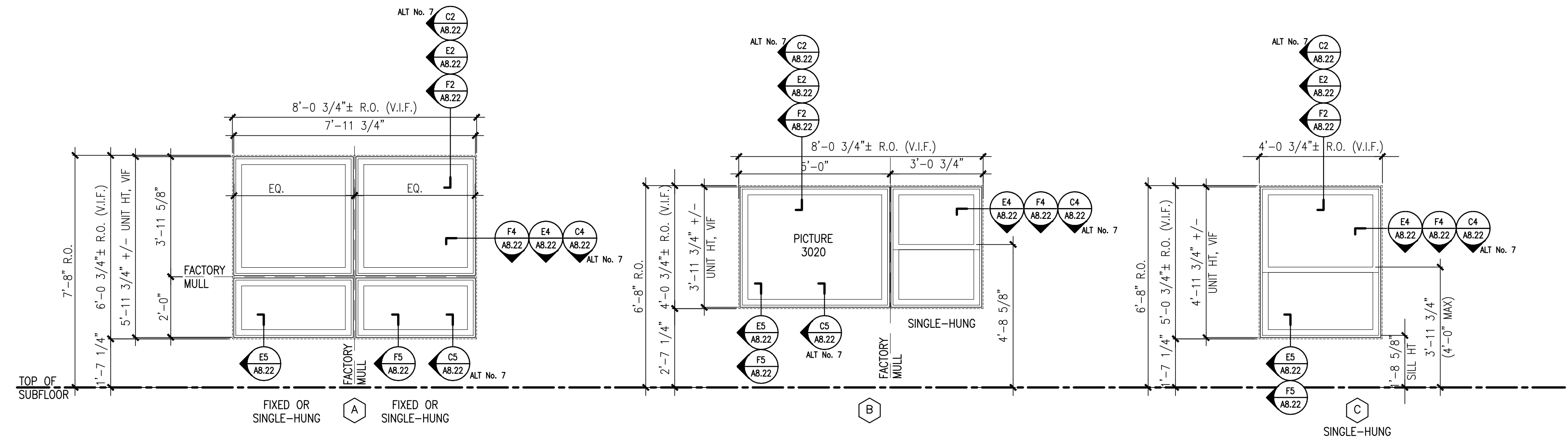

E2 WINDOW TYPE ELEVATIONS
REFERENCED FROM: PLANS SCALE: 3/8" = 1'-0"

GENERAL NOTES:

1. THE CONTRACTOR SHALL VERIFY ALL OPENINGS AND CONFIRM ALL WINDOW AND DOOR UNIT SIZES PRIOR TO RELEASING FOR FABRICATION.
2. REFER TO DOOR SCHEDULE FOR EXTERIOR AND INTERIOR DOOR DETAILS.
3. PROVIDE LOW "E" INSULATED GLAZING AS SPECIFIED, THROUGHOUT.
4. PROVIDE INSECT SCREEN FOR ALL OPERABLE WINDOW UNIT TYPES.
5. PROVIDE DOOR CASING (INTERIOR) PAINTED.
6. PROVIDE HUMAN IMPACT RATED GLAZING AS REQUIRED BY CPSC REGULATION AND AS PER SPECIFICATION.
7. INSULATE BETWEEN WINDOW AND ROUGH OPENING WITH LOW-EXPANDING FOAM INSULATION AS RECOMMENDED BY DOOR/WINDOW MANUFACTURER.

E4 GENERAL NOTES
REFERENCED FROM: SCALE: N/A

F4 WINDOW FLASHING INSTALLATION DIAGRAM
REFERENCED FROM: A8.21 SCALE: NTS

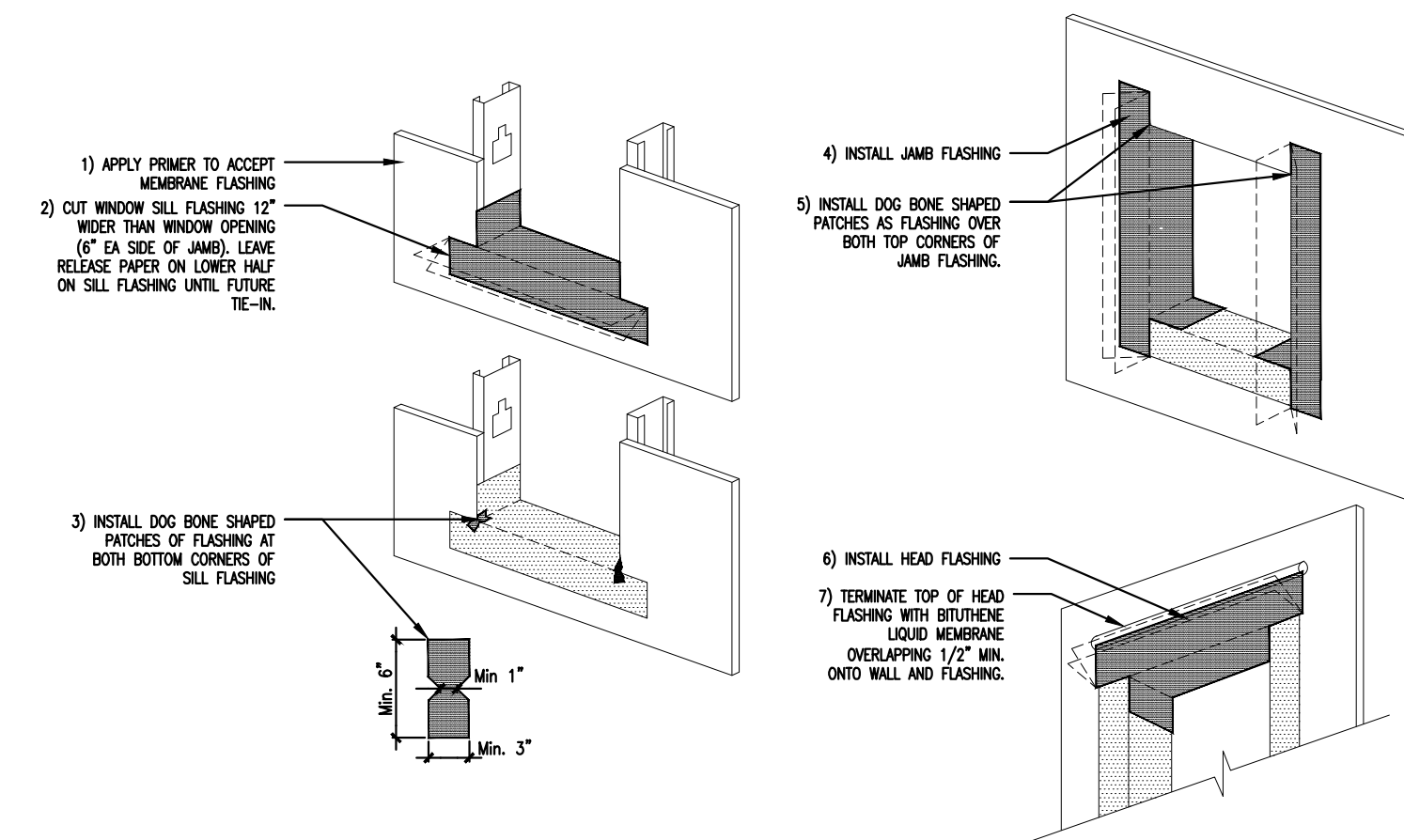

NOTES:

- A. INSTALL AIR INFILTRATION BARRIER AS SPECIFIED.
- B. INSTALL MEMBRANE FLASHING IN ORDER AS SHOWN BY NUMBERED STEPS.
- C. INSTALL MEMBRANE FLASHING PLUS AIR INFILTRATION BARRIER TO FORM WATER SHEDDING LAPS TO THE EXTERIOR SIDE OF THE WALL ASSEMBLY.
- D. COORDINATE WITH FLASHING REQUIREMENTS OF WINDOW MANUFACTURER. REFERENCE WINDOW ELEVATIONS & DETAILS FOR ADDITIONAL INFORMATION.
- E. HEAD AND JAMB DETAILS AT DOOR CONDITIONS SIMILAR.
- F. AT NON-FLANGED OPENINGS, WRAP ENTIRE R.O. WITH ICE AND WATERSHIELD SAME AS SILL DETAIL.
- G. REFERENCE DRAWINGS ON A7.21 FOR EXTERIOR/INTERIOR AIR SEALING DIAGRAM.

1
2
3
4
5