

DESIGNER

CWS ARCHITECTS
ARCHITECTURE | INTERIOR DESIGN
434 CUMBERLAND AVENUE
PORTLAND, MAINE 04101
T: 207.774.4441
F: 207.774.4016
WWW.CWSARCH.COM

OWNER

NORTHFIELD GREEN
HOUSING PARTNERS LP.

ONE CITY CENTER, 4TH FLOOR
PORTLAND, MAINE 04101

PROJECT

NORTHFIELD GREEN

147 - 151 ALLEN AVENUE
PORTLAND, MAINE 04101

DRAWING

BUILDING NO. 151
BASEMENT FLOOR PLAN

CWS PROJECT NUMBER: 16.010

REVISIONS

NO.	DATE	DESCRIPTION

DRAWING NUMBER

A1.30

SCALE: AS NOTED

DATE: 11/22/2017

ISSUED NOVEMBER 22, 2017

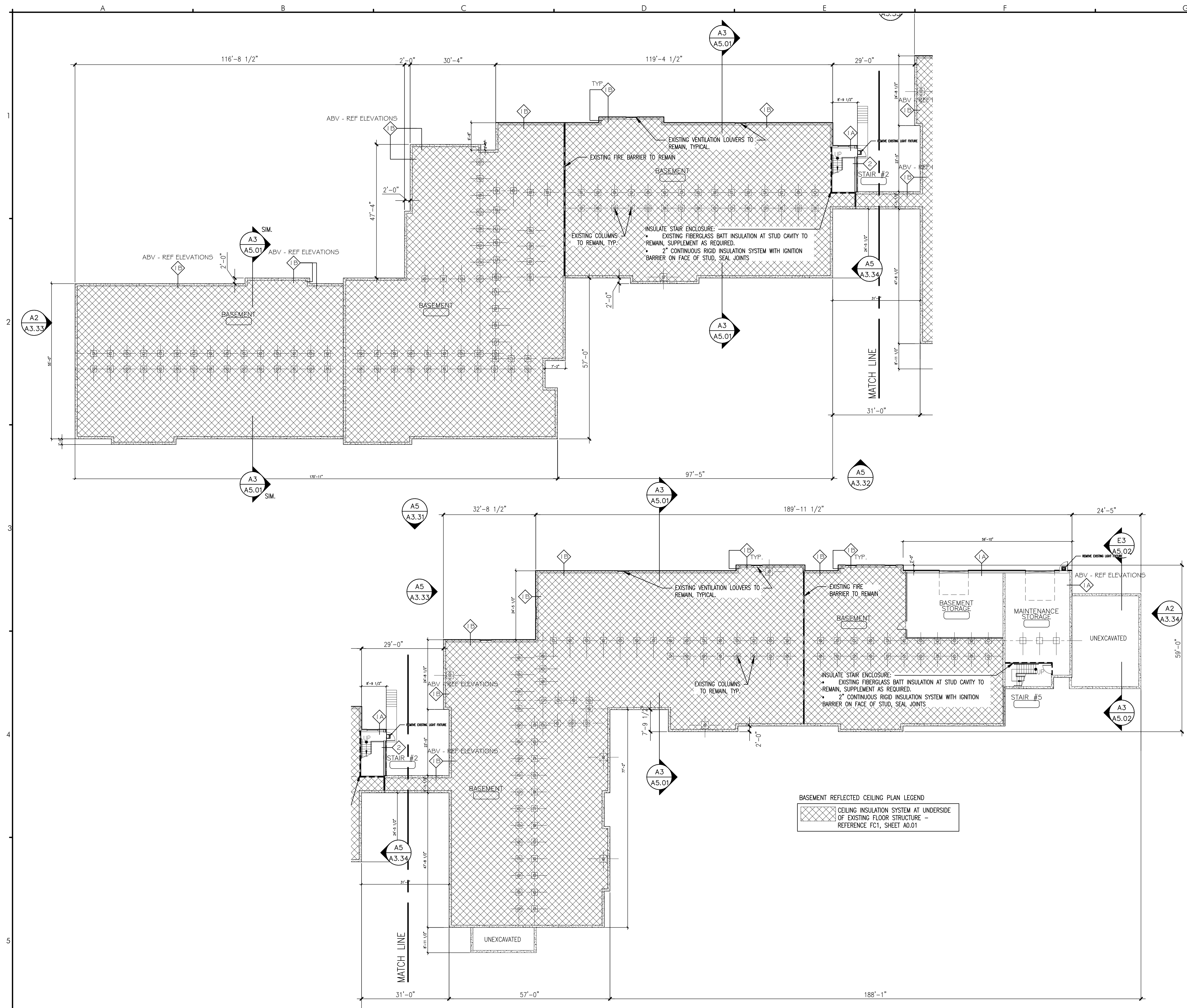

NOTES:
1. REFERENCE CIVIL DRAWINGS FOR SCOPE OF EXTERIOR CONCRETE STOOP WORK AT VARIOUS ENTRY LOCATIONS.

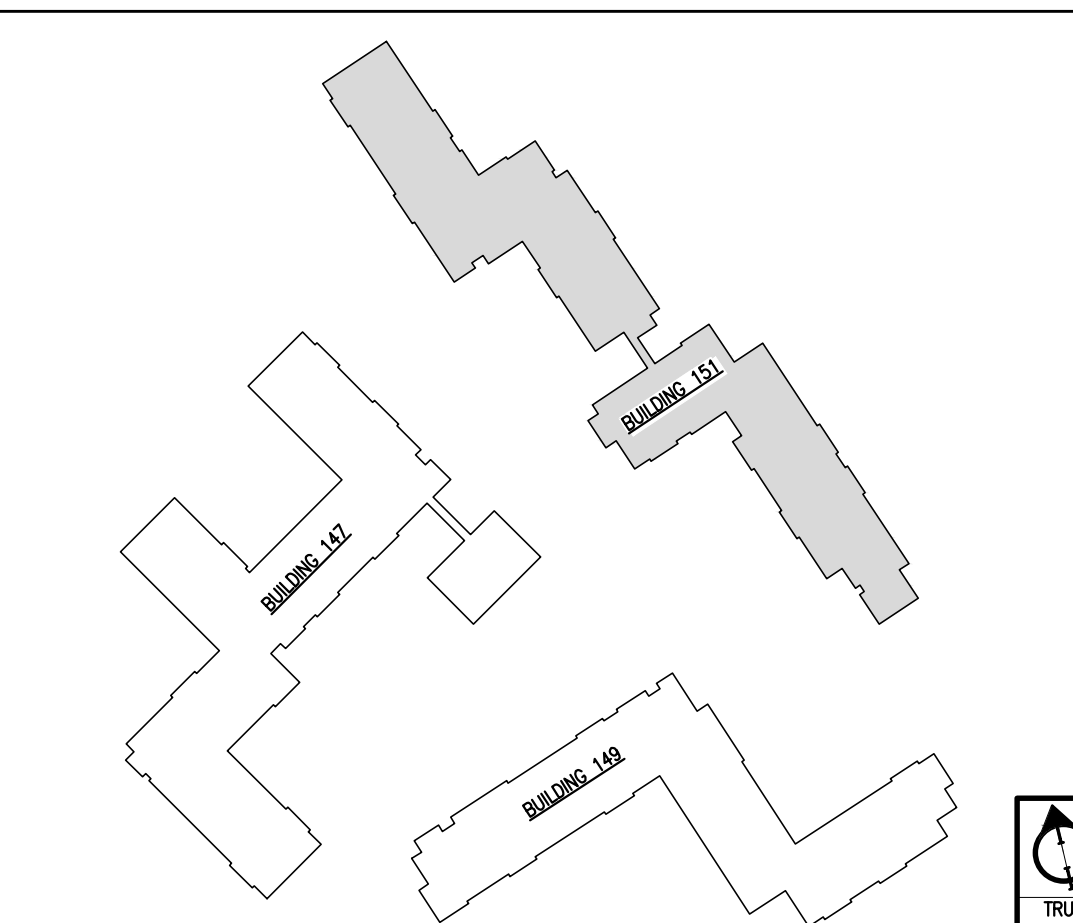

A5 BUILDING NO. 151 - BASEMENT FLOOR PLAN
REFERENCED FROM: TP2 SCALE: 1/16" = 1'-0"

G5 KEY PLAN
REFERENCED FROM: PLANS SCALE: NTS