

DESIGNER

CWS ARCHITECTS
ARCHITECTURE | INTERIOR DESIGN
434 CUMBERLAND AVENUE
PORTLAND, MAINE 04101
T: 207.774.4441
F: 207.774.4016
WWW.CWSARCH.COM

OWNER

NORTHFIELD GREEN HOUSING PARTNERS LP.

ONE CITY CENTER, 4TH FLOOR
PORTLAND, MAINE 04101

PROJECT

NORTHFIELD GREEN

147 - 151 ALLEN AVENUE
PORTLAND, MAINE 04101

DRAWING

BUILDING NO. 149 BASEMENT FLOOR PLAN

CWS PROJECT NUMBER: 16.010

REVISIONS

NO.	DATE	DESCRIPTION

DRAWING NUMBER
A1.20

SCALE: AS NOTED
DATE: 11/22/2017

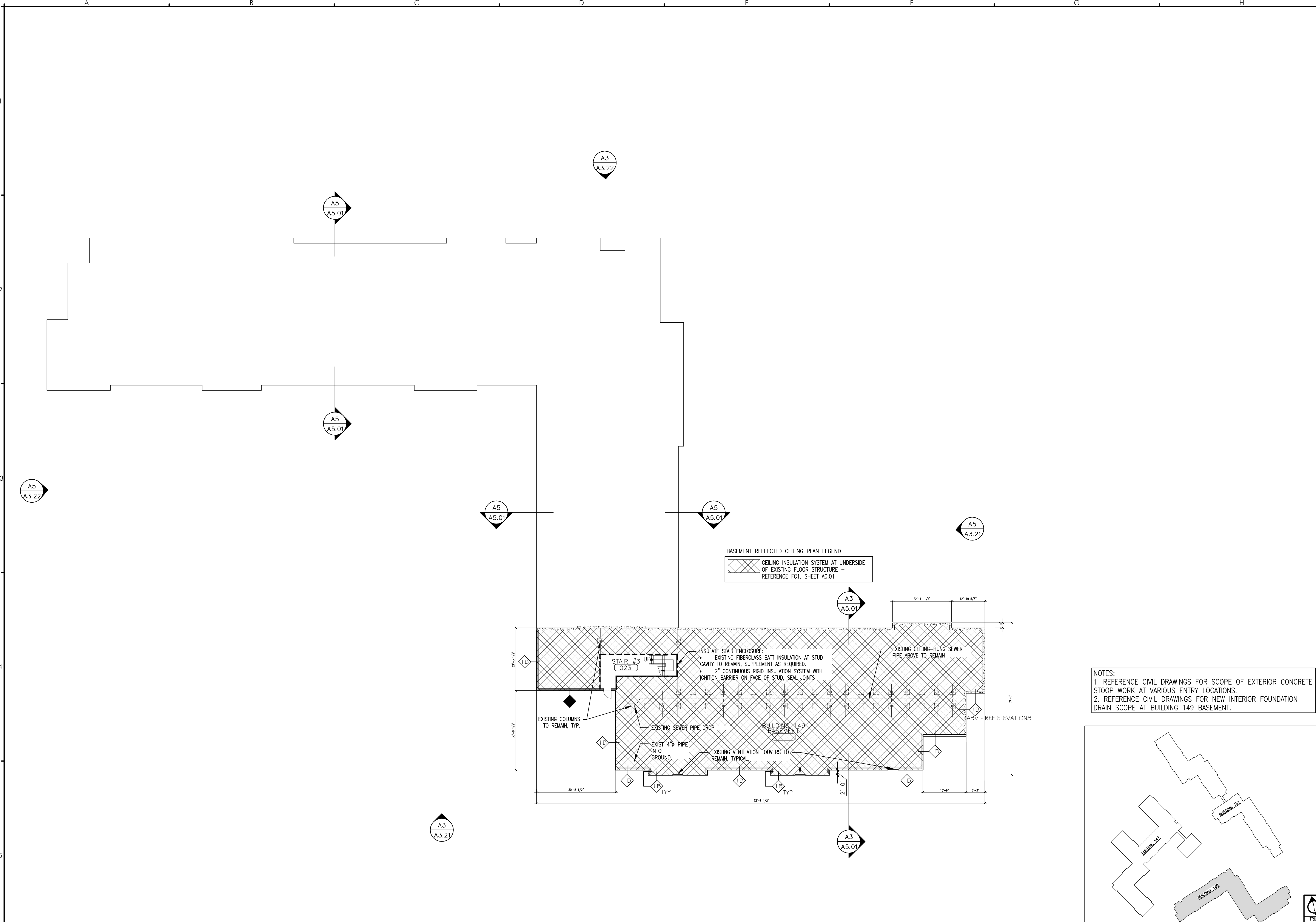

NOTES:
1. REFERENCE CIVIL DRAWINGS FOR SCOPE OF EXTERIOR CONCRETE STOOP WORK AT VARIOUS ENTRY LOCATIONS.
2. REFERENCE CIVIL DRAWINGS FOR NEW INTERIOR FOUNDATION DRAIN SCOPE AT BUILDING 149 BASEMENT.

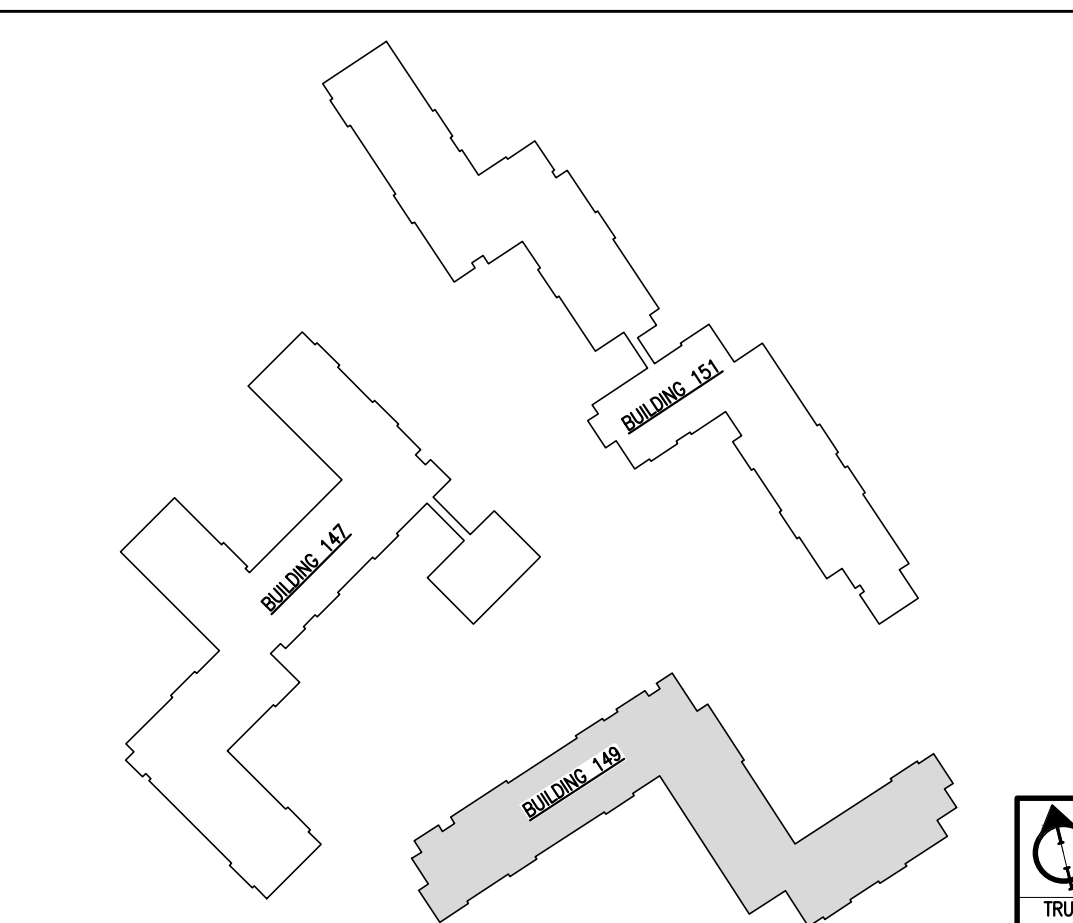

A5 BUILDING NO. 149 - BASEMENT FLOOR PLAN
REFERENCED FROM: TP2 SCALE: 1/16" = 1'-0"

G5 KEY PLAN
REFERENCED FROM: PLANS SCALE: NTS