

**GENERAL NOTES:**  
 1. SEE GDD FOR PROJECT GENERAL NOTES.  
 2. SEE SPECIFICATIONS FOR MORE INFORMATION REGARDING FINISHES AND FINISH APPROPRIATENESS.

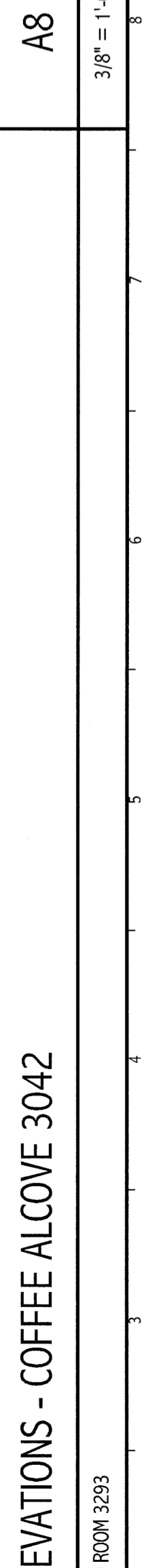

ISSUED FOR G.M.P. & PERMITTING  
 4-3-09

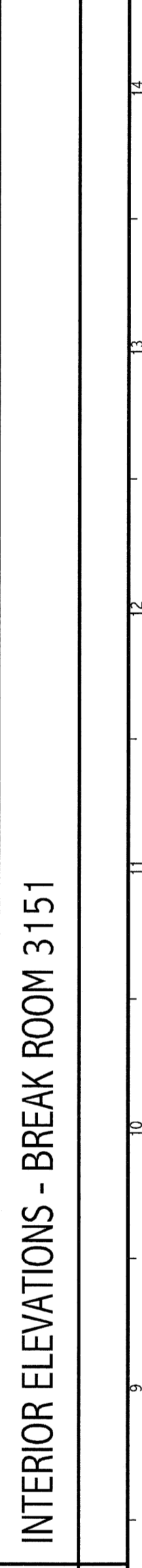
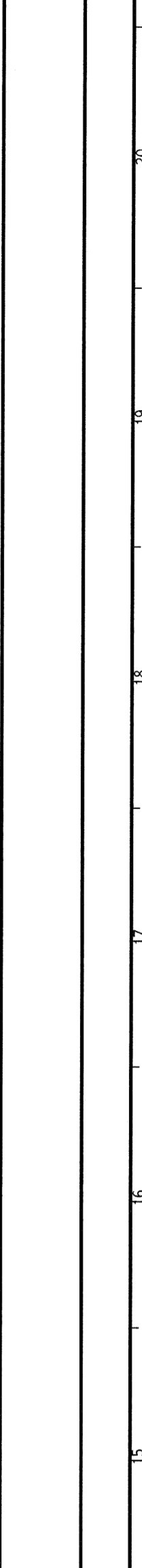
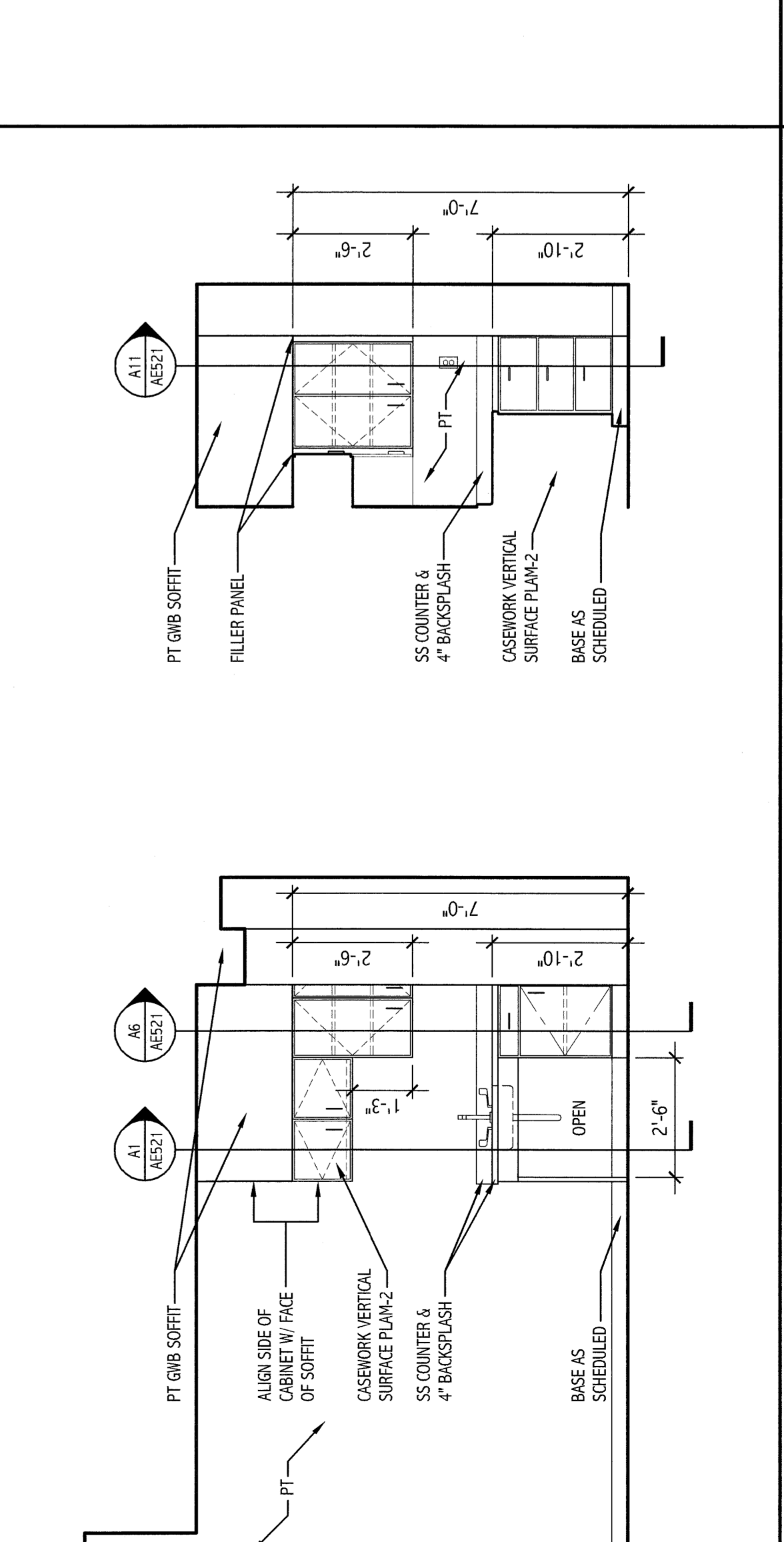
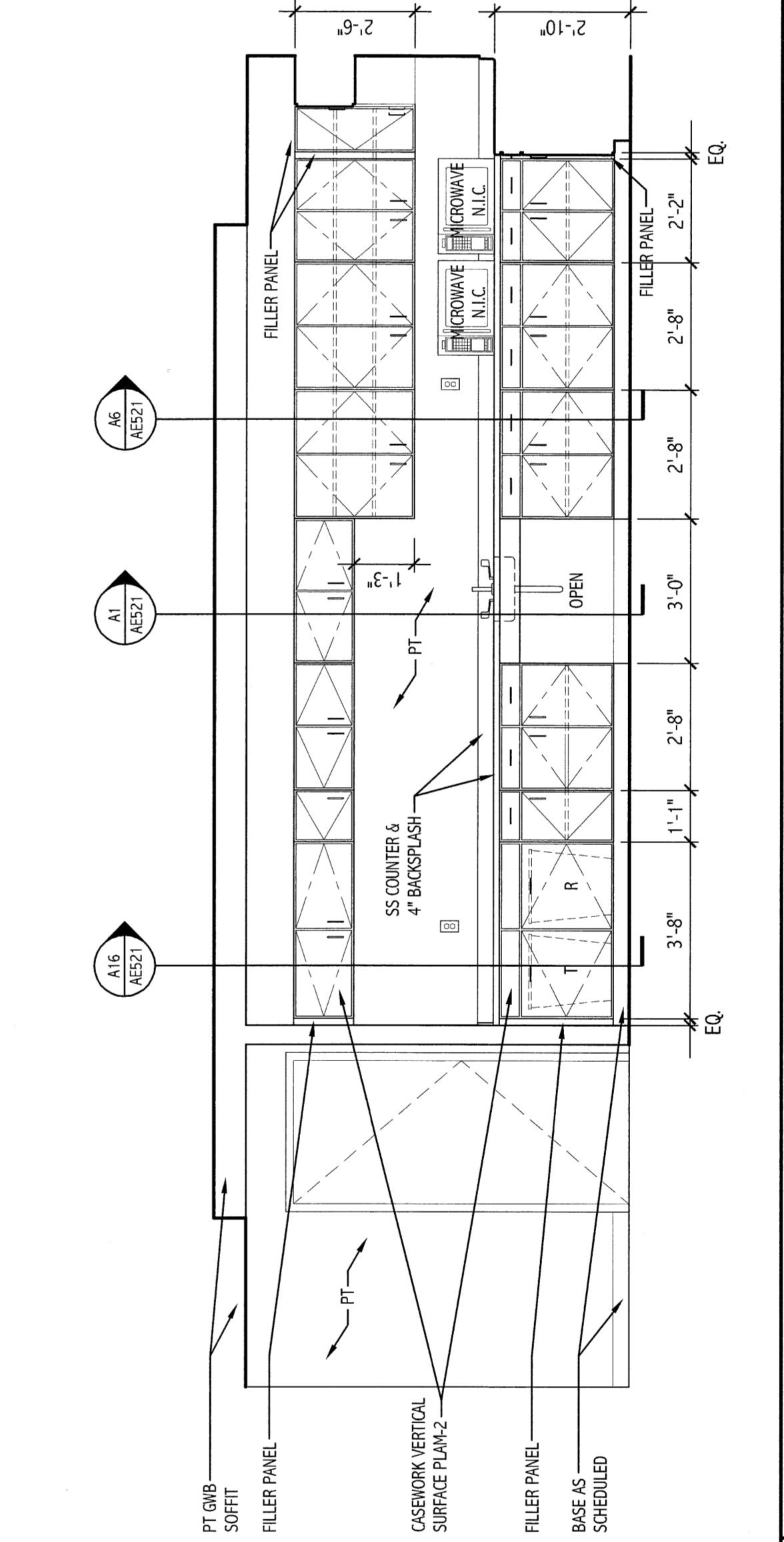
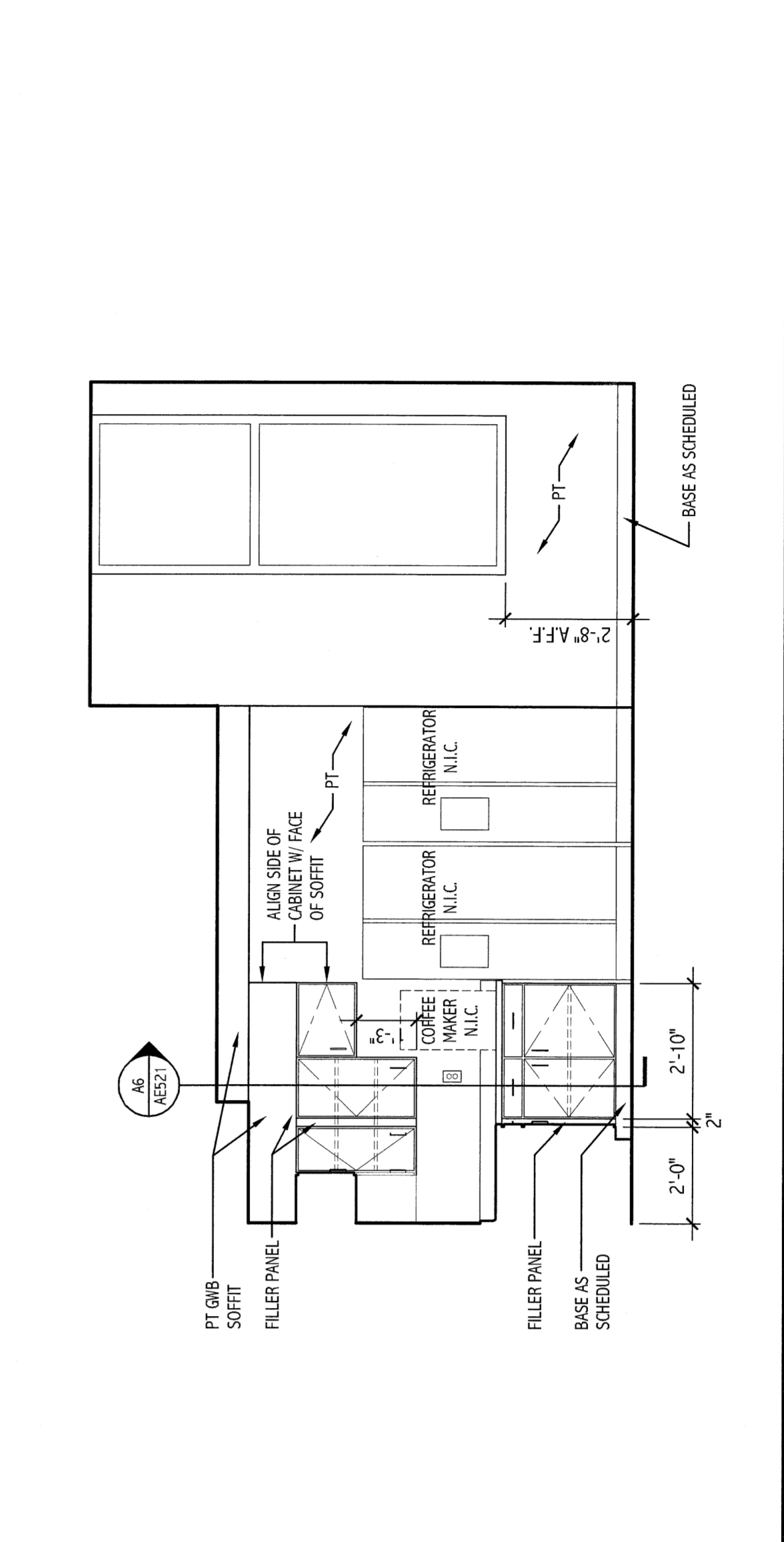
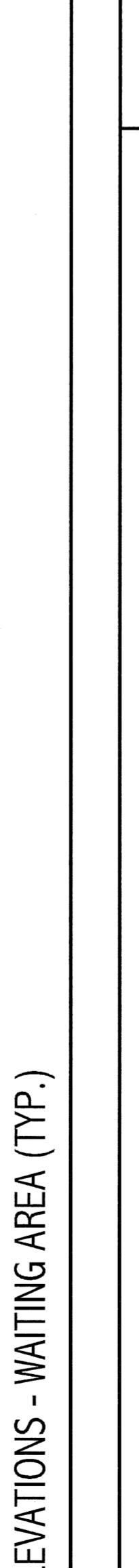
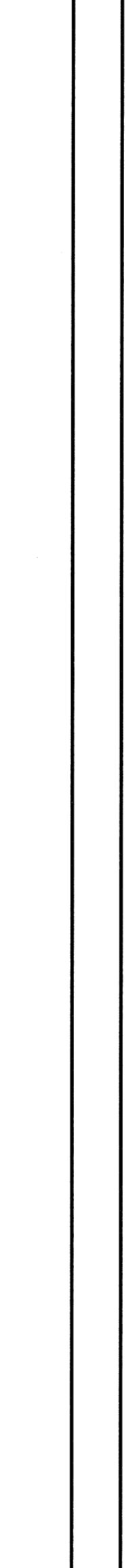
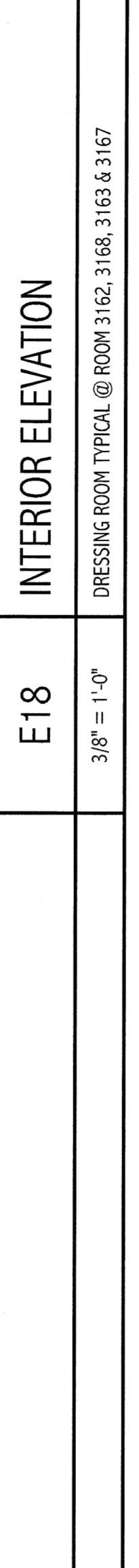
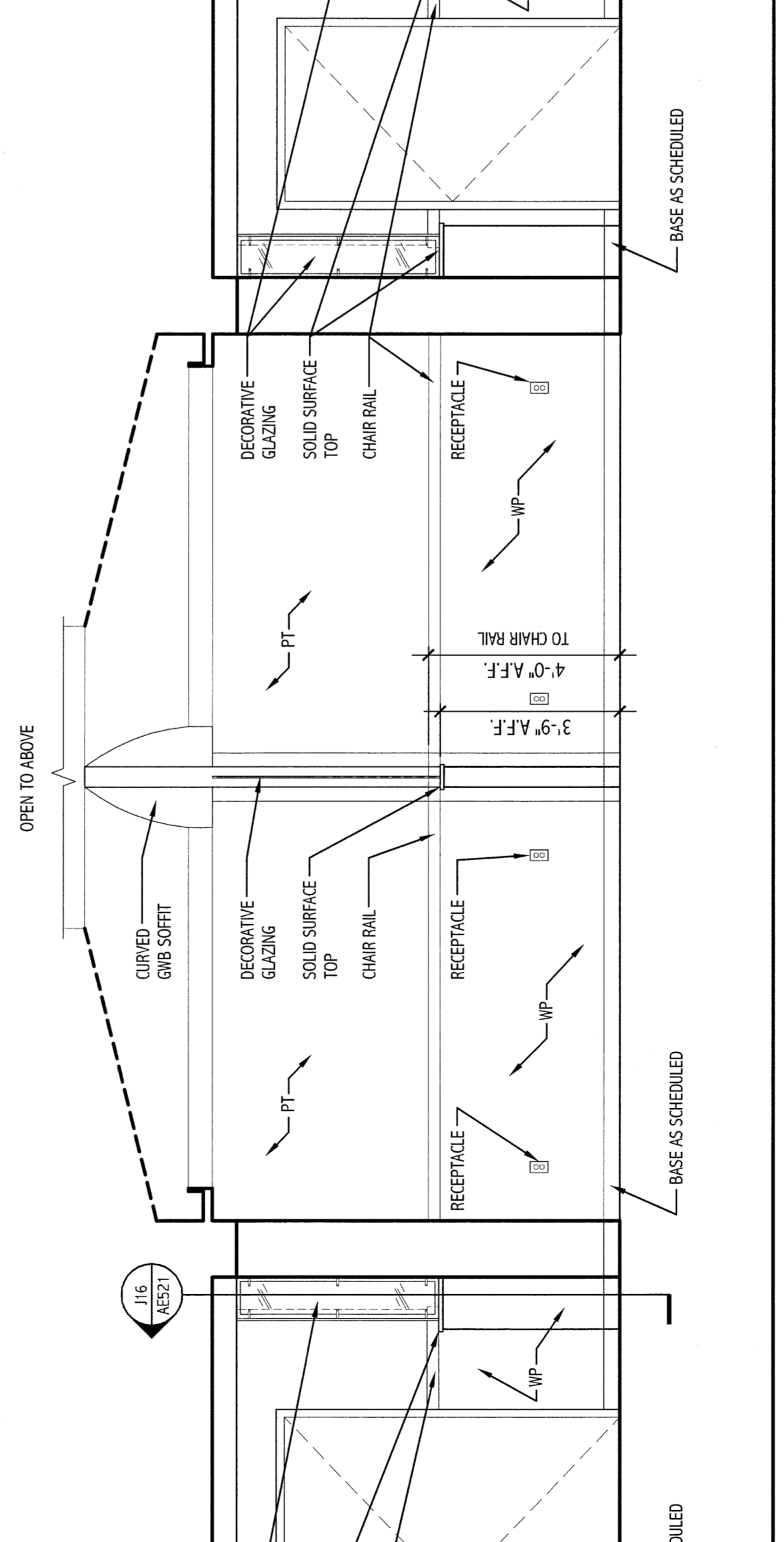
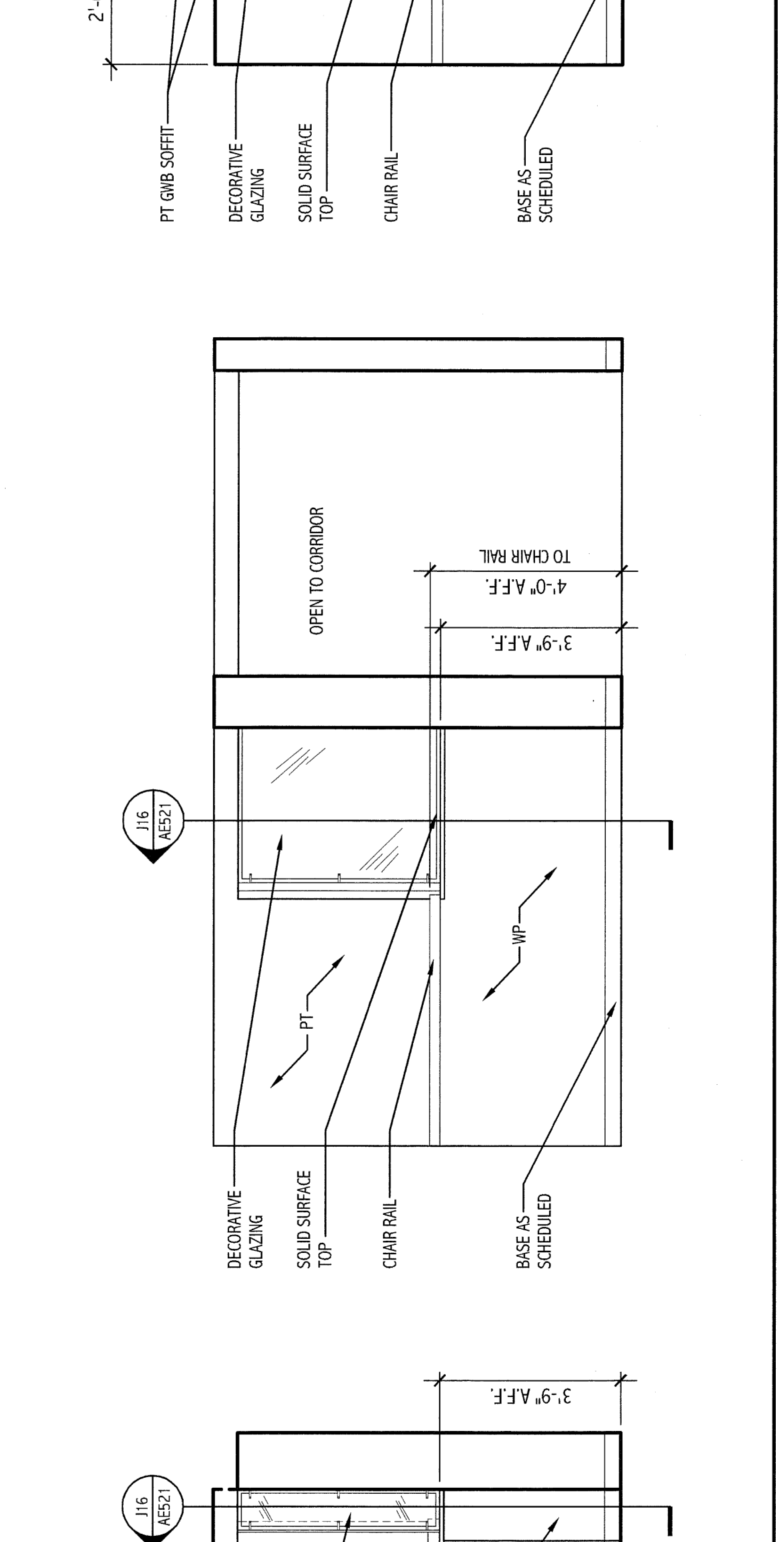
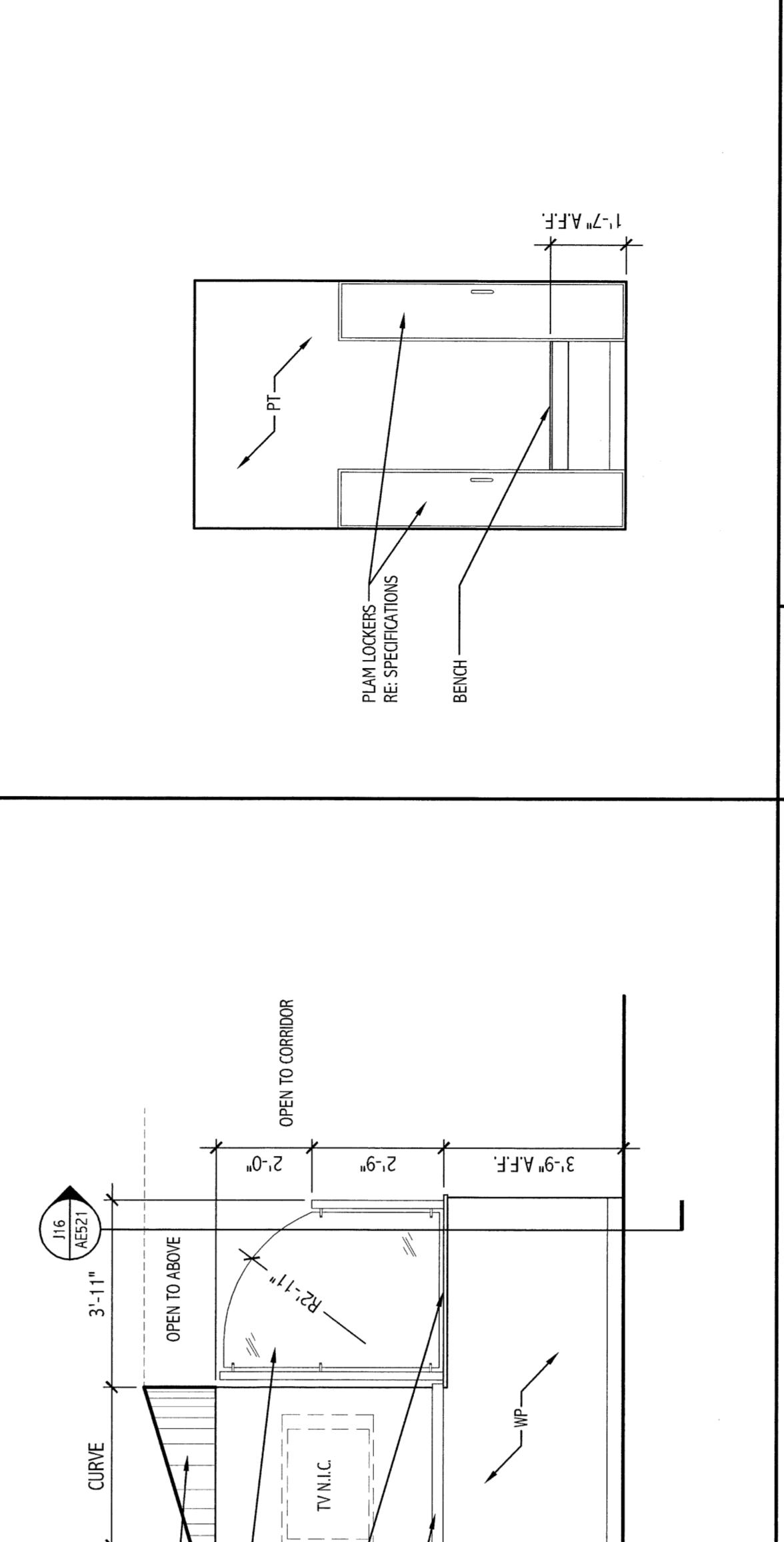
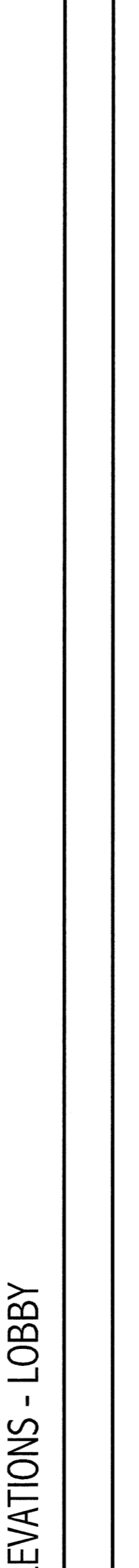
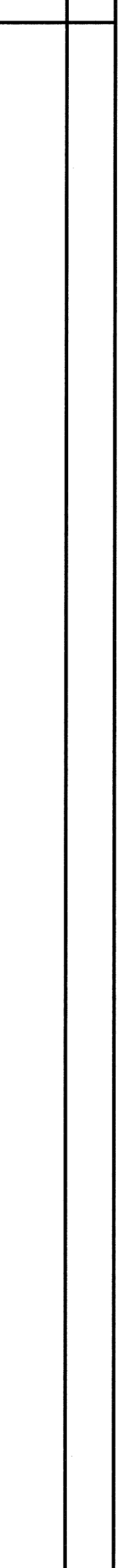
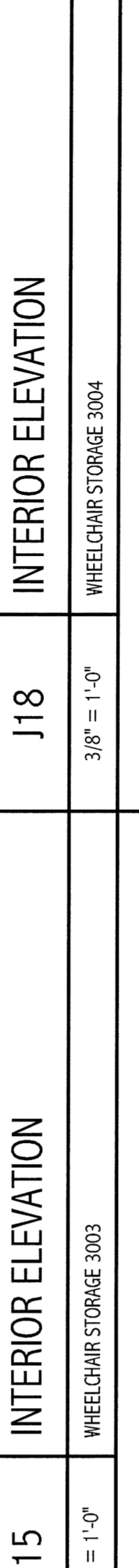
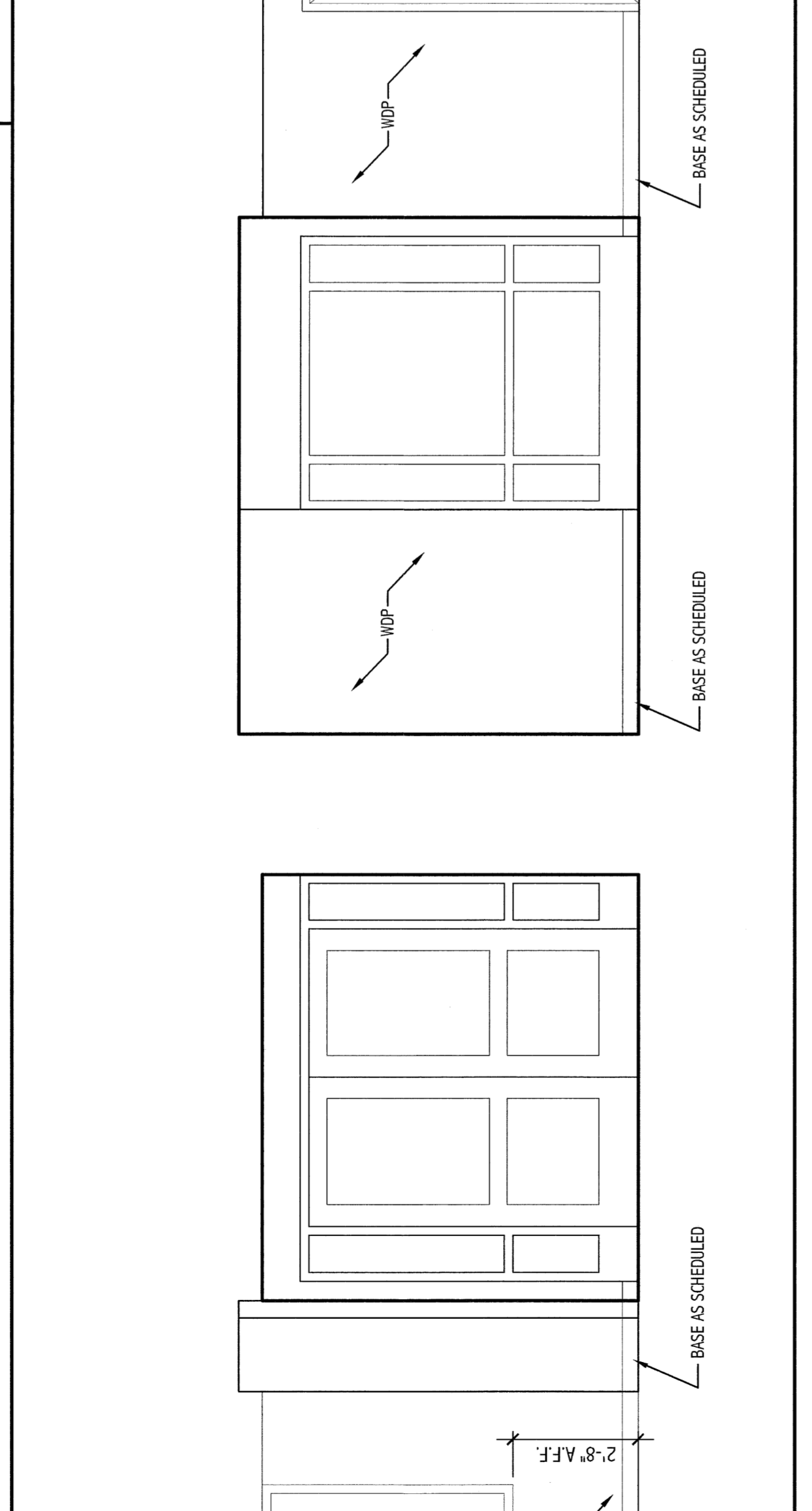
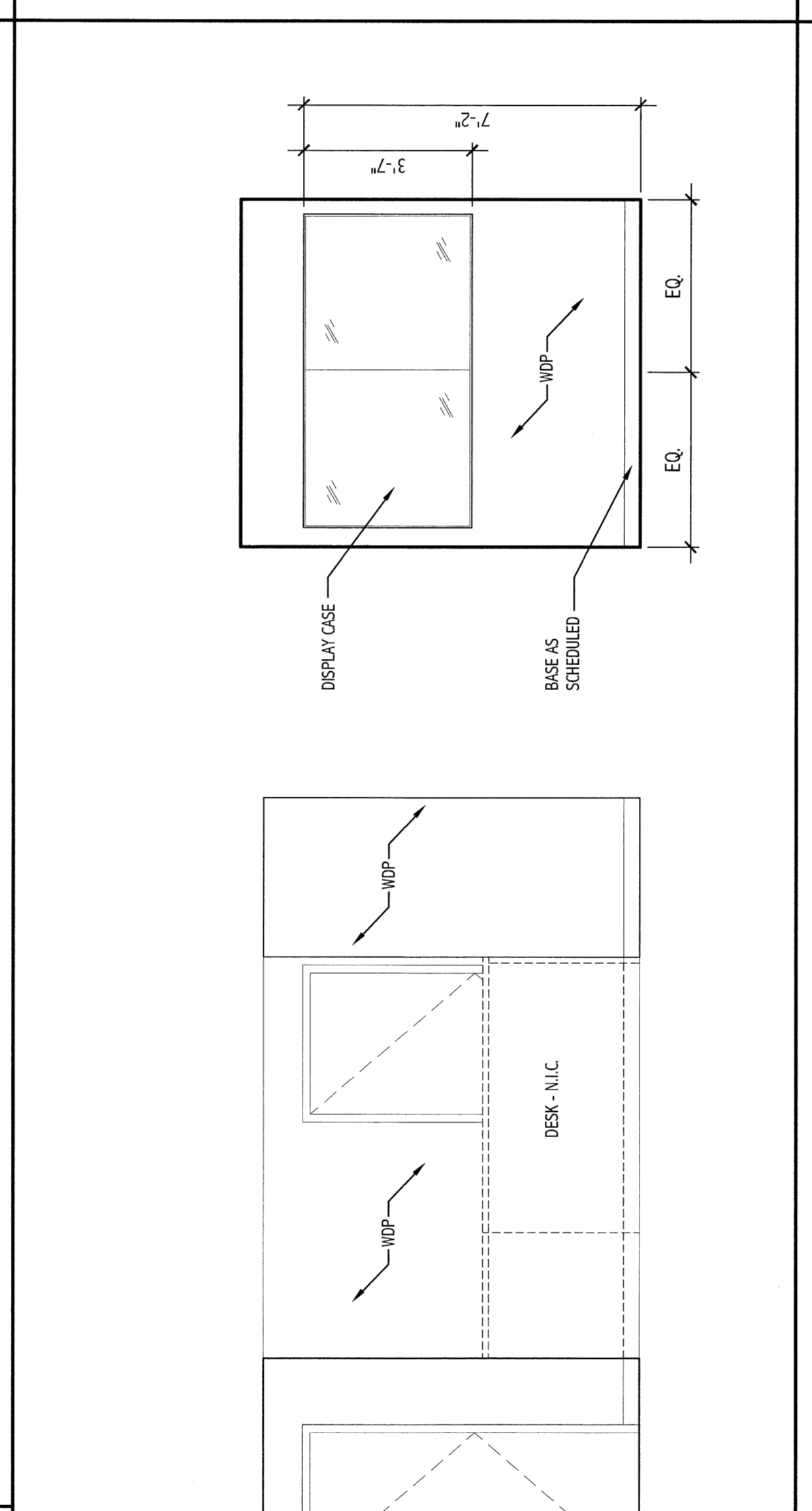
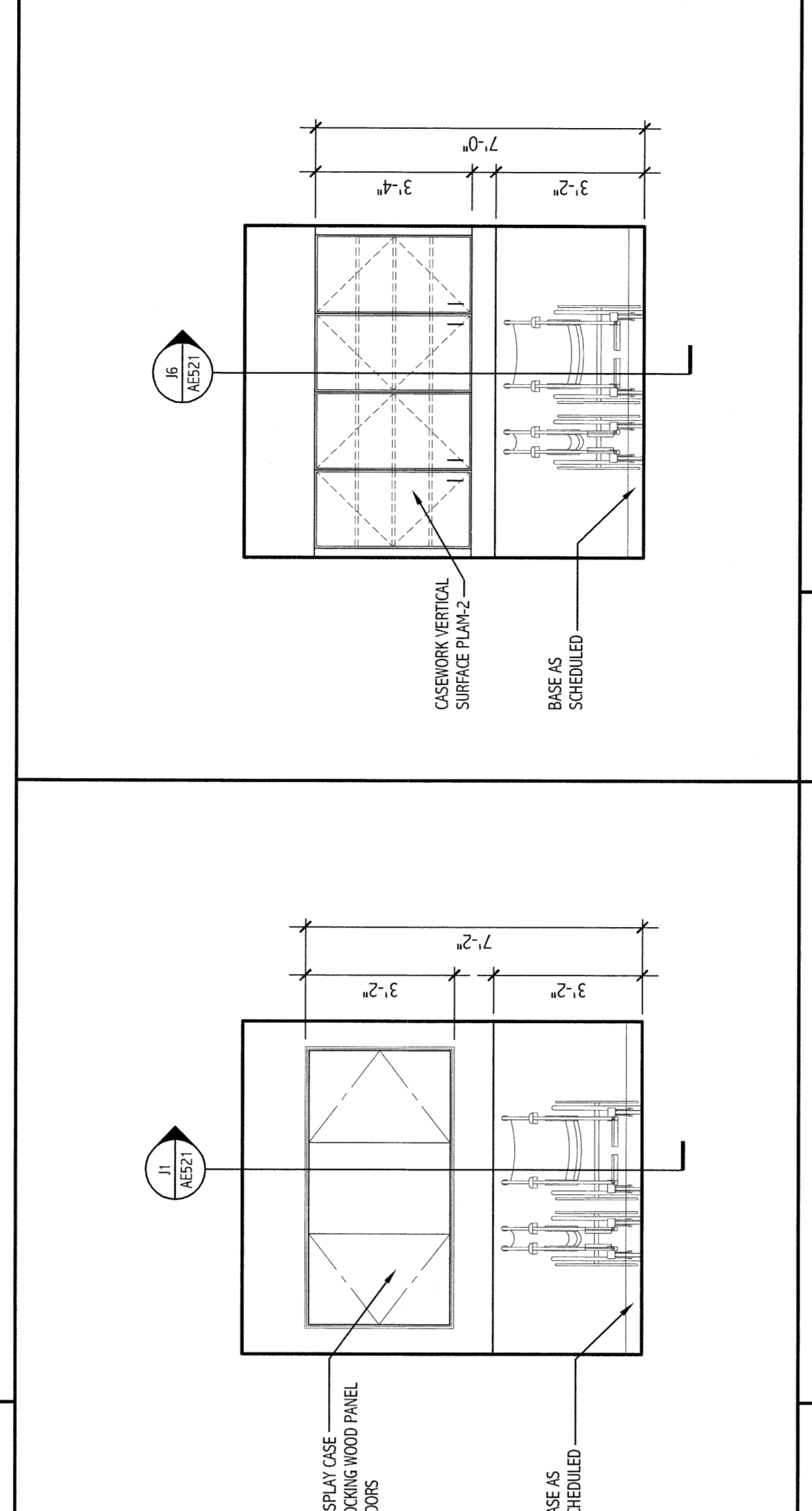
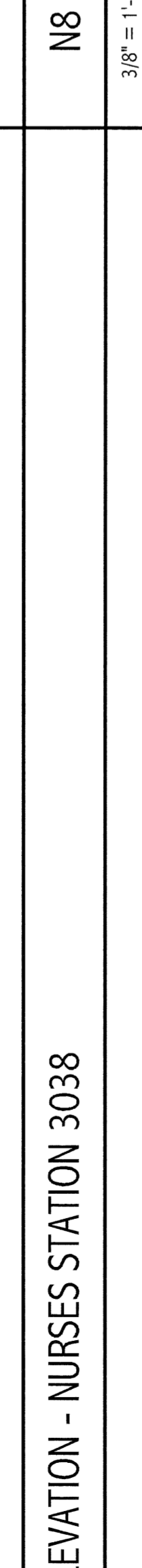
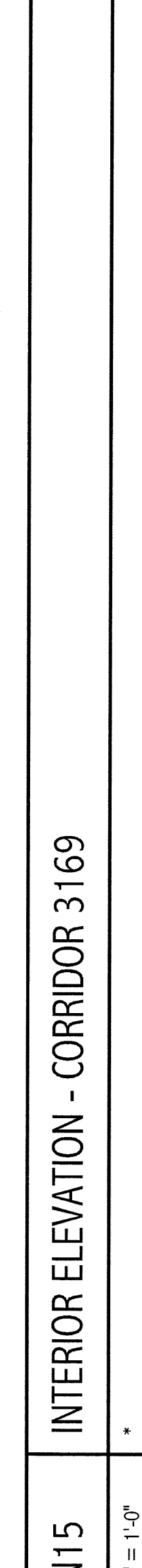
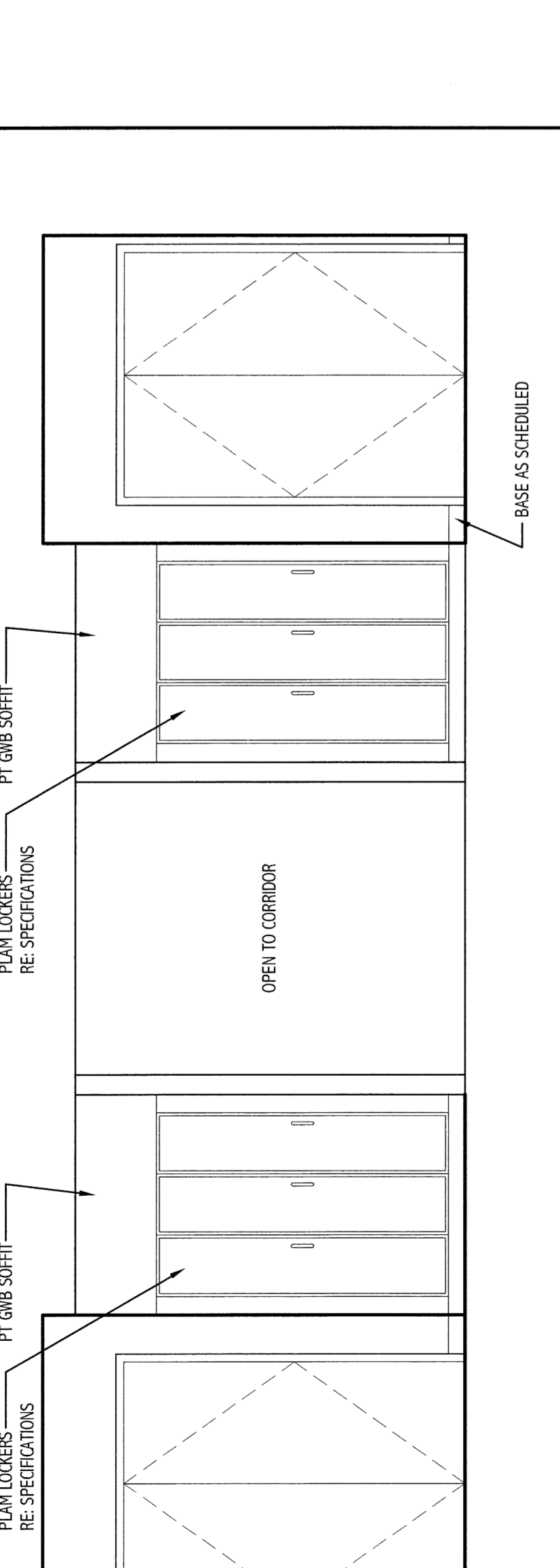
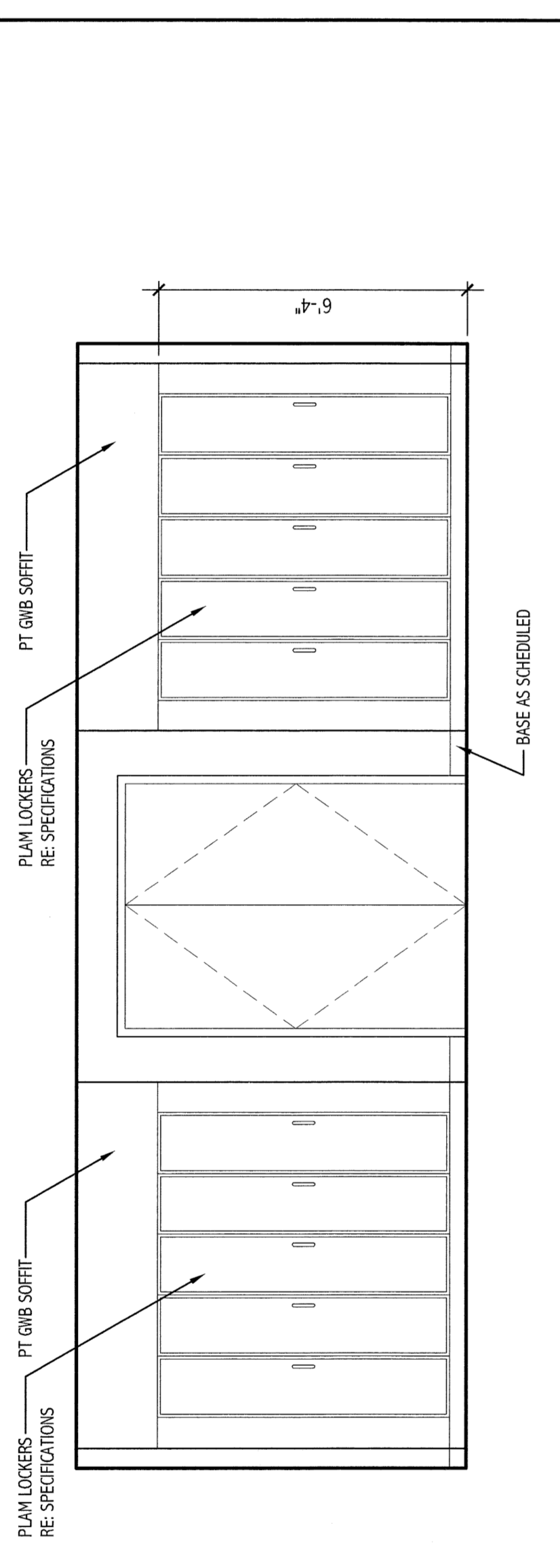
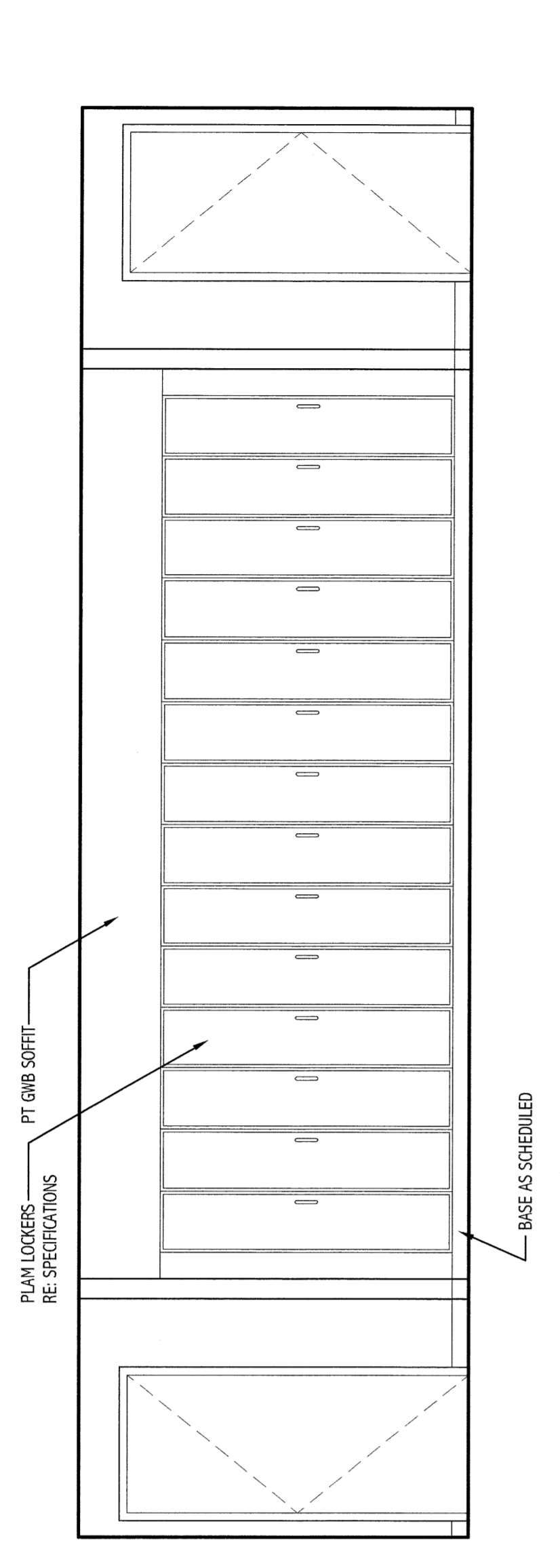
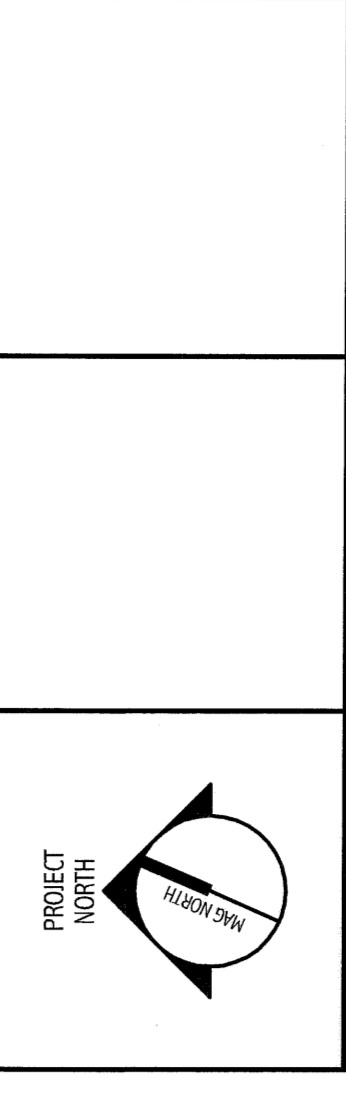

**SMRT**  
 ARCHITECTURE  
 ENGINEERING  
 PLANNING  
 INTERIOR DESIGN  
 COMMISSIONING

MARTIN'S POINT HEALTH CARE  
 MEDICAL OFFICE BUILDING  
 PORTLAND, OREGON

PROJECT No. 08139  
 SHEET No. AE211

PROJECT No. 08139  
 SHEET No. AE211

PROGRESS PRINT