

25 Vine Street
Gardiner, ME
Tel: (207) 582-5252
Fax: (207) 582-1577

Maine Traffic Resources

NO.	DATE	REVISION

Signalization Plan
ROUTE 1/VERANDA STREET & MARTIN'S POINT DRIVE
Portland, Maine

SIGNALIZATION PLAN

Date: 3/30/2019
Drawn By: BSK
Checked By: DIVM
Title: 1 OF 2

SCOPE OF SIGNAL WORK

THIS IS A NEW SIGNAL INSTALLATION. THE INTENT OF THESE PLANS IS TO PROVIDE FOR A MAST ARM INSTALLATION W/VIDEO DETECTION FOR ALL APPROACHES AT THE INTERSECTION. ALL COMPONENTS OF THIS SIGNAL ARE TO BE NEW AND SHALL BE INSTALLED AS SHOWN.

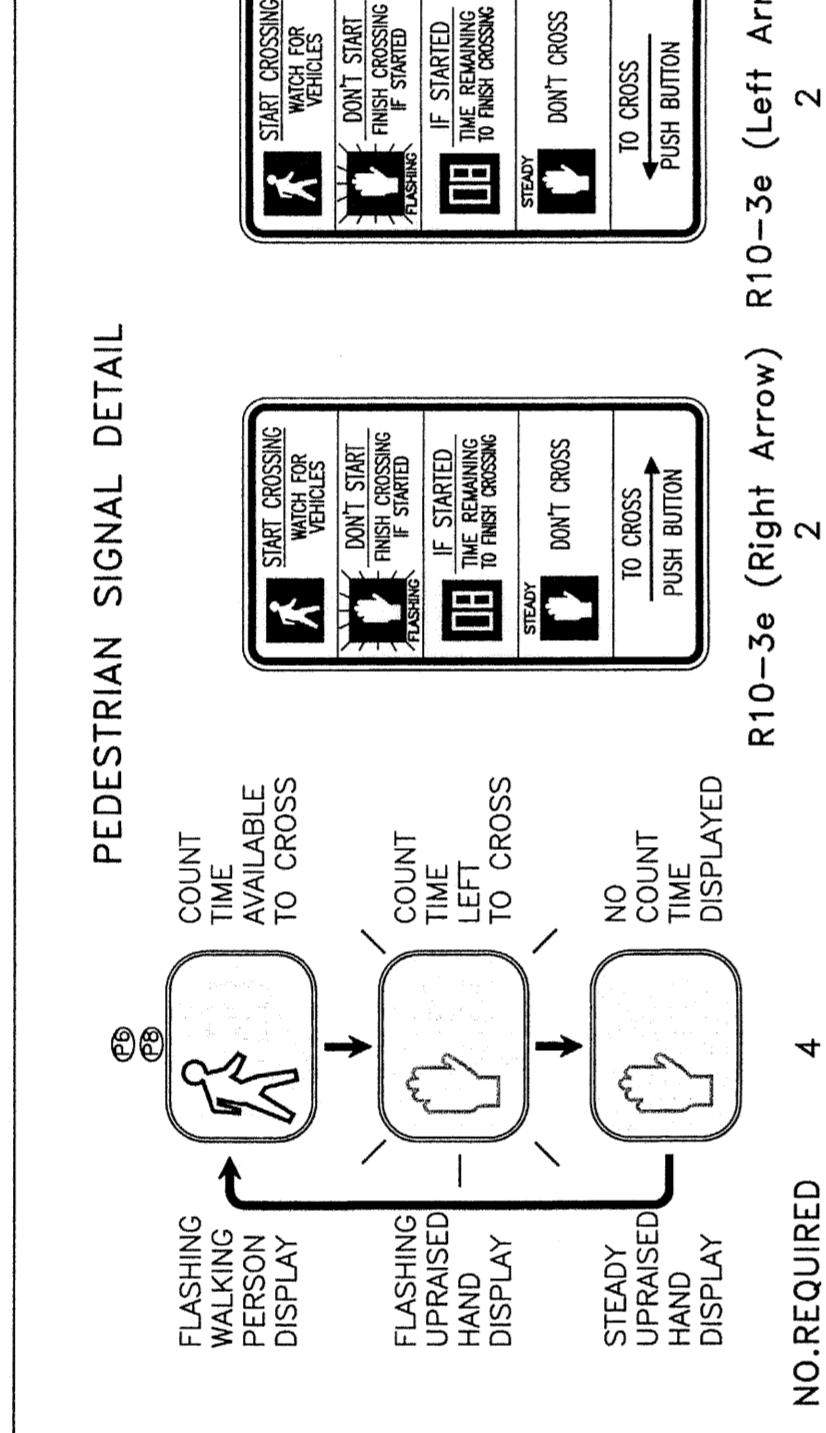
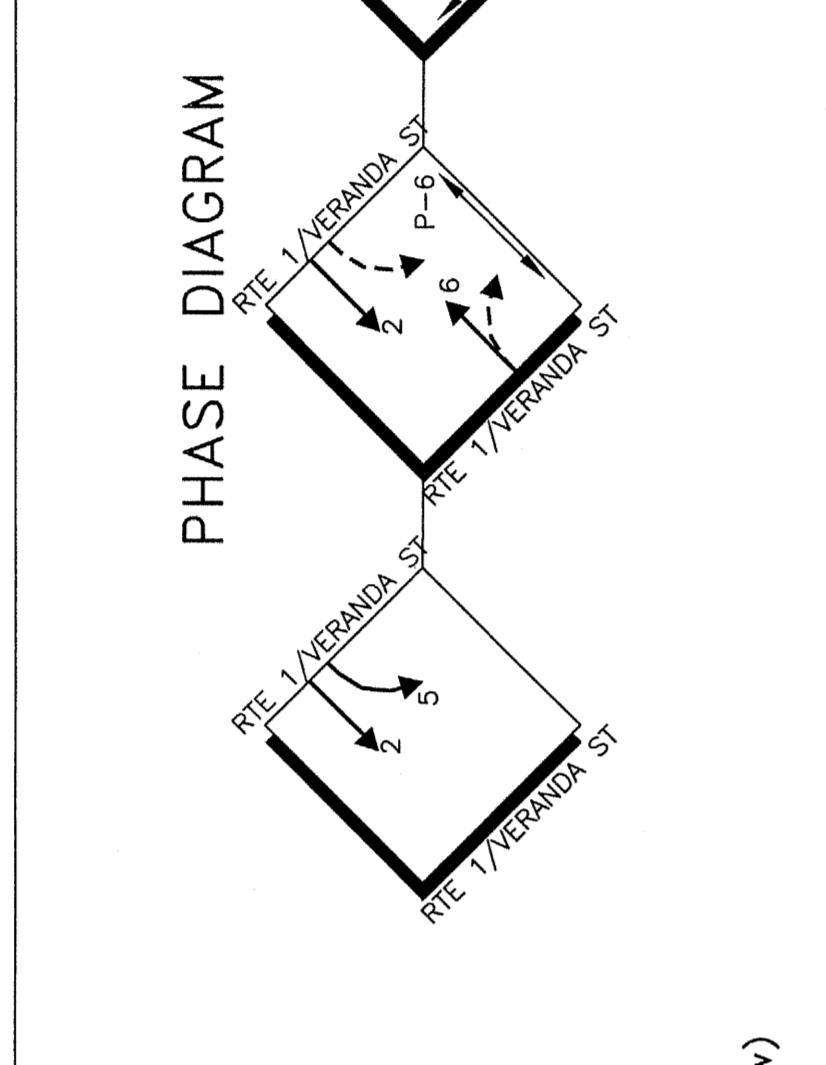
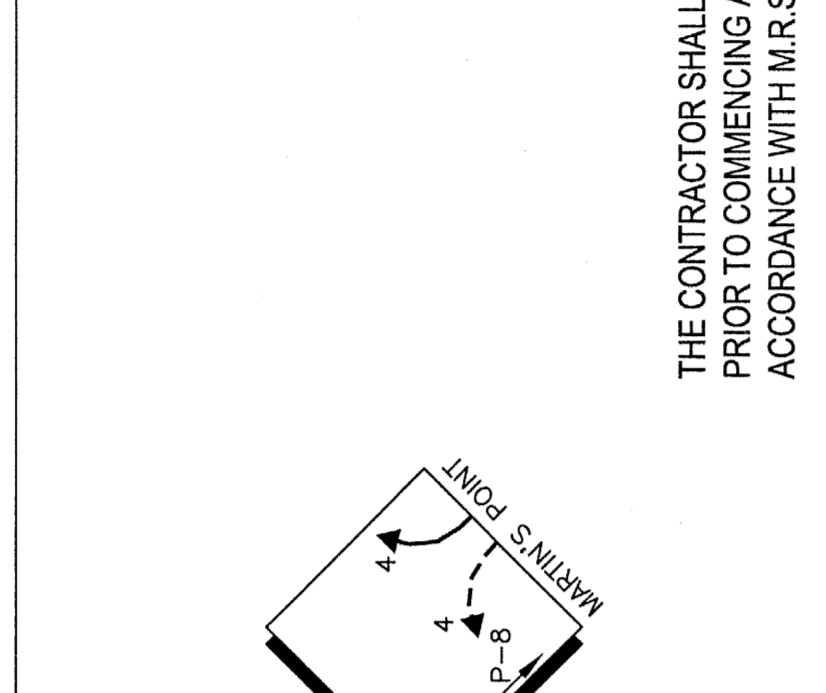

OVERHEAD SIGN DETAIL

NO. REQUIRED 5
ALL NEW SIGNAL FACE DISPLAYS SHALL BE 12" LED.
ALL NEW SIGNAL FACE DISPLAYS SHALL HAVE TUNNEL VISORS
ALL NEW SIGNAL DISPLAYS SHALL HAVE BACKPLATES

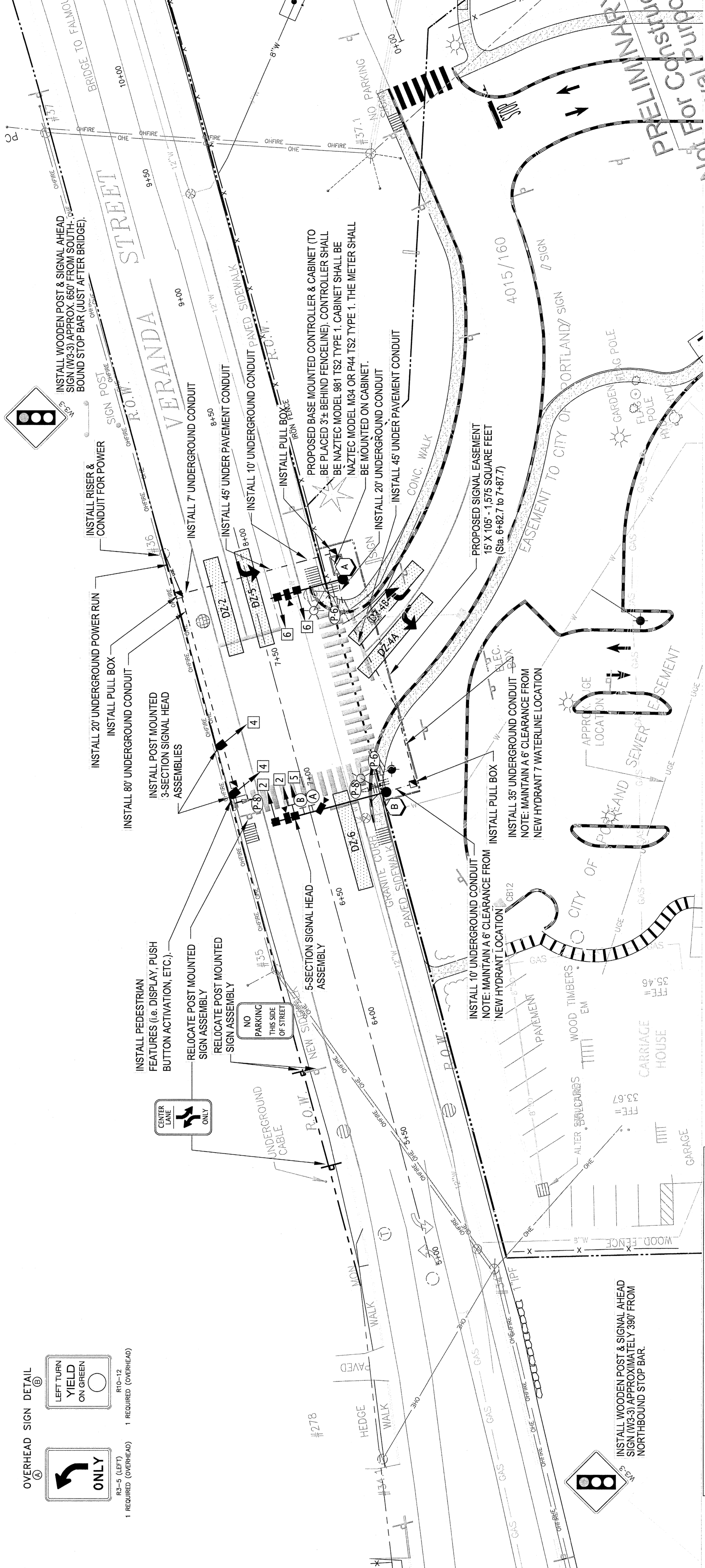

MAST ARM POLES

POLE W/ 30" MAST ARM
WILLUMNAIRE & 1-WAY PEDESTRIAN FEATURES
STA. 7+73.1
(MEASURED TO CENTER OF POLE)

POLE W/ 48" MAST ARM
WILLUMNAIRE & 2-WAY PEDESTRIAN FEATURES
STA. 6+85.7
(MEASURED TO CENTER OF POLE)

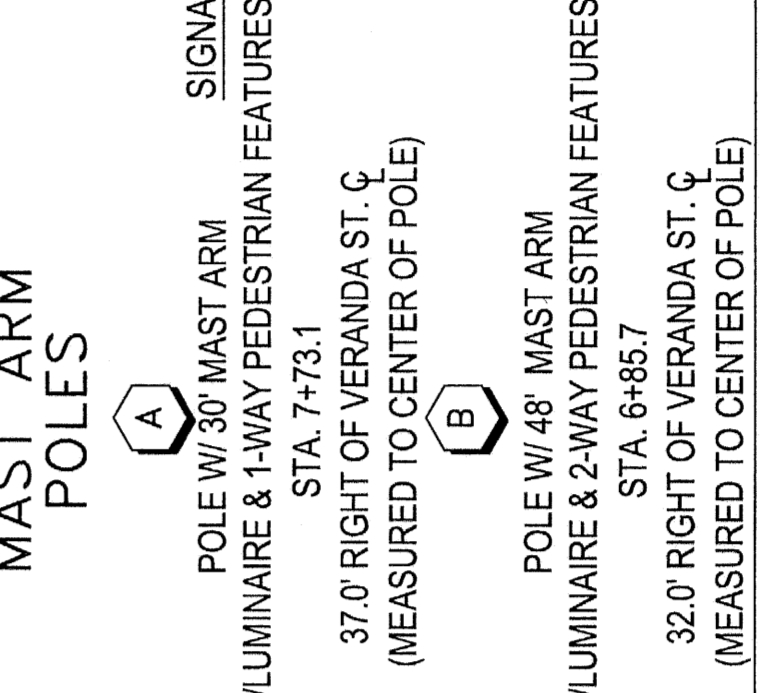

REFER TO SHEET 2 OF 2 FOR SIGNAL NOTES AND DETAILS.
SIGNAL SHALL BE OPERATED IN FLASH MODE A MINIMUM OF TWO WEEKS PRIOR TO STARTUP.

SUGGESTED INITIAL CONTROLLER TIMINGS

MOVEMENT	1	2	3	4	5	6	7	8
MIN. GRN	10	10	10	10	10	10	10	10
MIN. YEL	7.5	7.5	7.5	7.5	7.5	7.5	7.5	7.5
ALL-RED	2.2	2.2	2.2	2.2	2.2	2.2	2.2	2.2
ALL-RED	2.2	2.2	2.2	2.2	2.2	2.2	2.2	2.2
PED. WALK	7	7	7	7	7	7	7	7
PED. CLR	10	10	10	10	10	10	10	10
RECALL	ON	OFF	OFF	ON	ON	ON	ON	ON

MAX SHALL BE GREATER THAN SPIT TIME.
WHEN IN FLASH; 2 & 6 SHALL FLASH YELLOW. ALL OTHER MOVEMENTS SHALL FLASH RED.
MOVEMENTS 2 & 6 SHALL REMAIN GREEN IN THE ABSENCE OF CALLS FROM THE OTHER MOVEMENTS.
TIMINGS ARE INITIAL AND MAY REQUIRE FIELD ADJUSTING AS DIRECTED BY THE CITY OF PORTLAND AND MAINE DOT OR THEIR REPRESENTATIVE.

