

NOTE:

1. FOR LEGEND SEE SHEET G-001.

DEMOLITION KEYED NOTES:

- ① EXISTING SIDING TO BE REMOVED AROUND STRUCTURE. EXISTING EXTERIOR STUD WALL & SHEATHING TO REMAIN. PREPARE SURFACES FOR NEW SIDING.
- ② EXISTING WINDOW TO BE REMOVED AND REPLACED.
- ③ EXISTING EXTERIOR DOOR TO BE REMOVED AND REPLACED.
- ④ REMOVE PORTION OF WALL FOR POCKET DOOR.
- ⑤ REMOVE EXISTING STUDS TO FINISH FLOOR AND PREPARE FOR CONSTRUCTION OF NEW DORMER WALLS.
- ⑥ COMPLETELY DEMOLISH WALLS AND WINDOWS UNLESS NOTED OTHERWISE.
- ⑦ REMOVE AND SALVAGE EXISTING DOOR FOR NEW CONSTRUCTION.
- ⑧ SHORE EXISTING FIRST FLOOR AND REMOVE EXISTING FOUNDATION WALL.

G1 DEMOLITION - SECOND FLOOR PLAN
SCALE: 1/4" = 1'-0"

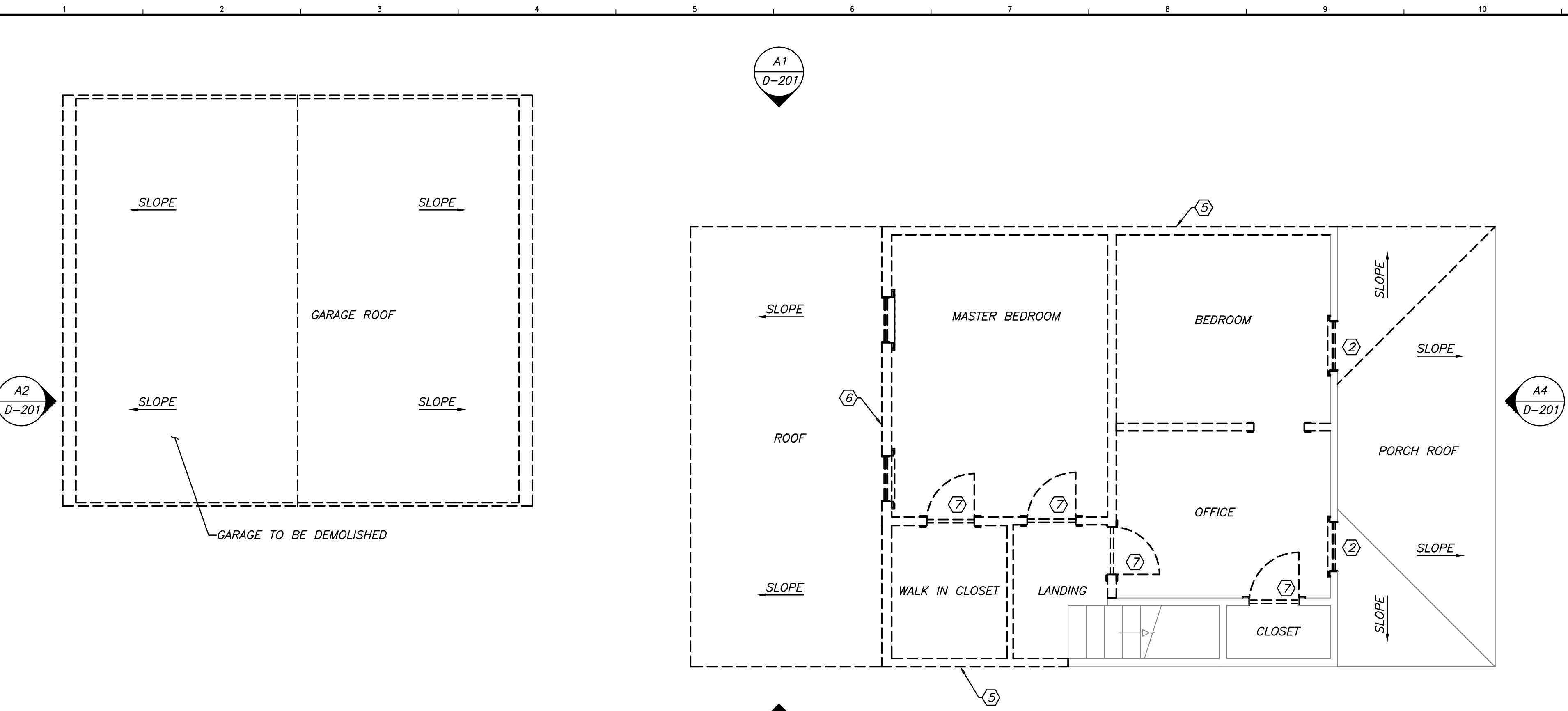

A1 DEMOLITION - FIRST FLOOR PLAN
SCALE: 1/4" = 1'-0"

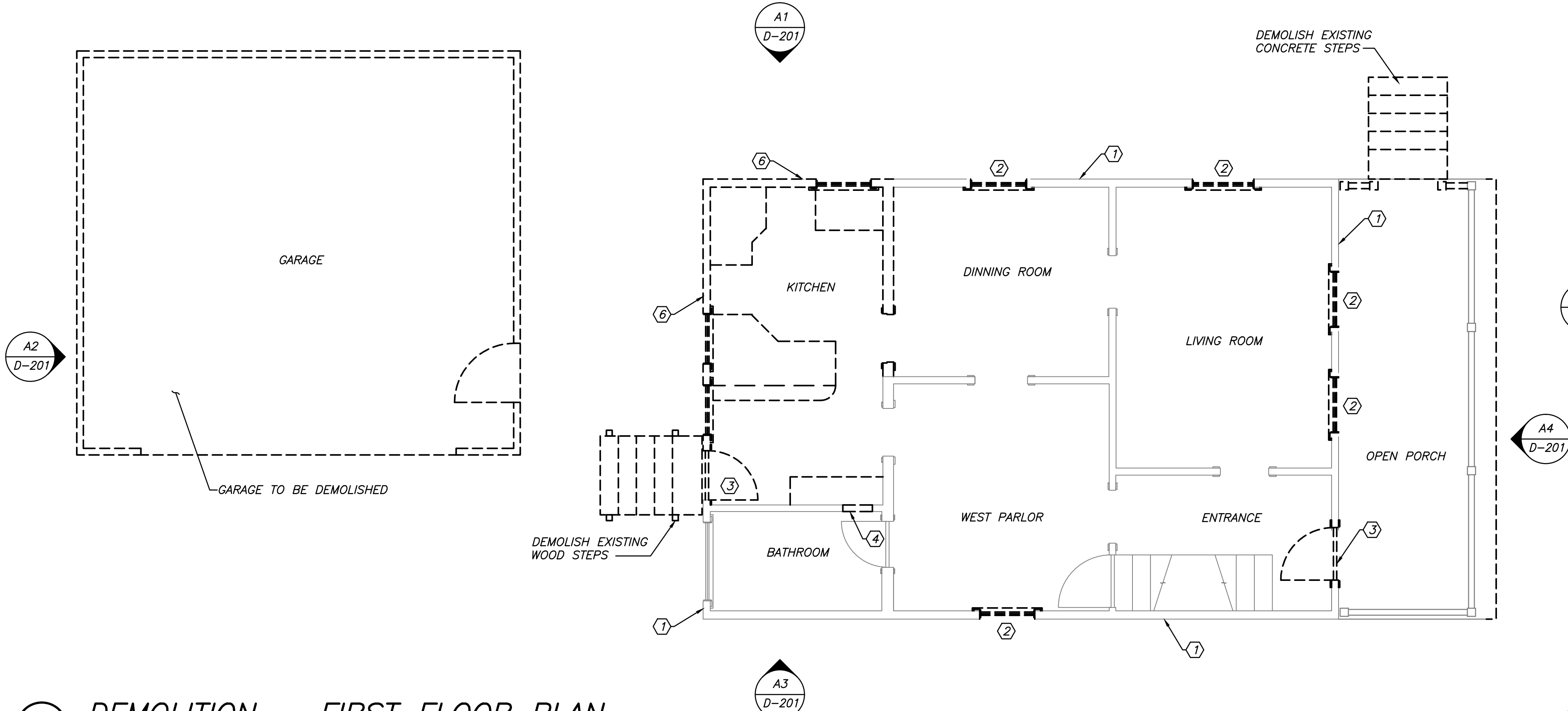

A1 DEMOLITION - BASEMENT FLOOR PLAN
SCALE: 1/4" = 1'-0"

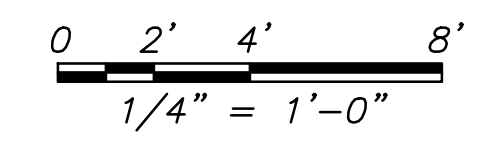
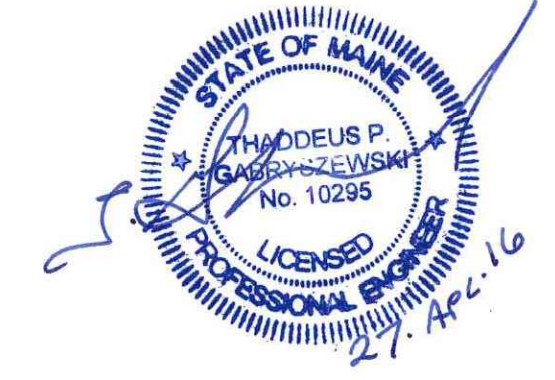
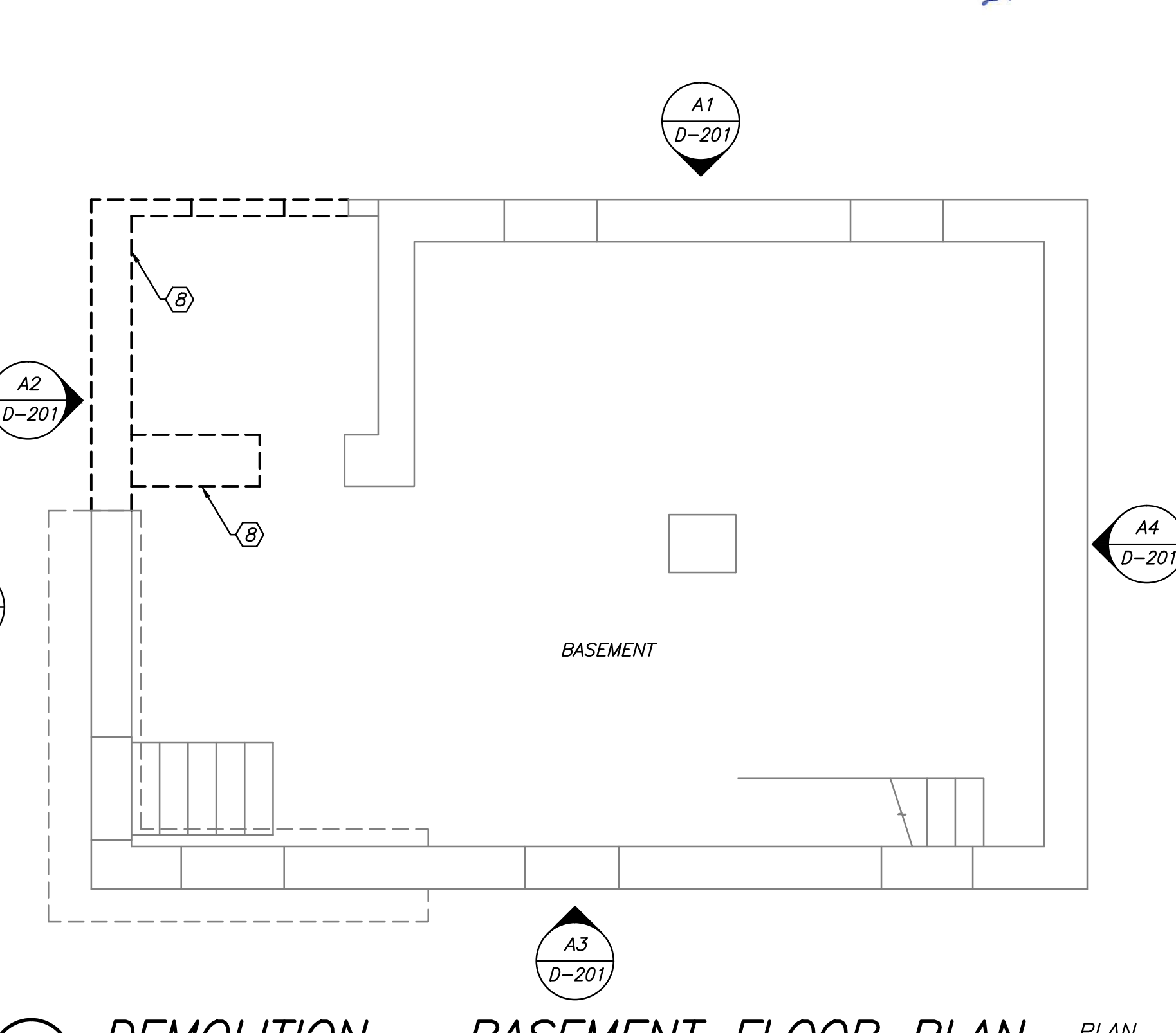

DATE	NO	REMARKS
04/27/16	0	BUILDING PERMIT APPLICATION

GRAPHIC SCALE:
 0" = 1"
 CODE: IRC 2009
 TOWN: PORTLAND
 DATE: APRIL 2016
 SCALE: AS NOTED
 DRAWN BY: JJD
 TITLE:
 DEMOLITION
 FLOOR
 PLANS
 FILE: 0020101
 DRAWING NO:
 D-101
 SHEET: 5 OF 20