

DISPLAY THIS CARD ON PRINCIPAL FRONTAGE OF WORK
CITY OF PORTLAND

Please Read
Application And
Notes, If Any,
Attached

BUILDING DEPARTMENT

PERMIT

Permit Number: 070946

This is to certify that Albee Todd S & Parker B Albee Jr / no contractor / self
 has permission to amend permit 05-0608 - add entry door
 AT 10 Helene St 433 C008001

provided that the person or persons, firm or corporation accepting this permit shall comply with all of the provisions of the Statutes of the State and of the Ordinances of the City of Portland regulating the construction, maintenance and use of buildings and structures, and of the application on file in this department.

Apply to Public Works for street line and grade if nature of work requires such information.

Notification of inspection must be given and when permission procured before this building or part thereof is laid or closed-in.
 HOUR NOTICE IS REQUIRED.

A certificate of occupancy must be procured by owner before this building or part thereof is occupied.

OTHER REQUIRED APPROVALS	
Fire Dept.	
Health Dept.	AUG - 7 2007
Appeal Board	
Other	
CITY OF PORTLAND	

Department Name

Director - Building & Inspection Services

PENALTY FOR REMOVING THIS CARD

City of Portland, Maine - Building or Use Permit Application

389 Congress Street, 04101 Tel: (207) 874-8703, Fax: (207) 874-8716

Permit No: 07-0946	Issue Date: AUG - 7 2007	GBL: 433 C008001
-----------------------	-----------------------------	---------------------

Location of Construction: 10 Helene St	Owner Name: Albee Todd S & Parker B Albee Jr	Owner Address: 10 Helene St	Phone:
Business Name:	Contractor Name: no contractor / self	Contractor Address: Portland	Phone:
Lessee/Buyer's Name	Phone:	Permit Type: Amendment to Single Family	Zone: R-5

Past Use: single family	Proposed Use: single family - amend permit 05-0608 - add entry door	Permit Fee: \$30.00	Cost of Work: \$0.00	CEO District: 4
-----------------------------------	---	-------------------------------	--------------------------------	---------------------------

Proposed Project Description:
amend permit 05-0608 - add entry door

FIRE DEPT: <input type="checkbox"/> Approved <input checked="" type="checkbox"/> Denied Signature: <i>[Signature]</i>	INSPECTION: Use Group: R-3 Type: SB Signature: <i>[Signature]</i>
PEDESTRIAN ACTIVITIES DISTRICT (P.A.D.)	
Action: <input type="checkbox"/> Approved <input type="checkbox"/> Approved w/Conditions <input type="checkbox"/> Denied	
Signature: _____ Date: _____	

Permit Taken By: tmm	Date Applied For: 08/07/2007	Zoning Approval	
--------------------------------	--	------------------------	--

<ol style="list-style-type: none"> This permit application does not preclude the Applicant(s) from meeting applicable State and Federal Rules. Building permits do not include plumbing, septic or electrical work. Building permits are void if work is not started within six (6) months of the date of issuance. False information may invalidate a building permit and stop all work.. 	Special Zone or Reviews <input checked="" type="checkbox"/> Shoreland <i>Amend. permit 30% expansion permitted</i> <input type="checkbox"/> Wetland <input checked="" type="checkbox"/> Flood Zone <i>Zone AE Panel 7-B</i> <input type="checkbox"/> Subdivision <input type="checkbox"/> Site Plan Maj <input type="checkbox"/> Minor <input type="checkbox"/> MM <input type="checkbox"/> Date: <i>8/7/07</i>	Zoning Appeal <input type="checkbox"/> Variance <input type="checkbox"/> Miscellaneous <input type="checkbox"/> Conditional Use <input type="checkbox"/> Interpretation <input type="checkbox"/> Approved <input type="checkbox"/> Denied Date: _____	Historic Preservation <input checked="" type="checkbox"/> Not in District or Landmark <input type="checkbox"/> Does Not Require Review <input type="checkbox"/> Requires Review <input type="checkbox"/> Approved <input type="checkbox"/> Approved w/Conditions <input type="checkbox"/> Denied Date: <i>8/7/07</i>
---	---	---	--

CERTIFICATION

I hereby certify that I am the owner of record of the named property, or that the proposed work is authorized by the owner of record and that I have been authorized by the owner to make this application as his authorized agent and I agree to conform to all applicable laws of this jurisdiction. In addition, if a permit for work described in the application is issued, I certify that the code official's authorized representative shall have the authority to enter all areas covered by such permit at any reasonable hour to enforce the provision of the code(s) applicable to such permit.

SIGNATURE OF APPLICANT	ADDRESS	DATE	PHONE
RESPONSIBLE PERSON IN CHARGE OF WORK, TITLE		DATE	PHONE

City of Portland, Maine - Building or Use Permit

389 Congress Street, 04101 Tel: (207) 874-8703, Fax: (207) 874-8716

Permit No: 07-0946	Date Applied For: 08/07/2007	CBL: 433 C008001
------------------------------	--	----------------------------

Location of Construction: 10 Helene St	Owner Name: Albee Todd S & Parker B Albee Jr	Owner Address: 10 Helene St	Phone:
Business Name:	Contractor Name: no contractor / self	Contractor Address: Portland	Phone:
Lessee/Buyer's Name	Phone:	Permit Type: Amendment to Single Family	

Proposed Use: single family - amend permit 05-0608 - add entry door	Proposed Project Description: amend permit 05-0608 - add entry door
---	---

Dept: Zoning **Status:** Approved **Reviewer:** Tammy Munson **Approval Date:** 08/07/2007
Note: **Ok to Issue:**

Dept: Building **Status:** Approved with Conditions **Reviewer:** Tammy Munson **Approval Date:** 08/07/2007
Note: **Ok to Issue:**

- 1) Permit approved based on the plans submitted and reviewed w/owner/contractor, with additional information as agreed on and as noted on plans.

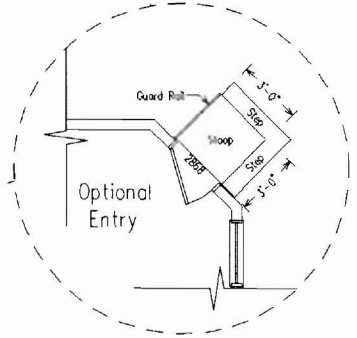
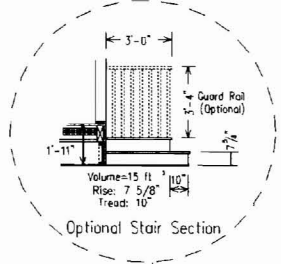
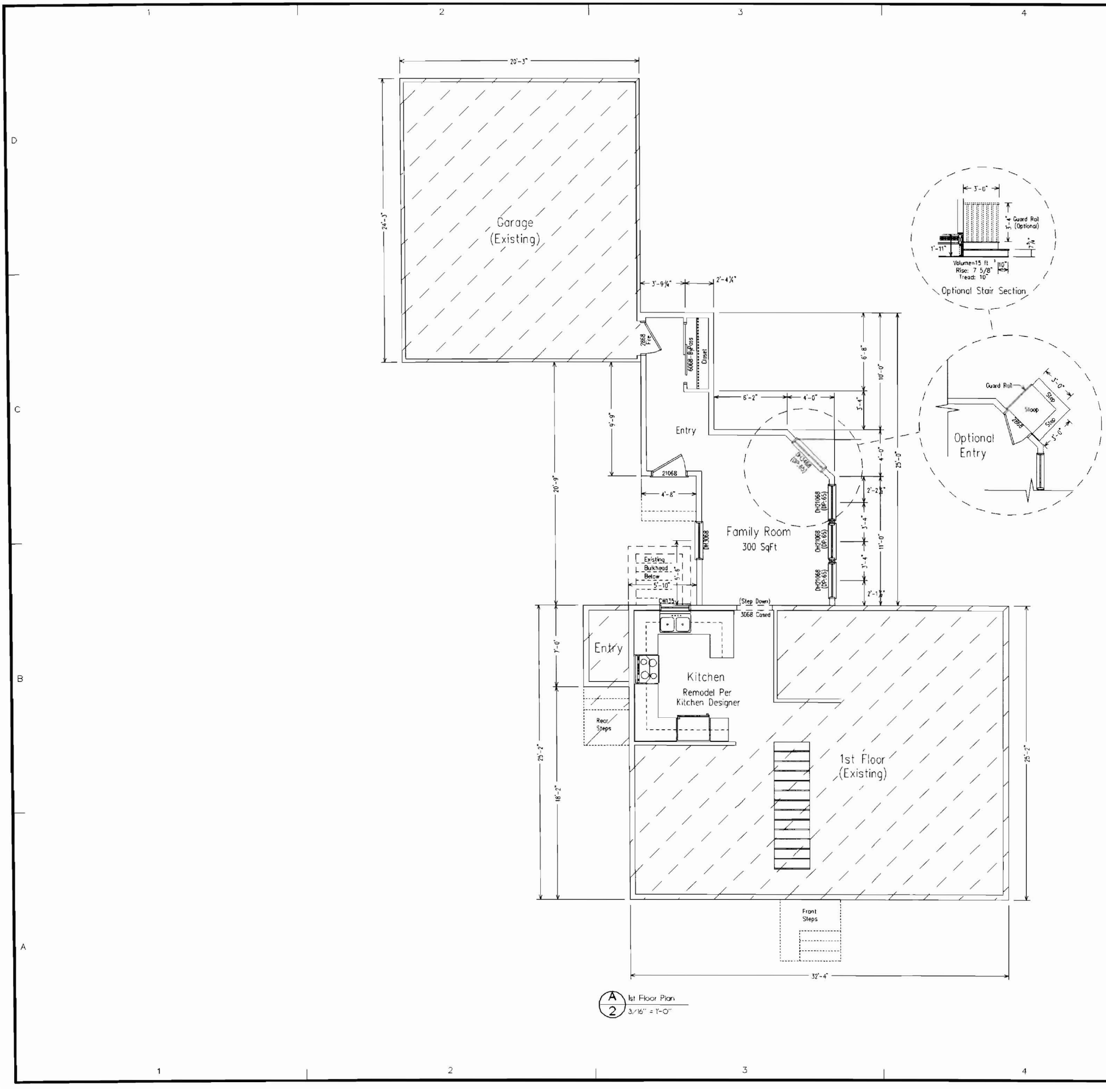

A 1st Floor Plan
2 3/16" = 1'-0"