

# PROPOSED PORCH

FRAME (2x6 P.T. @ 16" O.C. with joist hangers)

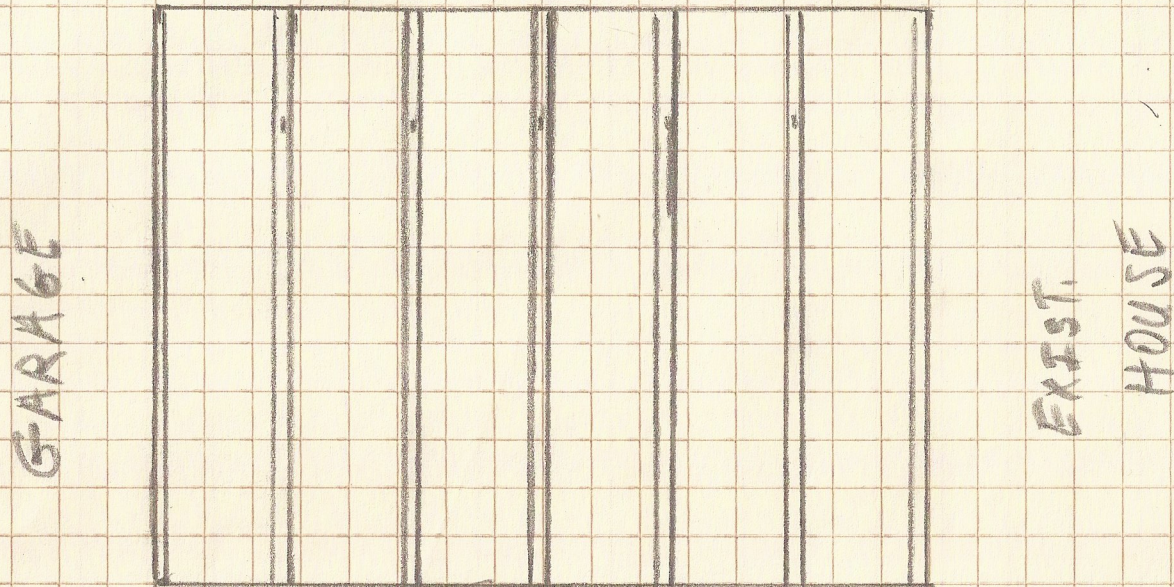

Notes: 1. No Footings or Structural Foundations or Piers needed

SCALE

$\frac{1}{2}'' = 1 \text{ ft.}$

2. PORCH TO BE Attached to surrounding structures on three sides using structural screws.
3. Stairs to BE attached to Porch and rest on grade. (no footings)