

NOT TO SCALE -
see scaled
plans
received 11/14/05

11/14/05
22' x 80' = 1760
15' x 60' = 900
1760 + 900 = 2660

15' long Bldg
72.5'

72.5' x 74' = 5365
5365 ÷ 400 = 13.41
13 pkgs

30 pkgs spaces shown
013 pkgs

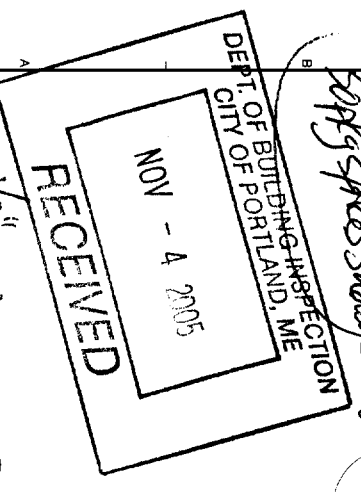

1/8" scale per Catherine Farnham, PE 11/14/05

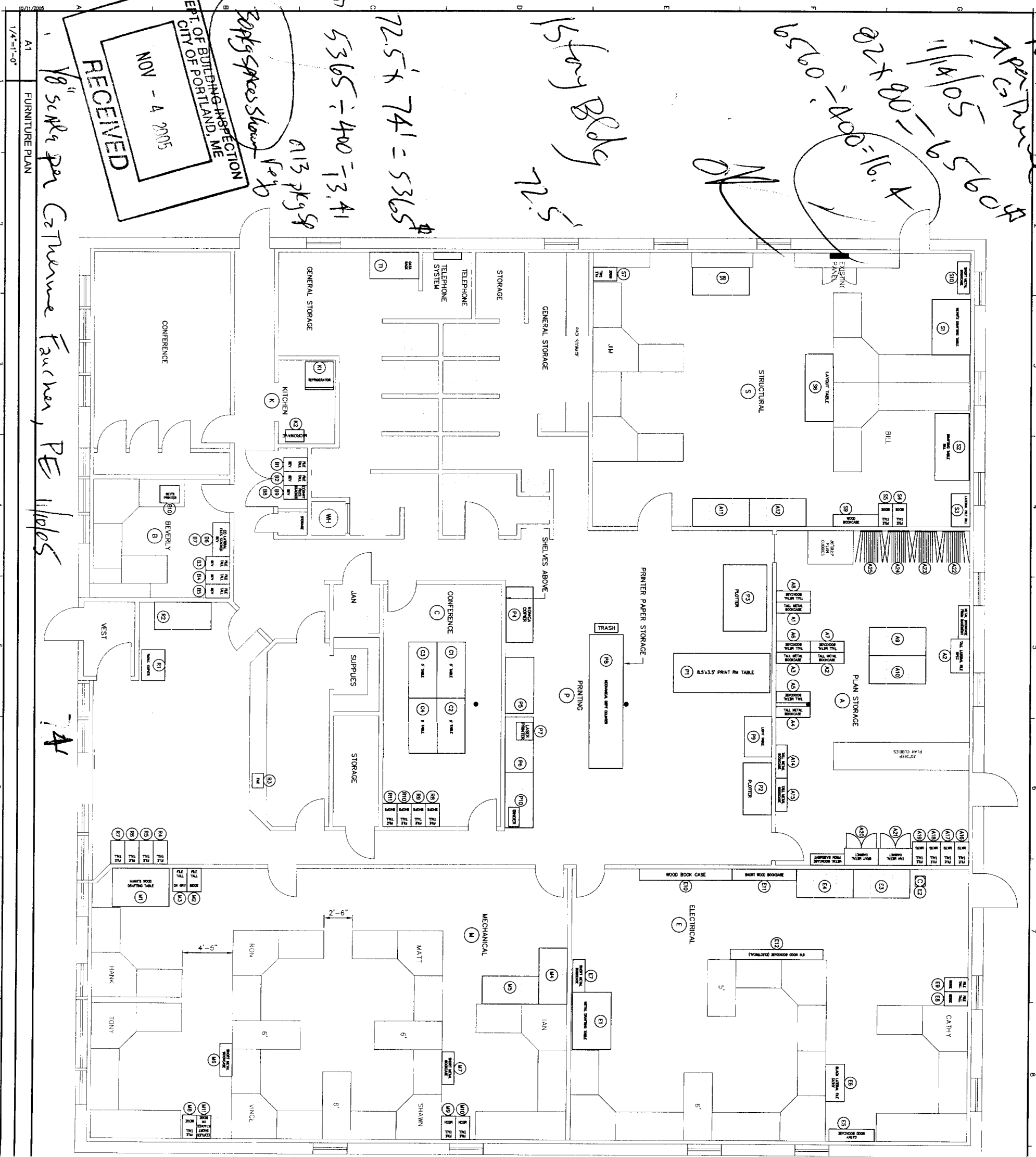

FURNITURE PLAN

NEW ALLIED OFFICE BUILDING

Date: 10/11/2005
Drawn By: DLL
Checked By: CAF
Project Mgr: CAF
Project No:
Cad me:
Graphic Scale: 0

REVISIONS

NUMBER	DATE	BY	DESCRIPTION

a11ied engineering, inc.
FULL SERVICE CONSULTING ENGINEERS
STRUCTURAL • MECHANICAL • ELECTRICAL • TECHNOLOGY
ENVIRONMENTAL SERVICES • CONSTRUCTION ADMINISTRATION
One Westbrook Common, Westbrook, Maine 04092-2804
Telephone: 207-854-8128 • Fax: 207-854-0803
E-Mail: info@a11ied-eng.com • www.a11ied-eng.com



F.1

© COPYRIGHT 2005 ALLIED ENGINEERING, INC.