

PFS Corporation
 Northeast Region
 APPROVED
 H Raup - 3
 2/27/15
 Approval limited to
 Factory Built Portion

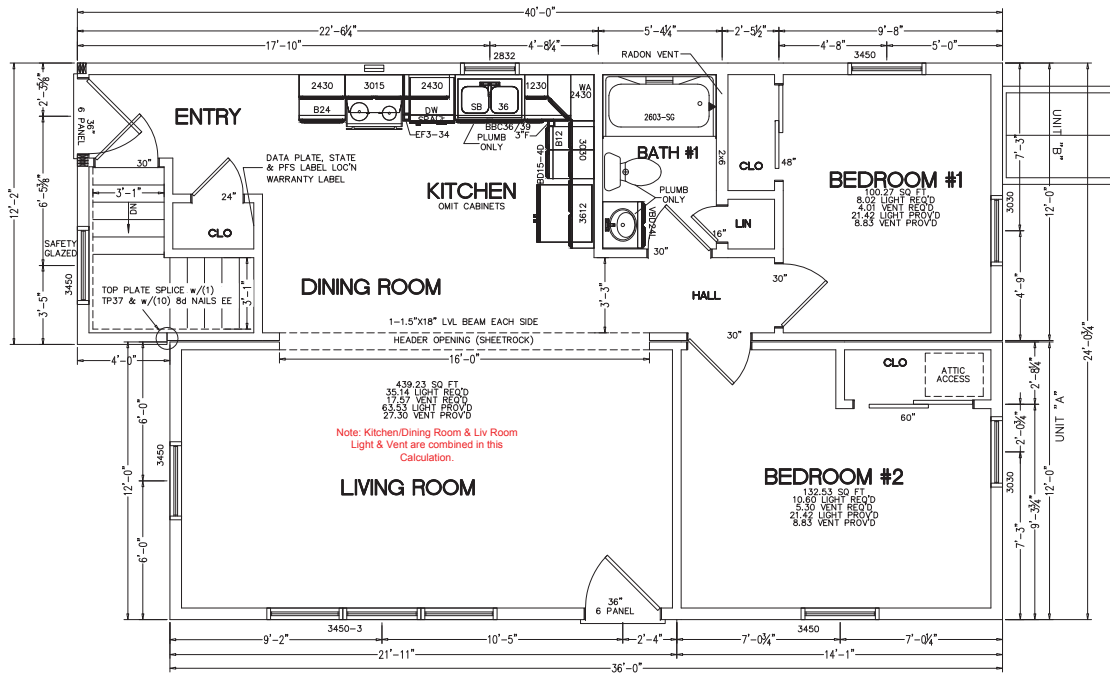

- NOTES:
- 2x6 EXT WALLS @ 24" O.C./2x4 MARR WALLS @ 24" O.C. (EXCEPT AS NOTED)
 - 8'-0" CLG HT.
 - 2x8 SFP#2 FLOOR JOISTS @ 16" O.C.
 - ROOF SYSTEM TO BE 24" O.C.
 - ALSID NEW CONSTRUCTION 0100 SERIES SINGLE HUNG WINDOWS
 - BASED ON <100 MPH WIND LOAD & EXPOSURE "B"
 - SITE LOCATION: PORTLAND, ME.; CUMBERLAND COUNTY; 50 PSF GROUND SNOW LOAD
 - Bldr. INSTALLED HEATING SYSTEM DESIGN & MATERIAL SUPPLIED BY OTHERS

6-11 1/2" HEADER HEIGHT

PARADIGM WINDOW SCHEDULE							
WINDOW CALL SIZE	UNIT SIZE	ROUGH OPENING	TYPE	LIGHT FT.	VENT FT.	SQ. FT.	U-VALUE
2832	31 1/2" x 37 1/2"	32 1/2" x 38 1/2"	SH 0100 NC	6.73	2.9	8.7	0.30
3030	35 1/2" x 35 1/2"	36 1/2" x 36 1/2"	SH 0100 NC	7.22	2.73	9.0	0.30
* 3450	39 1/2" x 59 1/2"	40 1/2" x 60 1/2"	SH 0100 NC	14.2	6.1	17.0	0.30

NOTE: SAFETY GLAZING TO BE PROVIDED FOR WINDOWS IN HAZARDOUS LOCATIONS
 NOTE: WINDOWS ARE NFRC RATED
 *MEETS EGRESS REQUIREMENTS

STANDARD - EXTERIOR (NSWING) DOOR SCHEDULE							
DOOR CALL SIZE	WIDTH	HEIGHT	ROUGH OPENING	MATERIAL	MANUFACTURER	TYPE	U-VALUE
3068 6-PNL	3'-0"	6'-8"	38 1/2" x 82 1/2"	INSUL. CORE	THERMA-TRU	EXT HINGED	.16

MAINE ENERGY SPECIFICATION TABLES

MINIMUM INSUL. R-VALUES		MAXIMUM U-FACTORS	
CEILINGS	R-38	ENTRANCE DOORS	.35
ROOF/CEILINGS	R-38	SPECIALTY DOORS	.45
WALLS	R-19	WINDOWS	.35
FLOORS	R-19	SKYLIGHTS	.60

HOUSE TO BE BUILT OVER UNCONDITIONED SPACE. BUILDER IS RESPONSIBLE TO PROVIDE & INSTALL FLOOR INSULATION ON THE 1ST FLOOR PER THE MAINE ENERGY CODE. THE BUILDER ALSO REQUIRED TO PROVIDE & INSTALL A DOOR SWEEP & WEATHER STRIPPING AT BASEMENT DOOR. EXCEL TO PROVIDE & INSTALL R-11 INSULATION IN WALLS AND R-19 INSULATION IN THE CEILING OF ANY BASEMENT STAIR ENCLOSURES.

- ADDITIONAL MAINE REQUIREMENTS**
- * SET MANUAL MUST BE IN RESIDENCE.
 - * COPY OF APPROVED SETS MUST BE IN RESIDENCE.
 - * WINDOWS REQUIRE ARGON UPGRADE TO MEET MAINE U-FACTOR REQUIREMENTS.

FOR THE STATE OF MAINE, FOR BASEMENTS HEIGHTS FROM 7'-3" TO 8'-0" BASEMENT STAIRS ARE A COMPONENT OF THIS DESIGN WITH A MAXIMUM RISER HEIGHT OF 8-1/4". A MINIMUM TREAD DEPTH OF 9" AND A 1" NOSING WILL BE PROVIDED ON ALL TREADS WITH TREAD WIDTH LESS THAN 10".

RANGE SHALL BE EQUIPPED WITH A SEPARATE FAN/HOOD WITH A MIN. RATING OF 100 CFM. EACH BATHROOM WILL BE EQUIPPED WITH A SEPARATE VENTILATING FAN THAT HAS A MIN. RATING OF 50 CFM AND BE RATED FOR SOUND AT A MAX. SOUND RATING OF 3 SONE. ALL RANGE & BATH FANS TO BE VENTED TO THE EXTERIOR.

PER MAINE RADON REQUIREMENTS, THE RADON PIPE SHALL BE A MIN. 12" ABOVE THE ATTIC SPACE AND HAVE A 36" HIGH BY 24" DIAMETER CLEARANCE FOR COMPLETION.

- MAINE**
- 2009 INTERNATIONAL RESIDENTIAL CODE w/EXCEPTIONS
 - 2011 NFPA 31, STD FOR THE INSTALLATION OF OIL BURNING EQUIP
 - 2009 NFPA 54, NATIONAL FUEL GAS CODE
 - 2011 NFPA 70, NATIONAL ELECTRIC CODE w/EXCEPTIONS
 - 2010 NFPA 211 STANDARDS FOR CHIMNEYS, FIREPLACES, VENTS AND SOLID FUEL BURNING APPLIANCES
 - 2009 UNIFORM PLUMBING CODE w/EXCEPTIONS
 - 2011 STATE OF MAINE OIL AND SOLID FUEL BOARD LAW AND RULES
 - 2011 NATIONAL ELECTRIC CODE w/EXCEPTIONS

PTL#: Kim 4355 ME
 PD □ ON □ SN □ SO

BUILDER: MTR DEV., LLC

CUSTOMER/PROJECT: COPE



THIS DRAWING WAS EXTRACTED FROM APPROVED PLANS AND/OR APPROVED SYSTEMS DRAWINGS

NAME: DATE:

THIS DRAWING AND DESIGN IS THE PROPERTY OF EXCEL HOMES GROUP, LLC. ANY REPRODUCTION OF THE DRAWING OR DESIGN IS PROHIBITED WITHOUT THE EXPRESS WRITTEN CONSENT OF EXCEL HOMES GROUP, LLC.

ADJUSTMENTS MADE FOR CODE COMPLIANCE AND PRODUCTION CAPABILITY.

DRAWING MAY BE REVERSED

DRAWN: CHECKED: WNC
 SLP
 SLP

DESCRIPTION

DATE: 1-28-15
 NO: PD1 1-28-15
 PD2 1-28-15

DRAWING TITLE: FIRST FLOOR PLAN

SCALE: NTS SHEET: 3