

STANDARD MATERIAL LIST (UNLESS OTHERWISE NOTED)

FLOORING:
 JOISTS: SEE FRAMING PLAN
 SHEATHING: 3/4" ADVANTECH (GLUED AND SCREWED OR Nailed)
 FINISH: 1/2" GYPSUM BOARD PER CODE
 INSULATION: SEE INSULATION

WALLS:
 STUDS (EXTERIOR): 2x4 @ 16" O.C.
 STUDS (INTERIOR): 2x4 @ 16" O.C.
 FINISH: 1/2" GYPSUM BOARD PER CODE
 AIR BARRIER: TYVEK OR EQUIVALENT, NOT RIGID W/ZIP SYSTEM
 SINKING: UNK. CLIPBOARD
 VAPOR BARRIER: 6 MIL POLYETHYLENE
 INTERIOR FINISH (GARAGE): 5/8" TYPE "X" GYPSUM BOARD PER CODE
 INSULATION: SEE INSULATION

CEILING:
 JOISTS: SEE FRAMING PLAN
 INTERIOR FINISH: 1/2" GYPSUM BOARD PER CODE
 VAPOR BARRIER: 6 MIL POLYETHYLENE (EXTERIOR EXPOSURE ONLY)
 INSULATION: SEE INSULATION

ROOF:
 RAFTERS: SEE FRAMING PLAN
 COLLAR TIES: 2x8 @ 16" O.C.
 SHEATHING: 3/4" ADVANTECH (GLUED AND SCREWED OR Nailed)
 INSULATION: SEE INSULATION
 ICE & WATER SHIELD: ALL WALLS, 3" @ ROOF EDGE, ENTIRE SURFACE W/PITCHES UNDER 5/12
 ALL ROOFS SHALL HAVE PROPER VENTILATION WITH PROPER VENTS, RIDGE VENTS AND SOFFIT VENTS.

SOFFIT:
 FINISH: 1/2" GYPSUM BOARD PER CODE
 VENT: CONT. SOFFIT VENT, 1x6" PRE-FRIMED PINE
 FRIEZE BOARD: 1x6" PRE-FRIMED PINE
 INSULATION: SEE NOTES ON DRAWING A1

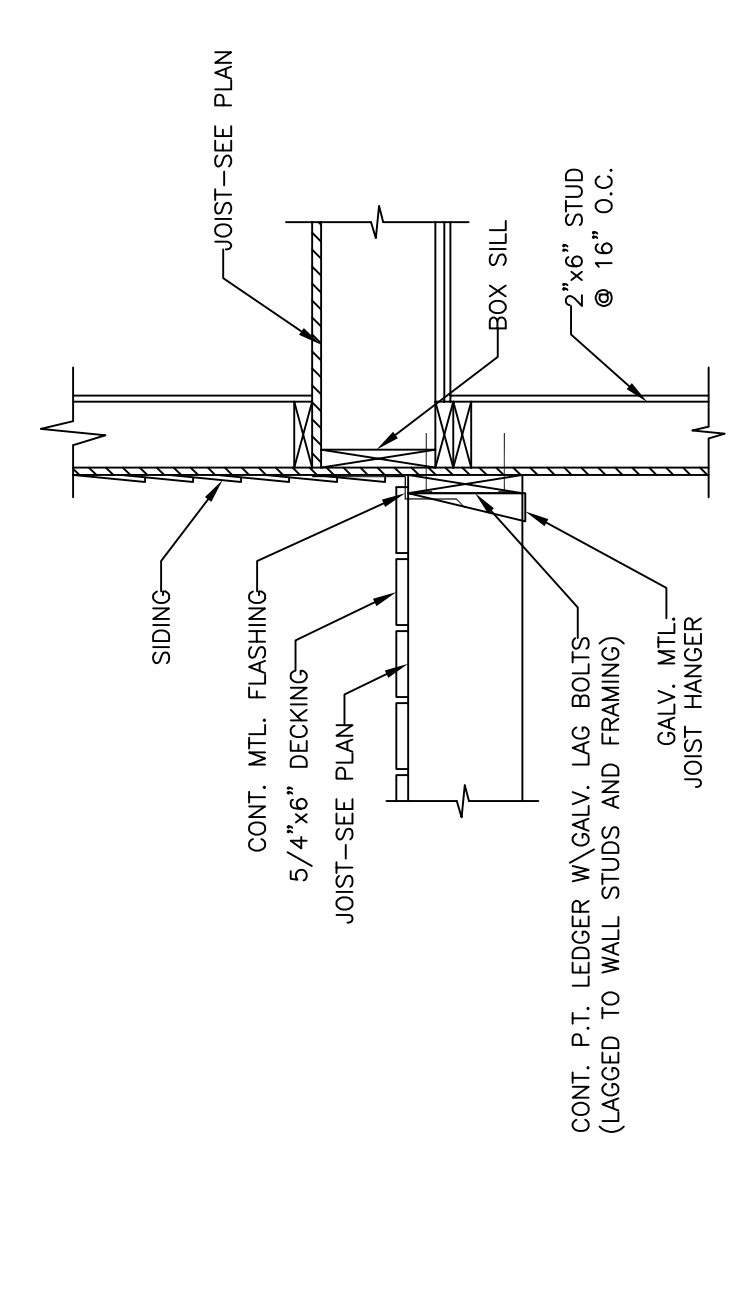

ISSUED FOR CONSTRUCTION
 04-30-2014

ALL DRAWINGS, PLANS, SKETCHES ETC. ARE PROVIDED TO OUR CLIENTS BASED ON COMMON BUILDING PRACTICES. NONE OF THE EMPLOYEES OF MORIN DRAFTING ARE LICENSED PROFESSIONAL ENGINEERS OR ARCHITECTS. ALL DRAWINGS AND SKETCHES ARE FOR INFORMATION ONLY AND SHOULD NOT BE USED FOR CONSTRUCTION OR FOR ANY OTHER PURPOSE. ALL DIMENSIONS AND SPECIFICATIONS SHALL BE AS SHOWN ON THE DRAWINGS UNLESS OTHERWISE NOTED. MORIN DRAFTING SHALL NOT BE RESPONSIBLE FOR ANY ERRORS OR OMISSIONS IN ANY DRAWING OR FOR ANY DAMAGES TO THE PROPERTY OF ANY CLIENT OR FOR ANY DAMAGES TO THE PROPERTY OF MORIN DRAFTING.

Engineering Review of Structural Framing System Only.

LARRY A. WICHORSKI
 No. 5990
 PROFESSIONAL ENGINEER

ENGINEERING DESIGN PROFESSIONAL
 PO Box 375
 Freeport, Maine 04032
 207-865-9505

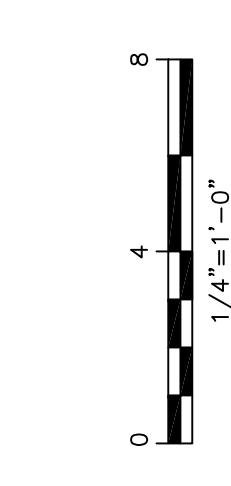

NO.	DATE	DESCRIPTION
1	11-04-14	REVISED NOTE

MAINE INVESTMENT PROPERTIES, L.L.C.
 PORTLAND, MAINE

MORIN DRAFTING GORHAM, ME. 318-1177
 DUPLEX RESIDENCE
 126 VERANDA ST., PORTLAND, MAINE

SECTIONS

DRAWN: J. MORIN
 SCALE: 1/4"=1'-0"
 DATE: 09-30-2013
 PLAN NO.

A3