

7.5 ft stairs

Bathroom

7.5 ft



closet



7.5 ft

Spare bedroom
(business area)

Total
115.5
sq. ft

11 ft

closet

Hallway

Master Bedroom

26 ft

↓ Downstairs ↓

Back door

Kitchen

stairs →

20 ft

Living Room

Total
sq. footage
960 sq. ft

Front Door

20 ft



Reviewed for Code Compliance
Permitting and Inspections
Department
April 05/24/2018

12/17/08 DR

THIS IS NOT A BOUNDARY SURVEY

This copyrighted document expires 03-15-09. Reproduction and/or dissemination after this date is unauthorized.

MORTGAGE INSPECTION OF: DEED BOOK 20108 PAGE 204 COUNTY Cumberland
PLAN BOOK --- PAGE --- LOT p/o 1

ADDRESS: 7-9 Kensington Street, Portland, Maine

Job Number: 309-25-R

Inspection Date: 12-15-08

Scale: 1" = 30'

Client File #: 80550

Buyers: Gerald K. & Susan J. Campbell

Seller: New Stream R E Funding 20, LLC



LC
PC

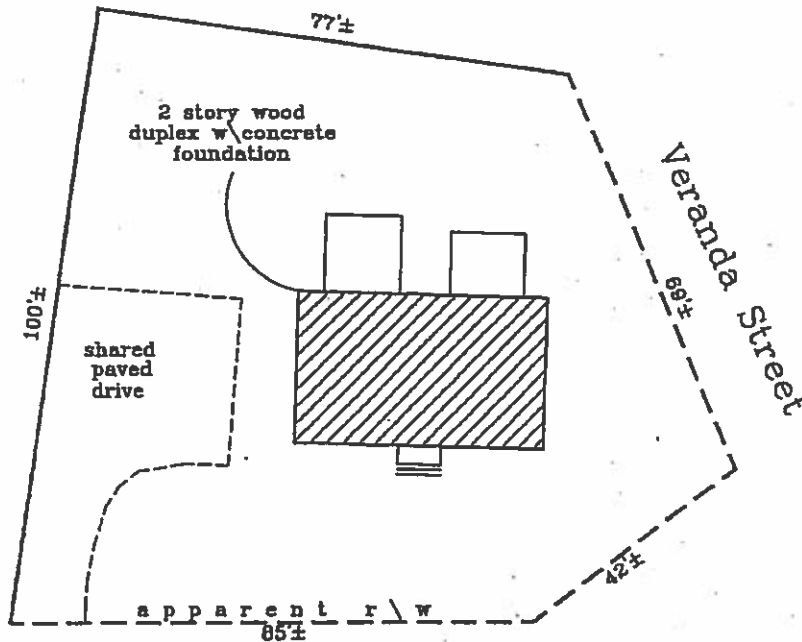

LEL

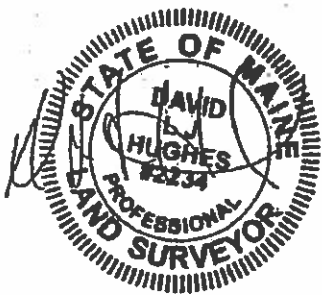

Reviewed for Code Compliance
Permitting and Inspections
Department
April 03/24/2018

I HEREBY CERTIFY TO: Bay Area Title Services; Gerald K. & Susan J. Campbell, and its title insurer.

Monuments found did not conflict with the deed description.

The dwelling setbacks do not violate town zoning requirements.

As delineated on the Federal Emergency Management Agency Community Panel 230051-0007B:

The structure does not fall within the special flood hazard zone.

The land does not fall within the special flood hazard zone.

A wetlands study has not been performed.

APPARENT EASEMENTS AND RIGHTS OF WAY ARE SHOWN. OTHER ENCUMBRANCES, RECORDED OR NOT, MAY EXIST. THIS SKETCH WILL NOT REVEAL ABUTTING DEED CONFLICTS, IF ANY.

copyright 1994

Livingston - Hughes

Professional Land Surveyors & Foresters

88 Guinea Road

Kennebunkport - Maine 04046

207-987-9761 phone

207-987-4831 fax

THIS SKETCH IS FOR MORTGAGE PURPOSES ONLY