

# DISPLAY THIS CARD ON PRINCIPAL FRONTAGE OF WORK CITY OF PORTLAND

## BUILDING INSPECTION

Please Read Application And Notes, If Any, Attached

This is to certify that ANDREWS HELEN DALL /Home Owner  
has permission to install a 8' x 12' Shed in rear property  
AT 2 CHESTER ST L 431 C018001

Permit Number: 071376  
**PERMIT ISSUED**  
NOV 7 2007  
CITY OF PORTLAND

provided that the person or persons, firm or corporation accepting this permit shall comply with all of the provisions of the Statutes of this State and of the Ordinances of the City of Portland regulating the construction, maintenance and use of buildings and structures, and of the application on file in this department.

Apply to Public Works for street line and grade if nature of work requires such information.

Notification of inspection must be given and when permission procured before this building or part thereof is laid or completed. Closed-in areas 4 HOUR NOTICE IS REQUIRED.

A certificate of occupancy must be procured by owner before this building or part thereof is occupied.

### OTHER REQUIRED APPROVALS

Fire Dept. \_\_\_\_\_  
Health Dept. \_\_\_\_\_  
Appeal Board \_\_\_\_\_  
Other \_\_\_\_\_  
Department Name

*[Signature]* 11/7/08  
Director - Building & Inspection Services

**PENALTY FOR REMOVING THIS CARD**

**City of Portland, Maine - Building or Use Permit Application**

389 Congress Street, 04101 Tel: (207) 874-8703, Fax: (207) 874-8716

Permit No: 07-1376	Issue Date:	CBL: 431 C018001
-----------------------	-------------	---------------------

Location of Construction: 2 CHESTER ST	Owner Name: ANDREWS HELEN DALLAS	Owner Address: PO BOX 178	Phone:
Business Name:	Contractor Name: Home Owner	Contractor Address:	Phone
Lessee/Buyer's Name	Phone:	Permit Type: Sheds	Zone: R-5

Past Use: Single Family home	Proposed Use: Single Family Home - install a 8' x 12' Shed in rear of property	Permit Fee: \$30.00	Cost of Work: \$1,000.00	CEO District: 4
---------------------------------	---	------------------------	-----------------------------	--------------------

Proposed Project Description: install a 8' x 12' Shed in rear of property	FIRE DEPT: <input type="checkbox"/> Approved <input checked="" type="checkbox"/> Denied INSPECTION: Use Group: R-3/U Type: SB City Ordinance Signature: _____ Signature: _____
--	--

Permit Taken By: Idobson	Date Applied For: 11/07/2007	<b>Zoning Approval</b>	
-----------------------------	---------------------------------	------------------------	--

- This permit application does not preclude the Applicant(s) from meeting applicable State and Federal Rules.
- Building permits do not include plumbing, septic or electrical work.
- Building permits are void if work is not started within six (6) months of the date of issuance. False information may invalidate a building permit and stop all work..

<b>Special Zone or Reviews</b> <input checked="" type="checkbox"/> Shoreland <i>Well beyond 75' from</i> <input type="checkbox"/> Wetland <input type="checkbox"/> Flood Zone <input type="checkbox"/> Subdivision <input type="checkbox"/> Site Plan Maj <input type="checkbox"/> Minor <input type="checkbox"/> MM <input type="checkbox"/> Date: 11/7/08	<b>Zoning Appeal</b> <input checked="" type="checkbox"/> Variance <input type="checkbox"/> Miscellaneous <input type="checkbox"/> Conditional Use <input type="checkbox"/> Interpretation <input type="checkbox"/> Approved <input type="checkbox"/> Denied Date:	<b>Historic Preservation</b> <input checked="" type="checkbox"/> Not in District or Landmark <input type="checkbox"/> Does Not Require Review <input type="checkbox"/> Requires Review <input type="checkbox"/> Approved <input type="checkbox"/> Approved w/Conditions <input type="checkbox"/> Denied Date: 11/7/08
---	--	--

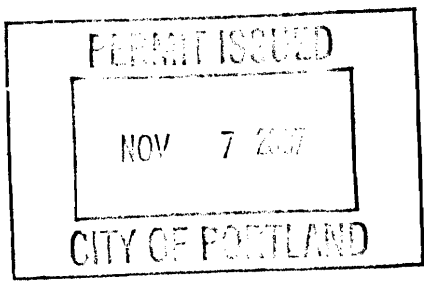

**CERTIFICATION**

I hereby certify that I am the owner of record of the named property, or that the proposed work is authorized by the owner of record and that I have been authorized by the owner to make this application as his authorized agent and I agree to conform to all applicable laws of this jurisdiction. In addition, if a permit for work described in the application is issued, I certify that the code official's authorized representative shall have the authority to enter all areas covered by such permit at any reasonable hour to enforce the provision of the code(s) applicable to such permit.

SIGNATURE OF APPLICANT	ADDRESS	DATE	PHONE
RESPONSIBLE PERSON IN CHARGE OF WORK, TITLE		DATE	PHONE



# General Building Permit Application

If you or the property owner owes real estate or personal property taxes or user charges on any property within the City, payment arrangements must be made before permits of any kind are accepted.

Location/Address of Construction: <u>2 CHESTER ST., PORTLAND, MAINE</u>		
Total Square Footage of Proposed Structure/Area <u>96'</u>		Square Footage of Lot <u>4042</u>
Tax Assessor's Chart, Block & Lot Chart# <u>431</u> Block# <u>C</u> Lot# <u>18</u>	Applicant * <b>must be owner, Lessee or Buyer</b> * Name <u>HELEN DALLAS ANDREWS</u> Address <u>2 CHESTER ST.</u> City, State & Zip <u>PORTLAND, ME, 04102</u>	Telephone: <u>207-772-6188</u>
Lessee/DBA (If Applicable)	Owner (if different from Applicant) Name Address City, State & Zip	Cost Of Work: \$ <u>1000</u> C of O Fee: \$ _____ Total Fee: \$ <u>30</u>
Current legal use (i.e. single family) <u>S F</u> If vacant, what was the previous use? _____ Proposed Specific use: <u>Same</u> Is property part of a subdivision? _____ If yes, please name _____ Project description: <u>8' X 12' SHED</u>		
Contractor's name: <u>GORDON ANDREWS</u> Address: <u>MCCANN RD</u> City, State & Zip <u>POLAND, MAINE 04291</u> Telephone: <u>998-3289</u> Who should we contact when the permit is ready: <u>HELEN DALLAS ANDREWS</u> Telephone: <u>772-6188</u> Mailing address: <u>PO. BOX 178 W. POLAND, ME, 04291</u>		

**Please submit all of the information outlined on the applicable Checklist. Failure to do so will result in the automatic denial of your permit.**

In order to be sure the City fully understands the full scope of the project, the Planning and Development Department may request additional information prior to the issuance of a permit. For further information or to download copies of this form and other applications visit the Inspections Division on-line at [www.portlandmaine.gov](http://www.portlandmaine.gov), or stop by the Inspections Division office, room 315 City Hall or call 874-8703.

I hereby certify that I am the Owner of record of the named property, or that the owner of record authorizes the proposed work and that I have been authorized by the owner to make this application as his/her authorized agent. I agree to conform to all applicable laws of this jurisdiction. In addition, if a permit for work described in this application is issued, I certify that the Code Official's authorized representative shall have the authority to enter all areas covered by this permit at any reasonable hour to enforce the provisions of the codes applicable to this permit.

Signature: [Signature] Date: 11/7/07

**This is not a permit; you may not commence ANY work until the permit is issue**

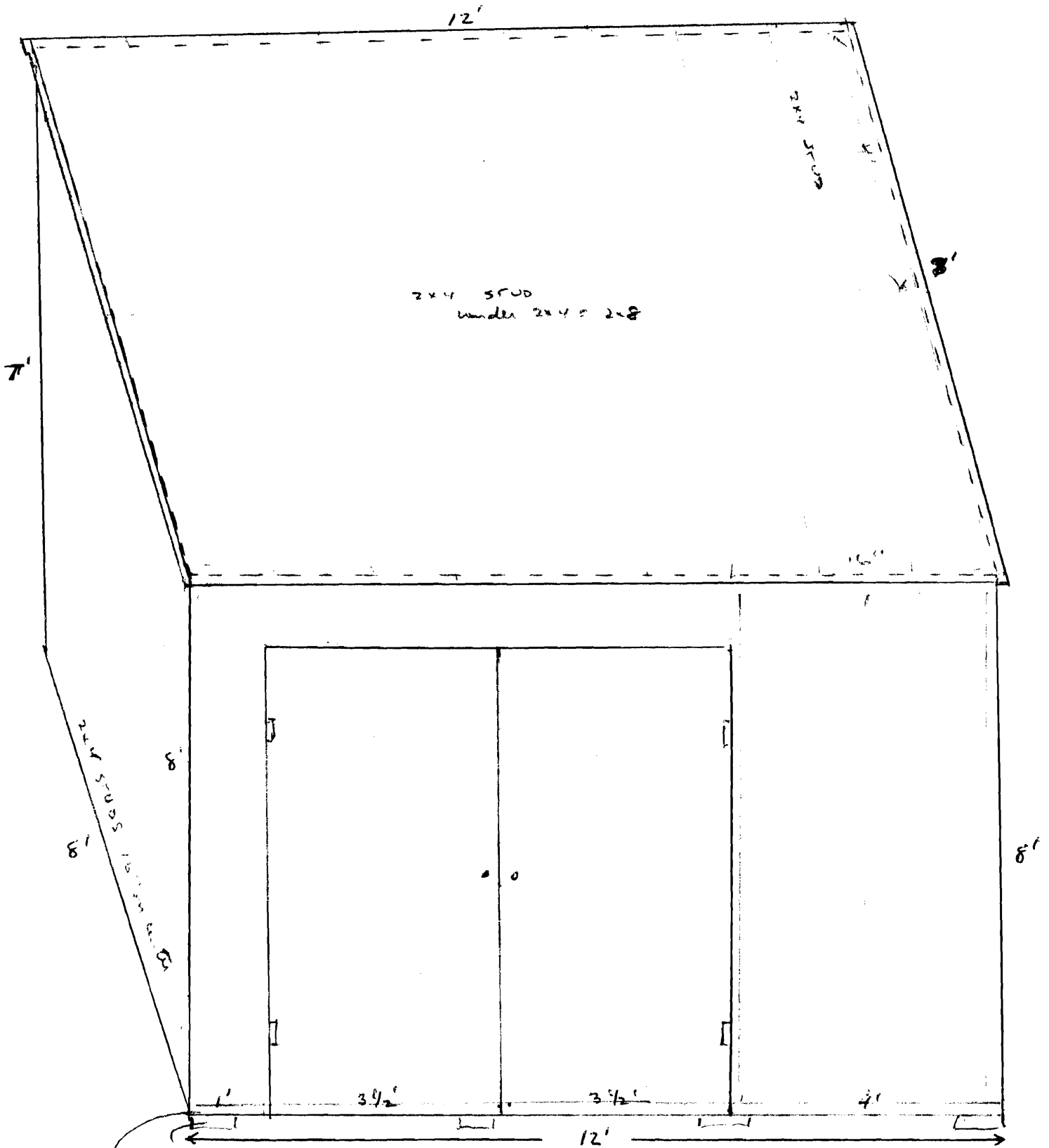

Cement Blocks, + 2x6 - 16" ON CENTER

3/4" EXTERIOR PLYWOOD SHED

SIDE WALLS 2x4 STUDS 16" ON CENTER 2 / 1/2" EXT PLYWOOD

ROOF 2x4 16" ON CENTER & 2x4 @ 4" UNDER 2x4 = double 2x4.

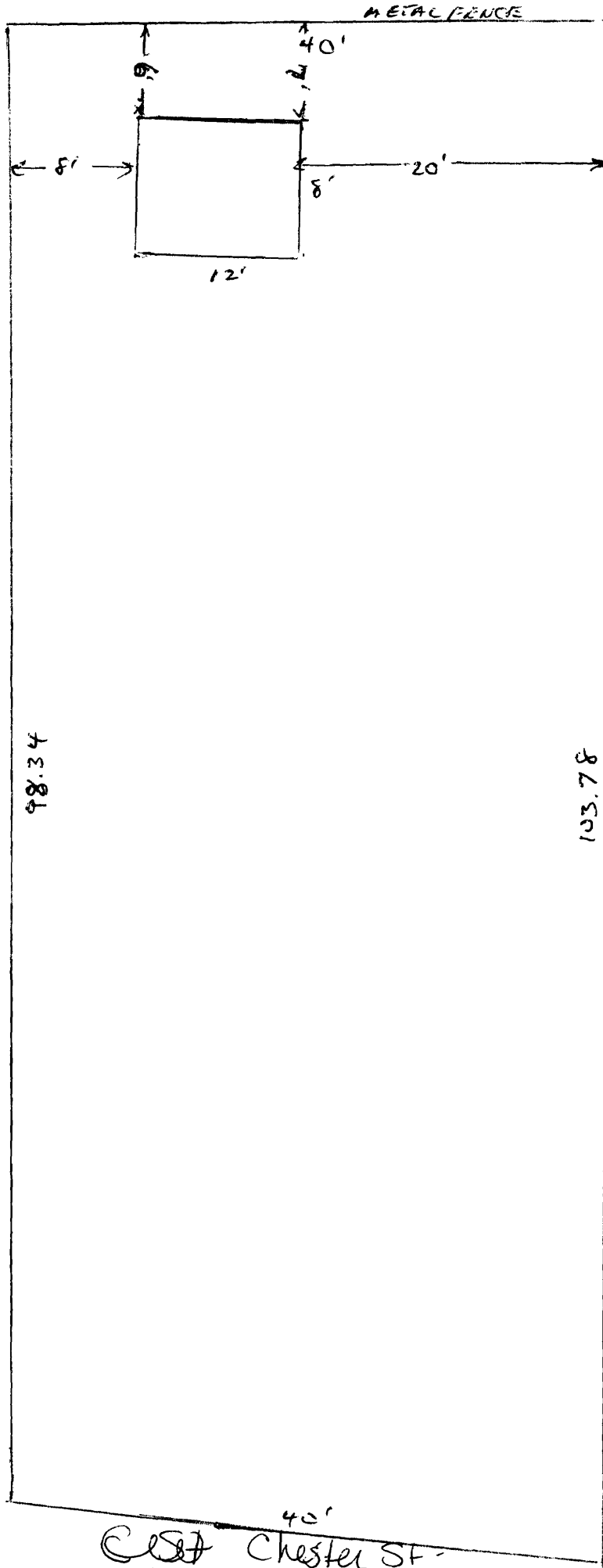

R-5  
 5' - side + rear  
 Lot cov - OK

PLOT PLAN  
 431-C-17