

1 Align posts on bottom stair tread and top landing 1" back from edge, as shown. Follow post installation instructions closely (Figure 1).

2 Fold and position ("rack") the pre-built aluminum rail sections to desired angle of stairs. Clamp to installed rail posts (Figure 2). Make sure to have the same distance from inside of post to inside of first baluster on both top and bottom of the stair section.

3 Hold top angle bracket on post adjacent to rail, and mark rail at the end of the bracket. Repeat for other three stair rail brackets (Figure 3).

Cutting Stair Rail to Proper Length

4 Remove clamped stair kit from post.

5 Locate previous marked rails and add 1" to your pre-determined measurement (Figure 4).

6 Cut all four 1" marks at 90° (Figure 5).

7 Slide brackets on ends of rails (top and bottom) and slide section in-between posts.

8 Using 1/8" drill bit - pre-drill bottom rail bracket to top stair post (Figure 6).

9 Attach bottom bracket to post with 3/4" screws (included).

10 Repeat for bottom stair post bottom rail bracket (Figure 7).

11 Using 1/8" drill bit - pre-drill top rail bracket to top stair post (Figure 8).

12 Attach top bracket to post with 3/4" screws (included).

13 Repeat for bottom stair post top rail bracket.

14 Using a 1/8" drill bit, pre-drill all brackets (top and bottom) through side hole (Figure 9).

15 Install 3/4" screws (included) into side bracket holes to attach brackets to rails.

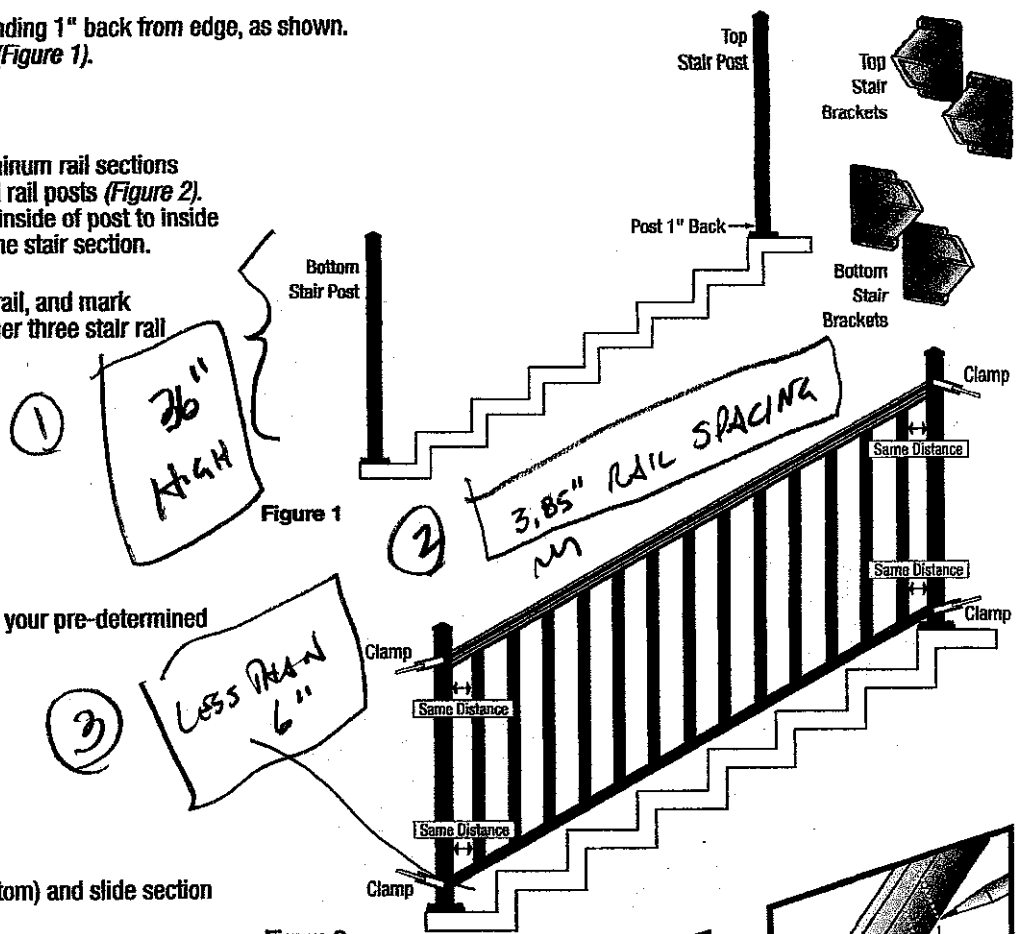

Figure 2

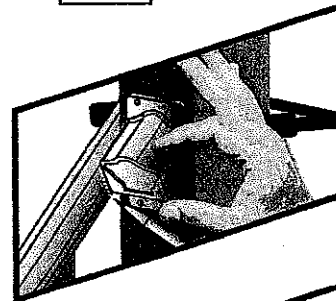

Figure 3

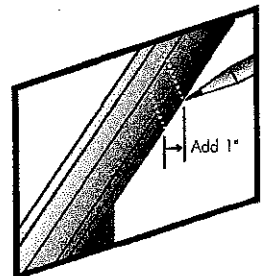

Figure 4

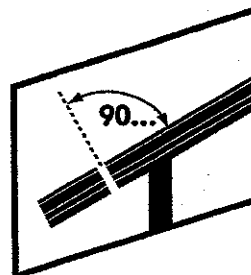

Figure 5

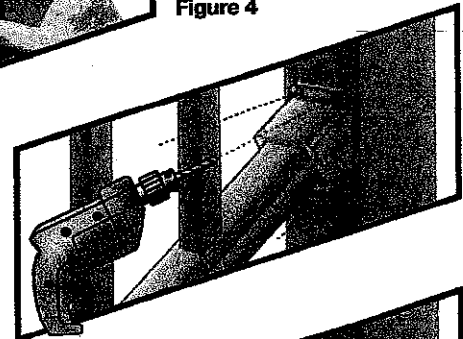

Figure 6

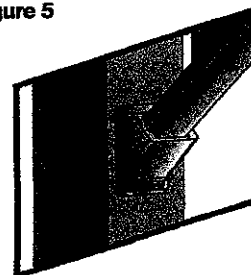

Figure 7

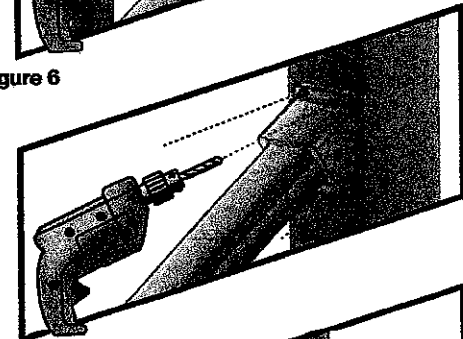

Figure 8

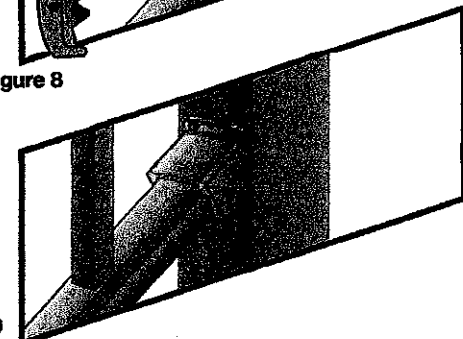

Figure 9