

**City of Portland, Maine - Building or Use Permit Application**

389 Congress Street, 04101 Tel: (207) 874-8703, Fax: (207) 874-8716

Permit No: 02-1288	Issue Date:	CBL: 430 A017001
-----------------------	-------------	---------------------

Location of Construction: 24 Berwick St	Owner Name: Ryan Margaret M &	Owner Address: 24 Berwick St	Phone: 207-871-5934
Business Name: n/a	Contractor Name: Adrian Keating	Contractor Address: 617 Mountain Road West Bath	Phone: 2078715934
Lessee/Buyer's Name n/a	Phone: n/a	Permit Type: Additions - Dwellings	Zone: R-3

Past Use: Single Family	Proposed Use: Single Family / Construct shed dormer for upstairs bedroom.	Permit Fee: \$93.00	Cost of Work: \$10,000.00	CEO District: 2	9000 SF
Proposed Project Description: Construct shed dormer for upstairs bedroom.		FIRE DEPT: <input type="checkbox"/> Approved <input checked="" type="checkbox"/> Denied <i>N/A</i>	INSPECTION: Use Group: R-3 Type: SB BOCA 1999 Signature: <i>AK</i>		

PEDESTRIAN ACTIVITIES DISTRICT (P.A.D.)	
Action: <input type="checkbox"/> Approved <input type="checkbox"/> Approved w/Conditions <input type="checkbox"/> Denied	Signature: _____ Date: _____

Permit Taken By: gg	Date Applied For: 11/15/2002	<b>Zoning Approval</b>	
------------------------	---------------------------------	------------------------	--

<ol style="list-style-type: none"> <li>This permit application does not preclude the Applicant(s) from meeting applicable State and Federal Rules.</li> <li>Building permits do not include plumbing, septic or electrical work.</li> <li>Building permits are void if work is not started within six (6) months of the date of issuance. False information may invalidate a building permit and stop all work.</li> </ol>	<b>Special Zone or Reviews</b> <input type="checkbox"/> Shoreland <input type="checkbox"/> Wetland <input type="checkbox"/> Flood Zone <input type="checkbox"/> Subdivision <input type="checkbox"/> Site Plan  Maj <input type="checkbox"/> Minor <input type="checkbox"/> MM <input type="checkbox"/> Date: <i>11/20/02</i>	<b>Zoning Appeal</b> <input type="checkbox"/> Variance <input type="checkbox"/> Miscellaneous <input type="checkbox"/> Conditional Use <input type="checkbox"/> Interpretation <input type="checkbox"/> Approved <input type="checkbox"/> Denied  Date: _____	<b>Historic Preservation</b> <input checked="" type="checkbox"/> Not in District or Landmark <input type="checkbox"/> Does Not Require Review <input type="checkbox"/> Requires Review <input type="checkbox"/> Approved <input type="checkbox"/> Approved w/Conditions <input type="checkbox"/> Denied  Date: <i>11/20/02</i>
--	---	---	--

**CERTIFICATION**

I hereby certify that I am the owner of record of the named property, or that the proposed work is authorized by the owner of record and that I have been authorized by the owner to make this application as his authorized agent and I agree to conform to all applicable laws of this jurisdiction. In addition, if a permit for work described in the application is issued, I certify that the code official's authorized representative shall have the authority to enter all areas covered by such permit at any reasonable hour to enforce the provision of the code(s) applicable to such permit.

---

SIGNATURE OF APPLICANT \_\_\_\_\_ ADDRESS \_\_\_\_\_ DATE \_\_\_\_\_ PHONE \_\_\_\_\_

---

RESPONSIBLE PERSON IN CHARGE OF WORK, TITLE \_\_\_\_\_ DATE \_\_\_\_\_ PHONE \_\_\_\_\_

# All Purpose Building Permit Application

If you or the property owner owes real estate or personal property taxes or user charges on any property within the City, payment arrangements must be made before permits of any kind are accepted.

Location/Address of Construction: <u>24 BERWICK ST PORTLAND ME 04103</u>		
Total Square Footage of Proposed Structure	Square Footage of Lot <u>9,000</u>	
Tax Assessor's Chart, Block & Lot Chart# <u>430</u> Block# <u>A</u> Lot# <u>017</u>	Owner: <u>MARGARET RYAN</u> <u>JAY SETLIFF</u>	Telephone: <u>871-5934</u>
Lessee/Buyer's Name (If Applicable) <u>N/A</u>	Applicant name, address & telephone: <u>JAY SETLIFF</u> <u>871 5934</u> <u>24 BERWICK ST</u> <u>PORTLAND ME 04103</u>	Cost Of Work: \$ <u>10,000</u> Fee: \$ <u>93.00</u>
Current use: <u>SINGLE FAMILY HOME</u>		
If the location is currently vacant, what was prior use: <u>N/A</u>		
Approximately how long has it been vacant: <u>N/A</u>		
Proposed use: <u>SINGLE FAMILY HOME</u>		
Project description: <u>CONSTRUCT SHED DORMER FOR UPSTAIRS BEDROOM</u>		
Contractor's name, address & telephone: <u>ADRIAN KEATING, 617 MOUNTAIN RD, WEST BATH ME 04530</u>		
Who should we contact when the permit is ready: <u>JAY SETLIFF</u>		<u>207 442 8709</u>
Mailing address: <u>24 BERWICK ST</u> <u>PORTLAND ME 04103</u>		
We will contact you by phone when the permit is ready. You must come in and pick up the permit and review the requirements before starting any work, with a Plan Reviewer. A stop work order will be issued and a \$100.00 fee if any work starts before the permit is picked up. PHONE: <u>871 5934</u> <i>Call</i>		

**IF THE REQUIRED INFORMATION IS NOT INCLUDED IN THE SUBMISSIONS THE PERMIT WILL BE AUTOMATICALLY DENIED AT THE DISCRETION OF THE BUILDING/PLANNING DEPARTMENT, WE MAY REQUIRE ADDITIONAL INFORMATION IN ORDER TO APPROVE THIS PERMIT.**

*I hereby certify that I am the Owner of record of the named property, or that the owner of record authorizes the proposed work and that I have been authorized by the owner to make this application as his/her authorized agent. I agree to conform to all applicable laws of this jurisdiction. In addition, if a permit for work described in this application is issued, I certify that the Code Official's authorized representative shall have the authority to enter all areas covered by this permit at any reasonable hour to enforce the provisions of the codes applicable to this permit.*

Signature of applicant: <u>Jay Setliff</u>	Date: <u>11/15/12</u>
--	-----------------------

**This is NOT a permit, you may not commence ANY work until the permit is issued.**  
If you are in a Historic District you may be subject to additional permitting and fees with the Planning Department on the 4<sup>th</sup> floor of City Hall

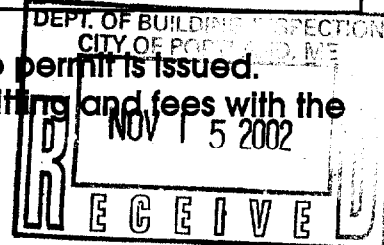

# DISPLAY THIS CARD ON PRINCIPAL FRONTAGE OF WORK CITY OF PORTLAND

Please Read Application And Notes, If Any, Attached

BUILDING DEPARTMENT

## PERMIT

Permit Number: 021288

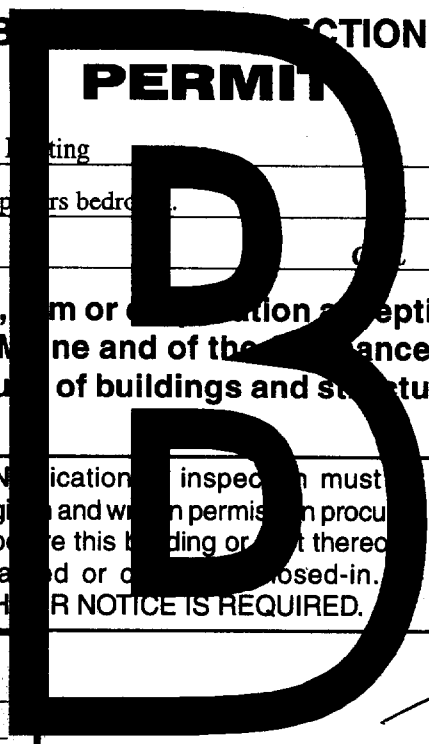

This is to certify that Ryan Margaret M &/Adrian Living  
has permission to Construct shed dormer for upstairs bedrooms  
AT 24 Berwick St Call 430 A017001

provided that the person or persons, firm or corporation accepting this permit shall comply with all of the provisions of the Statutes of Maine and of the Ordinances of the City of Portland regulating the construction, maintenance and use of buildings and structures, and of the application on file in this department.

Apply to Public Works for street line and grade if nature of work requires such information.

Notification of inspection must be given and work on permit must be completed before this building or part thereof is leased or occupied. **HEAR NOTICE IS REQUIRED.**

A certificate of occupancy must be procured by owner before this building or part thereof is occupied.

OTHER REQUIRED APPROVALS

Fire Dept. \_\_\_\_\_  
Health Dept. \_\_\_\_\_  
Appeal Board \_\_\_\_\_  
Other \_\_\_\_\_

**PERMIT ISSUED**  
NOV 20 2002

Department Name

CITY OF PORTLAND

*[Signature]*  
Director - Building & Inspection Services

PENALTY FOR REMOVING THIS CARD



24 BERWICK ST.  
11-15-02

R-3

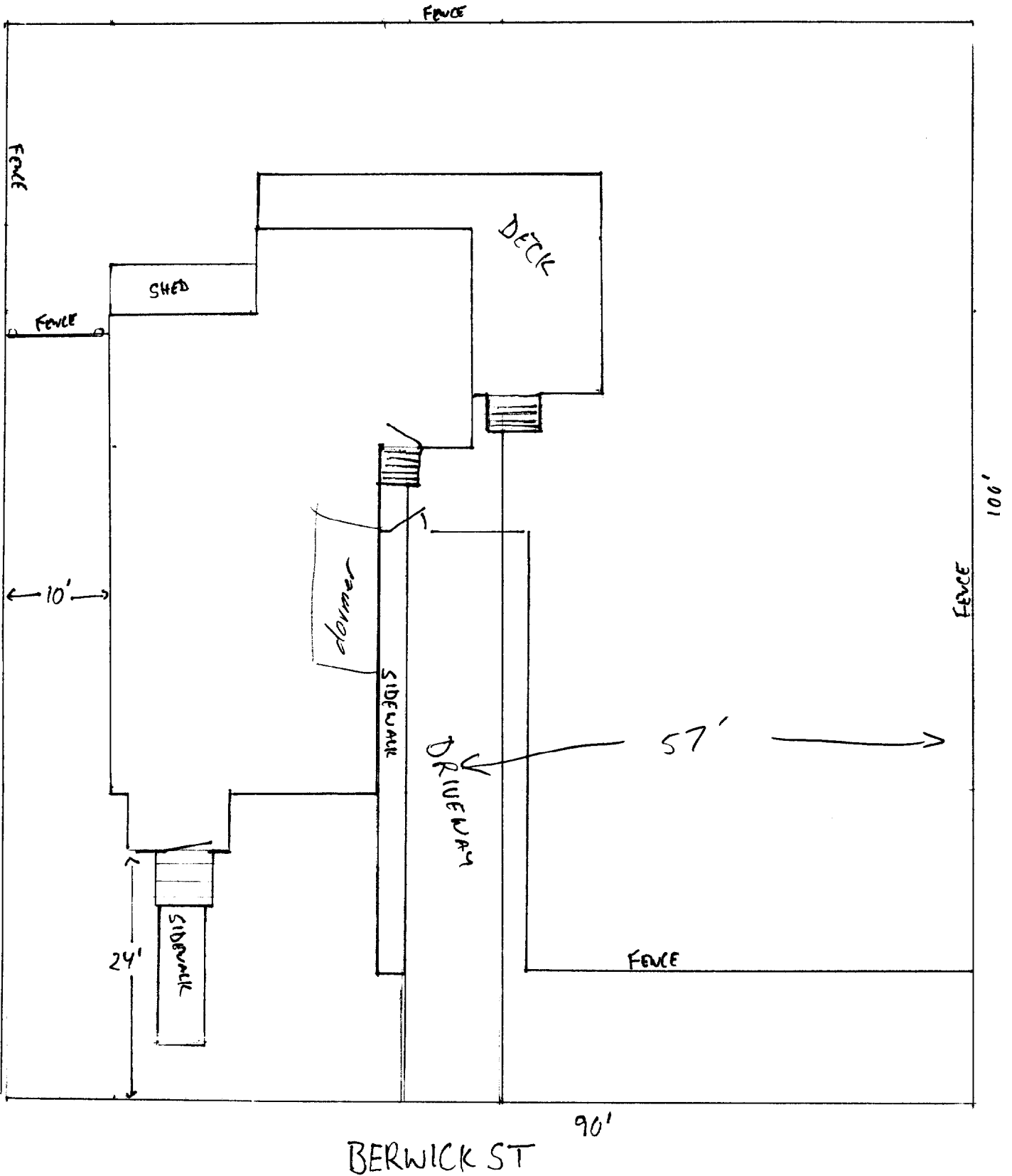

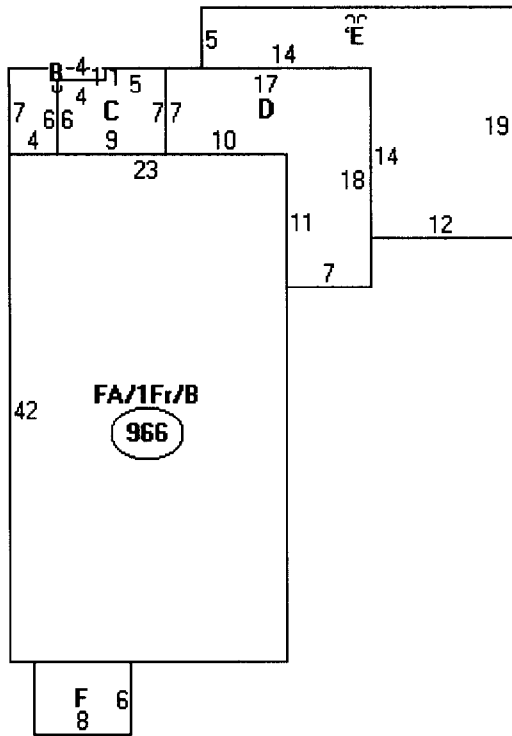

<u>Descriptor/Area</u>	
A:	FA/1Fr/B 966 sqft
B:	CNPY 32 sqft
C:	FUB 59 sqft
D:	EP 196 sqft
E:	WD 298 sqft
F:	EP 48 sqft

This page contains a detailed description of the Parcel ID you selected. Press the **New Search** button at the bottom of the screen to submit a new query.

**Current Owner Information**

**Card Number** 1 of 1  
**Parcel ID** 430 A017001  
**Location** 24 BERWICK ST  
**Land Use** SINGLE FAMILY

**Owner Address** RYAN MARGARET M & JAY W SETLIFF JTS  
 24 BERWICK ST  
 PORTLAND ME 04103

**Book/Page** 12630/335  
**Legal** 430-A-17-18  
 BERWICK ST 24-30  
 9000 SF

**Valuation Information**

<b>Land</b>	<b>Building</b>	<b>Total</b>
\$29,400	\$68,670	\$98,070

**Property Information**

<b>Year Built</b> 1913	<b>Style</b> Old Style	<b>Story Height</b> 1	<b>Sq. Ft.</b> 1208	<b>Total Acres</b> 0.207		
<b>Bedrooms</b> 3	<b>Full Baths</b> 2	<b>Half Baths</b>	<b>Total Rooms</b> 7	<b>Attic</b> Part Finsh	<b>Basement</b> Full	

**Outbuildings**

<b>Type</b>	<b>Quantity</b>	<b>Year Built</b>	<b>Size</b>	<b>Grade</b>	<b>Condition</b>
-------------	-----------------	-------------------	-------------	--------------	------------------

**Sales Information**

<b>Date</b> 07/25/1996	<b>Type</b> LAND + BLDING	<b>Price</b> \$84,000	<b>Book/Page</b> 12630-335
---------------------------	------------------------------	--------------------------	-------------------------------

**Picture and Sketch**

Picture                      Sketch

[Click here to view Tax Roll Information.](#)

Any information concerning tax payments should be directed to the Treasury office at 874-8490 or [e-mailed](#).



