

# DISPLAY THIS CARD ON PRINCIPAL FRONTAGE OF WORK CITY OF PORTLAND

## BUILDING INSPECTION

### PERMIT

Please Read Application And Notes, If Any, Attached

Permit Number: 080145

This is to certify that POULOS NICHOLAS E/Brogoin & Sons  
has permission to Installation of commercial kitchen exhaust hood  
AT 9 VERANDA ST 429 H030001

PERMIT ISSUED

MAR - 6 2008

CITY OF PORTLAND

provided that the person or persons who perform or supervise the construction accepting this permit shall comply with all of the provisions of the Statutes of this State and of the Ordinances of the City of Portland regulating the construction, maintenance and use of buildings and structures, and of the application on file in this department.

Apply to Public Works for street line and grade if nature of work requires such information.

Notification of inspection must be given and when permission is procured before this building or part thereof is loaded or otherwise closed-in. 4 HOUR NOTICE IS REQUIRED.

A certificate of occupancy must be procured by owner before this building or part thereof is occupied.

#### OTHER REQUIRED APPROVALS

Fire Dept. \_\_\_\_\_  
Health Dept. \_\_\_\_\_  
Appeal Board \_\_\_\_\_  
Other \_\_\_\_\_  
Department Name

*Jeanne Bonke* 2/28/08  
Director - Building & Inspection Services

**PENALTY FOR REMOVING THIS CARD**

**City of Portland, Maine - Building or Use Permit Application**

389 Congress Street, 04101 Tel: (207) 874-8703, Fax: (207) 874-8716

Permit No: 08-0145	Issue Date:	CBL: 429 H030001
-----------------------	-------------	---------------------

Location of Construction: 9 VERANDA ST	Owner Name: POULOS NICHOLAS E	Owner Address: 40 BERKELEY ST	Phone:
Business Name:	Contractor Name: Bourgoin & Sons	Contractor Address: 123 Davis Road Durham	Phone 2077491878
Lessee/Buyer's Name	Phone:	Permit Type: Hood Systems, Commerical	Zone: B-2

Past Use: Commercial - Restaurant	Proposed Use: Commercial - Restaurant new exhaust hood	Permit Fee: \$140.00	Cost of Work: \$11,700.00	CEO District: 4
Proposed Project Description: Installation of commercial kitchen exhaust hood.		FIRE DEPT: <input type="checkbox"/> Approved <input type="checkbox"/> Denied	INSPECTION: Use Group: B Type: Hood Type 1 DMC - 2003 Signature: JMB 2/25/08	
		PEDESTRIAN ACTIVITIES DISTRICT (P.A.D.) Action: <input type="checkbox"/> Approved <input type="checkbox"/> Approved w/Conditions <input type="checkbox"/> Denied Signature: _____ Date: _____		

Permit Taken By: lmd	Date Applied For: 02/20/2008	<b>Zoning Approval</b>
-------------------------	---------------------------------	------------------------

<p>1. This permit application does not preclude the Applicant(s) from meeting applicable State and Federal Rules.</p> <p>2. Building permits do not include plumbing, septic or electrical work.</p> <p>3. Building permits are void if work is not started within six (6) months of the date of issuance. False information may invalidate a building permit and stop all work..</p>	<p><b>Special Zone or Reviews</b></p> <input type="checkbox"/> Shoreland <input type="checkbox"/> Wetland <input type="checkbox"/> Flood Zone <input type="checkbox"/> Subdivision <i>JK</i> <input type="checkbox"/> Site Plan Maj <input type="checkbox"/> Minor <input type="checkbox"/> MM <input type="checkbox"/> Date: <i>JMB 2/28/08</i>	<p><b>Zoning Appeal</b></p> <input type="checkbox"/> Variance <input type="checkbox"/> Miscellaneous <input type="checkbox"/> Conditional Use <input type="checkbox"/> Interpretation <input type="checkbox"/> Approved <input type="checkbox"/> Denied Date: _____	<p><b>Historic Preservation</b></p> <input checked="" type="checkbox"/> Not in District or Landmark <input type="checkbox"/> Does Not Require Review <input type="checkbox"/> Requires Review <input type="checkbox"/> Approved <input type="checkbox"/> Approved w/Conditions <input type="checkbox"/> Denied Date: _____
---	--	---	--

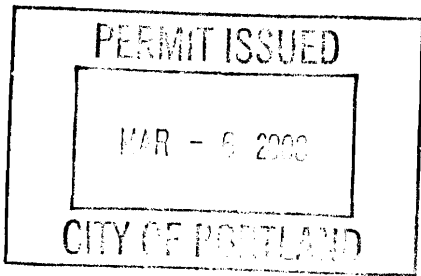

**CERTIFICATION**

I hereby certify that I am the owner of record of the named property, or that the proposed work is authorized by the owner of record and that I have been authorized by the owner to make this application as his authorized agent and I agree to conform to all applicable laws of this jurisdiction. In addition, if a permit for work described in the application is issued, I certify that the code official's authorized representative shall have the authority to enter all areas covered by such permit at any reasonable hour to enforce the provision of the code(s) applicable to such permit.

SIGNATURE OF APPLICANT	ADDRESS	DATE	PHONE
RESPONSIBLE PERSON IN CHARGE OF WORK, TITLE		DATE	PHONE

**City of Portland, Maine - Building or Use Permit**

389 Congress Street, 04101 Tel: (207) 874-8703, Fax: (207) 874-8716

<b>Permit No:</b> 08-0145	<b>Date Applied For:</b> 02/20/2008	<b>CBL:</b> 429 H030001
------------------------------	--	----------------------------

<b>Location of Construction:</b> 9 VERANDA ST	<b>Owner Name:</b> POULOS NICHOLAS E	<b>Owner Address:</b> 40 BERKELEY ST	<b>Phone:</b>
<b>Business Name:</b>	<b>Contractor Name:</b> Bourgoin & Sons	<b>Contractor Address:</b> 123 Davis Road Durham	<b>Phone</b> (207) 749-1878
<b>Lessee/Buyer's Name</b>	<b>Phone:</b>	<b>Permit Type:</b> Hood Systems, Commerical	

<b>Proposed Use:</b> Commercial - Restaurant new exhaust hood	<b>Proposed Project Description:</b> Installation of commercial kitchen exhaust hood.
--	--

<b>Dept:</b> Zoning	<b>Status:</b> Approved	<b>Reviewer:</b> Jeanine Bourke	<b>Approval Date:</b> 02/28/2008
<b>Note:</b>	<b>Ok to Issue:</b> <input checked="" type="checkbox"/>		

<b>Dept:</b> Building	<b>Status:</b> Approved with Conditions	<b>Reviewer:</b> Jeanine Bourke	<b>Approval Date:</b> 02/28/2008
<b>Note:</b>	<b>Ok to Issue:</b> <input checked="" type="checkbox"/>		
1) The Hood shall be installed per IMC 2003 and NFPA 96 This permit is approved based on the plans submitted and updated for reductions in the cleaances based on the application of a UL approved fire wrap or equivalent assembly per code.			
2) Separate permits are required for any electrical, plumbing, or HVAC systems. Separate plans may need to be submitted for approval as a part of this process.			



Strengthening a Remarkable City, Building a Community for Life • [www.portlandmaine.gov](http://www.portlandmaine.gov)

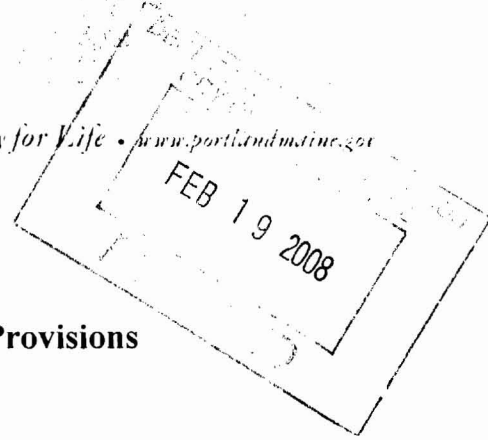

Lee Urban - Director of Planning and Development  
Jeanie Bourke - Inspection Division Services Director

### Kitchen Exhaust System Checklist and code Provisions

Dear Applicant,

The following is a checklist to assist you in filing for a permit for a Kitchen Exhaust system. The applicable Mechanical Code provisions have also been attached. Please complete this and submit job specific construction documents that demonstrate compliance with the attached information.

#### Type of System:

Type I XXXX                      Type II \_\_\_\_\_

Type I systems are systems that vent fryers, grills, broilers, ovens or woks.

Type II systems are systems that vent steamers and other non grease producing appliances.

#### Type of Materials:

Is the hood Stainless steel or other type of steel? 16ga stainless If Other, what Type? \_\_\_\_\_

Is the duct work Stainless steel or other type of steel? 16ga galv. If Other, what type? \_\_\_\_\_

Thickness of the steel for the hood 16 ga

Thickness of the duct for the hood 16ga

#### Type of Hood and Duct Supports

3/8 threaded rod to roof truss and 3/8 lag into wall

duct support roof curb

Type of seams and Joints solid welded

\_\_\_\_\_

Grease Gutters provided? cup that hooks to fan

Hood Clearance reduction to Combustibles design /specs:

install wall and ceilings fire rated to zero

Duct Clearance reduction to Combustibles design /specs:

zero wrap in 3m fire barrier

Vibration Isolation System:

none

Air Velocity within the duct system .75 static pressure

Grease accumulation prevention system:

none

Cleanouts none duct run only 5' straight

Grease Duct enclosure 3m fire barrier grease duct wrap

Exhaust Termination Roof xxxx Wall \_\_\_\_\_

Fire Suppression System 4gallon

Exhaust fan mounting and clearance from the roof / wall or Combustibles:

40" off roof and 10' away from wall, window, and grade

Exhaust fan distance from property lines 10'

Exhaust fan distance from other vents or openings 10 10'

Exhaust fan distance from adjacent buildings 10'

Exhaust fan height above adjoining grade 12'

### Hood Specs

Style of Hood c Canopy

Type of Filter Grease Baffle

Height of filter above nearest cooking surface 6'6" from floor/36" from cooking

Capacity of hood CFM 2790

Make up Air system description and capacity

2600 cfm fan mount on roof 10' away from exhaust

\_\_\_\_\_  
\_\_\_\_\_



# General Building Permit Application

If you or the property owner owes real estate or personal property taxes or user charges on any property within the City, payment arrangements must be made before permits of any kind are accepted.

Location/Address of Construction: <b>9 Veranda Street</b>		
Total Square Footage of Proposed Structure	Square Footage of Lot	
Tax Assessor's Chart, Block & Lot Chart# 429 Block# H Lot# 30	Owner: <b>Nicholas Poulus</b>	Telephone:
Lessee/Buyer's Name (If Applicable) <b>Hai Phum</b>	Applicant name, address & telephone: <b>Blue Cold Dist. 10 Snow Canning Rd Scarborough, ME 04074 885-0107</b>	Cost Of Work: <b>\$11,700.00</b> Fee: \$ _____ C of O Fee: \$ _____
Current legal use (i.e. single family) _____ If vacant, what was the previous use? <b>RESTAURANT</b> Proposed Specific use: <b>RESTAURANT</b> Is property part of a subdivision? _____ If yes, please name _____ Project description: <b>Installation of commercial kitchen exhaust hood</b>		
Contractor's name, address & telephone:  Who should we contact when the permit is ready: <b>Bill Sawyer</b> Mailing address: _____ Phone: <b>885-0107</b> <b>Installation By Bourgoin + Sons</b> <b>749-1878</b>		

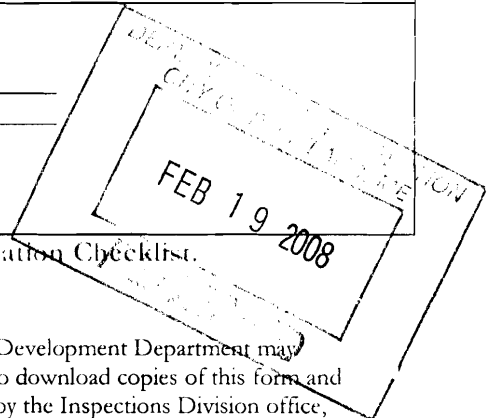

Please submit all of the information outlined in the Commercial Application Checklist. Failure to do so will result in the automatic denial of your permit.

In order to be sure the City fully understands the full scope of the project, the Planning and Development Department may request additional information prior to the issuance of a permit. For further information or to download copies of this form and other applications visit the Inspections Division on-line at [www.portlandmaine.gov](http://www.portlandmaine.gov), or stop by the Inspections Division office, room 315 City Hall or call 874-8703.

I hereby certify that I am the Owner of record of the named property, or that the owner of record authorizes the proposed work and that I have been authorized by the owner to make this application as his/her authorized agent. I agree to conform to all applicable laws of this jurisdiction. In addition, if a permit for work described in this application is issued, I certify that the Code Official's authorized representative shall have the authority to enter all areas covered by this permit at any reasonable hour to enforce the provisions of the codes applicable to this permit.

Signature of applicant: <b>Bill Sawyer</b>	Date: <b>2-19-08</b>
--	----------------------

This is not a permit; you may not commence ANY work until the permit is issued.

291235



# Low Ceiling Box Exhaust Canopy

430 lbs.

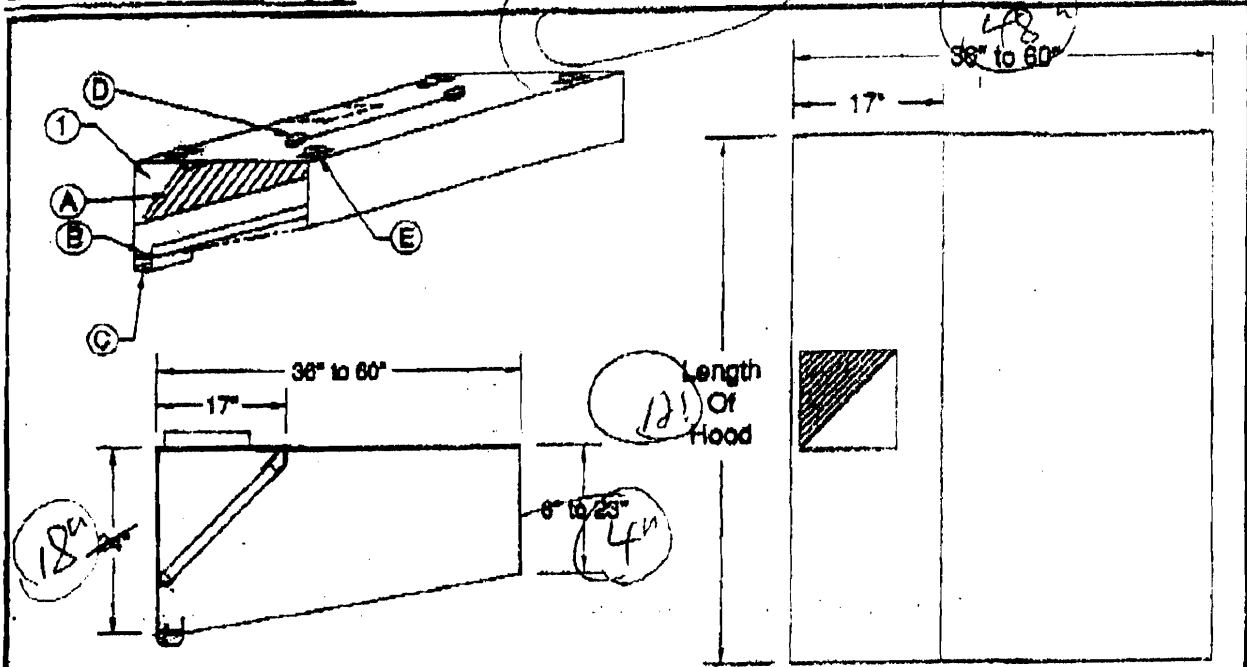

- ① Exhaust Chamber
- Ⓐ Baffle Type Filter
- Ⓑ Grease Trough
- Ⓒ Stainless Grease Cup
- Ⓓ Pre-Wired Lights
- Ⓔ Hanging Bracket

## HOOD SPECIFICATIONS:

1. All hoods are constructed of 16 gauge steel.
2. All joints are welded liquid tight, without seams by an automatic wire fed mig welder.
3. All hoods are built in accordance to NFPA 96, NSF specifications, & U.L. 710 specifications.
4. Grease trough is made to receive grease extracted by filters.
5. Grease filters are of baffle type (20" wide) and carry a U.L. listing. They are made from a light weight aluminum steel.
6. A stainless steel cup attaches to the tray that runs the entire length of the hood.

**DELUXE**  
ALL STAINLESS STEEL

**HYBRID**  
FRONT & SIDES STAINLESS  
TOP & BACK ALUMINIZED

**ECONOMY**  
ALL ALUMINIZED

American Hood Systems, Inc. "Your Exhaust Hood Specialist"  
[WWW.AMERICANHOOD.COM](http://WWW.AMERICANHOOD.COM)

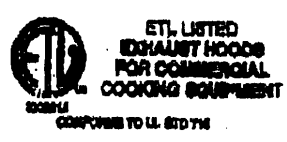

177 Reaser Court  
 Elyria, Ohio 44036  
 Telephone: 440-365-4567  
 Toll Free: 800-854-3267



P.O. Box 1377  
 Elyria, Ohio 44036-1377  
 Fax: 440-365-2100  
 www.americanhood.com

# AH44B PERFORMANCE DATA

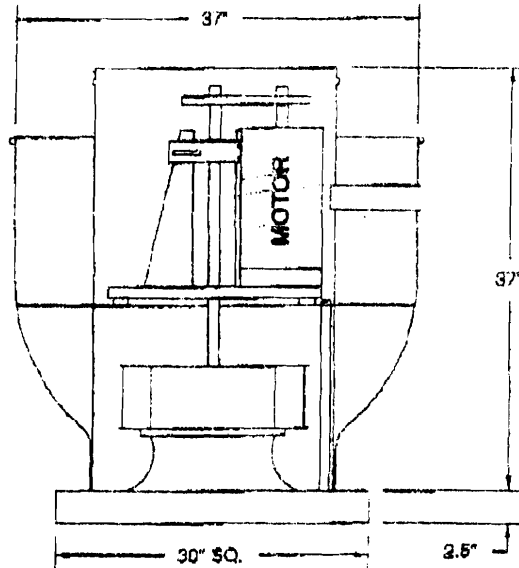

*150 lbs*

PHASE	1	
VOLTS	115	230
AMPS	8.4	4.2
HP	3/4	

**DIMENSIONAL DATA**

RPM	.000" S.P.		.125" S.P.		.25" S.P.		.375" S.P.		.50" S.P.		.625" S.P.		.75" S.P.		.875" S.P.		1.00" S.P.	
	CFM	BHP	CFM	BHP	CFM	BHP	CFM	BHP	CFM	BHP	CFM	BHP	CFM	BHP	CFM	BHP	CFM	BHP
854	3969	.53	3781	.55	3588	.58	3383	.59	3159	.60	2908	.61	2606	.60	2046	.56	-	-
879	4085	.58	3903	.60	3716	.62	3519	.64	3306	.65	3070	.66	2796	.66	2427	.64	-	-
915	4252	.65	4075	.68	3898	.70	3703	.72	3505	.74	3282	.75	3039	.75	2794	.74	2175	.68

**STANDARD FEATURES**  
 HEAVY GAUGE ALUMINUM HOUSING  
 3-YEAR LIMITED WARRANTY ON ALL ELECTRIC MOTORS  
 FACTORY SET DRIVE  
 BELT DRIVEN MOTORS ARE ENCLOSED IN WEATHER-TIGHT COMPARTMENTS  
 AVERAGE UNIT WEIGHT: 180 LBS



FANS



277 Reaser Court  
 Elyria, Ohio 44036  
 Telephone: 440-365-4557  
 Toll Free: 800-854-3267



140 lbs  
 P.O. Box 1377  
 Elyria, Ohio 44036-1377  
 Fax: 440-365-2100  
 www.americanhood.com

# AHSF7 PERFORMANCE DATA

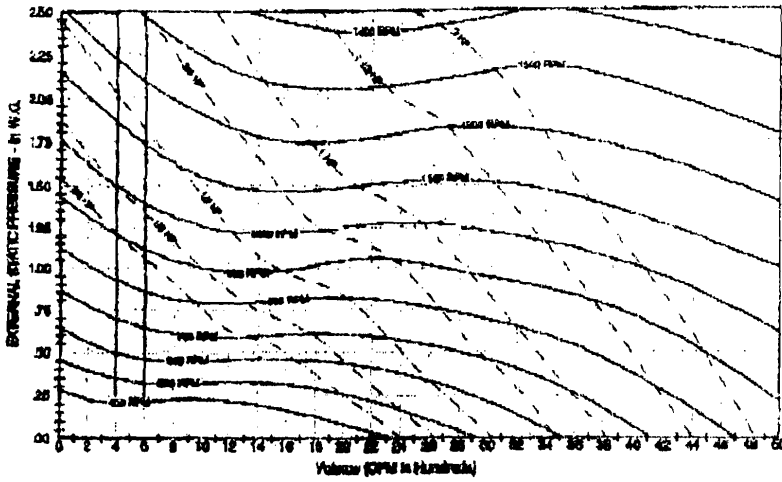

FAN CURVE

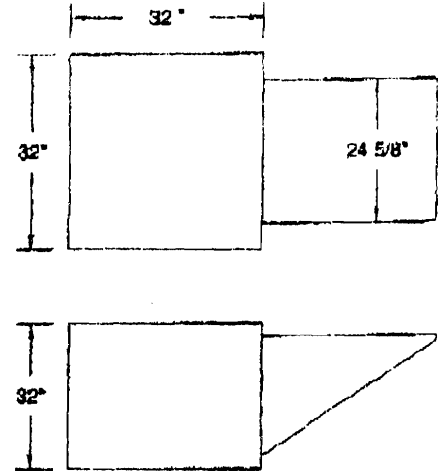

DIMENSIONAL DATA

## 1/2 HP SUPPLY FAN

CFM	.125" S.P.		.250" S.P.		.500" S.P.		.750" S.P.		1.00" S.P.		1.500" S.P.		2.00" S.P.		2.50" S.P.	
	RPM	BHP	RPM	BHP	RPM	BHP	RPM	BHP	RPM	BHP	RPM	BHP	RPM	BHP	RPM	BHP
1200	334	.06	444	.10	637	.18	767	.29	907	.40	1099	.61	1255	.82	1300	1.06
1400	360	.08	459	.12	627	.21	783	.34	909	.46	1109	.70	1270	.94	1406	1.19
1600	379	.11	485	.16	626	.25	774	.37	906	.51	1113	.79	1279	1.08	1422	1.34
1800	389	.15	480	.20	632	.30	766	.41	896	.56	1113	.88	1285	1.18	1431	1.49
2000	416	.19	487	.24	642	.35	769	.47	897	.61	1107	.98	1288	1.31	1436	1.65
2200	444	.24	517	.30	654	.42	774	.54	895	.68	1097	1.02	1283	1.42	1433	1.80
2400	472	.30	536	.36	668	.50	789	.63	899	.77	1089	1.10	1274	1.51	1436	1.95
2600	500	.37	563	.44	683	.58	795	.73	897	.87	1083	1.19	1264	1.60	1429	2.07
2800	530	.45	588	.52	700	.67	808	.83	906	.99	1085	1.31	1255	1.70	1419	2.18
3000	560	.54	614	.62	720	.78	823	.95	918	1.12	1081	1.45	1251	1.83	1409	2.30
3200	590	.65	641	.73	741	.90	838	1.09	931	1.28	1099	1.61	1253	1.99	1401	2.43
3400	621	.77	668	.85	764	1.09	855	1.22	945	1.41	1100	1.78	1258	2.17	1398	2.60
3600	653	.90	687	.98	787	1.19	874	1.37	960	1.58	1120	1.98	1265	2.37	1401	2.80
3800	684	1.05	728	1.14	812	1.34	895	1.54	977	1.75	1132	2.18	1274	2.59	1406	3.03
4000	716	1.21	755	1.30	837	1.52	917	1.73	994	1.95	1146	2.41	1284	2.84	1413	3.28

### STANDARD FEATURES

- HEAVY GAUGE ALUMINUM
- 3-YEAR LIMITED WARRANTY ON ALL ELECTRIC MOTORS
- FACTORY SET DRIVE
- BELT DRIVE MOTORS ARE ENCLOSED IN WEATHER-TIGHT COMPARTMENTS
- VOLTS: 115
- AMPS: 7.2
- WEIGHT: 131 LBS



FANS

P.03-05

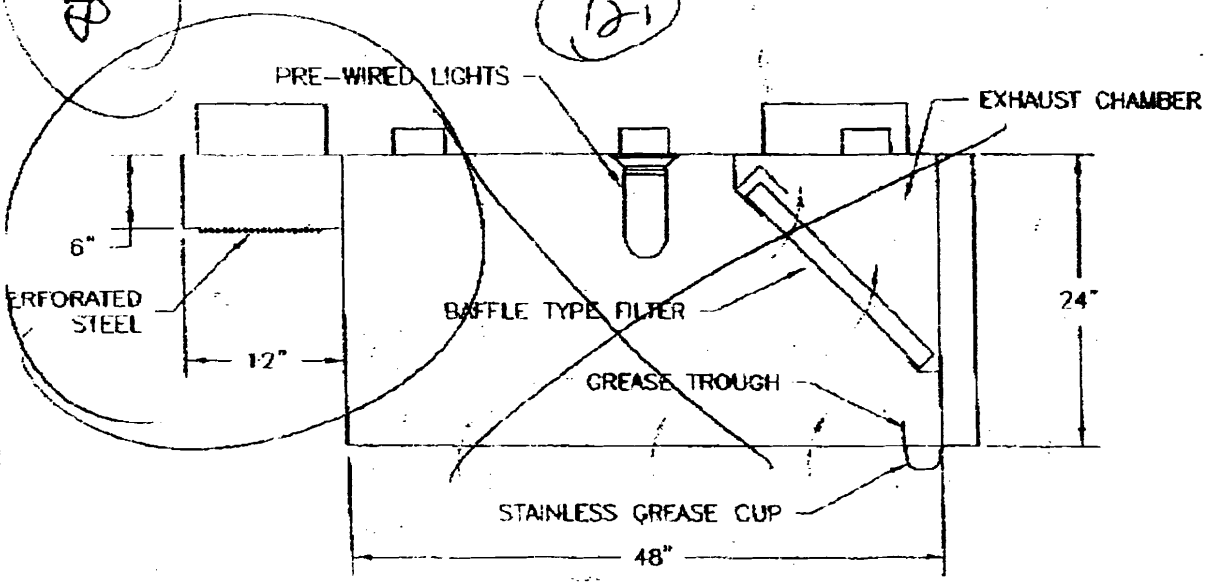
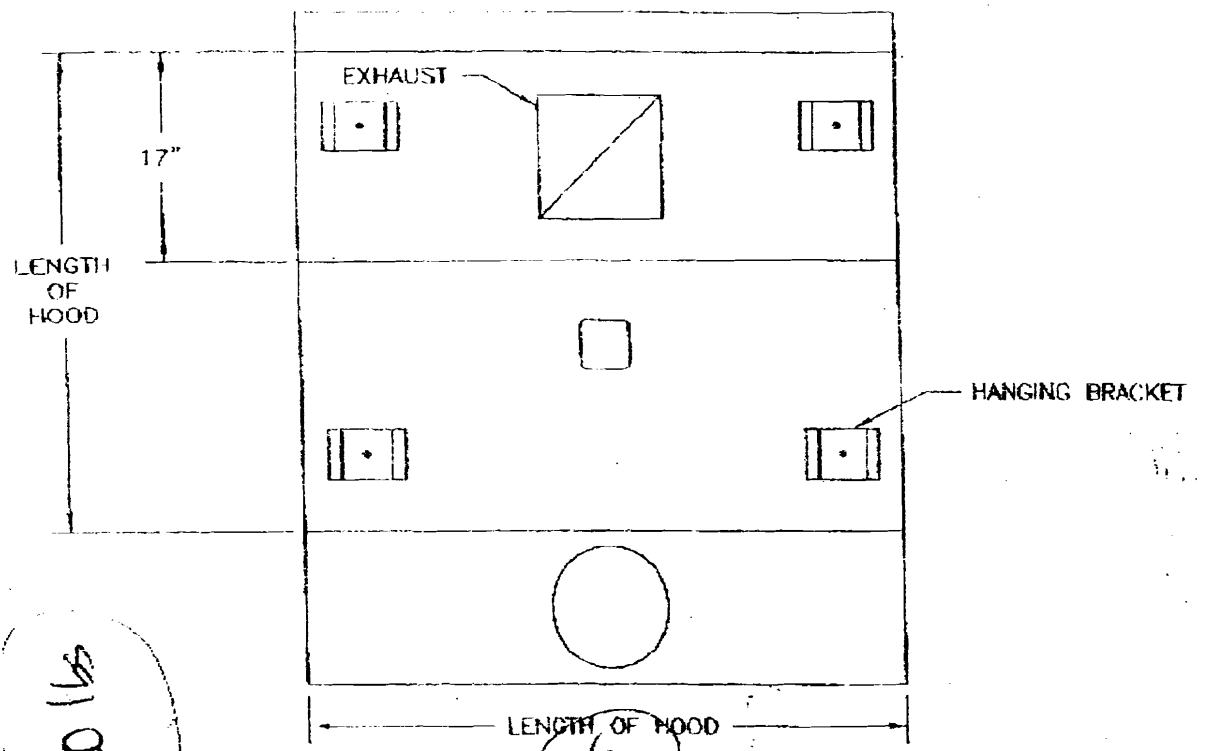

177 REASER COURT P.O. BOX 1377  
 ELYRIA, OHIO 44036-1377  
 TOLL FREE : 1-800-854-3267  
 PHONE: 440-365-4567  
 FAX: 440-365-2100  
 WWW.AMERICANHOOD.COM

**BOX CANOPY W/  
 PERFORATED SUPPLY PLENUM**

MODEL NO. \_\_\_\_\_  
 DELUXE \_\_\_\_\_ HYBRID \_\_\_\_\_ ECONOMY \_\_\_\_\_  
 DELUXE: ALL STAINLESS STEEL  
 HYBRID: FRONT & SIDES STAINLESS  
 TOP & BACK ALUMINIZED  
 ECONOMY: ALL ALUMINIZED

- GENERAL SPECIFICATIONS:
1. Constructed of 16 gauge steel.
  2. All joints are welded liquid tight, without seams by an automatic mig welder.
  3. Hoods are built in accordance to NFPA 96, NSF specifications, & U.L.710.
  4. Grease trough is made to receive grease extracted by the filters.
  5. Grease filters are baffle type (20" wide), carry a U.L. listing, and are made from a light weight aluminum steel.
  6. A stainless steel cup attaches to the grease trough.

PROJECT \_\_\_\_\_  
 LOCATION \_\_\_\_\_  
 JOB NO. \_\_\_\_\_



PERFORATED STEEL

Handwritten circled number '21'

Handwritten circled number '21'

5 VERANDA ST



1) bar support  $\frac{3}{8}$  thread rod into roof truss/Also  $\frac{3}{8}$  Lag into wall

2x12 header  
2x10 truss

4x4 post

2x6 wall to be built with  
 $\frac{3}{8}$  sheet rock both side

Lag into floor

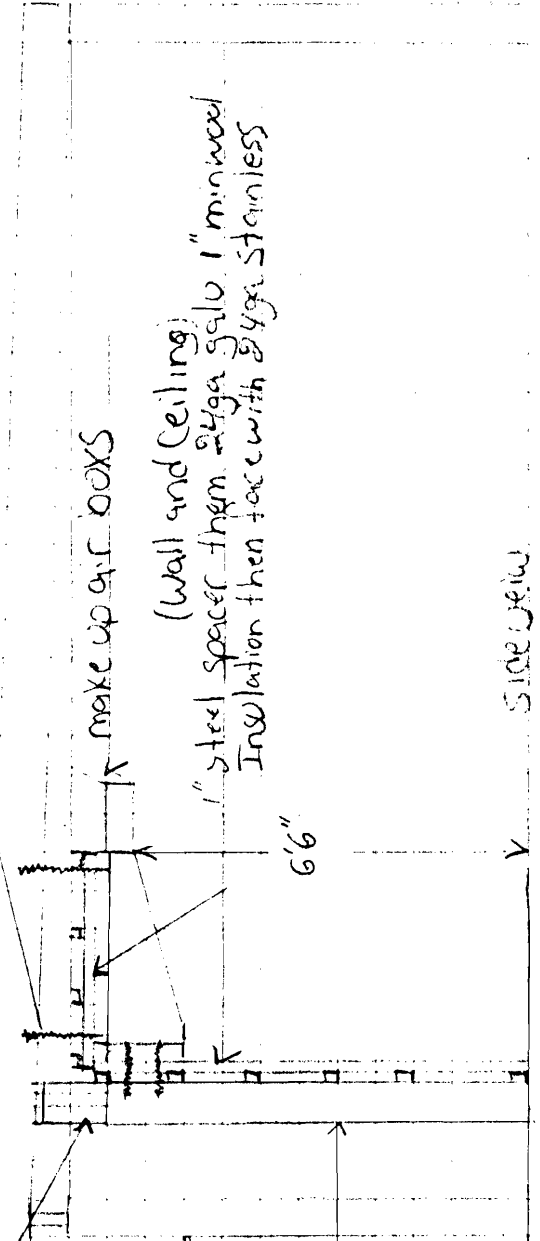

make up air boxes  
(Wall and Ceiling)  
1" steel spacer then 2 1/2 ga galv 1" min wood  
Insulation then face with 2 1/2 ga stainless

6'6"

Side View

5 VERANDA ST

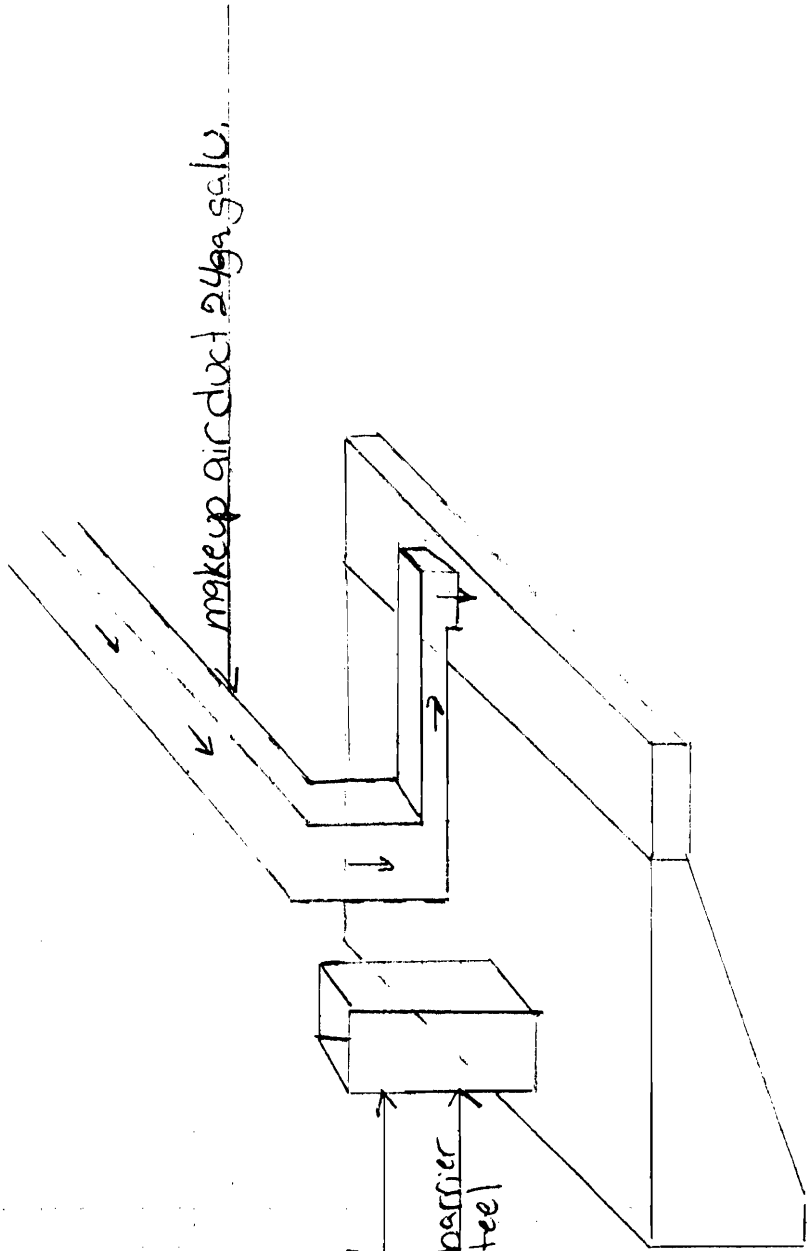

Grease duct 16ga Galu Solid welded

Grease duct to be wrap in 3m fire barrier grease duct wrap and strap with steel bands

S VERANDA ST

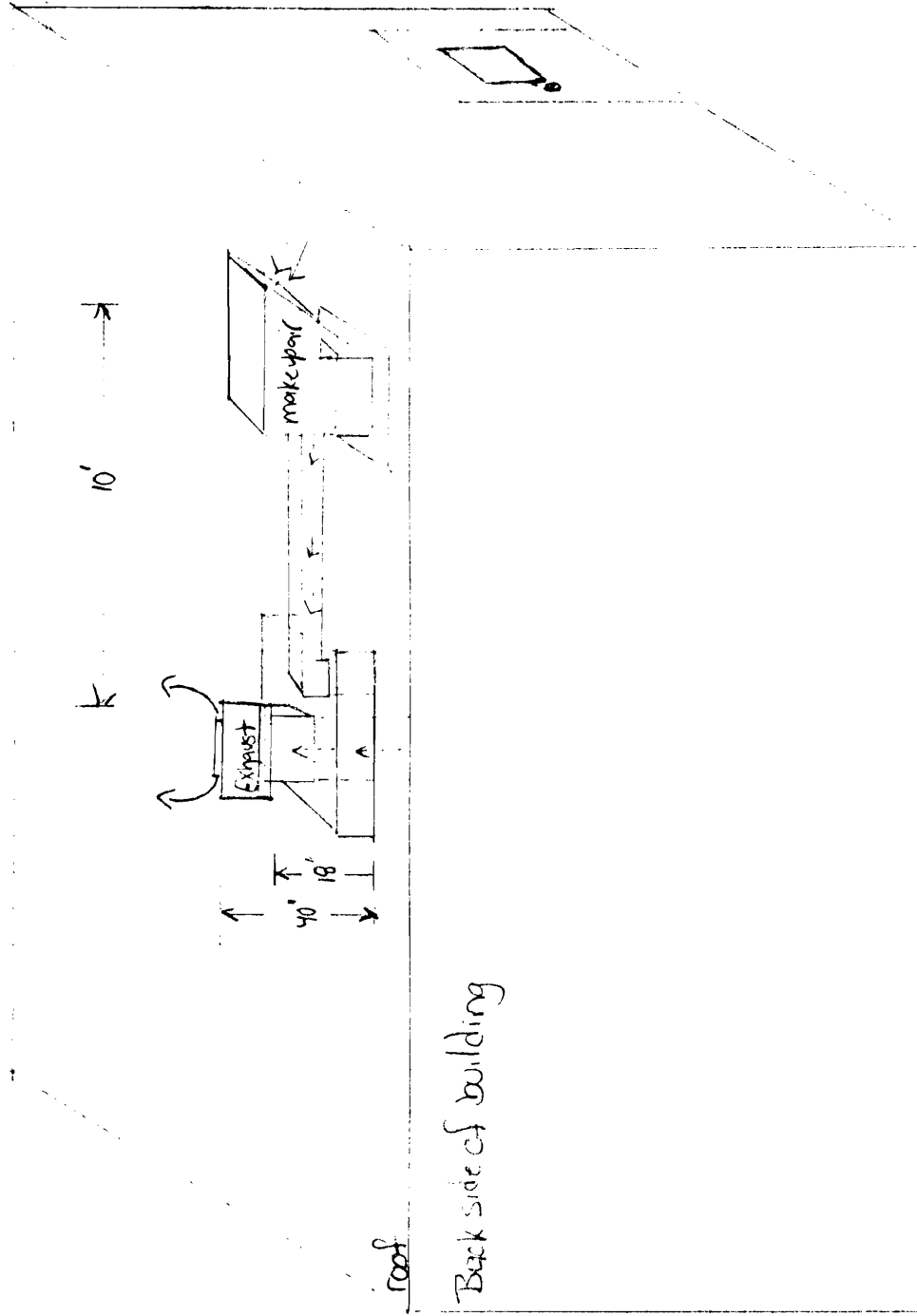

# BUILDING PERMIT INSPECTION PROCEDURES

Please call 874-8703 or 874-8693 (ONLY)

to schedule your inspections as agreed upon

Permits expire in 6 months, if the project is not started or ceases for 6 months.

The Owner or their designee is required to notify the inspections office for the following inspections and provide adequate notice. Notice must be called in 48-72 hours in advance in order to schedule an inspection:

By initializing at each inspection time, you are agreeing that you understand the inspection procedure and additional fees from a "Stop Work Order" and "Stop Work Order Release" will be incurred if the procedure is not followed as stated below.

A Pre-construction Meeting will take place upon receipt of your building permit.

- Footing/Building Location Inspection: Prior to pouring concrete
- Re-Bar Schedule Inspection: Prior to pouring concrete
- Foundation Inspection: Prior to placing ANY backfill
- Framing/Rough Plumbing/Electrical: Prior to any insulating or drywalling
- Final Certificate of Occupancy: Prior to any occupancy of the structure or use. NOTE: There is a \$75.00 fee per inspection at this point.

Certificate of Occupancy is not required for certain projects. Your inspector can advise you if your project requires a Certificate of Occupancy. All projects **DO** require a final inspection

If any of the inspections do not occur, the project cannot go on to the next phase, REGARDLESS OF THE NOTICE OR CIRCUMSTANCES.

N/A CERTIFICATE OF OCCUPANCIES MUST BE ISSUED AND PAID FOR, BEFORE THE SPACE MAY BE OCCUPIED

[Signature]  
Signature of Applicant/Designee

\_\_\_\_\_  
Date

[Signature]  
Signature of Inspections Official

\_\_\_\_\_  
Date

CBL: 729-113

Building Permit #: 08 0145