

City of Portland, Maine - Building or Use Permit Application

389 Congress Street, 04101 Tel: (207) 874-8703, Fax: (207) 874-8716

Permit No: 09-1176	Issue Date:	CBL: 428 L011001
-----------------------	-------------	---------------------

Location of Construction: 38 SAVOY ST	Owner Name: KING ROBERT C & JESSICA M	Owner Address: 38 SAVOY ST	Phone:
Business Name:	Contractor Name: Main Gas	Contractor Address: 908 Roosevelt Trail Windham	Phone 2078926744
Lessee/Buyer's Name	Phone:	Permit Type: HVAC	Zone: R-5

Past Use: Single Family Home	Proposed Use: Single Family Home - install 125 gallon propane tank & Direct vent gas fireplace	Permit Fee: \$60.00	Cost of Work: \$60.00	CEO District: 4
Proposed Project Description: install 125 gallon propane tank & Direct vent gas fireplace		FIRE DEPT: <input type="checkbox"/> Approved <input type="checkbox"/> Denied	INSPECTION: Use Group: R3 Type: SB IRC 2003	
		Signature:	Signature: <i>Jm 10/27/09</i>	
PEDESTRIAN ACTIVITIES DISTRICT (P.A.D.)				
Action: <input type="checkbox"/> Approved <input type="checkbox"/> Approved w/Conditions <input type="checkbox"/> Denied				
Signature: _____ Date: _____				

Permit Taken By: Ldobson	Date Applied For: 10/26/2009	Zoning Approval		
-----------------------------	---------------------------------	------------------------	--	--

<ol style="list-style-type: none"> This permit application does not preclude the Applicant(s) from meeting applicable State and Federal Rules. Building permits do not include plumbing, septic or electrical work. Building permits are void if work is not started within six (6) months of the date of issuance. False information may invalidate a building permit and stop all work.. 	Special Zone or Reviews <input type="checkbox"/> Shoreland <input type="checkbox"/> Wetland <input type="checkbox"/> Flood Zone <input type="checkbox"/> Subdivision <input type="checkbox"/> Site Plan Maj <input type="checkbox"/> Minor <input type="checkbox"/> MM <input type="checkbox"/> <i>OK with conditions</i> Date: <i>10/26/09</i>	Zoning Appeal <input type="checkbox"/> Variance <input type="checkbox"/> Miscellaneous <input type="checkbox"/> Conditional Use <input type="checkbox"/> Interpretation <input type="checkbox"/> Approved <input checked="" type="checkbox"/> Denied Date: _____	Historic Preservation <input checked="" type="checkbox"/> Not in District or Landmark <input type="checkbox"/> Does Not Require Review <input type="checkbox"/> Requires Review <input type="checkbox"/> Approved <input type="checkbox"/> Approved w/Conditions <input type="checkbox"/> Denied Date: _____
---	--	--	--

PERMIT ISSUED

CERTIFICATION

I hereby certify that I am the owner of record of the named property, or that the proposed work is authorized by the owner of record and that I have been authorized by the owner to make this application as his authorized agent and I agree to conform to all applicable laws of this jurisdiction. In addition, if a permit for work described in the application is issued, I certify that the code official's authorized representative shall have the authority to enter all areas covered by such permit at any reasonable hour to enforce the provisions of the code(s) applicable to such permit.

SIGNATURE OF APPLICANT	ADDRESS	DATE	PHONE
RESPONSIBLE PERSON IN CHARGE OF WORK, TITLE		DATE	PHONE

City of Portland, Maine - Building or Use Permit

389 Congress Street, 04101 Tel: (207) 874-8703, Fax: (207) 874-8716

Permit No: 09-1176	Date Applied For: 10/26/2009	CBL: 428 L011001
------------------------------	--	----------------------------

Location of Construction: 38 SAVOY ST	Owner Name: KING ROBERT C & JESSICA M	Owner Address: 38 SAVOY ST	Phone:
Business Name:	Contractor Name: Main Gas	Contractor Address: 908 Roosevelt Trail Windham	Phone (207) 892-6744
Lessee/Buyer's Name	Phone:	Permit Type: HVAC	

Proposed Use: Single Family Home - install 125 gallon propane tank & Direct vent gas fireplace	Proposed Project Description: install 125 gallon propane tank & Direct vent gas fireplace
--	---

Dept: Zoning **Status:** Approved with Conditions **Reviewer:** Marge Schmuckal **Approval Date:** 10/26/2009**Note:** **Ok to Issue:**

- 1) This is NOT an approval for an additional dwelling unit. You SHALL NOT add any additional kitchen equipment including, but not limited to items such as stoves, microwaves, refrigerators, or kitchen sinks, etc. Without special approvals.
- 2) This property shall remain a single family dwelling. Any change of use shall require a separate permit application for review and approval.
- 3) This permit is being approved on the basis of plans submitted. Any deviations shall require a separate approval before starting that work.

Dept: Building **Status:** Approved with Conditions **Reviewer:** Tom Markley **Approval Date:** 10/27/2009**Note:** **Ok to Issue:**

- 1) The installation must comply with the State of Maine Gas Regulations.
- 2) Application approval based upon information provided by applicant. Any deviation from approved plans requires separate review and approval prior to work.

PERMIT ISSUED

OCT 26 2009

City of Portland



Mail Permit Clearance

FILL IN AND SIGN WITH INK

APPLICATION FOR PERMIT HEATING OR POWER EQUIPMENT

PERMIT ISSUED

OCT 26 2009

To the INSPECTOR OF BUILDINGS, PORTLAND, ME.

City of Portland

The undersigned hereby applies for a permit to install the following heating, cooking or power equipment in accordance with the Laws of Maine, the Building Code of the City of Portland, and the following specifications:

Location / CBL 38 Savoy Street - 428-L-11 Use of Building Single family Date 10/26/09
 Name and address of owner of appliance Robert King
38 Savoy St., Portland ME 04103
 Installer's name and address Maingas, 908 Roosevelt Trl. Windham
ME, 04062 Telephone 892-6747

Location of appliance:

- Basement Floor
 Attic Roof

Type of Fuel:

- Gas Oil Solid

Appliance Name: Direct Vent gas fireplace

U.L. Approved Yes No

Will appliance be installed in accordance with the manufacture's installation instructions? Yes No

IF NO Explain: _____

The Type of License of Installer:

- Master Plumber # _____
 Solid Fuel # _____
 Oil # _____
 Gas # Maingas
 Other _____

Type of Chimney:

- Masonry Lined
 Factory built _____
 Metal
 Factory Built U.L. Listing # _____
 Direct Vent
 Type Thru Wall UL# _____

Type of Fuel Tank

- Oil
 Gas

Size of Tank 125 gallons

Number of Tanks 1

Distance from Tank to Center of Flame 13 feet.

Cost of Work: \$ 300.00

Permit Fee: \$ 30 + 30 per tank 60

RECEIVED
 OCT 26 2009
 Dept. of Building Inspections
 City of Portland Maine

Approved

Approved with Conditions

Fire: _____

Ele.: _____

Bldg.: _____

- See attached letter or requirement

Inspector's Signature

Date Approved

Signature of Installer [Signature]



INSTALLATION INSTRUCTIONS AND OWNER'S MANUAL

The Tahoe Direct Vent Zero Clearance Gas
Fireplace Heater

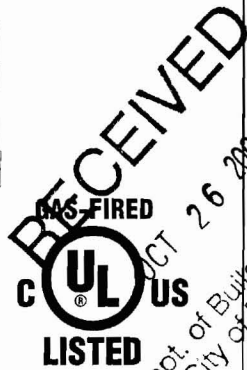
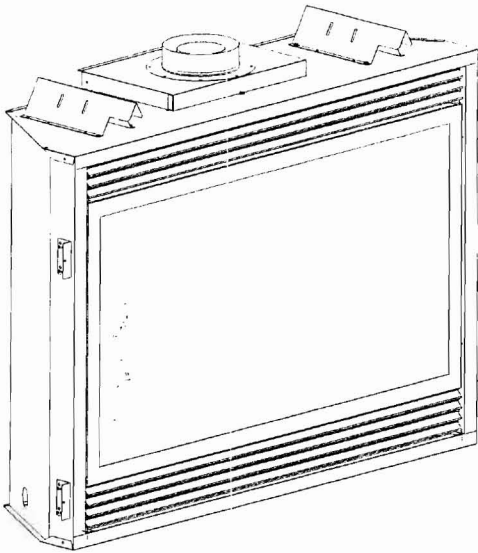

DIRECT VENT GAS FIREPLACE HEATER

MODEL SERIES

MILLIVOLT

- DVD32FP3(0,1,2,3)(N,P)-1
- DVD36FP3(0,1,2,3)(N,P)-1
- DVD42FP3(0,1,2,3)(N,P)-1
- DVD48FP3(0,1,2,3)(N,P)-1

DIRECT IGNITION

- DVD32FP5(0,1,2,3)N-2
- DVD36FP5(0,1,2,3)N-2
- DVD42FP5(0,1,2,3)N-2
- DVD48FP5(0,1,2,3)N-2

UL FILE NO. MH30033

Installer: Leave this manual with the appliance.
Consumer: Retain this manual for future reference.

WARNING: If the information in these instructions are not followed exactly, a fire or explosion may result causing property damage, personal injury or loss of life.

- Do not store or use gasoline or other flammable vapors and liquids in the vicinity of this or any other appliance.
- **WHAT TO DO IF YOU SMELL GAS**
 - Do not try to light any appliance.
 - Do not touch any electrical switch; do not use any phone in your building.
 - Immediately call your gas supplier from a neighbor's phone. Follow the gas supplier's instructions.
 - If you cannot reach your gas supplier, call the fire department.
- Installation and service must be performed by a qualified installer, service agency or the gas

NATIONAL
FIREPLACE
INSTITUTE



CERTIFIED
www.nficertified.org

We suggest that our gas hearth products be installed and serviced by professionals who are certified in the U.S. by the National Fireplace Institute® (NFI) as NFI Gas Specialists.

This appliance may be installed in an aftermarket, permanently located, manufactured home (USA only) or mobile home, where not prohibited by state or local codes.

This appliance is only for use with the type of gas indicated on the rating plate. This appliance is not convertible for use with other gases, unless a certified kit is used.

WARNING: If not installed, operated and maintained in accordance with the manufacturer's instructions, this product could expose you to substances in fuel or from fuel combustion which can cause death

INSTALLATION INSTRUCTIONS

ROUND HORIZONTAL VENT TERMINATION KIT DVVK-4RE-1 FOR DIRECT VENT FIREPLACE HORIZONTAL TERMINATION

FOR USE ON THE FOLLOWING MODELS:

- (A)DVD32FP SERIES
- (A)DVD36FP SERIES
- (A)DVD42FP SERIES
- (A)DVD48FP SERIES
- (A) DVP36FP SERIES

EFFECTIVE DATE AUGUST, 2006

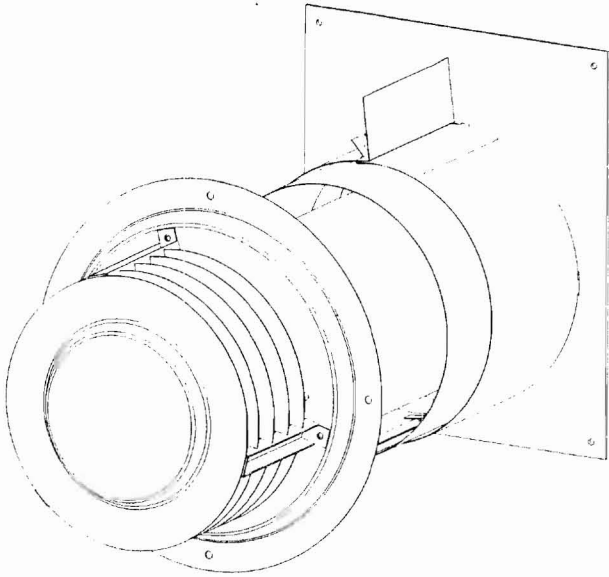

CAUTION: Sharp edges, use protective gloves when installing.

Tools Needed for Installation:

- Sheet metal snips
- 5/16" nut driver
- Phillips head screwdriver - #2
- High temperature sealant or furnace cement rated for continuous use at 1,000°F minimum
- Measuring tape

Parts Verification

See parts list on page 3 to verify components included in this vent kit prior to installation.

NOTE: If installing onto wood, lap, or vinyl siding, the vinyl siding kit should be used (sold separately, part number DV-822).

The vinyl siding vent kit, DV-822, is available from Empire Comfort Systems, Inc. The depth is 3" (76mm), which enables the vent cap to be extended away from vinyl siding or projections. The wall depth plus the additional 3" (76mm) depth of the vinyl siding vent cap extension should not exceed a total depth of 13 3/4" (349mm).

If wall depth exceeds 13 3/4" (349mm), extend system using 6 5/8" (168mm) x 4" (102mm) rigid venting (See Fireplace Instructions for approved lengths) See Figure 2.

Installing Wall Thimble/Firestop Assembly

1. Fix fireplace to permanent location. If using rigid venting system, install up to the location where it will exit the building.
2. Cut hole in wall for wall thimble/firestop assembly (Figure 1) into your combustible wall. Note: On brick or block exterior wall a 7" (178mm) diameter hole needs to be cut.

Measure the total wall thickness to determine whether or not the extension thimble is to be used. If the combustible wall depth is over 5 3/8" (137mm), then the extension thimble should be used (Figure 1).

3. Install the wall thimble assembly through the framed opening so the firestop plate is on the interior wall (Figure 1). Telescope section should extend all the way through the exterior wall. Attach with (4) 10 x 1" screws.
4. When placing the vent cap on an exterior wall covered with combustibles such as wood, lap, or vinyl siding, install the vinyl siding kit to the exterior wall sheathing.

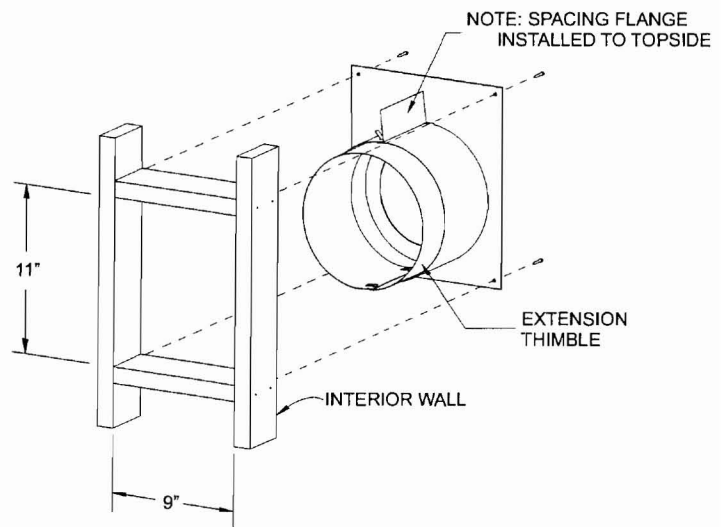

Figure 1

CLEARANCES

Clearance to Combustibles	
Back	0" (0 mm)
Side	0" (0 mm)
Floor	0" (0 mm)
Top Stand-off	0" (0 mm)
Top Framing Edge	3" (76 mm)

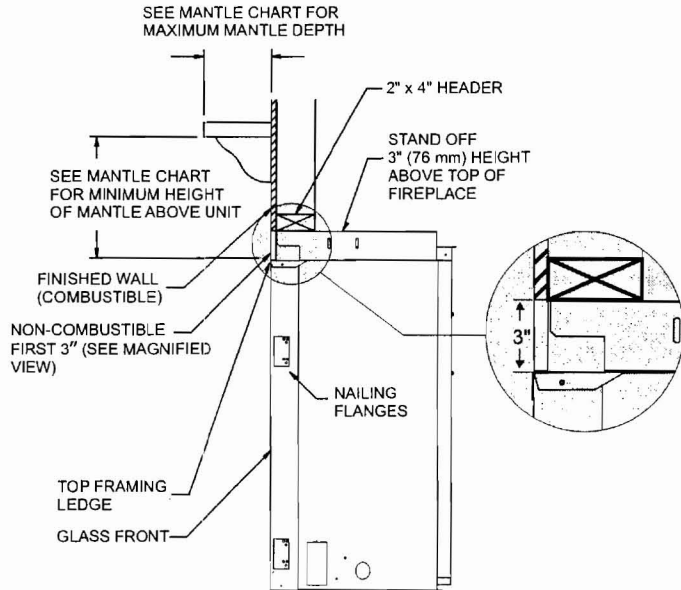

Figure 2

Combustible Material

No greeting cards, stockings or ornamentation of any type should be placed on or attached to the fireplace. The flow of heat can ignite combustibles.

Note: When using Empire EMBF, UMC, and UMF Series Full Mantels with DVD32 and DVD36 Series Fireplaces, combustible clearance may be reduced to 1" clearance from top edge of fireplace face.

Mantel Chart (Figure 3)

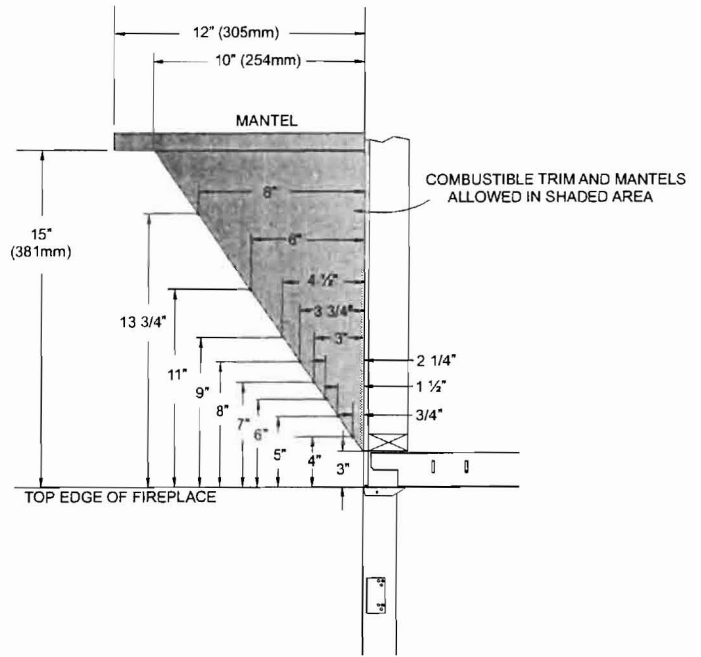

Figure 3

Clearances (Figure 4)

Clearance from top front edge of fireplace to ceiling is 36"
Clearance from side of fireplace to adjacent sidewall is 6".

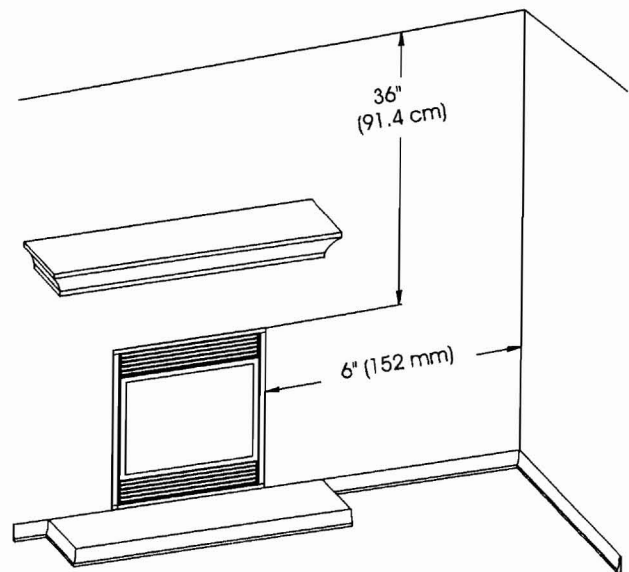

Figure 4

Savoy St.

Neighbor
Driveway

38 Savoy
St.
driveway

38
Savoy St.
House

fence

window 7/6" from ground

TANK

Deck

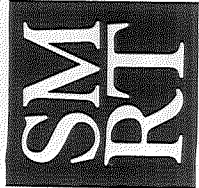

ARCHITECTURE
ENGINEERING
PLANNING

144 Fore Street
PO Box 618
Portland, Maine 04104
☎ 207 772-3846
📠 207 772-1070

www.smrtinc.com

AAC002168

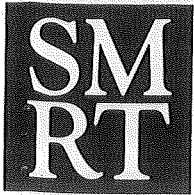

ARCHITECTURE
ENGINEERING
PLANNING

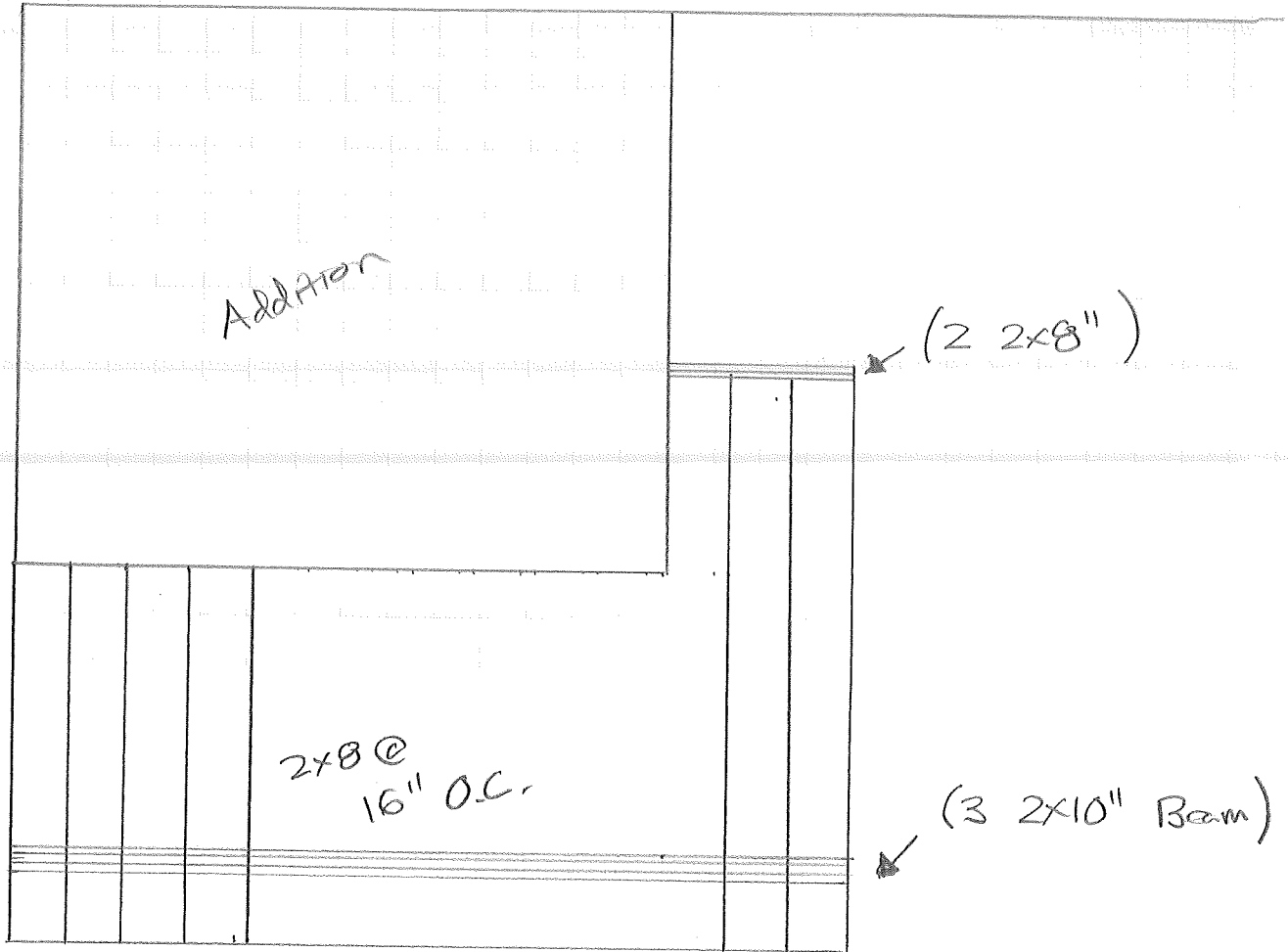

Deck Frame

- 2x8" P.T. @ 16" O.C.
- Girder (3 2x10" P.T.)

Stair Detail

- Refer to previous deck & stair detail

144 Fore Street
PO Box 618
Portland, Maine 04104

☎ 207 772-3846
📠 207 772-1070

www.smrtinc.com