

# Plot Plan (3)

THIS IS NOT A BOUNDARY SURVEY

This copyrighted document expires 10-05-12. Reproduction and/or dissemination after this date is unauthorized.  
 MORTGAGE INSPECTION OF: DEED BOOK 15835 PAGE 280 COUNTY Cumberland  
 PLAN BOOK --- PAGE --- LOT ---

ADDRESS: 593 Washington Avenue, Portland, Maine

Job Number: 752-75-R

Inspection Date: 7-05-12

Scale: 1" = 30'

Buyer: MECAP LLC

Seller: Gregory P. O'Donnell, Sr.



Presumpscot Street

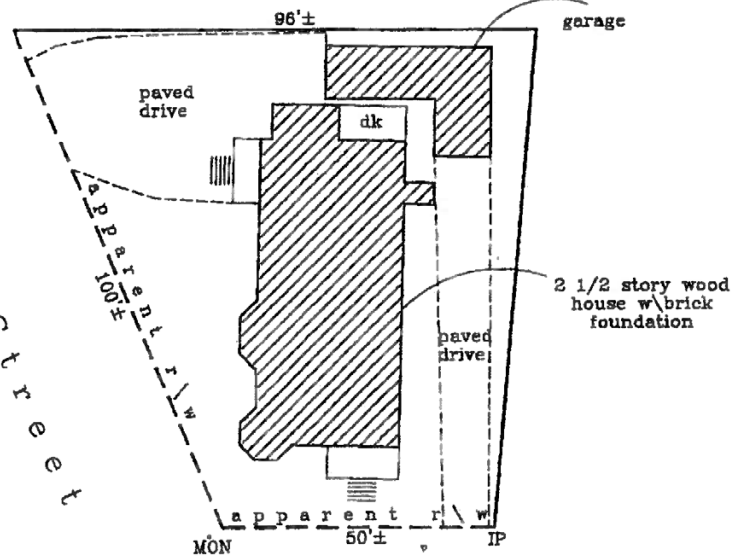

Washington Avenue



I HEREBY CERTIFY TO: Terry N. Snow, P.A.; the Lender  
and First American Title Ins. Co.

Monuments found did not conflict with the deed description.

The dwelling setbacks do not violate town zoning requirements.

As delineated on the Federal Emergency Management Agency Community Panel 230051-0007 C:

The structure does not fall within the special flood hazard zone.

The land does not fall within the special flood hazard zone.

A wetlands study has not been performed.

APPARENT EASEMENTS AND RIGHTS OF WAY ARE SHOWN. OTHER ENCUMBRANCES, RECORDED OR NOT, MAY EXIST. THIS SKETCH WILL NOT REVEAL ABUTTING DEED CONFLICTS, IF ANY.

copyright 1994

**Livingston - Hughes**  
 Professional Land Surveyors & Foresters  
 88 Guinea Road  
 Kennebunkport - Maine 04046  
 207-967-9761 phone 207-967-4831 fax

THIS SKETCH IS FOR MORTGAGE PURPOSES ONLY