

DISPLAY THIS CARD ON PRINCIPAL FRONTAGE OF WORK CITY OF PORTLAND

BUILDING DEPARTMENT

PERMIT

Permit Number: 081533

Please Read
Application And
Notes, If Any,
Attached

This is to certify that QUELETTE THOMAS L VNI T TD & ALITS

has permission to Install Hot Tub on 10'x12' brick io

AT 36 ARCADIA ST CB 427 F010001

provided that the person or persons, firm or corporation accepting this permit shall comply with all of the provisions of the Statutes of Maine and of the Ordinances of the City of Portland regulating the construction, maintenance and use of buildings and structures, and of the application on file in this department.

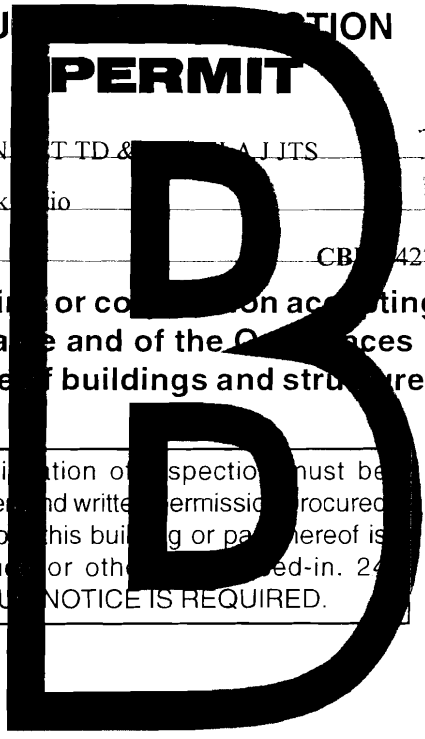

Apply to Public Works for street line and grade if nature of work requires such information.

Notification of inspection must be given and written permission procured before this building or part thereof is lathed or otherwise red-in. 24 HOURS NOTICE IS REQUIRED.

A certificate of occupancy must be procured by owner before this building or part thereof is occupied.

OTHER REQUIRED APPROVALS

Fire Dept. _____

Health Dept. _____

Appeal Board _____

Other _____
Department Name

James A. Manley 12/12/08
Director - Building & Inspection Services

PENALTY FOR REMOVING THIS CARD

City of Portland, Maine - Building or Use Permit Application

389 Congress Street, 04101 Tel: (207) 874-8703, Fax: (207) 874-8716

Permit No: 08-1533	Issue Date:	CBL: 427 F010001
-----------------------	-------------	---------------------

Location of Construction: 36 ARCADIA ST	Owner Name: OUELLETTE THOMAS L VN VE	Owner Address: 34 ARCADIA ST	Phone: 207-761-5607
Business Name:	Contractor Name:	Contractor Address:	Phone:
Lessee/Buyer's Name	Phone:	Permit Type: Additions - Duplex	Zone: R-5

Past Use: Two Family Home	Proposed Use: Two Family Home - Install Hot Tub on 10'x12' brick Patio	Permit Fee: \$70.00	Cost of Work: \$5,000.00	CEO District: 4	4,500 [#]
------------------------------	---	------------------------	-----------------------------	--------------------	--------------------

Proposed Project Description: Install Hot Tub on 10'x12' brick Patio <i>legal two family residential</i>	FIRE DEPT: <input type="checkbox"/> Approved <input type="checkbox"/> Denied	INSPECTION: Use Group: R3 Type: SB IRC 2003
	Signature:	Signature: <i>Jan 12/12/08</i>
PEDESTRIAN ACTIVITIES DISTRICT (P.A.D.) Action: <input type="checkbox"/> Approved <input type="checkbox"/> Approved w/Conditions <input type="checkbox"/> Denied Signature: _____ Date: _____		

Permit Taken By: Imd	Date Applied For: 12/10/2008	Zoning Approval
-------------------------	---------------------------------	------------------------

1. This permit application does not preclude the Applicant(s) from meeting applicable State and Federal Rules. 2. Building permits do not include plumbing, septic or electrical work. 3. Building permits are void if work is not started within six (6) months of the date of issuance. False information may invalidate a building permit and stop all work..	Special Zone or Reviews <input type="checkbox"/> Shoreland <input type="checkbox"/> Wetland <input type="checkbox"/> Flood Zone <input type="checkbox"/> Subdivision <input type="checkbox"/> Site Plan Maj <input type="checkbox"/> Minor <input type="checkbox"/> MM <input type="checkbox"/> Denied	Zoning Appeal <input type="checkbox"/> Variance <input type="checkbox"/> Miscellaneous <input type="checkbox"/> Conditional Use <input type="checkbox"/> Interpretation <input type="checkbox"/> Approved <input type="checkbox"/> Denied	Historic Preservation <input checked="" type="checkbox"/> Not in District or Landmark <input type="checkbox"/> Does Not Require Review <input type="checkbox"/> Requires Review <input type="checkbox"/> Approved <input type="checkbox"/> Approved w/Conditions <input type="checkbox"/> Denied
	Date: <i>12/11/08</i>	Date: _____	Date: _____

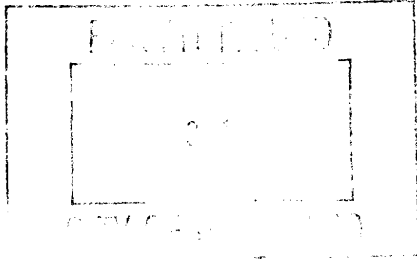

CERTIFICATION

I hereby certify that I am the owner of record of the named property, or that the proposed work is authorized by the owner of record and that I have been authorized by the owner to make this application as his authorized agent and I agree to conform to all applicable laws of this jurisdiction. In addition, if a permit for work described in the application is issued, I certify that the code official's authorized representative shall have the authority to enter all areas covered by such permit at any reasonable hour to enforce the provision of the code(s) applicable to such permit.

SIGNATURE OF APPLICANT ADDRESS DATE PHONE

RESPONSIBLE PERSON IN CHARGE OF WORK, TITLE DATE PHONE



General Building Permit Application

If you or the property owner owes real estate or personal property taxes or user charges on any property within the City, payment arrangements must be made before permits of any kind are accepted.

Location/Address of Construction: <u>34 ARCADIA Street</u>		
Total Square Footage of Proposed Structure/Area <u>10 x 10</u>	Square Footage of Lot <u>4500</u>	Number of Stories <u>3</u>
Tax Assessor's Chart, Block & Lot Chart# Block# Lot# <u>421 F 10</u>	Applicant * must be owner, Lessee or Buyer * Name <u>PAMELA J OUELLETTE</u> <u>THOMAS</u> Address <u>34 ARCADIA Street</u> City, State & Zip <u>PORT ME 04103</u>	Telephone: <u>7615607</u>
Lessee/DBA (If Applicable) <u>DEC 10 2007</u>	Owner (if different from Applicant) Name Address City, State & Zip	Cost Of Work: \$ <u>5,000</u> C of O Fee: \$ _____ Total Fee: \$ <u>700⁰⁰</u>
Current legal use (i.e. single family) <u>2 FAMILY</u> Number of Residential Units <u>2</u> If vacant, what was the previous use? _____ Proposed Specific use: <u>BATHS 2 Family</u> Is property part of a subdivision? <u>NO</u> If yes, please name _____ Project description: <u>INSTALLING HOT TUB ON BRK 12" SQUARE PAD 10'X12' IN BACK YARD 5' FROM FENCE POST.</u>		
Contractor's name: _____ Address: _____ City, State & Zip _____ Telephone: _____ Who should we contact when the permit is ready: <u>THOMAS L. OUELLETTE</u> Telephone: <u>761-5607</u> Mailing address: <u>34 ARCADIA ST. PORT. ME. 04103</u>		

Please submit all of the information outlined on the applicable Checklist. Failure to do so will result in the automatic denial of your permit.

In order to be sure the City fully understands the full scope of the project, the Planning and Development Department may request additional information prior to the issuance of a permit. For further information or to download copies of this form and other applications visit the Inspections Division on-line at www.portlandmaine.gov, or stop by the Inspections Division office, room 315 City Hall or call 874-8703.

I hereby certify that I am the Owner of record of the named property, or that the owner of record authorizes the proposed work and that I have been authorized by the owner to make this application as his/her authorized agent. I agree to conform to all applicable laws of this jurisdiction. In addition, if a permit for work described in this application is issued, I certify that the Code Official's authorized representative shall have the authority to enter all areas covered by this permit at any reasonable hour to enforce the provisions of the codes applicable to this permit.

Signature: Thomas L. Ouellette Date: 12-10-08

This is not a permit; you may not commence ANY work until the permit is issue

City of Portland, Maine - Building or Use Permit

389 Congress Street, 04101 Tel: (207) 874-8703, Fax: (207) 874-8716

Permit No: 08-1533	Date Applied For: 12/10/2008	CBL: 427 F010001
-----------------------	---------------------------------	---------------------

Location of Construction: 36 ARCADIA ST	Owner Name: OUELLETTE THOMAS L VN VE	Owner Address: 34 ARCADIA ST	Phone: 207-761-5607
Business Name:	Contractor Name:	Contractor Address:	Phone:
Lessee/Buyer's Name	Phone:	Permit Type: Additions - Duplex	

Proposed Use: Two Family Home - Install Hot Tub on 10'x12' brick Patio	Proposed Project Description: Install Hot Tub on 10'x12' brick Patio
---	---

Dept: Zoning **Status:** Approved with Conditions **Reviewer:** Marge Schmuckal **Approval Date:** 12/11/2008

Note: **Ok to Issue:**

- 1) It is understood that the base of the hot tub is to be composed of 12 inch pavers. Your plans are also showing another area of 12" pavers behind the house. Please note that if your plans change to either construct a wooden platform or to pour a concrete pad, different setback requirements shall be different for your hot tub. BEFORE you do any changes, you must first get reviewed and approved under an amended permit.
- 2) Separate permits shall be required for future decks, sheds, pools, and/or garages. It is noted that your plot plan shows a tool shed at the rear of your property. Our files show that the shed has not been permitted as required. It is closer to the property lines than allowed under zoning. It is necessary to correct the shed situation at this time. A permit application shall be required. The shed will need to be moved to meet the current ordinances.
- 3) This is NOT an approval for an additional dwelling unit. You SHALL NOT add any additional kitchen equipment including, but not limited to items such as stoves, microwaves, refrigerators, or kitchen sinks, etc. Without special approvals.
- 4) This property shall remain a two (2) family dwelling. Any change of use shall require a separate permit application for review and approval.
- 5) This permit is being approved on the basis of plans submitted. Any deviations shall require a separate approval before starting that work.

Dept: Building **Status:** Approved with Conditions **Reviewer:** Tom Markley **Approval Date:** 12/12/2008

Note: **Ok to Issue:**

- 1) Separate permits are required for any electrical, plumbing, HVAC or exhaust systems. Separate plans may need to be submitted for approval as a part of this process.
- 2) Application approval based upon information provided by applicant. Any deviation from approved plans requires separate review and approval prior to work.

Comments:

12/10/2008-lmd: Property owner will submit information on the cover of the hot tub ASAP



Print

Subject **FW: FW: garnett**
From: **Virginia Kent** <vkent@sourcenetworksam.com>
Sent: **Nov 24, 2008 03:00:01 PM**
To: **touellet@maine.rr.com**
CC: **kdogsgirl@verizon.net**

This is what the manufacture sent me –hope it helps

From: Misti M. Savolainen [mailto:qcaspas@qcaspas.com]
Sent: Monday, November 24, 2008 8:53 AM
To: Virginia Kent
Subject: re: FW: garnett

Virginia,

Here ya go!

87 L x 87 W x 36 D

Lucite Acrylic Surface Material (Caribbean Blue)

240 Volt

(90) Two-toned Graphite Gray jets

Adjustable Waterfall

Dual Adjustable Collar jets

(2) 4 HP Pump

(1) 2 HP Air Blower

New Luran Cabinetry

Ozone Ready

12 Volt Starburst LED Light

Rigid Cover

Rigid Cover

Thanks,

Misti

>

Misty-Can you send the specs dimensions of the Garnett Model 8A this customer says they can not find it in the manuel.Thanks

From: PAM [mailto:touellet@maine.rr.com]
Sent: Friday, November 21, 2008 5:47 PM
To: Virginia Kent
Subject: Re: garnett
Importance: High

Hi Virginia,

My dad is looking for the spa specs which are no where in this manual?? Can you please send us something w/the specs dimensions on it?? Perhaps we are missing it here, but 4 of us have gone through it, and there are no dimensions here.

ThankYou,

Thomas Ouellette

& Daughter.

----- Original Message -----

From: Virginia Kent
To: touellet@maine.rr.com
Cc: kdogsgirl@verizon.net
Sent: Friday, November 21, 2008 5:23 PM
Subject: FW: garnett

Mr. Ouellette



Pool Installation/Construction Checklist

All of the following information is required and must be submitted. Checking off each item as you prepare your application package will ensure your package is complete and will help to expedite the permitting process.

- A plot plan showing the shape and dimension of the lot, footprint of the pool and its distance from the actual property lines, and the principal structure. Include any decks or accessory structures
- A complete set of plans that include structural details, size and dimensions and a cross section showing the slope and depth ratios, or for above ground pool, design specifications. Often this information can be obtained from the manufacturer.
- A complete set of construction details for any accessory structures or decks including: pier or foundation layout, framing, fastenings, guards/handrails, baluster spacing and stair dimensions
- Details of required barrier protection including the design of fencing, gates, latches, ladders, or audible alarms (if applicable). Please show where they will be located and how they are constructed. This information can often be obtained from the manufacturer
- Proof of ownership is required if it is inconsistent with the assessors records

**All pool installations must be conducted in compliance with the
IRC 2003 Building Code Appendix G**

Separate permits are required for HVAC, and electrical installations.

Permit Fee: \$30.00 for the first \$1000.00 construction cost, \$9.00 per additional \$1000.00 cost

This is not a Permit; you may not commence any work until the Permit is issued.

BUILD A SPA TO FIT YOUR LIFE

ALL KEYS® SPAS FEATURES:

- Premium Pumps for High Performance and Energy Efficiency
- Balanced Jet System for Increased Waterflow
- State-of-the-Art Topside Digital Controls
- Reflective Thermal Wrap Insulation
- Spa Light
- Removable Panels
- *Ozone Ready
- 240 Volt Service
- UL Listed
- Warranty: 5 Yr Shell; 2 Yr Pump/Electronics with every KB700 Series Spa.

Exclusive Home Depot Upgrade

\$1396 Savings

WITH EVERY KB700 SERIES SPA PURCHASE

- Cutside Delivery (\$399 Value)
- Internal Looking Marine Grade Vinyl Cover (\$399 Value)
- Upgraded No Maintenance Cabinet (\$499 Value)
- LED Mood Light

*Ozone Ready - All necessary plumbing installed. Requires ozone generator.
 † P of pump refers to "Brake Horsepower"

KB741 7 PERSON SPA



- 7 Person Capacity
- Ergonomic Barrier-Free Seating
- 84" x 84" x 36"
- Premium Silver Marble Shell
- Maintenance-Free Redwood Cabinet
- *4.0 hp Pump
- 1.0 hp Blower
- *Ozone Ready
- 41 Jets Including:
 - 1 Waterfall
 - 10 Air Injectors
 - 5 Directional
 - 6 Large Pulsing
 - 4 Neck
 - 11 Small Whirly
 - 2 Massage
 - 1 Volcano
 - 1 Ozone

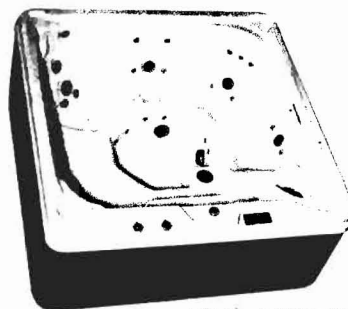

HD Sku# 878-701

KB741CD 7 PERSON SPA

ADD: AQUA SONIC STEREO PACKAGE

\$4,699

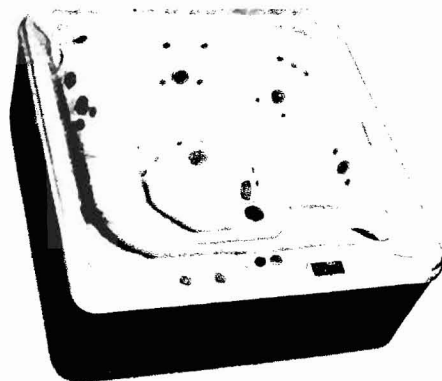

HD Sku# 878-794



- 7 Person Capacity
- Ergonomic Barrier-Free Seating
- 84" x 84" x 36"
- Premium Silver Marble Shell
- Maintenance-Free Redwood Cabinet
- *4.0 hp Pump
- 1.0 hp Blower
- *Ozone Ready
- AM/FM/CD Stereo
 - Internal Speakers
 - Sub Woofer
 - Topside Remote
- 41 Jets Including:
 - 1 Waterfall
 - 10 Air Injectors
 - 5 Directional
 - 6 Large Pulsing
 - 4 Neck
 - 11 Small Whirly
 - 2 Massage
 - 1 Volcano
 - 1 Ozone

Handwritten notes:
 150
 12
 300
 150
 1800
 p 12 - 11 - 12 - 12

KB776 7 PERSON SPA

ADD: POWER MAX TURBO PACKAGE

\$4,999

- 7 Person Capacity
- Ergonomic Barrier-Free Seating
- 84" x 84" x 36"
- Premium Silver Marble Shell
- Maintenance-Free Redwood Cabinet
- *Pump 1: 6.0 HP
- *Pump 2: 5.0 HP
- 1.0 hp Blower
- *Ozone Ready
- 76 Jets Including:
 - 1 Waterfall
 - 10 Air Injectors
 - 5 Directional
 - 6 Large Pulsing
 - 4 Neck
 - 46 Small Whirly
 - 2 Massage
 - 1 Volcano
 - 1 Ozone

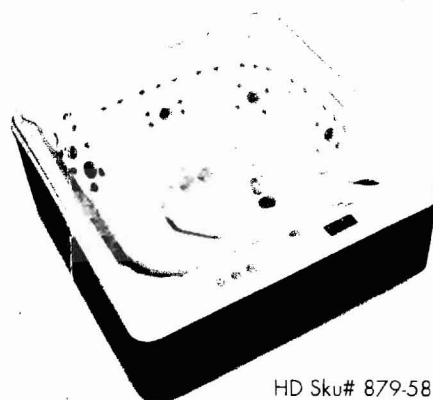

HD Sku# 879-581

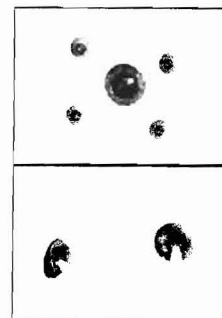

Model No. M100A1L

QUESTIONS?

As a manufacturer, we are committed to provide complete customer satisfaction. If you have questions, or if there are missing or damaged parts, we will guarantee complete satisfaction through direct assistance from our factory.

TO AVOID UNNECESSARY DELAYS, PLEASE CALL DIRECT TO OUR TOLL-FREE CUSTOMER HOT LINE. The trained technicians on our customer hot line will provide timely assistance, free of charge to you.

**CUSTOMER HOT LINE:
1-877-897-7493
24 Hours a Day, 7 Days a Week**

CAUTION

Read all precautions and instructions in this manual before using this equipment. Save this manual for future reference.

Use the Infinity Spas coverlift only as described in this manual. Inspect and tighten all parts regularly; replace any worn or missing parts immediately.

!! WARNING !!

The Lower Support Arm and Lower Coupler are not intended to assist in opening or closing of the coverlift.

DO NOT step on or lift with the Lower Support Arm or Lower Coupler. Doing so could cause injury to you or may damage the coverlift.

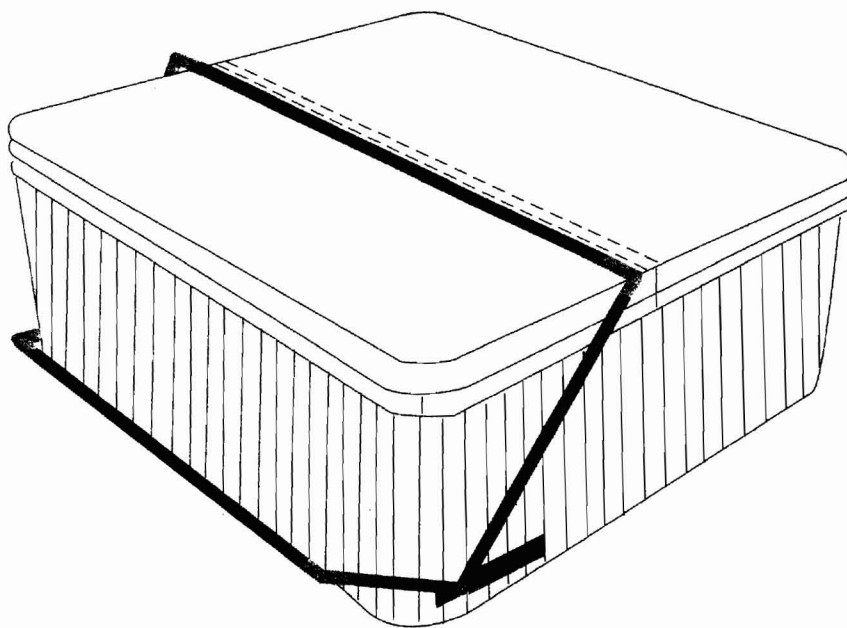

SPA COVERLIFT User's Manual

Rev A
3/19/08
P/N 173794

Copy for permit

*BIG BOX
TUB SHUTOFF
EMERGENCY SWITCH
5 Feet From
TUB*

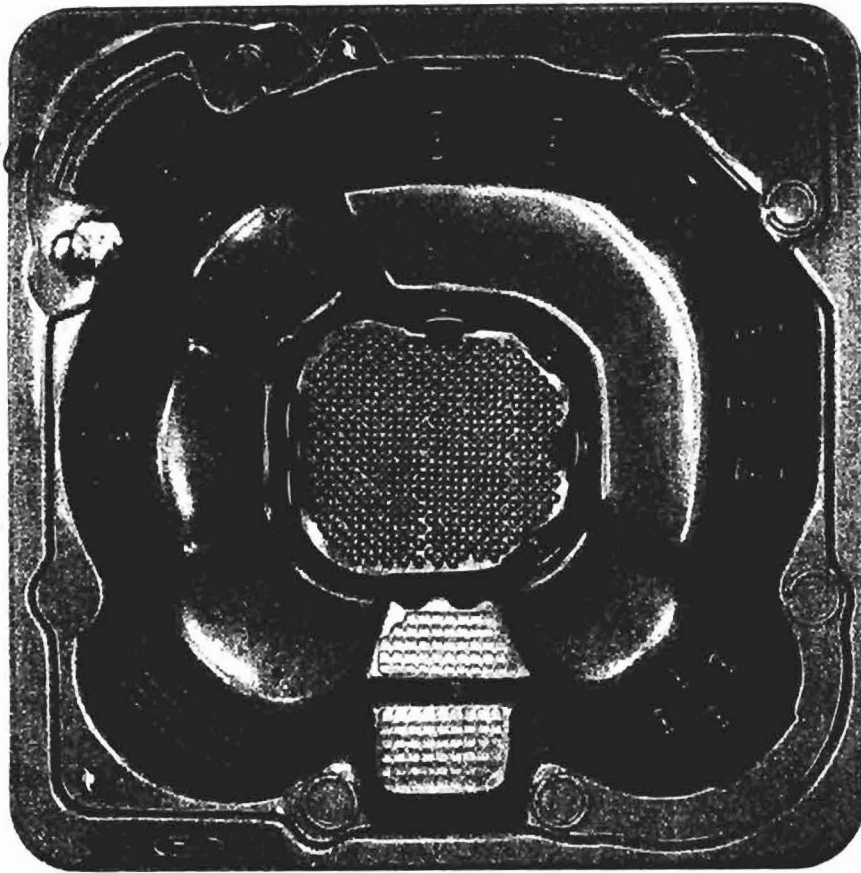

*STI
Trucking
will call
to set up
and work
and
Time =
4G099700*

*H.D.
7610600*

ENJOY

Your QCA Morocco/Venice or Vista Spa

VS515 Pack VL 260 Topside

OWNER'S MANUAL

This owner's manual is for YOU! It will show you how to operate and maintain your very own spa. We think it is important for you to take a few moments and get acquainted with your new spa operation. Please keep this manual available for references.

QCA Spas would like to congratulate you on your purchase and we sincerely hope you enjoy your QCA Spa.

SERIAL NUMBER 508110314

18 DIGIT SPA NUMBER 25050334020026220



Morocco. Venice. Vista Spa 09.08

TABLE OF CONTENTS

<i>Cleaning the Filter Cartridge</i>	11 15	
<i>Draining the Water</i>	10 13	
<i>Filter Maintenance</i>	11 14	
<i>Hydro-, Turbo-, Air-Max^(tm)</i>	9 is	pg 15 & 16
<i>Hyperthermia Description</i>	3 is	pg 5
<i>Initial Start Up</i>	5 8	
<i>Installation Instructions</i>	4 7	
<i>115/240v Installations</i>	4 7	
<i>Jets, Jets, Jets</i>	8 9-11	
<i>Prevention of Freezing</i>	11 12 9	
<i>Spa Light</i>	9 12	
<i>Refilling your Spa</i>	10 13	
<i>Removing the Filter Cartridge</i>	11 14	
<i>Spa and Cabinet Maintenance</i>	12 13+14	
<i>Spa Location</i>	4 6	
<i>Spa Side Control</i>	5 is	pg 8 & 9
<i>System Messages</i>	7 8 9	
<i>Troubleshooting</i>	7 8 10-9	
<i>UL Instructions</i>	3 5	
<i>Vacation Care</i>	11 15	
<i>Warranty</i>	12 17	
<i>Warranty Card</i>	13 16	
<i>Water Care Program</i>	10 11 13	
<i>Winterizing</i>	12 16-17	

893

UL INSTRUCTIONS

The instructions you are about to read are required to be published in your manual by the Underwriters Laboratories. These instructions are very important for your safety and QCA would like to encourage you to read and apply all instructions. Thank you!

IMPORTANT SAFETY INSTRUCTIONS

When installing and using this electrical equipment, remember to always observe safety precautions, including the following:

1. READ AND FOLLOW ALL INSTRUCTIONS.
- 2a. **DANGER** - To reduce the risk of injury, do not permit children to use this product unless they are closely supervised.
- 2b. **WARNING - RISK OF CHILD DROWNING.** Extreme caution must be exercised to prevent unauthorized access by children. To avoid accidents, ensure that children cannot use a spa or hot tub unless they are supervised at all times.
3. Connect to a grounded, grounding type receptacle only.
4. **WARNING** - To reduce the risk of electrical shock, replace a damaged cord immediately.
5. **DANGER** - To reduce the risk of injury to persons, do not remove suction fittings.
6. A pressure wire connector is provided on the inside and outside of the control box inside the unit to permit connection of a minimum No. 6 AWG (8.4mm) solid copper bonding conductor between this point and any metal equipment, metal enclosures of electrical equipment, metal water pipe, or conduit within 5 feet (1.5m) of the unit as needed to comply with local requirements.
7. (All permanently installed units must have a GFCI) This appliance must have a neutrally protected ground-fault circuit-interrupter. Before each use and with the unit operating, push the test button. The unit should stop operating and the reset button should appear. Push the reset button. The unit should now operate normally. If the interrupter does not perform in this manner, a ground current is flowing indicating the possibility of an electric shock. Disconnect the power until the fault has been identified and corrected.
8. Install to provide drainage of compartment for electrical components.
9. **RISK OF ELECTRIC SHOCK.** Install at least 5 feet (1.5m) from all metal surfaces. (A spa may be installed within 5 feet of metal surfaces if each metal surface is permanently connected by a minimum No. 6 AWG (8.4mm) solid copper conductor attached to the pressure wire connector on the terminal box that is provided for this purpose.)
10. **DANGER - RISK OF ELECTRICAL SHOCK.** Do not permit any electrical appliance, such as a light, telephone, radio, or television, within 5 feet (1.5m) of the spa or hot tub.
11. To reduce the risk of injury:
 - a. The water in a spa or hot tub should never exceed 40°C (104°F). Water temperatures between 38°C (100°F) and 40°C (104°F) are considered safe for a healthy adult. Lower water temperatures are recommended for extended use (exceeding 10-15 minutes) and for young children.
 - b. Since excessive water temperatures have a high potential for causing fetal damage during the early months of pregnancy, pregnant or possibly pregnant women should limit spa or hot tub water temperatures to 38°C (100°F).
 - c. Before entering a spa or hot tub, the user should measure the water temperature with an accurate

thermometer since the tolerance of water temperature-regulating devices may vary as much as +/-3 C (5 F).

d. The use of alcohol, drugs, or medication before or during spa or hot tub use may lead to unconsciousness with the possibility of drowning.

e. Persons suffering from obesity or with a medical history of heart disease, low or high blood pressure, circulatory system problems or diabetes should consult a physician before using a spa or hot tub.

f. Persons using medication should consult a physician before using a spa or hot tub since some medication may induce drowsiness while other medications may affect heart rate, blood pressure, and circulation.

12. The electrical supply for this product must include a suitably rated switch or circuit breaker to open all ungrounded supply conductors to comply with section 422-20 of the National Electrical Code, ANSI/NFPA 70-1987. The disconnecting means must be readily accessible to the tub occupant but installed at least 5 feet (1.5m) from the tub water. For units used in other than single-family dwellings, a clearly labeled emergency switch shall be provided as part of the installation. The switch shall be readily accessible to the occupants and shall be installed at least 5 feet (1.52 m) away, adjacent to, and within sight of the unit.

SAVE THESE NSTRUCTIONS

Just a quick note,

For your own security...Prolonged immersion in water that is warmer than normal body temperature can result in a

dangerous condition known as HYPERTHERMIA. The causes, symptoms, and effects of hyperthermia may be described

as follows: Hyperthermia occurs when the internal temperature of the body reaches a level several degrees above the

normal temperature of 98.6° F or 37° C. The symptoms of hyperthermia include dizziness, fainting, drowsiness, lethargy,

and an increase in the internal temperature of the body. The effects of hyperthermia include (1) unawareness of

impending hazard, (2) failure to perceive heat, (3) failure to recognize the need to exit the spa, (4) physical inability to

exit the spa, (5) fetal damage in pregnant women, and (6) unconsciousness resulting in a danger of drowning. WARNING

- the use of alcohol, drugs, or medication can greatly increase the risk of fatal hyperthermia in hot tubs and spas.

Spa Location

The selection of a site for the installation of your spa is a very important decision and should be undertaken keeping several factors in mind.

1. Always check your local codes before installing your spa. A clear understanding of buildings, fences, gates, electrical and plumbing guidelines will be invaluable.

2. Select a location that will compliment your lifestyle and your home. The spa will become an integral part of your life and therefore should be placed advantageously.
3. The position of the spa in relation to surrounding terrain should be considered. Locating the spa near or directly under trees not only cuts off the sun thereby depriving you of natural heat, but also necessitates the physical removal of leaves and debris. Airborne dirt and debris may also be carried into the spa by prevailing winds. In addition, an uncovered spa with wind blowing across the top will tend to lower water temperatures; therefore you may wish to shield your spa from direct winds.
4. You may wish to consider an indoor installation. An indoor spa located off of a bedroom or family room can offer relaxing solitude or enjoyable gatherings of friends or family. Care should be taken in providing protection from possible water damage due to splashing. High humidity levels relating to the spa can also be a source for damage and should be planned for in the construction stage.
5. Your portable spa with a cabinet has been designed to be self-supporting. Any further reinforcement or support is not required when placed upon a sound foundation. In order to prevent damage to the cabinet and spa be certain to locate the spa on a solid, level foundation capable of maintaining the weight of the spa when filled with water.
6. A base of poured concrete is best for this type of installation. You may wish to use an existing patio but if you wish to construct a new base for your spa, select a level, flat area. After removing the topsoil, construct a square frame using four 2x4's. Usually an area 10'x10' will suffice. When the frame has been leveled, pour a 3 1/2" base of concrete mix into the frame leveling the mix by stroking across the top with another 2x4. Finish the top with the cement float. When the slab has cured remove the 2x4's and landscape as desired. Note: It is necessary to provide drainage of the compartment for the electrical components.
7. Install your spa in a location, which allows easy access to the equipment bay.
8. Before filling with water, be sure the spa is in its final position and that hoses, tools, etc. are not under the spa.

Installation Instructions

Electrical-General

Prior to performing any service to the spa package turn OFF ALL primary electric power at the main circuit breaker or disconnect panel.

Opening the front cover of the electrical control box can make all field electrical connections.

All electrical connections to this spa package must be accomplished by a qualified electrician in accordance with the National Electric Code or the Canadian Electric Code and in accordance with any local electrical codes in effect at the time of installation.

All connections should be made in accordance with the wiring tab enclosed in the electrical control box.

These spa packages are designed to operate on 60Hz Alternating Current only, at a voltage of 240 volts.

Spa packages with a 240-volt rating require a three wire electrical service, plus ground (line 1, line 2, neutral and ground).

Connections should be made using copper conductors only. The connecting wire and circuit breakers or fuses must be sized to accommodate the Total Ampere load as specified on the equipment module data label.

PLEASE NOTE: To Overseas owners
50 Hz, 230-volt units should be wired to the national code in the country of the owner's residence.

A bonding lug has been provided on the equipment module to allow connection to local ground points. To reduce the risk of electrical shock, a #6 AWG solid copper bonding wire should be run from this lug to any metal ladders, water pipes or other metal within 5 feet of the spa.

240 volt Installation

B95

Units to be operated at 240 volts must have all electrical connections accomplished by a qualified electrician in accordance with the National Electric Code, the Canadian Electric Code or other local electrical codes in effect at the time of installation.

Equipment modules installed for 240-volt operation requires a three wire electrical service, plus ground (line 1, line 2, neutral and ground). Refer to terminal block diagram.

Starting the Spa

1. Fill the spa to at least minimum water level (indicated near the skimmer) before electrical power is turned on. - Be sure all valves and hose bib, located on power pack, are closed and all union nuts are tight.
2. Check for plumbing leaks.
3. Be sure all suction valves to the equipment pack are open.
4. Open return valve with handle in up position.
5. Set filtering cycles according to control panel instructions.

Initial Start-up

When your spa is first actuated, it will go into Priming mode, indicated by "Pr." The Priming mode will last for less than 5 minutes (press "Temp" or "Set" to skip Priming Mode) and then the spa will begin to heat the spa and maintain the water temperature in the Standard mode.

QCA VL260 Spa Control



VS515 = Jets 2 / Jets 1 / Temp / Light

Temp Set (80°F - 104°F / 26°C - 40°C)

The start-up temperature is set at 100°F/37.5°C. The last measured temperature is constantly displayed on the LCD.

Press the "Warm" or "Cool" button once to display the set temperature. Each time either button is pressed again, the set temperature will increase or decrease depending on which button is pressed. After three seconds, the LCD will automatically display the last measured spa temperature.

Jets 1

Touch the "Jets" button once to activate the low speed of the pump and again for the high speed. Press the "Jets" button again to turn off the pump. If left running, the low speed of the pump will automatically turn off after 4 hours, and the high speed will automatically turn off after 15 minutes. The low speed of the pump runs when the blower is on. It may

also activate for at least 2 minutes every 30 minutes to detect the spa temperature and then to heat to the set temperature if needed, depending upon mode. When the low speed turns on automatically, it cannot be deactivated from the panel; however, the high speed may be started.

Jets 2/ Blower

Your system has a pump 2 installed. Press Jets 2 once pump will come on high speed. Press Jets 2 twice, blower comes on. Press Jets 2 third time, pump 2 shuts off and blower stays on. Press Jets 2 fourth time, blower shuts off.

Light

Press the "Light" button to turn the light on and off. If left on, the light automatically turns off after 4 hours.

Standard Mode is programmed to maintain the desired temperature. Note that the last measured spa temperature displayed is current only when the pump has been running for at least 2 minutes.

Preset Filter Cycles

The first filter cycle begins 6 minutes after the spa is energized. The second filter cycle begins 12 hours later. Filter duration is programmable for 2, 4, 6, 8 hours or for continuous filtration (indicated by "FC"). The default filter time is 2 hours. To program, press "Temp", then "Jets." Press "Temp" to adjust. Press "Jets" to exit programming. The blower purges for 30 seconds at the beginning of each filter cycle. The low speed of the pump runs during filtration and the ozone generator (if installed) will be enabled.

Freeze Protection

If the temperature sensors detect a drop to below 44°F/6.7°C within the heater, the pump and blower will automatically activate to provide freeze protection. The equipment stays on until 4 minutes after the sensors detect that the spa temperature has risen to 45°F/7.2°C or higher. In colder climates, an optional additional freeze sensor may be added to protect against freeze conditions that may not be sensed by the standard sensors.

Diagnostic Messages

Message	Meaning	Action Required
	No Message on display. Power has been cut off to the spa.	The control panel will be disabled until power returns. Spa settings are preserved on all

		systems.
--	Temperature unknown	After the pump has been running for 2 minutes, the temperature will be displayed.
HH	“Overheat” – The spa has shut down. One of the sensors has detected 118°F/48°C at the heater.	DO NOT ENTER THE WATER. Remove the spa cover and allow water to cool. Once the heater has cooled, reset by pushing any button. If spa does not reset, shut off the power to the spa and call your dealer or service organization
OH	“Overheat” - The spa has shut down. One of the sensors has detected that the spa water is 110° F/43.3°C.	DO NOT ENTER THE WATER. Remove the spa cover and allow water to cool. At 107°F/42° C, the spa should automatically reset. If spa does not reset, shut off the power to the spa and call your dealer or service organization.
IC	“Ice” - Potential freeze condition detected.	No action required. The pump and the blower will automatically activate regardless of spa status.
SA	Spa is shut down. The sensor that is plugged into the Sensor “A” jack is not working.	If the problem persists, contact your dealer or service organization. (May appear temporarily in an overheat situation and disappear when the heater cools.)
Sb	Spa is shut down. The sensor that is plugged into the Sensor “B” jack is not working.	If the problem persists, contact your dealer or service organization. (May appear temporarily in an overheat situation and disappear when the heater cools.)
Sn	Sensors are out of balance. If alternating with spa temperature, it may just be a temporary condition. If flashing by itself, spa is shut down.	If the problem persists, contact your dealer or service organization.
HL	A significant difference between the temperature sensors was detected. This could indicate a flow problem.	Check water level in spa. Refill if necessary. If the water level is okay, make sure the pumps have been primed. If problem persists, contact your dealer or service organization.
LF	Persistent low flow problems. (Displays on the fifth occurrence of the “HL” message within 24 hours.) Heater is shut down, but other spa functions continue to run normally.	Follow action required for “HL” message. Heating capability of the spa will not reset automatically; you may press any button to reset.
dr	Possible inadequate water, poor flow, or air bubbles in detected in the heater. Spa is shut down for 15 minutes.	Check water level in spa. Refill if necessary. If the water level is okay, make sure the pumps have been primed. Press any button to reset, or this message will automatically reset within 15 minutes. If problem persists, contact your dealer or service organization.
dy	Inadequate water detected in heater. (Displays on third occurrence of “dr” message.) Spa is shut down.	Follow action required for “dr” message. Spa will not automatically reset. Press any button to reset.

Jewel Series Jets

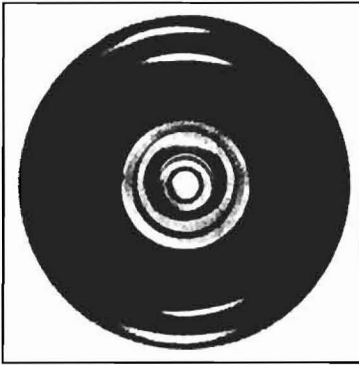

Directional Hurricane Jet-the graphite gray jet is operated by rotating the jet face counter-clockwise to full On position or clockwise for 95% shut-off.

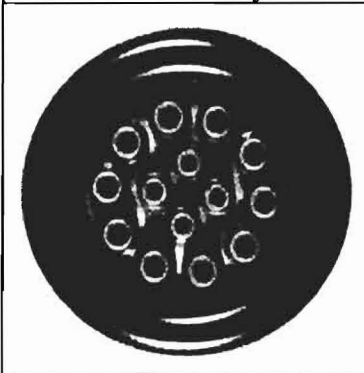

Massage Jet-the graphite gray jet is operated by rotating the jet face counter-clockwise to full On position or clockwise for 95% shut-off. It is a 14 port large volume jet.

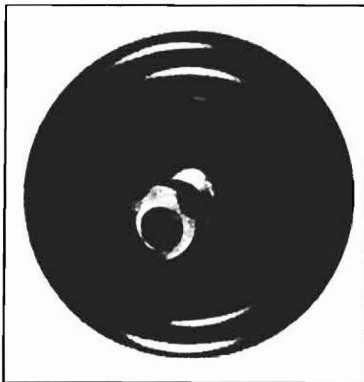

Vari-Swirl Jet-the graphite gray jet is operated by rotating the jet face counter-clockwise to full On position or clockwise for 95% shut-off. The Directional and Vari-Swirl Jet is interchangeable. Ask your QCA Dealer for more information.

Jewel™ Spa Light

All equipment Modules have a receptacle, located on the side of the Equipment Module. This receptacle is provided for the connection of the spa light.

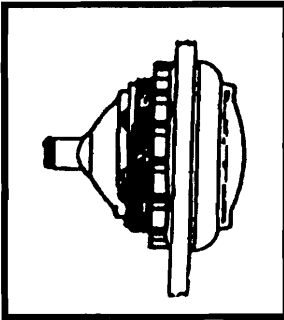

Your QCA Majestic™ Spa has a standard 12v light. The Spa light may be turned ON or OFF by pressing the Light button located on the spa side control.

Spa Light Lens Installation

Colored lenses are included with the spa light. To install or remove lenses simply push ON or pull OFF of the spa light, as show below.

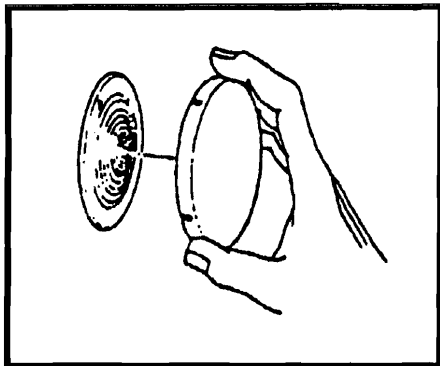

Light Bulb Replacement

To replace the spa light bulb; turn ALL power to the Equipment Module OFF. Locate the rear of the spa light and remove the bulb sock by rotating socket counter clockwise 1/8 turn and pulling on the socket (not the wire), as shown below. Pull the bulb from the socket and replace by reversing the above steps.

CAUTION: The replacement bulb must be the same rating as the factory installed bulb.

Spa Care and Maintenance

It is recommended to completely drain the spa at least four times a year. Otherwise, the water becomes chemically "saturated" and no longer responds to regular chemical upkeep. The spa should also be drained before long periods of disuse, or for equipment repair.

Draining of Water

Because of the small water volumes involved with spas, sometimes it is much simpler and less expensive to drain the water than to adjust the water chemistry with chemical additives. To drain the spa, shut off the main breaker to your spa equipment pack. Use a wet/ dry vac to remove the remaining amount of water.

Options for Draining the Water

1. Simply siphon water from spa with garden hose.
2. A sump pump may be used to pump water from spa.

Refilling your Spa

1. Shut off the main breaker to your spa equipment pack.
2. Fill spa with water through center of filter cavity.
3. Turn Power back on, spa will automatically start to run and heat water to set temperature.

Your Water Care Program

Before adding chemicals to your spa, do a full water analysis with a test kit or ask your QCA Spa dealer to conduct the water test for you.

Step 1: Always have the circulation system running before adding any chemicals. As you fill your spa to the level recommended by the manufacturer, add cleaning agent to prevent metal staining and to protect equipment against scale and corrosion. Circulate for one hour.

Step 2: "Balance" the water so that it is neither alkaline (scale forming) nor acidic (corrosive). Balanced spa water should be 7.2 - 7.8 on the pH scale, with total alkalinity (the measure of the ability of water to resist a change in pH) in the range of 80-120 parts per million (ppm).

- A. If pH is lower than 7.2, add pH UP
- B. If pH is higher than 7.8, add pH DOWN
- C. If total alkalinity is below 80, add ALKALINITY UP.

Step 3: Shock treats the water with non chlorine shock to destroy any organic contaminants that may have accumulated in the spa during filling.

Step 4: Add Clarifier to keep water sparkling clear. Circulate one hour.

Step 5: Prepare your disinfectant dispenser or feeder for use according to directions. A bromine residual of 2.0 - 4.0 ppm, as determined by your test kit, should be maintained at all times. Directions for using the bromine are

indicated on the float ring.

We suggest you follow a regular maintenance program to keep your spa water fresh and crystal clear.

Daily Checklist

1. Test for proper bromine level. Replenish spa floater dispenser or feeder with bromine tabs as needed. Proper bromine level should be maintained at 2.0 - 4.0 ppm.
2. Test pH levels and adjust if needed. If you are having difficulty-keeping pH properly balanced, it may be an indication that total alkalinity needs adjusting. Have your dealer test the water and adjust if needed.

Weekly Checklist

1. Add Clarifier to help the filter remove small particles and to retain water clarity.
2. Add Chelating Agent to protect your equipment against stains, scale and rust.
3. For spas located outdoors or subject to a great deal of sunlight add Algaecide to guard against algae.
4. Shock your spa weekly with Oxidizer to remove contaminants such as ammonia, body oils and foreign matter. Unless spa water is routinely shock treated, contaminants will accumulate to cause eye and skin irritation, odors and cloudy dull water appearance.
5. To eliminate and prevent foaming, add a small amount of NON FOAM as needed.

General Guidelines

- **NEVER MIX CHEMICALS TOGETHER**
- Add only small amounts of each chemical at a time until the desired value is achieved. Do not exceed dosage rates on label directions.
- Keep spa free of debris and cover spa when not in use.
- Circulate the water for 2-4 hours each day to maintain proper filtration. Clean your filter with FILTER CLEANER every 1-2 months.
- Remove oils and grease around water line with a cleaner on a weekly basis.
- In heavily used spas, water should be drained and refilled every two months or whenever it becomes difficult to maintain proper chemical levels.

NOTE: Not maintaining your water can result in damage of your spa jets, filter, etc. This damage, due to incorrect water maintenance, is not covered under warranty.

Filter Maintenance

As with any water filtering system, the filter cartridges may become clogged with particles or with calcification that will result in reduced water flow. In your QCA Spa, it is important to maintain a clean, unobstructed filtering system. This not only provides the maximum performance from the hydrotherapy jets, but allows the 24 hour filtration system to function effectively. We recommend the filter cartridges be cleaned (either spraying clean with water or soaking to dissolve minerals) EVERY MONTH.

WARNING: Failure to maintain the cartridges in a clean, unobstructed manner will result in reduced water flow through the heater assembly which may cause the Heater High Limit Thermostat to "trip". If this high limit "trip" occurs during sub-freezing temperatures and goes unnoticed, the spa water may freeze. Any damage to the spa (from freezing), which is a direct cause of poor maintenance, will not be covered by warranty.

Removing the Filter Cartridge

The cartridge of the in-line filter must be removed for cleaning. This is accomplished as follows:

1. Remove filter lid.
2. Twist and lift built-in chemical dispenser and remove the cartridge.

3. Remove the filter cartridge from the housing and clean, or replace it with a new cartridge.

Cleaning the Filter Cartridge

1. Hold the cartridge in an upright position and spray downward into the pleats of the fabric with a garden hose to flush away debris. Cleaning will be easier if the garden hose nozzle can be adjusted to a single jet spray.
2. After hosing off the cartridge, it is highly recommended that the cartridge be allowed to soak in a filter-cleaning solution available through your local dealer. Soak the cartridge for 24 hours to remove body oils and body lotions that become impregnated in the cartridge fabric during filtration. Rinse the cartridge thoroughly before placing it back in the filter housing.

NOTE: If two filter cartridges are available, it is recommended to allow filter cartridge to dry before new usage.

3. If the cartridge is coated with hard, solid material, it may indicate a calcium build-up on the fabric. This build-up can be removed by soaking the cartridge in proper cartridge cleaning solution available through your QCA dealer. When using this solution, follow instructions provided on label.
4. If the cartridge is coated with algae or bacteria, it should be soaked in a solution of one part chlorine and four parts water in a plastic container. As a safety precaution, rubber gloves should be worn while handling this solution. Brushing the solution into the fabric pleats may also help remove algae or bacteria. Rinse the cartridge thoroughly before placing it back into the filter housing.

Observe manufacturers recommended safety procedures when using acid or chlorine. Always rinse the cartridge thoroughly after applying these solutions.

5. Clean the filter housing and filter housing O-ring. Lubricate the O-ring with silicone lubricant.
6. Return the filter cartridge to the housing and replace the housing lid.

Vacation Care Instructions

If you plan to be away, follow these instructions to maintain the water quality:

Short Time Periods (3-5 Days):

1. Adjust the pH by following the instructions outlined in the water quality and maintenance section.
2. Sanitize the water by following the "super-chlorination" procedures and lock your thermal cover in place using the tie-downs.
3. Upon your return, sanitize the water (superchlorinate, if necessary) and balance the pH.

IMPORTANT NOTE: *Spa water oxidizers such as dichlor chlorine maintain their level of effectiveness substantially longer in cool water than in hot water.*

Long Time Periods (4-15 Days):

Prior to leaving:

1. Adjust the pH as required.
2. Sanitize the water by following the SUPER-CHLORINATION procedures.
3. Upon your return, check the level of sanitation of your spa water. If the chlorine test reads "O" and you have been gone an extended period of time, SUPER-CHLORINATE the spa water to ensure all organisms or algae are oxidized. Turn the Temperature Control clockwise to return it to the original setting. The spa water will be safe for you to use once the Free Chlorine Residual has dropped below 5.0 ppm.

Prevention of Freezing

The QCA Spa has been designed and engineered for year-round use in any climate. The energy efficiency of the spa may decrease during these cold periods, as the heater will cycle more frequently. If a freeze condition is detected, the low-speed pump is automatically activated. This is a normal spa function; no corrective action is necessary. Freeze protection is enabled regardless of the spa's status.

Winterizing

In very cold weather you may not want to venture outside to use your spa. In this case, you may move it to a heated area, or leave it as is until the weather warms. If you do leave the spa unused for a long period of time in severely cold weather, you should winterize the spa to avoid accidental freezing due to a power or equipment failure.. Follow these easy steps: Turn power to the spa OFF. Drain the spa. Use a wet vac to suck or blow out the air injectors, water jets and water suction fittings. Add 1-3 gallons of RV antifreeze, depending on the size of the spa, to all the air injectors, water jets, suction drains, and filter. **Caution: Any lines not receiving adequate antifreeze are subject to freeze damage!**

Spa and Cabinet Maintenance

Acrylic Finish - The acrylic finish on all QCA spas is impervious to most of the problems associated with non-acrylic finished spas and requires very little effort to keep it looking bright and clean. Every four months the spa should be drained, cleaned, polished and refilled. For the cleaning, use any non-abrasive cleaner. There are several non-abrasive products on the market that can be used for polishing. Made specifically for acrylic spas are cleaner/polish/sealer combinations, which contain reactive silicones instead of wax. If these are not available, any high quality silicone automotive polish will suffice.

Thermo-Guard Cabinet Care

Handcrafted maintenance free cabinet surfaces may need to be wiped down from time to time with a soap and water solution or simply sprayed with a garden hose. Use of harsh chemicals to clean the surface will cause the cabinet to discolor.

WARRANTY REGISTRATION

This warranty applies to spas manufactured by QCA Spas and sold to an original consumer purchaser at

purchase ("Purchaser") after May 1, 2008. To validate this warranty, the Purchaser must complete the enclosed

warranty registration card and mail it to QCA within 30 days of delivery of the spa. RETURN OF THE

WARRANTY REGISTRATION CARD IS A CONDITION OF WARRANTY COVERAGE. This warranty is

exclusive and supersedes all other representations or obligations of QCA Spas, Inc, whether express or

implied and whether oral, written or printed.

Your Serial Number is located inside shell on the step or under shell hanging from plumbing within the equipment compartment of your QCA Spa.

Date Purchased:

Date Installed:

sa Model :

erial Number:

Warning: Elderly persons, infants and anyone subject to heart disease, diabetes, high or low blood pressure, strokes, epilepsy or similar afflictions should not enter a spa alone and without consulting a physician. Unsupervised use by children should be prohibited. Never use a spa while under the influence of alcohol, anti-coagulants, antihistamines, vasoconstrictors, vasodilators, stimulants, hypnotics, narcotics, or tranquilizers. If you are taking medications of any kind, or being treated for any illness, consult your physician prior to the use of the spa. A spa should be kept at

WARRANTY REGISTRATION

This warranty applies to spas manufactured by QCA Spas and sold to an original consumer purchaser at retail ("Purchaser") after May 1, 2008. To validate this warranty, the Purchaser must complete the enclosed warranty registration card and mail it to QCA within 30 days of deliver of the spa. RETURN OF THE OWNER REGISTRATION CARD IS A CONDITION OF WARRANTY COVERAGE. This warranty is exclusive and supersedes all other representations or obligations of QCA Spas, Inc, whether express or implied and whether oral, written or printed.

Your Serial Number is located inside shell on the step or under shell hanging from plumbing within the equipment compartment of your QCA Spa.

Date Purchased:

Date Installed:

Spa Model :

Serial Number:

Warning: Elderly persons, infants and anyone subject to heart disease, diabetes, high or low blood pressure, strokes, epilepsy or similar afflictions should not enter a spa alone and without consulting a physician. Unsupervised use by children should be prohibited. Never use a spa while under the influence of alcohol, anti-coagulants, antihistamines, vasoconstrictors, vasodilators, stimulants, hypnotics, narcotics, or tranquilizers. If you are taking medications of any kind, or being treated for any illness, consult your physician prior to the use of the spa. A spa should be kept at temperatures less then 104° F or 40° C for personal safety and health.

To validate your warranty the enclosed warranty must be filled out and returned to QCA Spas, Inc., 1021 State St., Bettendorf, Iowa 52722, within 30 days from date of purchase.

For your warranty see enclosed packet located inside your spa shell.

sanders industries inc.

P. BOX 1126 • 1989 ROYAL MAID DRIVE
TUPELO MS 38802-1126

INSTALLATION INSTRUCTIONS

1. Open carton carefully and remove spa cover.
2. Position cover on spa so that all flaps are down.
3. Unclip the female clip device from the cover and position them so the strap will be straight down and tight. Using the screws provided attach the female clips to your spa cabinet.
4. Spa cover is now ready for use.

“SPA COVER IS TO REMAIN ON SPA AT ALL TIMES WHEN SPA IS NOT IN USE.”

1. Cover is to be on the spa in order to maintain maximum heat retention, and to keep out debris.
2. Always make sure spa cover is locked when covering the spa, to prevent children from opening the cover.
3. Improper use of cover is a hazard.

sanders industries inc.

WARRANTY

P.O. BOX 1126

TUPELO, MS 38802-1126

FAX 662-844-0874

PHONE 662-844-9427

www.sandersind.cc

DELUXE SPA COVER WARRANTY

MATERIAL - Sanders Industries warrants the premium spa cover material and workmanship for a period of 1 year from its purchase date.

INSULATION - Sanders Industries warrants this spa cover insulation for a period of 1 years against water absorption that has been determined to have been caused by normal usage INSULATION WARRANTY IS VOID IF FOAM HAS BEEN BROKEN.

WARRANTY DOES NOT COVER DAMAGE CAUSED BY IMPROPER USE OR THE FOLLOWING:

1. Excessive chlorination of water or splashing of chlorine or other chemicals on vinyl.
2. Chafing or wearing holes in cover by dragging on rough surfaces or storing against sharp objects.
3. Broken foam by sitting lying on or walking on cover, excessive snow loads, water or pets.

Warranty Performance - In the event of any defect covered under the terms of this warranty, Sanders Industries will repair or replace the spa cover or components found defective. TO OBTAIN WARRANTY SERVICE CONTACT YOUR SPA COVER DEALER. **FREIGHT REQUIRED TO EFFECT THE REPAIR OF THE COVER IS THE RESPONSIBILITY OF THE PURCHASER.**

MAINTENANCE AND CARE

COVER SHOULD BE KEPT CLEAN, RECOMMEND CLEANING WITH MILD SOAP & WATER. DO NOT USE PETROLEUM BASED CLEANERS. SHOULD RAIN OR ICE GET INTO TOP OF COVER, OPEN ZIPPERS AND ALLOW TO DRAIN. HANDLE WITH CARE WHEN COVERING OR REMOVING COVER FROM SPA. TREATMENT OF COVER SHOULD BE SIMILAR TO THAT OF CARPET, DRAPES AND FURNITURE.

ROAD

PLOT PLAN

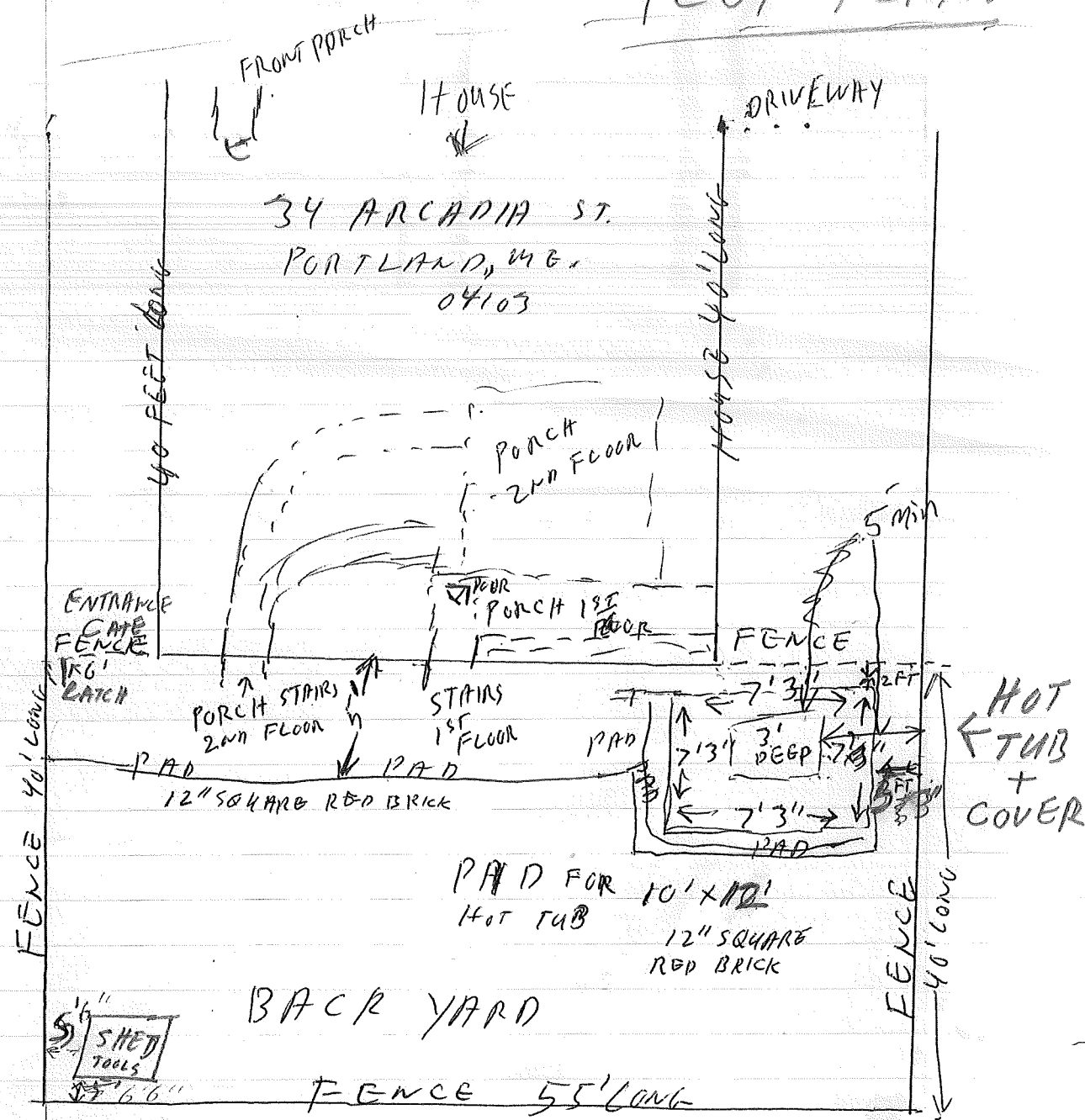

Garnett + 3 Q.C.A. SPA
 MODEL 8A HOT TUB SPA

BEFORE YOU GET STARTED

You will need to make sure you have at least 2 feet of clearance on all 4 sides of your spa. We recommend the coverlift opens toward the back of the spa away from the control panel. Mounting the coverlift in any other orientation may cause interference with the spa's front access panel if any repairs or maintenance of spa is required in the future.

SMALL PARTS LIST

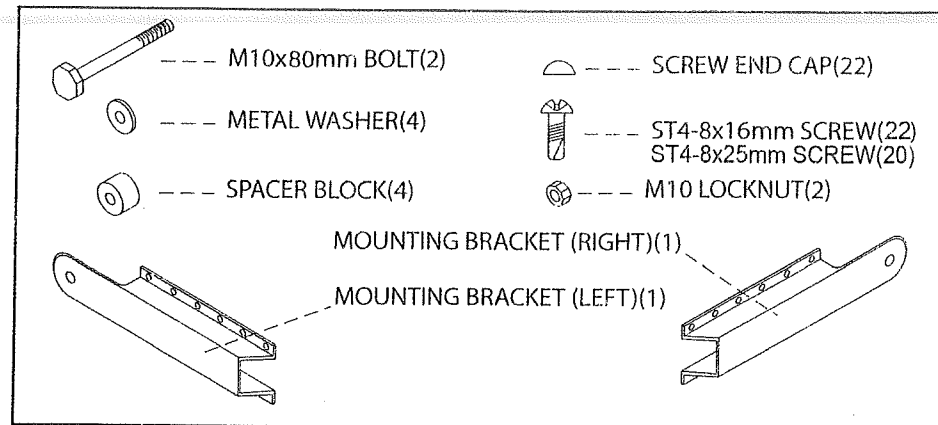

SET-UP AND ASSEMBLY





Before beginning assembly, carefully read the following information and instructions.

- Place all parts in a cleared area and remove the packing materials from the spa shell; do not dispose of the packing materials until assembly is completed and the spa is in operation.
- Assembly requires two people.
- For help identifying the small parts used in assembly, use the Small Parts List above or the Parts List on Page 6.
- During assembly, make sure that all parts are oriented as shown in the drawings.

• Read each assembly step before you begin.

• Tighten all parts as you assemble them, unless instructed to do otherwise.

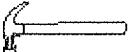
ASSEMBLY REQUIRES THE FOLLOWING TOOLS (not included):

- One (2) adjustable wrench 
- One (1) Phillips screwdriver 
- One (1) hammer 
- One (1) power drill with a 1/16" drill bit and a 1/4" drill bit 
- Soapy Water
- Pen, Pencil or Marker

Installation Instructions for the INFINITY Spa COVERLIFT

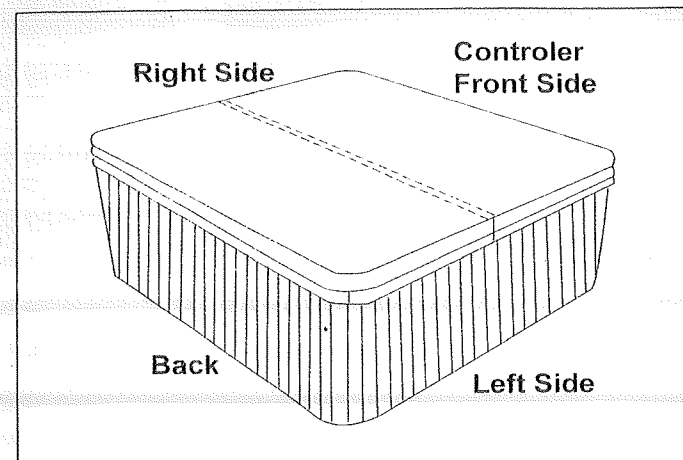

Figure 1

1. Position the spa cover (in closed position) on the spa, making sure that all four corners are properly positioned and square on the spa. See Figure 1.

You will need to make sure you have at least 2 feet of clearance on all 4 sides of your spa. We recommend the coverlift opens toward the back of the spa away from the control panel. Mounting the coverlift in any other orientation may cause interference with the front access panel if any repairs or maintenance of the spa is required in the future.

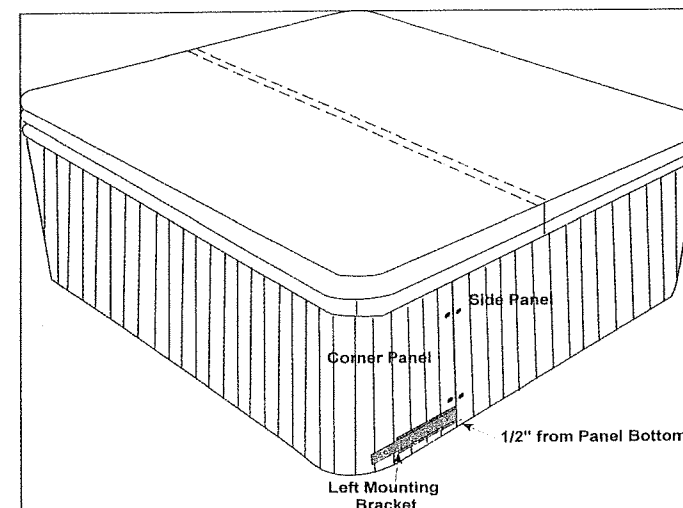

Figure 2

2. Starting with the mounting bracket, place one of the M10x80mm bolts and one washer into the mounting bracket. The head of the bolt should be facing the spa. This must be done before you mount the bracket. (See Detail 1-1 below) The pivot arm will be added in step 3. Line up the bracket 1/2" from the bottom of the panel as close to the corner as you can. Make sure the entire flat surface of the mounting bracket is flat against the panel. While holding the bracket in place mark the holes to be drilled. Using a 1/16" drill bit, pilot drill the marked holes. Install mounting bracket to panel by inserting the 4.8x25mm screws. (10 per bracket) Repeat the process on the opposite side of spa.

NOTE: There is a short and long end of the Pivot Arm. The short end goes toward the back of spa, the long will go toward the top of spa as shown in Figure 3. (Side Pivot Arm)

3. Attach a side pivot arm to the mounting with two spacer blocks, a metal washer and a M10 locknut. Secure the nut firmly on the bolt. (See Detail 1-1) Repeat this procedure on opposite side of spa.

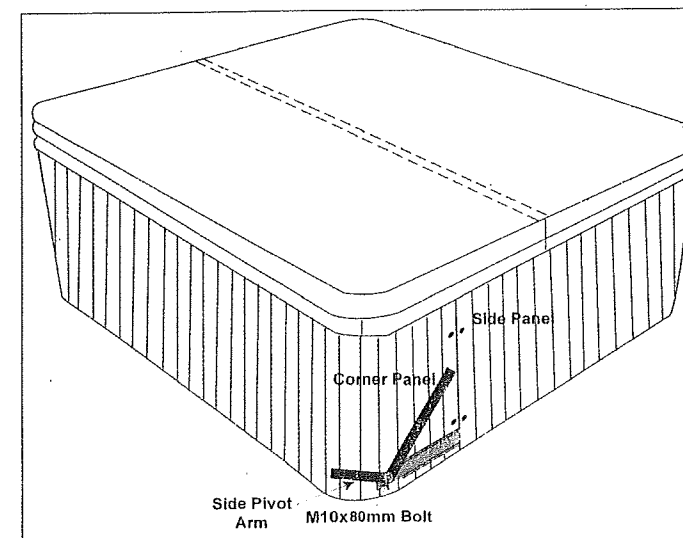
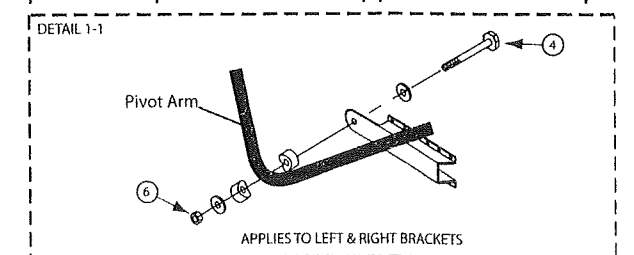

Figure 3



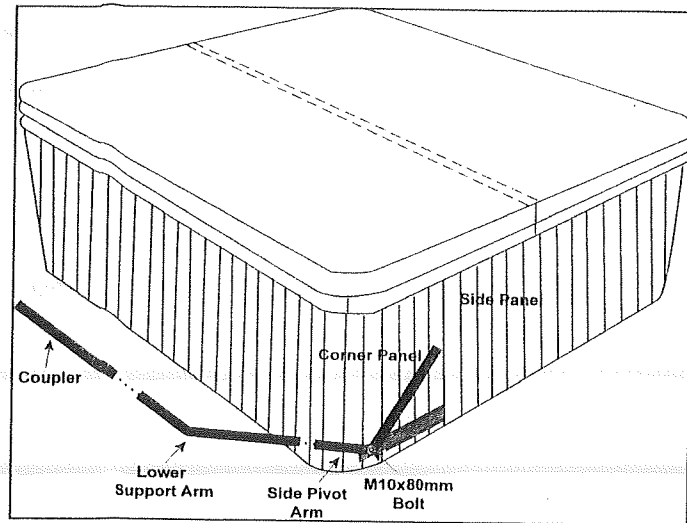

Figure 4

4. Slide one of the four foam corner guards on the Lower Support Arm. (#13 Parts List) Soapy water sprayed on the pipe and inside of the foam will help with this.

NOTE: Lower Support Arm is shorter than the Upper Support Arm.

Insert the long end of the Lower Support Arm into the short end of the Pivot Arm. Now insert the Coupler into the short end of the Lower Support Arm. Repeat this on the other side. Screws will be added after making adjustments later in setup.

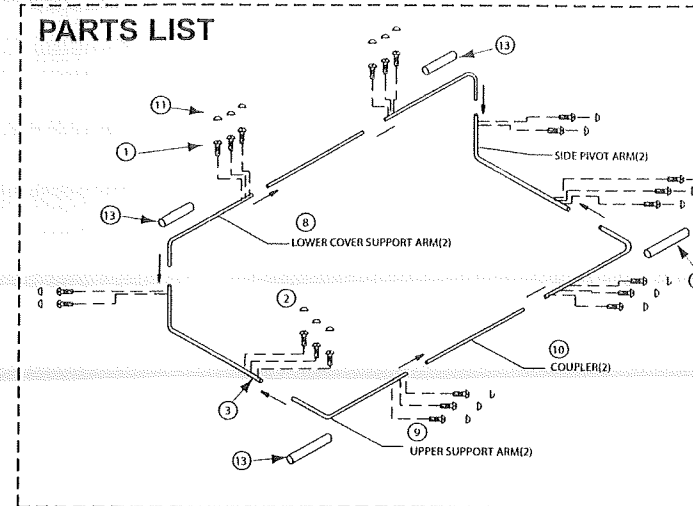

Figure 7

7. Using the 22 ST4-8x16mm screws (see parts list for description), fasten Support Arm to the Coupler. There are six screws inserted into the Upper and Lower Coupler. There are two screws inserted into each Upper and Lower Support Arm that attach the Side Pivot Arms to complete the installation of the screws. You will need to remove any metal filings that may have been produced by drilling and/or installing the screws. Now install the black plastic screw caps to screw heads by pressing on with your fingers.

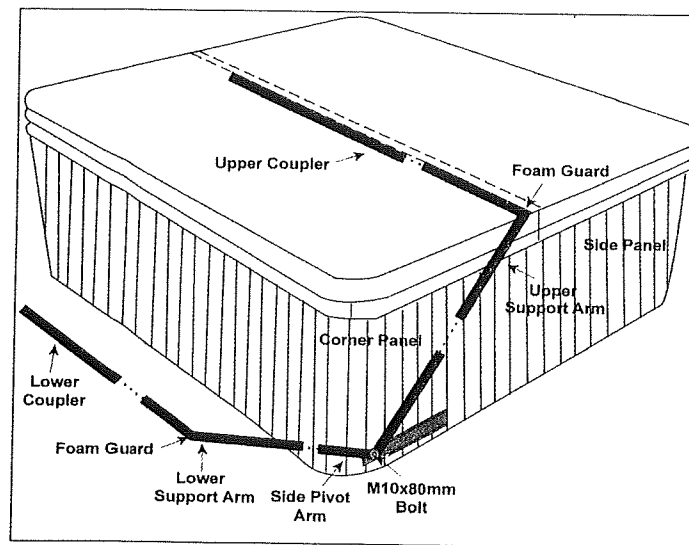

Figure 5

NOTE: The Upper Support Arm is longer than the Lower Support Arm.

5. The Upper Support Arm will also use the Foam Guards to protect corners. Install the same way as in step 4. Now insert the the Upper coupler into the the Upper Support Arm and the other end of the Upper Support Arm into the long end of the Pivot Arm as shown in Figure 5. Do the same on the other side. Now the coverlift should be all assembled but adjustable.

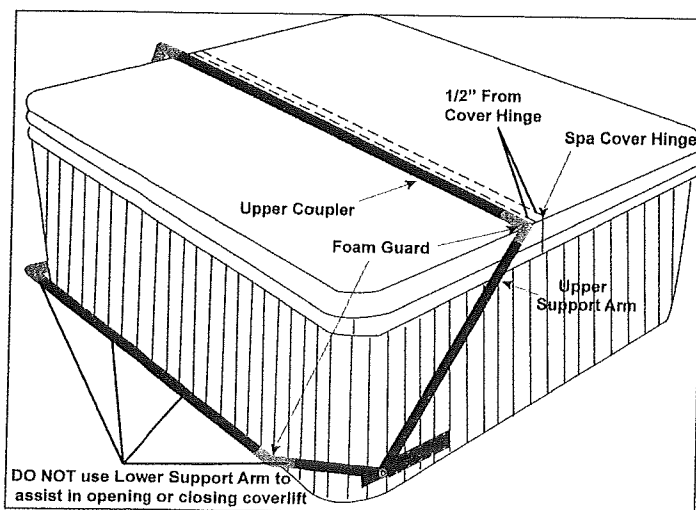

Figure 6

6. Adjust and center the Upper Coupler and Upper Support Arm so that the Coupler is lying parallel to the spa cover's hinge (the center seam of the cover) and approximately 1/2" away from it. (See Figure 6)

The Lower Support Arm and Coupler just needs to clear the back spa panel when the cover lift is in position as shown in Figure 6.

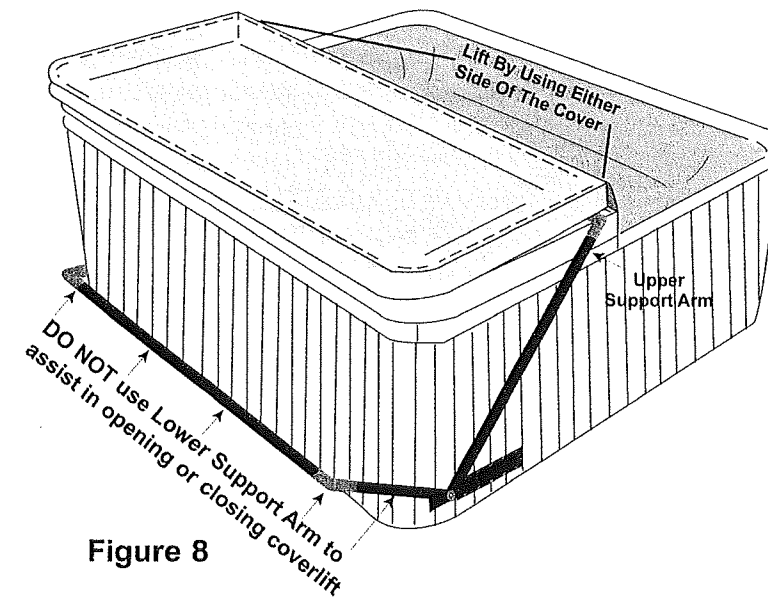

Figure 8

8. The Coverlift is now ready to use. To remove the cover from the spa with the coverlift, fold the spa cover (at the hinge) over the Upper Support Arm (as shown in Figure 8).

Now lift cover up and toward the back of the spa. The cover will slide back and down the back side of the spa and stop when it reaches the ground.

PARTS LIST (EXPLODED DRAWING)

Parts List:

Key No.	Qty.	Description
1	22	ST4-8x16mm screw
2	2	Mounting Bracket
3	2	Pivot Arm
4	2	M10x80mm Bolt
5	4	Metal Washer
6	2	M10 Locknut
7	4	Spacer Block
8	2	Lower Support Arm
9	2	Upper Support Arm
10	2	Coupler
11	44	Screw End Cap
12	20	ST4-8x25mm Screw
13	4	Foam Guard

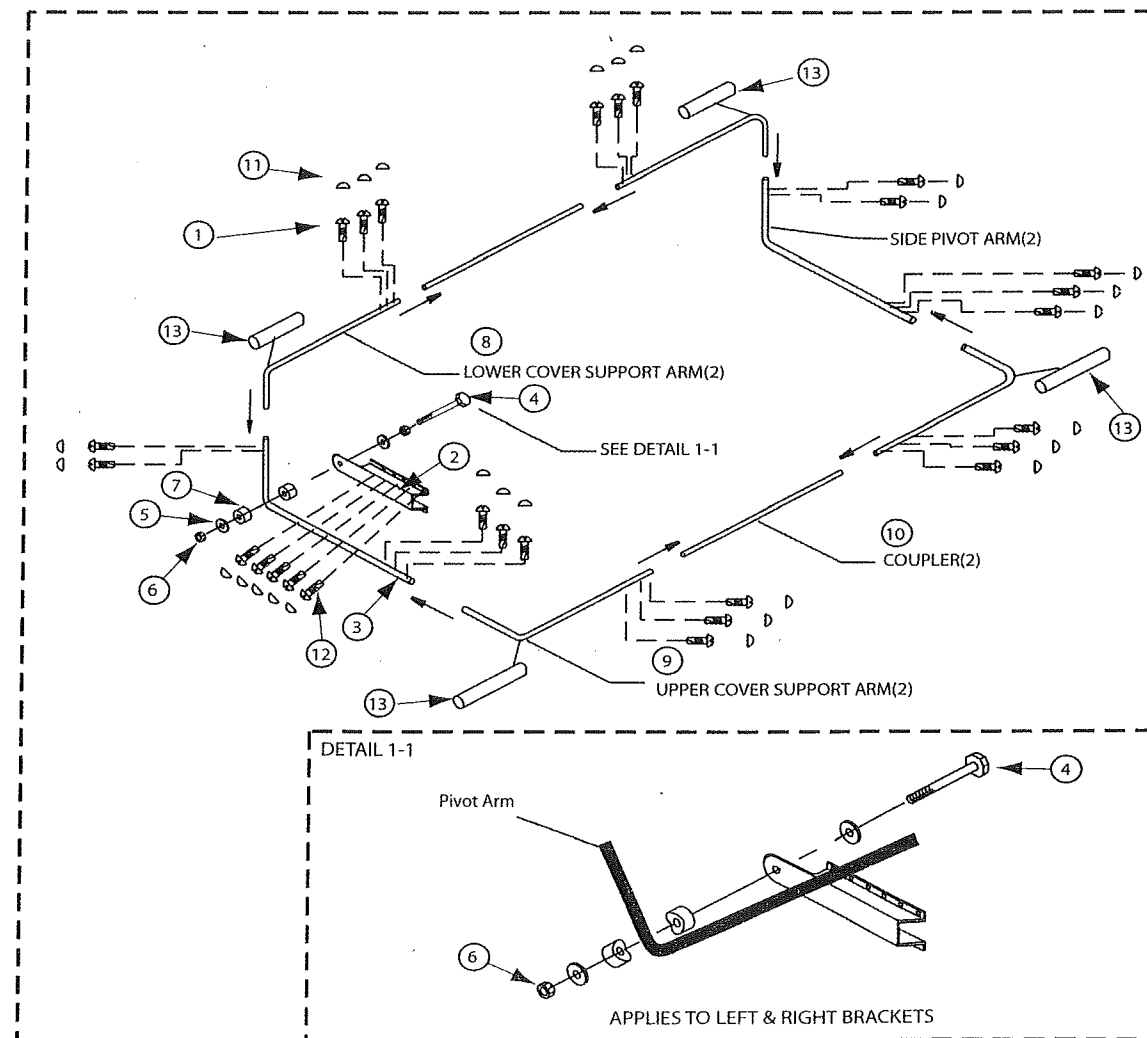

ORDERING REPLACEMENT PARTS

To order replacement parts, simply call our Customer Service Department toll-free at 1-877-897-7493, 24 Hours a Day, 7 Days a Week (excluding holidays). To help us assist you, please be prepared to give the following information when calling:

1. The MODEL NUMBER of the product is M100A1L.
2. The NAME of the product - Infinity Spas, Spa Coverlift.
3. The DESCRIPTION of the desired part(s) (see the PART LIST on page 2 & page 6 of this manual).

LIMITED WARRANTY

INFINITY SPAS, warrants this product to be free from defects in workmanship and material, under normal use and service conditions, for a period of ninety (90) days from the date of purchase. This warranty extends only to the original purchaser. Infinity Spas' obligation under this warranty is limited to replacing or repairing, at Infinity Spas' option, the product at one of its authorized service centers. All products for which warranty claim is made must be received by Infinity Spas at one of its authorized service centers with all freight and other transportation charges prepaid, accompanied by sufficient proof of purchase. All returns must be pre-authorized by Infinity Spas. This warranty does not extend to any product or damage to a product caused by or attributable to freight damage, abuse, misuse, improper or abnormal usage or repairs not provided by an Infinity Spas authorized service center, products used for commercial or rental purposes, or products used as store display models. No other warranty beyond that specifically set forth above is authorized by Infinity Spas.

Infinity Spas is not responsible or liable for indirect, special or consequential damages arising out of or in connection with the use or performance of the product or damages with respect to any economic loss, loss of property, loss of revenues or profits, loss of enjoyment or use, costs of removal, installation or other consequential damages of whatsoever nature. Some states do not allow the exclusion or limitation of incidental or consequential damages. Accordingly, the above limitation may not apply to you.

The warranty extended hereunder is in lieu of any and all other warranties and any implied warranties of merchantability or fitness for a particular purpose is limited in its scope and duration to the terms set forth herein. Some states do not allow limitations on how long an implied warranty lasts. Accordingly, the above limitation may not apply to you.

This warranty gives you specific legal rights. You may also have other rights which vary from state to state.

INFINITY SPAS., 2901 W KINGSLEY RD., GARLAND, TX 75041