

# DISPLAY THIS CARD ON PRINCIPAL FRONTAGE OF WORK CITY OF PORTLAND

Please Read Application And Notes, If Any, Attached

DEPARTMENT OF BUILDING INSPECTION

## PERMIT

Permit Number: 041715

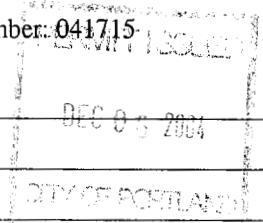

This is to certify that Kuntz John A & Cheryl L Itschner

has permission to Install new bulkhead at single family home

AT 39 Hawthorne St

427 B022001

provided that the person or persons, firm or corporation accepting this permit shall comply with all of the provisions of the Statutes of the State and of the Ordinances of the City of Portland regulating the construction, maintenance and use of buildings and structures, and of the application on file in this department.



Apply to Public Works for street line and grade if nature of work requires such information.

Notification of inspection must be given and written permission procured before this building or part thereof is altered or closed-in. 24 HOUR NOTICE IS REQUIRED.

A certificate of occupancy must be procured by owner before this building or part thereof is occupied.

### OTHER REQUIRED APPROVALS

Fire Dept. \_\_\_\_\_

Health Dept. \_\_\_\_\_

Appeal Board \_\_\_\_\_

Other \_\_\_\_\_

Department Name

*[Handwritten Signature]*  
*12/03/04*

Director - Building & Inspection Services

### PENALTY FOR REMOVING THIS CARD

**City of Portland, Maine - Building or Use Permit Application**

389 Congress Street, 04101 Tel: (207) 874-8703, Fax: (207) 874-8716

Permit No: 04-1715	Issue Date:	CBL: 427 B022001
-----------------------	-------------	---------------------

Location of Construction: 39 Hawthorne St	Owner Name: Kuntz John A & Cheryl L Jts	Owner Address: 39 Hawthorne St	Phone: 775-0949
----------------------------------------------	--------------------------------------------	-----------------------------------	--------------------

Business Name:	Contractor Name: Owner	Contractor Address: Portland	Phone: 0000000000
----------------	---------------------------	---------------------------------	----------------------

Lessee/Buyer's Name	Phone:	Permit Type: Alterations - Dwellings	Zone: R5
---------------------	--------	-----------------------------------------	-------------

Past Use: single family home	Proposed Use: single family home w/ new bulkhead	Permit Fee: \$48.00	Cost of Work: \$2,500.00	CEO District: 4
---------------------------------	-----------------------------------------------------	------------------------	-----------------------------	--------------------

FIRE DEPT: <input type="checkbox"/> Approved <input checked="" type="checkbox"/> Denied Signature: <i>[Signature]</i>		INSPECTION: Use Group R-3 Type 5B IRC 2009 Signature: <i>[Signature]</i>	
--------------------------------------------------------------------------------------------------------------------------	--	-----------------------------------------------------------------------------------	--

**Proposed Project Description:**  
Install new bulkhead at single family home

PEDESTRIAN ACTIVITIES DISTRICT (P.A.D.)			
Action	<input type="checkbox"/> Approved	<input type="checkbox"/> Approved w/Conditions	<input type="checkbox"/> Denied
Signature	Date		

Permit Taken By: jharris	Date Applied For: 11/17/2004	<b>Zoning Approval</b>	
-----------------------------	---------------------------------	------------------------	--

1. This permit application does not preclude the Applicant(s) from meeting applicable State and Federal Rules. 2. Building permits do not include plumbing, septic or electrical work. 3. Building permits are void if work is not started within six (6) months of the date of issuance. False information may invalidate a building permit and stop all work..	Special Zone or Reviews <input type="checkbox"/> Shoreland <input type="checkbox"/> Wetland <input checked="" type="checkbox"/> Flood Zone <input type="checkbox"/> Subdivision <input type="checkbox"/> Site Plan Maj <input type="checkbox"/> Minor <input type="checkbox"/> MM <input type="checkbox"/> Date: 12/03/04	Zoning Appeal <input type="checkbox"/> Variance <input type="checkbox"/> Miscellaneous <input type="checkbox"/> Conditional Use <input type="checkbox"/> Interpretation <input type="checkbox"/> Approved <input type="checkbox"/> Denied Date:	Historic Preservation <input checked="" type="checkbox"/> Not in District or Landmark <input type="checkbox"/> Does Not Require Review <input type="checkbox"/> Requires Review <input type="checkbox"/> Approved <input type="checkbox"/> Approved w/Conditions <input type="checkbox"/> Denied Date: 12/03/04
------------------------------------------------------------------------------------------------------------------------------------------------------------------------------------------------------------------------------------------------------------------------------------------------------------------------------------------------------------------------	------------------------------------------------------------------------------------------------------------------------------------------------------------------------------------------------------------------------------------------------------------------------------------------------------------------------------------------------	----------------------------------------------------------------------------------------------------------------------------------------------------------------------------------------------------------------------------------------------------------------------	--------------------------------------------------------------------------------------------------------------------------------------------------------------------------------------------------------------------------------------------------------------------------------------------------------------------------------------

**CERTIFICATION**

I hereby certify that I am the owner of record of the named property, or that the proposed work is authorized by the owner of record and that I have been authorized by the owner to make this application as his authorized agent and I agree to conform to all applicable laws of this jurisdiction. In addition, if a permit for work described in the application is issued, I certify that the code official's authorized representative shall have the authority to enter all areas covered by such permit at any reasonable hour to enforce the provision of the code(s) applicable to such permit.

SIGNATURE OF APPLICANT \_\_\_\_\_ ADDRESS \_\_\_\_\_ DATE \_\_\_\_\_ PHONE \_\_\_\_\_

RESPONSIBLE PERSON IN CHARGE OF WORK, TITLE \_\_\_\_\_ DATE \_\_\_\_\_ PHONE \_\_\_\_\_

# All Purpose Building Permit Application for ~~Demolition of A Structure~~

If you or the property owner owes real estate or personal property taxes or user charges on any property within the City, payment arrangements must be made before permits of any kind are accepted.

Location/Address of Construction: <u>39 Hawthorne St</u>		
Total Square Footage of Proposed Structure	Square Footage of Lot <u>105 x 100</u>	
Tax Assessor's Chart, Block & Lot Chart#      Block#      Lot# <u>427</u> <u>B</u> <u>22</u>	Owner: <u>John + Cheryl Kuntz</u>	Telephone: <u>775-0949</u>
Lessee/Buyer's Name (If Applicable)	Applicant name, address & telephone: <u>775-0949</u> <u>39 Hawthorne St</u>	cost Of Work: \$ <u>2500 -</u> Fee: \$ _____
Current use: <u>None Single Family Home</u>		
If the location is currently vacant, what was prior use: _____		
Approximately how long has it been vacant: _____		
Project description: <u>Bulk head</u>		
<b>DEMOLITION CALL LIST MUST BE SUMITTED WITH THIS APPLICATION</b>		
Contractor's name, address & telephone: _____		
Whom should we contact when the permit is ready: <u>John Kuntz</u>		
Mailing address: <u>39 Hawthorne St. Portland, Me. 04103</u>		
		Phone: <u>775-0949</u>

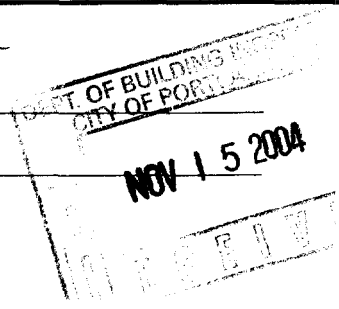

IF THE REQUIRED INFORMATION IS NOT INCLUDED IN THE SUBMISSIONS THE PERMIT WILL BE AUTOMATICALLY DENIED AT THE DISCRETION OF THE BUILDING/PLANNING DEPARTMENT, WE MAY REQUIRE ADDITIONAL INFORMATION IN ORDER TO APPROVE THIS PERMIT.

*I hereby certify that I am the Owner of record of the named property, or that the owner of record authorizes the proposed work and that I have been authorized by the owner to make this application as his/her authorized agent. I agree to conform to all applicable laws of this jurisdiction. In addition, if a permit for work described in this application is issued, I certify that the Code Official's authorized representative shall have the authority to enter all areas covered by this permit at any reasonable hour to enforce the provisions of the codes applicable to this permit.*

Signature of applicant: <u>Cheryl K Kuntz</u>	Date: <u>11-16-04</u>
-----------------------------------------------	-----------------------

**This is not a permit, you may not commence ANY work until the permit is issued. This is for residential demolition. Commercial demolition will require other types of permitting along with this permit, please inquire with support staff**

**City of Portland, Maine - Building or Use Permit**

389 Congress Street, 04101 Tel: (207) 874-8703, Fax: (207) 874-8716

<b>Permit No:</b> 04-1715	<b>Date Applied For:</b> 11/17/2004	<b>CBL:</b> 427 B022001
------------------------------	----------------------------------------	----------------------------

<b>Location of Construction:</b> 39 Hawthorne St	<b>Owner Name:</b> Kuntz John A & Cheryl L Jts	<b>Owner Address:</b> 39 Hawthorne St	<b>Phone:</b> ( ) 775-0949
<b>Business Name:</b>	<b>Contractor Name:</b> Owner	<b>Contractor Address:</b> Portland	<b>Phone:</b> (000) 000-0000
<b>Lessee/Buyer's Name</b>	<b>Phone:</b>	<b>Permit Type:</b> Alterations - Dwellings	

<b>Proposed Use:</b> single family home w/ new bulkhead	<b>Proposed Project Description:</b> Install new bulkhead at single family home
------------------------------------------------------------	------------------------------------------------------------------------------------

**Dept:** Zoning      **Status:** Approved      **Reviewer:** Tammy Munson      **Approval Date:** 12/03/2004  
**Note:**      **Ok to Issue:**

**Dept:** Building      **Status:** Approved with Conditions      **Reviewer:** Tammy Munson      **Approval Date:** 12/03/2004  
**Note:**      **Ok to Issue:**

- 1) The basement is NOT approved as habitable space. A code compliant 2nd means of egress must be installed in order to change the use of this space.

**City of Portland, Maine - Building or Use Permit**

389 Congress Street, 04101 Tel: (207) 874-8703, Fax: (207) 874-8716

<b>Permit No:</b> 04-1715	<b>Date Applied For:</b> 11/17/2004	<b>CBL:</b> 427 B022001
------------------------------	----------------------------------------	----------------------------

<b>Location of Construction:</b> 39 Hawthorne St	<b>Owner Name:</b> Kuntz John A & Cheryl L Jts	<b>Owner Address:</b> 39 Hawthorne St	<b>Phone:</b> ( ) 775-0949
<b>Business Name:</b>	<b>Contractor Name:</b> Owner	<b>Contractor Address:</b> Portland	<b>Phone</b> (000) 000-0000
<b>Lessee/Buyer's Name</b>	<b>Phone:</b>	<b>Permit Type:</b> Alterations - Dwellings	

single family home w/ new bulkhead

Install new bulkhead at single family home

**Dept:** Zoning      **Status:** Approved      **Reviewer:** Tammy Munson      **Approval Date:** 1210312004  
**Note:**      **Okto Issue:**

**Dept:** Building      **Status:** Approved with Conditions      **Reviewer:** Tammy Munson      **Approval Date:** 1210312004  
**Note:**      **Okto Issue:**

- 1) The basement is NOT approved as habitable space. A code compliant 2nd means of egress must be installed in order to change the use of this space.

# GORDON CELLADORS

Replace your basement door easily and economically

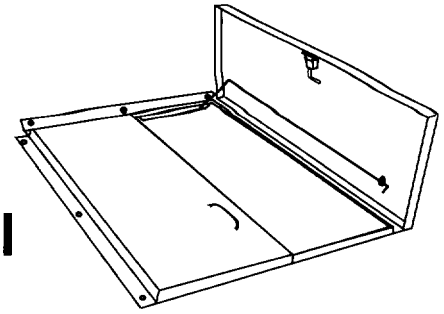

## RD Model

When it comes time to replace your worn or damaged basement door, Gordon has the answer. Gordon makes it easy to choose and install the right steel door. Simply find the measurements you need, select the right door size and follow Gordon's clear, complete instructions. You'll have a weather-tight entrance that adds value, beauty and security to your home.

Two basic styles are available: The Replacement Door (RD) shown here and the CellaDoor (CD) shown on the other side of this page.

### STEP ONE, measure the foundation.

The RD model installs on your existing sloping sidewalls.

- Measure the width "C" and "D" which are the **inside (C)** and **outside (D)** dimensions of the foundation width.
- Next measure the length "A" and "B" along the slope from the building, to the inside (A) and outside (B) of the base-wall. **(Note; To insure accuracy, measure the foundation and not the existing door.)**

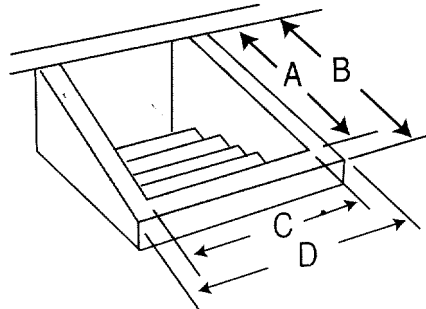

Write the four door measurements, A, B, and C, D, in space below. Using these measurements and the chart, choose the right door size. Not sure?? Ask your Gordon dealer for Help.

A = 4'4" C = 4'8"  
B = 5' D = 6'8"

**C & D.** Select width at least 4 inches wider than "C" and at least 2 inches narrower than "D".

**A & B.** Select length at least 2 inches longer than "A" and within 2 inches of "B" (Use extension headers to find doors longer than standard lengths)

**STEP TWO** choose the right door size. This chart will help you select the correct replacement door. Remember, that the new door will be positioned on sidewalls of your foundation. Extension "headers" are available for doors longer than the standard sizes shown in the first section of the chart.

MODEL	WIDTH	LENGTH	WITH 6" EXTENSION	WITH 12" EXTENSION	WITH 18" EXTENSION	IF LONGER LENGTHS ARE REQUIRED, ORDER FLAT STEEL FROM THE PLANT
RD-0	44 1/2"	48"	53" - 55"	59" - 61"	NA	
RD-1	44 1/2"	62"	67" - 69"	73" - 75"	NA	
RD-2	48 1/2"	66 1/2"	71" - 73"	77" - 79"	NA	
RD-3	52 1/2"	73 1/2"	78" - 80"	84" - 86"	90" - 92"	
OUTSIDE FRAME DIMENSIONS			EXTENSION HEADERS ARE NOT INCLUDED IN DOORS — ORDER SEPARATELY			

**STEP THREE.** the photos below the sizing chart show a sample installation. Complete, easy-to-follow instructions are packed with each door.

### FOUNDATION PLATES

To install doors on rough or irregular stone, block or masonry foundations, use foundation plates. Foundation plates can also be used to modify openings too narrow or too wide for standard width doors.

The chart lists only four sizes of foundation plates, but plates are available in any width, by special order. (3x3, 3x4, 3x25, etc. or longer than 84 inches.) Ask your Gordon dealer for help.

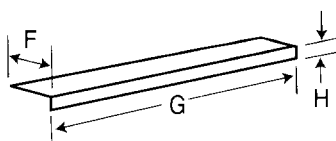

Remove Old Door.

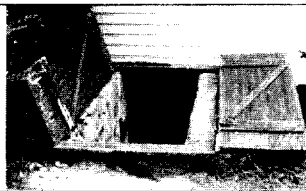

Prepare foundation. Smooth surface with mortar or Foundation Plates. (optional)

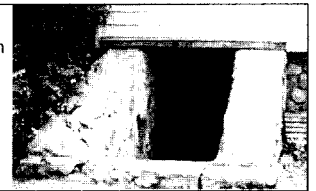

Place assembled Frame on Foundation. Square & attach.

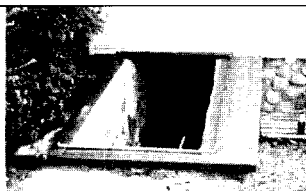

Caulk around Frame. Paint promptly with Alkyd Enamel.



H	F	G	Price
3"	5"	7'	
3"	8"	7'	
3"	11"	7'	
3"	14"	7'	

(Rough Cement)

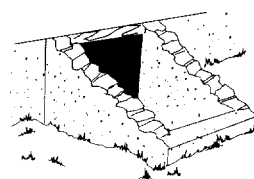

(Field Stone or Granite)

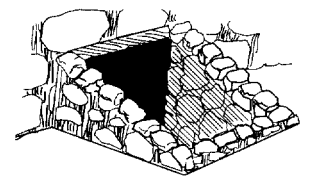

**GORDON  
CELLADORS**

THE GORDON CORPORATION 170 SPRING ST., SOUTHINGTON, CONNECTICUT 06489  
TELEPHONE (860) 628-0000 FAX (860) 621-1251 Website: <http://www.gordoncelladour.com>

11/15/04

EXCAVATE 6' X 8' OPENING FOR NEW BULKHEAD  
POUR 5' X 6' FOOTING OVER 6" CRUSHED STONE. 6"-12" FOOTING  
CUT NEW 3/4" DOOR OPENING FOR NEW BULKHEAD ACCESS.  
FORM & POUR NEW FOUNDATION WALLS <sup>8"</sup> 5' X 6' X 6' HIGH.  
INSTALL NEW BILCO BULKHEAD DOOR SYSTEM & SEAL.  
SEAL EXTERIOR OF FOUNDATION BEFORE BACKFILLING  
WITH SAND AND TOPCOAT WITH LOAM AND SEED.

### BILCO BULKHEAD DOOR SYSTEM

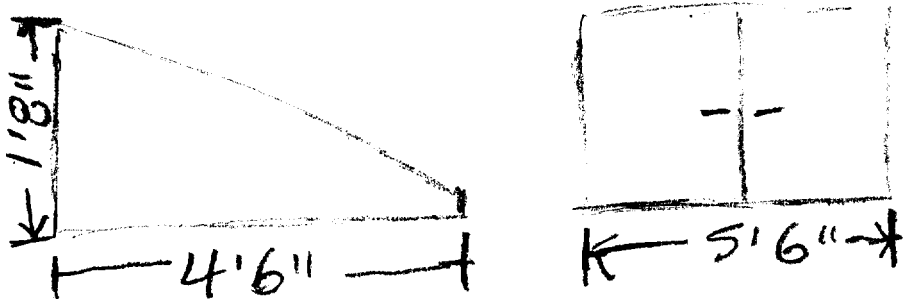

BUILD NEW ENTRY STAIRS TO BASEMENT.

{ 4- STRINGERS 2" X 12" W/ 7" RISE AND 12" TREAD.  
{ 7- STEPS. 2" X 12" TREADS.

INSTALL NEW 3' SOLID PINE ~~DOOR~~ ENTRY DOOR.

39 HAWTHORNE ST.  
PORTLAND, ME.

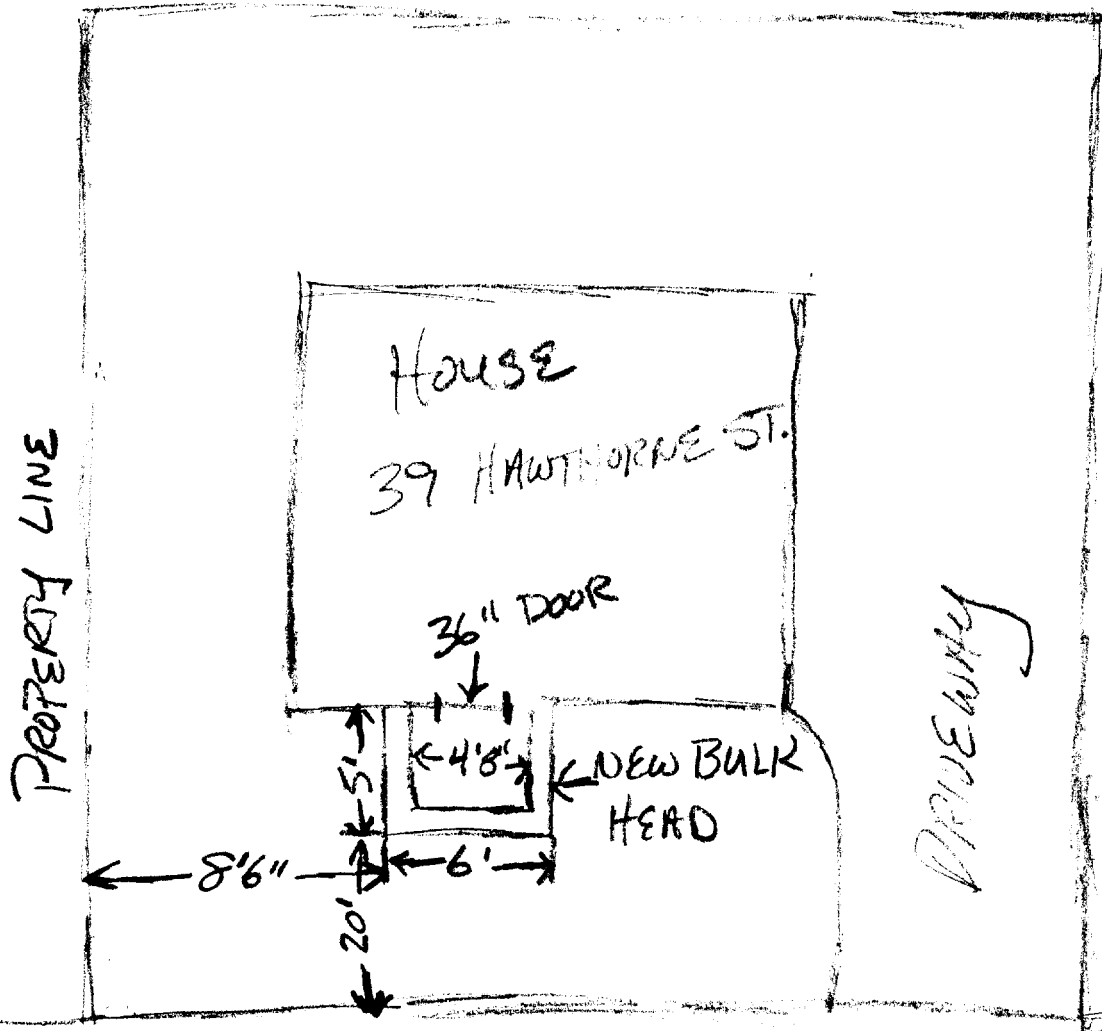

R-5  
Front - 20'  
average of  
Sides - 8'

HAWTHORNE ST.