

DISPLAY THIS CARD ON PRINCIPAL FRONTAGE OF WORK
CITY OF PORTLAND

Please Read
Application And
Notes, If Any,
Attached

BUILDING INSPECTION

PERMIT

Permit Number: 081177

This is to certify that MASSACHUSETTS LUMBER CO INC /M C Hall
 has permission to Demolition of 4 Building (Foundations) in Bldg, Silo, and adjacent Sheds
 AT 165 PRESUMPCOT ST 425 A015001

provided that the person or persons, firm or corporation accepting this permit shall comply with all of the provisions of the Statutes of Maine and of the Ordinances of the City of Portland regulating the construction, maintenance and use of buildings and structures, and of the application on file in this department.

Apply to Public Works for street line and grade if nature of work requires such information.

Notification of inspection must be given and when permission is procured before this building or part thereof is altered or closed-in. 24 HOUR NOTICE IS REQUIRED.

A certificate of occupancy must be procured by owner before this building or part thereof is occupied.

OTHER REQUIRED APPROVALS

Fire Dept. _____

Health Dept. _____

Appeal Board _____

Other _____

PERMIT ISSUED

SEP 25 2008

Department Name

CITY OF PORTLAND

PENALTY FOR REMOVING THIS CARD

Director - Building & Inspection Services

9/25/08

City of Portland, Maine - Building or Use Permit Application

389 Congress Street, 04101 Tel: (207) 874-8703, Fax: (207) 874-8716

Permit No: 08-1177	Issue Date:	CBL: 425 A015001
-----------------------	-------------	---------------------

Location of Construction: 165 PRESUMPCOT ST	Owner Name: MASSACHUSETTS LUMBER CO	Owner Address: 929 MASSACHUSETTS AVE STE 0	Phone: 207-318-2100
Business Name:	Contractor Name: M C Hall	Contractor Address: 1039 Riverside St Portland	Phone: 2073182100
Lessee/Buyer's Name	Phone:	Permit Type: Demolitions - Building	Zone: I-M

Past Use: Commercial	Proposed Use: Commercial - Demolition of 4 Building (No Foundations) Mill Bldg, Silo, Two adjacent Sheds	Permit Fee: \$70.00	Cost of Work: \$5,000.00	CEO District: 4
		FIRE DEPT: <input type="checkbox"/> Approved <input type="checkbox"/> Denied <i>N/A</i>	INSPECTION: Use Group: <i>V</i> Type: <i>IBC 2005</i>	

Proposed Project Description: Demolition of 4 Building (No Foundations) Mill Bldg, Silo, Two adjacent Sheds	Signature: <i>[Signature]</i>	Signature: <i>[Signature]</i>
PEDESTRIAN ACTIVITIES DISTRICT (P.A.D.)		
Action: <input type="checkbox"/> Approved <input type="checkbox"/> Approved w/Conditions <input type="checkbox"/> Denied		
Signature:		Date:

Permit Taken By: lmd	Date Applied For: 09/5/2008	Zoning Approval
-------------------------	--------------------------------	------------------------

1. This permit application does not preclude the Applicant(s) from meeting applicable State and Federal Rules. 2. Building permits do not include plumbing, septic or electrical work. 3. Building permits are void if work is not started within six (6) months of the date of issuance. False information may invalidate a building permit and stop all work..	Special Zone or Reviews <input type="checkbox"/> Shoreland <input type="checkbox"/> Wetland <input type="checkbox"/> Flood Zone <input type="checkbox"/> Subdivision <input type="checkbox"/> Site Plan Maj <input type="checkbox"/> Minor <input type="checkbox"/> MM <input type="checkbox"/> Date: <i>9/18/08</i>	Zoning Appeal <input type="checkbox"/> Variance <input type="checkbox"/> Miscellaneous <input type="checkbox"/> Conditional Use <input type="checkbox"/> Interpretation <input type="checkbox"/> Approved <input type="checkbox"/> Denied Date:	Historic Preservation <input checked="" type="checkbox"/> Not in District or Landmark <input type="checkbox"/> Does Not Require Review <input type="checkbox"/> Requires Review <input type="checkbox"/> Approved <input type="checkbox"/> Approved w/Conditions <input type="checkbox"/> Denied Date:
	PERMIT ISSUED SEP 25 2008 CITY OF PORTLAND		

CERTIFICATION

I hereby certify that I am the owner of record of the named property, or that the proposed work is authorized by the owner of record and that I have been authorized by the owner to make this application as his authorized agent and I agree to conform to all applicable laws of this jurisdiction. In addition, if a permit for work described in the application is issued, I certify that the code official's authorized representative shall have the authority to enter all areas covered by such permit at any reasonable hour to enforce the provision of the code(s) applicable to such permit.

SIGNATURE OF APPLICANT	ADDRESS	DATE	PHONE
RESPONSIBLE PERSON IN CHARGE OF WORK, TITLE		DATE	PHONE

City of Portland, Maine - Building or Use Permit

389 Congress Street, 04101 Tel: (207) 874-8703, Fax: (207) 874-8716

Permit No: 08-1177	Date Applied For: 09/15/2008	CBL: 425 A015001
------------------------------	--	----------------------------

Location of Construction: 165 PRESUMPCOT ST	Owner Name: MASSACHUSETTS LUMBER CO	Owner Address: 929 MASSACHUSETTS AVE STE 0	Phone: 207-318-2100
Business Name:	Contractor Name: M C Hall	Contractor Address: 1039 Riverside St Portland	Phone (207) 318-2100
Lessee/Buyer's Name	Phone:	Permit Type: Demolitions - Building	

Proposed Use: Commercial - Demolition of 4 Building (No Foundations) Mill Bldg, Silo, Two adjacent Sheds	Proposed Project Description: Demolition of 4 Building (No Foundations) Mill Bldg, Silo, Two adjacent Sheds
--	---

Dept: Zoning **Status:** Approved with Conditions **Reviewer:** Marge Schmuckal **Approval Date:** 09/18/2008

Note:**Ok to Issue:**

- 1) If your present structure is legally nonconforming as to setbacks, and if you are to demolish this structure on your own volition, you will only have one (1) year to replace it in the same footprint (no expansions), with the same height, and same use. Any changes to any of the above shall require that this structure meet the current zoning standards. The one (1) year starts at the time of removal. It shall be the owner's responsibility to contact the Code Enforcement Officer and notify them of that specific date and to be inspected PRIOR to any demolitions.
- 2) This permit is being approved on the basis of plans submitted. Any deviations shall require a separate approval before starting that work.

Dept: Building **Status:** Approved with Conditions **Reviewer:** Tammy Munson **Approval Date:** 09/25/2008

Note:**Ok to Issue:**

- 1) Demolition permits are valid for a period of 30 days from the date of issuance. A written request must be submitted and granted for an extension to this time period.
- 2) Demolition permit only. No other construction activities allowed.

Comments:

9/18/2008-lmd: Received permit on 9/16/2008, was waiting on the abatement report to process the permit.

9/18/2008-mes: Capt. Cass will be out for three weeks, so I am routing this permit to inspections for a review first.

9/19/2008-tmm: left message to schedule inspection /tmm



Demolition of a Structure Permit Application

If you or the property owner owes real estate or personal property taxes or user charges on any property within the City, payment arrangements must be made before permits of any kind are accepted.

Location/Address of Construction: <u>165 Presumpscott St.</u>		
Total Square Footage of Proposed Structure		Square Footage of Lot <u>2796.53</u>
Tax Assessor's Chart, Block & Lot Chart# Block# Lot# <u>425 A 15</u>	Owner: <u>Massachusetts Cambridge</u> <u>Lombard Co South 02A</u>	Telephone:
Lessee/Buyer's Name (If Applicable)	Applicant name, address & telephone:	Cost Of Work: \$ <u>5000</u> Fee: \$ _____
Current legal use: (i.e. garage, warehouse) _____ If vacant, what was the previous use? _____ How long has it been vacant? _____		
Project description: <u>Level planer mill bldg, silo + adjacent sheds</u> <u>4 BLDGS TOTAL</u>		
Contractor's name, address & telephone: <u>M.C. Hall</u> <u>1039 Riverside St Portland Me 04103</u>		
Who should we contact when the permit is ready: <u>MARK HALL</u>		
Mailing address: _____ Phone: <u>318-2100</u>		

Please submit all of the information outlined in the Demolition call list. Failure to do so will result in the automatic denial of your permit.

In order to be sure the City fully understands the full scope of the project, the Planning and Development Department may request additional information prior to the issuance of a permit. For further information or to download copies of this form and other applications visit the Inspections Division on-line at www.portlandmaine.gov, or stop by the Inspections Division office, room 315 City Hall or call 874-8703.

I hereby certify that I am the Owner of record of the named property, or that the owner of record authorizes the proposed work and that I have been authorized by the owner to make this application as his/her authorized agent. I agree to conform to all applicable laws of this jurisdiction. In addition, if a permit for work described in this application is issued, I certify that the Code Official's authorized representative shall have the authority to enter all areas covered by this permit at any reasonable hour to enforce the provisions of the codes applicable to this permit.

Signature of applicant: [Signature] Date: 09 20 08

This is not a permit; you may not commence ANY work until the permit is issued.



Demolition Call List & Requirements

Site Address: 165 Presumpscott

Owner: Hood distributors - lessee

Structure Type: wood

Contractor: M. C. Hall

Utility Approvals	Number	Contact Name/Date
Central Maine Power	1-800-750-4000	<u>Gary Hawks 9/1/08</u>
Northern Utilities	797-8002 ext 6241	<u>Allen 9/6</u>
Portland Water District	761-8310	<u>Allen Tony Alves 9/12/08</u>
Dig Safe	1-888-344-7233	<u>8/20/08</u>

After calling Dig Safe, you must wait 72 business hours before digging can begin.

DPW/ Traffic Division (L. Cote)	874-8891	<u>L. Cote L. Cote 9/15/08</u>
DPW/ Sealed Drain Permit (C. Merritt)	874-8822	<u>C. Merritt 9-15-08</u>
Historic Preservation	874-8726	<u>NA 30 years old</u>
Fire Dispatcher	874-8576	<u>_____</u>
DEP - Environmental (Augusta)	287-2651	<u>_____</u>

Additional Requirements

- 1) Written Notice to Adjoining Owners
- 2) A Photo of the Structure(s) to be demolished
- 3) Certification from an asbestos abatement company

All construction and demolition debris generated in Portland must be delivered to Riverside Recycling Facility at 910 Riverside Street. Source separated salvage materials placed in specifically designated containers are exempt from this provision. For more information contact Troy Moon @ 874-8467.

U.S. EPA Region 1 - No Phone call required. Just mail copy of State notification to:

Demo / Reno Clerk
US EPA Region I (SEA)
JFK Federal Building
Boston, MA 02203

I have contacted all of the necessary companies/departments as indicated above and attached all required documentation.

Signed: [Signature]

Date: 9/16/08

For more information or to download this form and other permit applications visit the Inspections Division on our website at www.portlandmaine.gov



ASBESTOS BUILDING DEMOLITION NOTIFICATION

MAINE DEPARTMENT OF ENVIRONMENTAL PROTECTION

Lead & Asbestos Hazard Prevention Program

17 State House Station, Augusta, Maine 04333



Maine law requires the filing of the ASBESTOS BUILDING DEMOLITION NOTIFICATION with the Department prior to demolition of any building except a single-family home.

Building owners are required to provide this notification of the demolition of a building to the DEP at least 5 working days prior to the demolition. This notification is not required before the demolition of a single-family residence or related structure (e.g., garage, shed, barn). It is also not required if previous notification of the demolition has been provided to the DEP as part of an asbestos abatement project notification. *Demolition* means the tearing down or intentional burning of a building or part of a building.

Prior to demolition, building owners must determine if there is any asbestos-containing material(s) (ACM) in the building. An "asbestos inspection" by a DEP-licensed Asbestos Consultant is required for all buildings except single-family homes and residential buildings with 2-4 units built after 1980. In lieu of an asbestos inspection, pre-1981 residential buildings with 2-4 units can be surveyed to identify possible ACM by someone knowledgeable about ACM, such as a code enforcement officer or building inspector. If materials that may contain asbestos are found, then you can either assume they are ACM, or hire a DEP-licensed Asbestos Consultant to test the materials.

Whenever more than 3 square feet or 3 linear feet of ACM is identified, the ACM must be abated in accordance with the Maine Asbestos Management Regulations by a DEP-licensed Asbestos Abatement Contractor. This includes materials presumed to be ACM. Check www.maine.gov for a listing of asbestos contractors.

Prior to issuing a local demolition permit, the DEP requests that municipalities have applicants for municipal demolition permits complete this form and fax it to the DEP at 207-287-7826. Municipalities should not issue local demolition permits if the required asbestos inspection or survey has not been performed and identified ACM removed.

Were regulated asbestos-containing building materials found? yes no

property address:	building description: <input type="checkbox"/> pre-1981 residential with 2-4 units <input type="checkbox"/> post-1980 residential with 2-4 units <input type="checkbox"/> other.
asbestos survey/inspection performed by: (name & address)	asbestos abatement contractor
telephone:	telephone:
property owner: (name & address)	demolition contractor: (name & address)
telephone:	telephone:
demolition start date:	demolition end date:

This demolition notification does not take the place of the Asbestos Project Notification, if applicable

I CERTIFY THAT THE ABOVE INFORMATION IS CORRECT

Print Name: Owner/Agent

Title

Signature

Telephone #

FAX #

Date

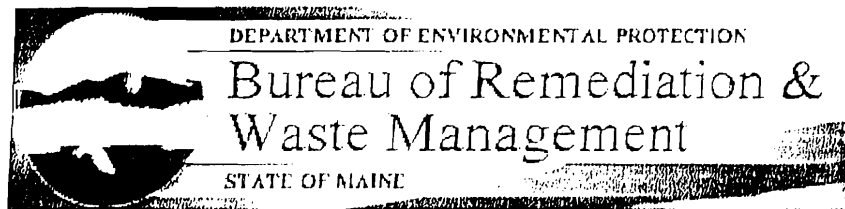

Demolitions and Asbestos

1) **Overview**

In Maine, building demolitions happen on a regular basis. Many of the demolitions occur in older buildings that are likely to contain some asbestos products, particularly in or on heating (HVAC), wall, floor, and ceiling systems. These demolition projects may be happening without the proper protection of employees, the general public, and the environment. It is important to remember that state and federal laws require that owners have buildings inspected and have any asbestos products properly removed prior to demolition. The Maine DEP is forwarding this information to municipal officials in an effort to increase awareness of and compliance with applicable rules, resulting in less asbestos exposure to the general public, demolition site personnel, and environment.

2) **What Can Municipalities Do To Help?**

Municipalities can greatly assist the people of Maine and the Department by joining with the DEP and the US EPA to ensure that asbestos is properly managed during demolitions. *Specifically, municipalities can hand out appropriate information, issue demolition permits only to persons, who can demonstrate that they will properly handle the asbestos, and mail or fax the building demolition (BDF) report form to the Department.*

The following check-off list can be used.

- A) _____ Provided "Asbestos Fact Sheet" to Applicant
- B) _____ Had applicant fill out "Building Demolition Form" (BDF)
- C) _____ Did not issue Demolition Permit to Applicant not answering "Yes" to three questions on BDF Form (OPTIONAL BUT SUGGESTED)
- D) _____ Municipality faxed (or Mailed) BDF Form to DEP at 287-7826

3) **What Are The Rules?**

Simply stated state and federal asbestos rules and regulations require that buildings be inspected for asbestos products and have them removed prior to demolition. The inspection and removal operations must be performed by DEP-licensed companies under regulated and controlled conditions.

4) **Using The Building Demolition Report Form**

The purpose of this form is to ensure that an applicant has the correct information to properly remove asbestos from a building prior to demolition. The form has two parts which need to be filled out by the applicant. The first section of the Form, Per-Demolition Building Inspection.

- Federal Environmental Protection Agency (EPA). Regulations include the Asbestos-Containing Materials in Schools Rule (ASHERA - 40 CFR Part 763), the National Emissions Standards for Hazardous Air Pollutants (NESHAP - 40 CFR Part 61), and the Worker Protection Rule (Subpart G to 40 CFR Part 763). The Maine DEP is delegated to implement the ASHERA and NESHAP rules in Maine. EPA telephone numbers are available from the DEP.

- Federal OSHA: responsibilities include regulating employee exposure to asbestos in the workplace through the asbestos construction and industry standards (29 CFR Parts 1926 and 1910). Telephone number: (207) 780-3178.

Asbestos Inspections Required Prior to Demolitions and Renovations

In Maine, improper demolition activities may be the greatest single source of asbestos exposure to the general public and to trades people working on the project. Prior to demolition or renovation of a building, the owner must ensure that the work will not disturb more than 3 square feet or 3 linear feet of asbestos-containing material (ACM). Owners of buildings, other than residential buildings with less than 5 units, must have a DEP-licensed Asbestos Consultant inspect the building (or area) for asbestos. Residential buildings with 2-5 units can be surveyed for likely asbestos-containing materials by knowledgeable non-licensed people (e.g. building inspectors and CEO's who have asbestos-awareness training); any materials likely to contain asbestos must be tested by a DEP-certified inspector or assumed to be ACM.

If ACM is identified in a building that will be demolished, or any building materials are assumed to be ACM, these materials must be removed by a DEP-licensed Asbestos Abatement Contractor before the demolition. Similarly, if any ACM is identified or assumed in areas of a building that will undergo renovation, the ACM must be removed by a DEP-licensed Asbestos Abatement Contractor before the renovation occurs. Intact asbestos-containing flooring and roofing may be left in place during demolition of a building if the demolition is performed by a DEP-licensed Asbestos Abatement Contractor using large equipment in accordance with the Maine "Asbestos Management Regulations".

Demolition Notification

State and federal regulations require that building owners notify the DEP at least 5 working days prior to demolition of a building (other than single-family residences). This notification is required **even if no asbestos is identified in the building**. Forms are available from DEP and your local code enforcement office.

Please note: OSHA regulates asbestos anytime an employer/employee relationship exists. OSHA worker protection rules exist and must be followed for abatement activities. Contact the local OSHA office with questions.

What if I have additional questions about asbestos?

The DEP regulates most asbestos activities in Maine and acts as an asbestos information clearinghouse. For more information about asbestos, contact the Asbestos Hazard Prevention Program in the Bureau of Remediation & Waste Management at 207/287-2651 or visit the web site at www.maine.gov/dep/rwm/asbestos/index.htm

Written correspondence should be sent to:
Lead & Asbestos Hazard Prevention Program
Maine Department of Environmental Protection
17 State House Station
Augusta, ME 04333-0017

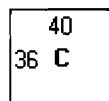
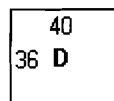
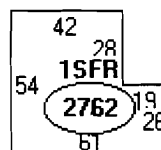
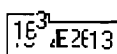
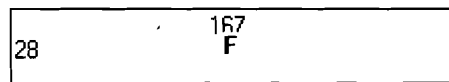
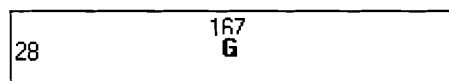
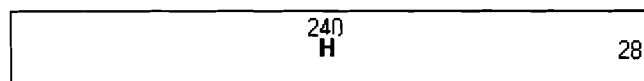

- Descriptor
- A: 1SFR
2762 sqft
 - B: 1S-MET
756 sqft
 - C: 1S OPEN
1440 sqft
 - D: 1S OPEN
1440 sqft
 - E: 1SFR
594 sqft
 - F: 1SFR
4676 sqft
 - G: 1SFR
4676 sqft
 - H: 1SFR
6720 sqft

132.23
172.63

Todd Finkler

410 - 721 - 9681

66 orland

Open shed
Goes

Shed

BCDG	Shed
------	------

Shed
stays

Goes
BCD
2

Silo
Goes

Goes
BCDG
1

Office
stays

Walter Plumb



874-8716

RE: MC Hall

590 County Rd. Suite #2 Westbrook, Maine 04092

Tel: (207) 773-1276 Fax: (207) 772-1203

September 9, 2008

Mark Hall
MC Hall
1039 Riverside St
Portland, Maine 04103

Dear Mr. Hall;

Please find enclosed for your review and file, the bulk sampling results that were collected by Kyle Rickett, Maine D.E.P. inspector number AI-0349, at the wood yard located on Presumpscott St, Portland, Maine on August 29, 2008.

Four (4) Samples were collected and sent to EMSL in New Jersey where it was analyzed by Polarized Light Microscopy (PLM) (EPA test method #600/M4-82-020) for asbestos content.

All samples were found to contain NO asbestos

Some items that were discovered on site and are assumed to contain asbestos are as follows:

- Circuit breakers in power panels within planer room

The State of Maine Department of Environmental Protection (DEP) considers a material to be an "asbestos containing material" when it is analyzed by PLM and found to contain greater than 1% asbestos

If you have any further questions or need additional information please feel free to contact me at (207)-773-1276.

Sincerely,

Kyle Rickett
Vice President

Enclosures



590 County Rd. Suite #2, Westbrook, Maine 04092

Tel: (207) 773-1276 Fax: (207) 772-1203

Sample Number	Bulk Sample / Description / Location	Volume
B-1	Rear Storage Shed (covered roof)	1500
B-2	Tower Roof	
B-3	Shed next to Tower	
B-4	Sheetrock within tower	



EMSL Analytical, Inc
Revised 07/07/99

CHAIN OF CUSTODY

ASBESTOSEMSL Rep: **Paul Nyfield**

Third Party Billing requires written authorization
from third party

Your Company Name: **Abatement Professionals Corp**
590 County Rd Suite #2
Westbrook, Maine 04092

EMSL- Bill to: **ABAT52**

Fax Results: **Kyle Rickett**
Telephone #: **207-772-1203**



Project
Name/Number: **Presumpscott St**

Purchase Order # **140**

MATRIX			TURNAROUND			
<input type="checkbox"/> Air	<input type="checkbox"/> Soil	<input type="checkbox"/> Micro-Vac	<input type="checkbox"/> 3 Hrs	<input type="checkbox"/> 6 Hrs	<input type="checkbox"/> 12 Hrs *	<input type="checkbox"/> 1 Day
<input type="checkbox"/> Bulk	<input type="checkbox"/> Drinking Water		<input type="checkbox"/> 2 Days	<input type="checkbox"/> 3 Days	<input type="checkbox"/> 4 Days	<input type="checkbox"/> 5 Days
<input type="checkbox"/> Wipe	<input type="checkbox"/> Waste Water		<input type="checkbox"/> 6-10 Days			

Please call ahead to schedule TEM AIR, 3 hours, 6 hours. There is a premium charge for 3 hour TAT; call 1-800-220-3675 for price prior to sending samples

You will be asked to sign an authorization form for this service

* 12 Hours must arrive by 11:00am Mon-Fri. Please refer to Price Quote

<p>PCM-AIR</p> <input type="checkbox"/> NIOSH 7400 (A) Issue 2: August 1994 <input type="checkbox"/> OSHA w/TWA <input type="checkbox"/> Other:	<p>TEM-AIR</p> <input type="checkbox"/> AHERA 40 CFR, Part 763 Subpart E <input type="checkbox"/> NIOSH 7402 Issue 2 <input type="checkbox"/> EPA Level II	<p>TEM-WATER</p> <input type="checkbox"/> EPA 100.1 <input type="checkbox"/> EPA 100.2 <input type="checkbox"/> NYS 198.2
<p>PLM-Bulk</p> <input type="checkbox"/> EPA 9002 <input type="checkbox"/> EPA Point Count 400 <input type="checkbox"/> NY Stratified Point Count <input type="checkbox"/> PLM NOB (Gravimetric) NYS 198.1 <input type="checkbox"/> NIOSH 9002 <input type="checkbox"/> EMSL Standard Addition	<p>TEM-Bulk</p> <input type="checkbox"/> Drop Mount (Qualitative) <input type="checkbox"/> Chatfield SOP-1988-02 <input type="checkbox"/> TEM NOB (Gravimetric) NY 198.4 <input type="checkbox"/> EMSL Standard Addition	<p>TEM Micro Vac/wipe</p> <input type="checkbox"/> ASTM D 5755-95 <input type="checkbox"/> Wipe Qualitative
<p>SEM Air or Bulk</p> <input type="checkbox"/> Qualitative <input type="checkbox"/> Quantitative	<p>PLM Soil</p> <input type="checkbox"/> EPA Protocol Qualitative <input type="checkbox"/> EPA Protocol Quantitative <input type="checkbox"/> EMSL MSD 9000 Method fibers/gram	<p>XRD</p> <input type="checkbox"/> Asbestos <input type="checkbox"/> Silica NIOSH 7500
		<p>OTHER</p> <input type="checkbox"/>

Client Sample # (s) **B-1-B-4**Total Sample #: **4**

Relinquished: _____ Date: _____ Time: _____

Received: _____ Date: _____ Time: _____

Relinquished: _____ Date: _____ Time: _____

Received: _____ Date: _____ Time: _____

**EMSL Analytical, Inc.**

107 Haddon Ave., Westmont, NJ 08108

Phone: (856) 858-4800 Fax: (856) 858-4960 Email: westmontslab@EMSL.com

Attn: **Kyle Rickett**
Abatement Professionals Corp.
590 County Road
Westbrook, ME 04092

Fax: (207) 772-1203 Phone: (207) 773-1276
 Project: **PRESUMPCOTT ST.**

Customer ID: ABAT52
 Customer PO: 140
 Received: 08/28/08 10:30 AM
 EMSL Order: 040822589
 EMSL Proj:
 Analysis Date: 8/28/2008
 Report Date: 8/28/2008

Asbestos Analysis of Bulk Materials via EPA 600/R-93/116 Method using Polarized Light Microscopy

Sample	Location	Appearance	Non-Asbestos		Asbestos
			% Fibrous	% Non-Fibrous	% Type
B-1 040822589-0001	REAR STORAGE SHED	White/Black Fibrous Heterogeneous	50% Cellulose	50% Non-fibrous (other)	None Detected
B-2 040822589-0002	TOWER ROOF	Black Fibrous Heterogeneous	45% Glass	55% Non-fibrous (other)	None Detected
B-3 040822589-0003	SHED NEXT TO TOWER	White/Black Fibrous Heterogeneous	50% Cellulose	50% Non-fibrous (other)	None Detected
B-4 040822589-0004	WITHIN TOWER	Gray/Brown/White Fibrous Heterogeneous	45% Cellulose	55% Non-fibrous (other)	None Detected

MAINE CERT. #BA-0100

Analyst(s)

Debra Beard (4)

Stephen Siegel, CIH, Laboratory Manager
 or other approved signatory

Due to magnification limitations inherent in PLM, asbestos fibers in dimensions below the resolution capability of PLM may not be detected. The limit of detection as stated in the method is 1%. The above test report relates only to the items tested and may not be reproduced in any form without the express written approval of EMSL Analytical, Inc. EMSL's liability is limited to the cost of analysis. EMSL bears no responsibility for sample collection activities or analytical method limitations. Interpretation and use of test results are the responsibility of the client. Samples received in good condition unless otherwise noted. This report must not be used to claim product endorsement by NVLAP or any agency of the U.S. Government.

Analysis performed by EMSL Westmont (NVLAP #101048-0), NY ELAP 10872

