



Permitting and Inspections Department

### Fire Alarm Permit Application

<b>Construction Address:</b> 125 Presumpscot Street	
<b>Total Square Footage of Proposed Structure:</b> 3771	
<b>Tax Assessor's Chart, Block &amp; Lot</b>	
Chart# 425	Block# A
Lot# 2	
<b>Applicant Name:</b> Cunningham Security Systems	
Address: 10 Princes Point Rd Yarmouth, ME 04096	
Phone: 846-3350	
Email: michelle@cunninghamsecurity.com	
<b>Cost of Work:</b> \$ 2150.00	
<b>Lessee/Owner Name (if different):</b>	
125 Presumpscot SPE LLC & Presumpscot-Portland Investors LLC	
Address: 73 W Monroe STE 507 Chicago IL 60603	
Phone:	
Email:	
<b>Contractor Name (if different):</b>	
Address:	
Phone:	
Email:	
<b>Current use (i.e. single family):</b> Retail & Personal Service	
If vacant, what was the previous use?	
<b>Proposed specific use:</b> Retail & Personal Service	
Is property part of a subdivision? If yes, name: No	
<b>Project description:</b> Installation of additional fire alarm devices	
<b>Life Safety Code Occupancy Classification:</b>	
Is this new work or a renovation to an existing system? Renovations to Existing	
Is the top occupiable floor of the building greater than 75 feet above the lowest level of Fire Department access (high-rise)? No	
<b>Name of company providing programming and certification of system*:</b> Cunningham Security Systems	
<b>Electrical permit #:</b> ELEC2020-02283	
<b>Will a master box be installed?</b> <input type="radio"/> Yes <input checked="" type="radio"/> No <b>If yes, complete all items for approval):</b>	
AES approved installing contractor:	
Documentation of AES approval:	
Property Owner:	
Property Owner Billing Address:	
Property common name:	
E-911 address for protected premises:	
Emergency contact phone: Additional emergency contact phone:	
Number of stories protected:	
Is the building protected by a supervised, automatic sprinkler system? <input checked="" type="radio"/> Yes <input type="radio"/> No	
<b>Name of person to contact when the permit is ready:</b> Michelle OBrien	
<b>Address:</b> 10 Princes Point Rd	
<b>City, State &amp; Zip:</b> Yarmouth ME 04096	
<b>Email Address:</b> michelle@cunninghamsecurity.com <b>Phone:</b> 846-3350	

\*For a list of approved fire alarm companies, see [www.portlandmaine.gov/1486/Approved-Fire-Alarm-Companies](http://www.portlandmaine.gov/1486/Approved-Fire-Alarm-Companies)  
389 Congress Street, Room 315/Portland Maine 04101/[www.portlandmaine.gov](http://www.portlandmaine.gov)/tel: 207-874-8703/fax: 207-874-8716



**SILENT  
KNIGHT**

by Honeywell

## SK-Pull-DA Addressable Pull Station

Patented, U.S. Patent No. Des. 428,351; 6,380,846; Other Patents Pending  
Document 52149 156-3447-002

### Description

The SK-Pull-DA Addressable pull station is a non-coded, dual-action manual pull station with a key-lock reset feature. It provides Silent Knight intelligent fire alarm control panels (FACP) with one addressable alarm initiating input. The addressable module is housed inside the pull station. The SK-Pull-DA is compatible with all Silent Knight intelligent panels that use the Intelligent Device Protocol (IDP). Refer to the FACP Installation Manual to determine if Intelligent Device Protocol is supported. The SK-Pull-DA meets the ADAAG controls and operating mechanisms guidelines (section 4.1.3[13]), and the ADA requirement for a 5 lb. maximum pull force to activate the pull station. Operating instructions are molded into the pull station handle along with Braille text. Molded Terminal numbers are also present. Conforms to ANSIVUL Standard 38.

### Ratings

Normal Operating Voltage: 24VDC.  
Average Operating Current (LED Flash): 300  $\mu$ A.  
Temperature Range: 32°F – 120°F (0°C – 49°C).  
Relative Humidity Range: 10% - 93% non-condensing.

### Installation

The SK-Pull-DA Addressable pull station can be surface mounted to a SB-I/O surface backbox or semi-flush mounted on a standard single-gang, double-gang or 4" (10.16 cm) square electrical box. The optional BG-TR trim ring can be used if the SK-Pull-DA is to be semi-flush mounted.

### Operation

To activate the dual-action pull station, push in and pull down on the handle. The word 'ACTIVATED' appears after the handle is pulled down. This will remain until the pull station is reset.

The pull station includes one Single Pole, Single Throw (SPST) Normally Open (N/O) switch which closes upon activation of the pull station.

### Resetting the Pull Station

1. Insert the key into the lock and rotate 1/4 turn counterclockwise.
2. Open the door until the handle returns to normal.
3. Close and lock the door.

### Wiring

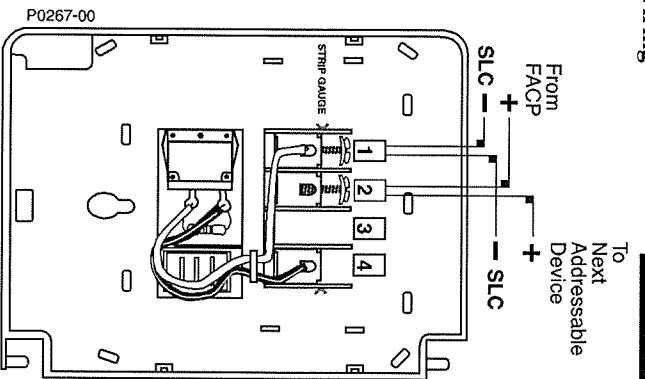

SK-Pull-DA  
Addressable Pull Station  
Document 52149 156-3447-002

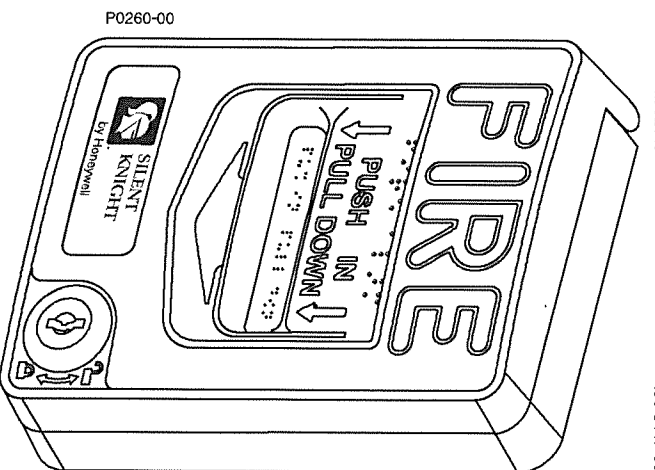

**NOTE:** Closing the door automatically resets the switch to the 'Normal' position. Opening the door will not activate or deactivate the alarm switch.

**CAUTION!** Do not detach the door of the pull station during installation. The door of the pull station cannot be reattached to the backplate after the backplate has already been installed onto an electrical box.

### CAUTION!

Install the Silent Knight SK-Pull-DA addressable pull station in accordance with these instructions, applicable NFPA standards, national and local Fire and Electrical codes and the requirements of the AHJ (Authority Having Jurisdiction). Regular testing of the devices should be conducted in accordance with the appropriate NFPA standards. Failure to follow these directions may result in failure of the device to report an alarm condition. Silent Knight is not responsible for devices that have been improperly installed, tested or maintained.

### ADA Compliance

For ADA compliance, if the clear floor space only allows forward approach to an object, the maximum forward reach height allowed is 48 inches (121.92 cm). If the clear floor space allows parallel approach by a person in a wheelchair, the maximum side reach allowed is 54 inches (137.16 cm).

(over for Programming information)

## Setting the SK-Pull-DA Address

The SK-Pull-DA Addressable pull station is factory preset with address '00'. Set the address for the pull station by turning the rotary address switches on the addressable module mounted inside the pull station. Only one device per address is allowed. Multiple modules may not be set to the same address on the Signaling Line Circuit. Once the address is set, record it in the space provided on the product ID label located inside the pull station.

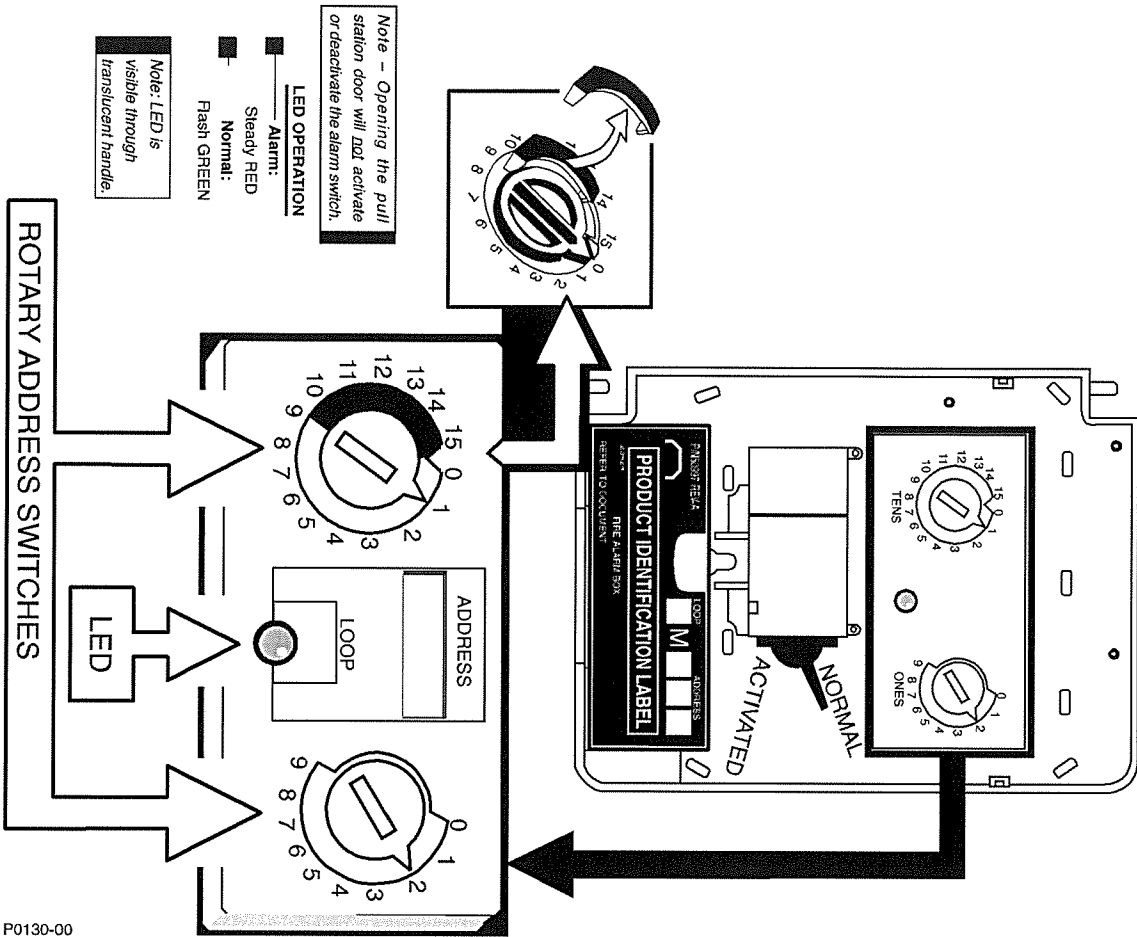

P0130-00



Reviewed for Code Compliance  
 Permitting and Inspections Department  
 Approved with Conditions

01/13/2020

# SK-PHOTO-W Series

## Intelligent Plug-In Photoelectric Smoke Detector

Honeywell Silent Knight SK-PHOTO-W Series plug-in smoke detectors are designed for both performance and aesthetics. A new modern, sleek, contemporary design and enhanced optical sensing chamber is engineered to sense smoke produced by a wide range of combustion sources in accordance with more stringent code standards.

The SK-PHOTO-W Series detector sensitivity can be programmed in the control panel software. Sensitivity is continuously monitored and reported to the panel. Point ID capability allows each detector's address to be set with rotary, decimal address switches, providing exact detector location for selective maintenance when chamber contamination reaches an unacceptable level.

Dual electronic thermistors add 135°F (57°C) fixed temperature thermal sensing on the SK-PHOTO-T-W. The SK-PHOTO-R-W is a remote test capable detector for use with DNR Series duct detector housings.

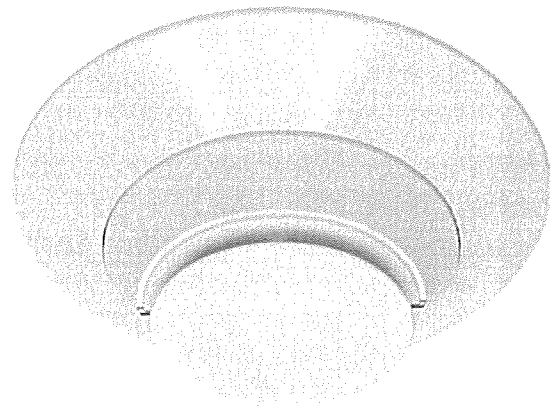

**SK-PHOTO-W**

## FEATURES & BENEFITS

- New modern profile for improved aesthetics
- Stable communication technique with noise immunity
- Low standby current
- Two-wire SLC connection
- Optional remote, single-gang LED accessory
- Dual LED design provides 360° viewing angle
- Remote test feature from the panel
- Built-in functional test switch activated by external magnet
- Built-in tamper-resistant feature
- Sealed against back pressure
- Expanded color options
- SEMS screws for wiring of the separate base
- Optional relay, isolator, and sounder bases
- Plugs into separate base for ease of installation and maintenance

## **DETECTOR SPACING AND APPLICATIONS**

Honeywell recommends spacing detectors in compliance with NFPA 72. In low airflow applications with smooth ceiling, space detectors 30 feet (9m). For specific information regarding detector spacing, placement, and special applications refer to NFPA 72. System Smoke Detector Application Guide, document A05-1003, is available at [systemsensor.com](http://systemsensor.com)

## **INSTALLATION**

The SK-PHOTO-W Series plug-in detectors use a separate base to simplify installation, service, and maintenance. Installation instructions are shipped with each detector.

Mount base (all base types) on an electrical backbox which is at least 1.5" (3.81 cm) deep.

## **NOTE:**

- Because of the inherent supervision provided by the SLC loop, end-of-line resistors are not required. Wiring "T-taps" or branches are permitted for Style 4 (Class "B") wiring.
- When using relay or sounder bases, consult the installation sheet for device limitations between isolator modules and isolator bases.

## **ORDERING INFORMATION**

**SK-PHOTO-W:** Photoelectric smoke detector, white.

**SK-PHOTO-R-W:** Photoelectric smoke detector, remote test capable, for use with DNR(W) duct smoke detectors, white.

**SK-PHOTO-T-W:** Photoelectric smoke detector with thermal sensing, white.

## **INTELLIGENT BASES**

**B300-6:** White, standard flanged low-profile mounting base.

**B300-6-BP:** Bulk pack of B300-6, package contains 10.

**B300-6-IV:** Ivory, standard flanged low-profile mounting base.

**B501-WHITE:** White, standard European flangeless mounting base. UL listed.

**B501-BL:** Black, standard European flangeless mounting base. UL listed.

**B501-IV:** Ivory, standard European flangeless mounting base. UL listed.

**B200S-WH:** White, Intelligent, programmable sounder base.

**B200S-IV:** Ivory, Intelligent, programmable sounder base.

**B200SR-WH:** White, Intelligent sounder base for retrofit applications.

**B200SR-IV:** Ivory, Intelligent sounder base for retrofit applications.

**B200S-LF-WH:** White, Low Frequency Intelligent, programmable sounder base.

**B200S-LF-IV:** Ivory, Low Frequency Intelligent, programmable sounder base.

**B200SR-LF-WH:** White, Low Frequency Intelligent sounder base for retrofit applications.

**B200SR-LF-IV:** Ivory, Low Frequency Intelligent sounder base for retrofit applications.

**B224RB-WH:** White, plug-in System Sensor relay base.

**B224RB-IV:** Ivory, plug-in System Sensor relay base.

**B224BI-WH:** White, plug-in System Sensor isolator detector base.

**B224BI-IV:** Ivory, plug-in System Sensor isolator detector base.

## **ACCESSORIES**

**CK300:** Color Kit (includes cover and trim ring), white, 10-Pack.

**CK300-IV:** Color Kit (includes cover and trim ring), ivory, 10-Pack.

**CK300-BL:** Color Kit (includes cover and trim ring), black, 10-Pack.

**M02-04-01:** Detector test magnet.

**M02-09-00:** Telescoping test magnet.

**RA100Z:** Remote LED annunciator

**SMB600:** Surface Mounting Kit (flanged).

**TR300:** Replacement trim ring for B300-6, white.

**TR300-IV:** Replacement trimring for B300-6-IV, ivory.



Reviewed for Code Compliance  
Permitting and Inspections Department  
Approved with Conditions  
**01/13/2020**





Reviewed for Code Compliance  
Permitting and Inspections Department  
Approved with Conditions

01/13/2020

# SK-PHOTO-W Series Detector Technical Specifications

## PHYSICAL

**Height:** 2.0" (51mm) installed in B300-6 base  
**Diameter:** 6.2" (156mm) installed in B300-6 base  
4.1" (104 mm) installed in B501 base  
**Weight:** 3.4 oz (95 g)

## ENVIRONMENTAL

**Operating Temperature range:**  
**Photo:** 32°F to 122°F (0°C to 50°C)  
**Photo with Thermal:** 32°F to 100°F (0°C to 38°C)  
**UL listed Velocity range:** Photo/Photo with Thermal: 0 to 4,000 fpm (0 to 20 m/sec) (suitable for installation in ducts)  
**Humidity:** 10% to 93% non-condensing  
**Thermal Ratings:** Fixed Temperature Set point: 135°F (57°C)

## ELECTRICAL RATINGS

**Voltage Range:** 15 to 32VDC peak  
**Operating Current @ 24VDC:** 200µA (one communication every 5 seconds with green LED blink on communication)  
**Maximum Current:** 4.5mA @ 24VDC (one communication every 5 seconds with amber LED solid on).

## COMPATIBILITY

The SK-PHOTO-W series detectors are compatible with the following Honeywell Silent Knight fire alarm control panels:

**6820:** Addressable fire alarm control panel  
**6820EVS:** Addressable fire alarm control panel with an emergency voice system.  
**6808:** Addressable fire alarm control panel  
**6700:** Addressable fire alarm control panel  
**5700:** Addressable fire alarm control panel  
**5808:** Addressable fire alarm control panel  
**5820XL:** Addressable fire alarm control panel  
**5820XL-EVS:** Addressable fire alarm control panel with an emergency voice system

## AGENCY LISTINGS AND APPROVALS

For exact certification listings for each model, please reference the respective agency Web site.  
**UL listed:** S6173  
**FM approved**  
**CSFM:** 7272-0559:0523

For a complete listing of all compliance approvals and certifications, please visit [www.silentknight.com](http://www.silentknight.com).

Microsoft, Windows, and the Windows Logo are registered trademarks or trademarks of Microsoft Corporation.

Silent Knight®, System Sensor® and Honeywell® are registered trademarks of Honeywell International, Inc.

This document is not intended to be used for installation purposes. We try to keep our product information up-to-date and accurate. We cannot cover all specific applications or anticipate all requirements. All specifications are subject to change without notice.

For Technical Support, call 800-446-6444.

## For more information

Learn more about Honeywell Silent Knight and other products by visiting [www.silentknight.com](http://www.silentknight.com)

## Honeywell Silent Knight

12 Clintonville Road  
Northford, CT 06472  
800-328-0103



## Indoor Selectable-Output Horns, Strobes, and Horn Strobes for Wall Applications

*System Sensor L-Series audible visible notification products are rich with features guaranteed to cut installation times and maximize profits with lower current draw and modern aesthetics.*

### Features

- Updated Modern Aesthetics
- Small profile devices for Horns and Horn Strobes
- Plug-in design with minimal intrusion into the back box
- Tamper-resistant construction
- Automatic selection of 12- or 24-volt operation at 15 and 30 candela
- Field-selectable candela settings on wall units: 15, 30, 75, 95, 110, 135, and 185
- Horn rated at 88+ dBA at 16 volts
- Rotary switch for horn tone and two volume selections
- Mounting plate for all standard and all compact wall units
- Mounting plate shorting spring checks wiring continuity before device installation
- Electrically compatible with legacy SpectrAlert and SpectrAlert Advance devices
- Compatible with MDL3 sync module
- Strobes and Horn Strobes listed for wall mounting only
- Horns listed for wall or ceiling use

### Agency Listings



FM approval descent  
for ALERT models:  
3067353, 3067972



7125-165-1024  
7125-165-1024

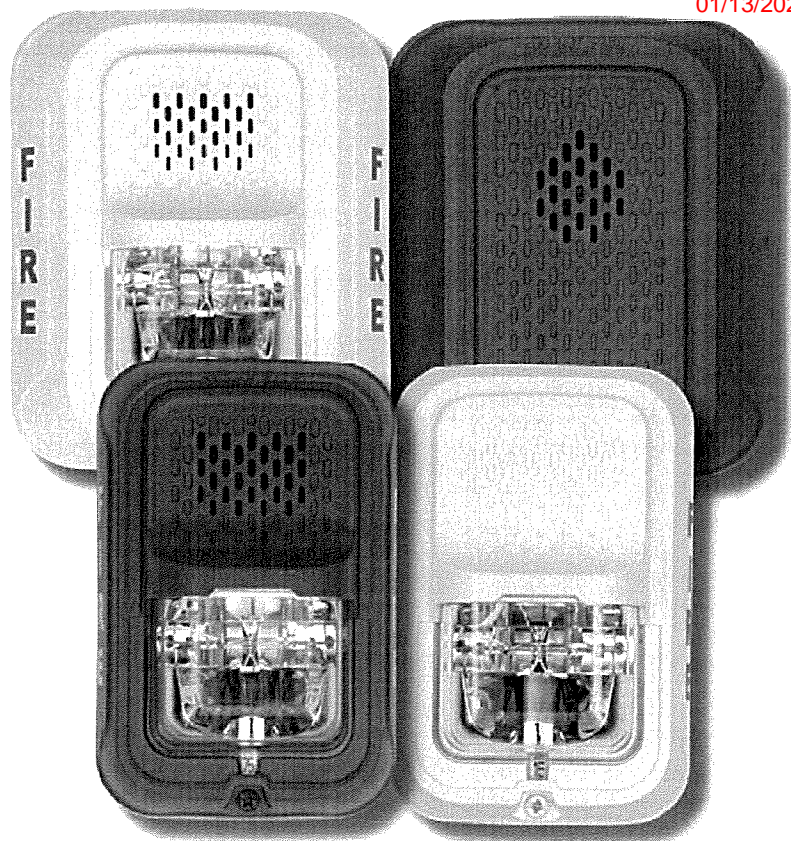

**The System Sensor L-Series** offers the most versatile and easy-to-use line of horns, strobes, and horn strobes in the industry with lower current draws and modern aesthetics. With white and red plastic housings, standard and compact devices, and plain, FIRE, and FUEGO-printed devices, System Sensor L-Series can meet virtually any application requirement.

The L-Series line of wall-mount horns, strobes, and horn strobes include a variety of features that increase their application versatility while simplifying installation. All devices feature plug-in designs with minimal intrusion into the back box, making installations fast and foolproof while virtually eliminating costly and time-consuming ground faults.

To further simplify installation and protect devices from construction damage, the L-Series utilizes a universal mounting plate for all models with an onboard shorting spring, so installers can test wiring continuity before the device is installed.

Installers can also easily adapt devices to suit a wide range of application requirements using field-selectable candela settings, automatic selection of 12- or 24-volt operation, and a rotary switch for horn tones with two volume selections.



## L-Series Specifications

### Architect/Engineer Specifications

#### General

L-Series standard horns, strobes, and horn strobes shall mount to a standard 2 x 4 x 1<sup>7</sup>/<sub>8</sub>-inch back box, 4 x 4 x 1<sup>1</sup>/<sub>2</sub>-inch back box, 4-inch octagon back box, or double-gang back box. L-Series compact products shall mount to a single-gang 2 x 4 x 1<sup>7</sup>/<sub>8</sub>-inch back box. A universal mounting plate shall be used for mounting ceiling and wall products for all standard models and a separate universal mounting plate shall be used for mounting wall compact models. The notification appliance circuit wiring shall terminate at the universal mounting plate. Also, L-Series products, when used with the Sync•Circuit™ Module accessory, shall be powered from a non-coded notification appliance circuit output and shall operate on a nominal 12 or 24 volts. When used with the Sync•Circuit Module, 12-volt-rated notification appliance circuit outputs shall operate between 8.5 and 17.5 volts; 24-volt-rated notification appliance circuit outputs shall operate between 16.5 and 33 volts. Indoor L-Series products shall operate between 32 and 120 degrees Fahrenheit from a regulated DC or full-wave rectified unfiltered power supply. Strobes and horn strobes shall have field-selectable candela settings including 15, 30, 75, 95, 110, 135, and 185.

#### Strobe

The strobe shall be a System Sensor L-Series Model \_\_\_\_\_ listed to UL 1971 and shall be approved for fire protective service. The strobe shall be wired as a primary-signaling notification appliance and comply with the Americans with Disabilities Act requirements for visible signaling appliances, flashing at 1 Hz over the strobe's entire operating voltage range. The strobe light shall consist of a xenon flash tube and associated lens/reflector system.

#### Horn Strobe Combination

The horn strobe shall be a System Sensor L-Series Model \_\_\_\_\_ listed to UL 1971 and UL 464 and shall be approved for fire protective service. The horn strobe shall be wired as a primary-signaling notification appliance and comply with the Americans with Disabilities Act requirements for visible signaling appliances, flashing at 1 Hz over the strobe's entire operating voltage range. The strobe light shall consist of a xenon flash tube and associated lens/reflector system. The horn shall have two audibility options and an option to switch between a temporal three pattern and a non-temporal (continuous) pattern. These options are set by a multiple position switch. The horn on horn strobe models shall operate on a coded or non-coded power supply.

#### Synchronization Module

The module shall be a System Sensor Sync•Circuit model MDL3 listed to UL 464 and shall be approved for fire protective service. The module shall synchronize Strobes at 1 Hz and horns at temporal three. Also, while operating the strobes, the module shall silence the horns on horn strobe models over a single pair of wires. The module shall mount to a 4<sup>11</sup>/<sub>16</sub> x 4<sup>11</sup>/<sub>16</sub> x 2<sup>1</sup>/<sub>8</sub>-inch back box. The module shall also control two Style Y (class B) circuits or one Style Z (class A) circuit. The module shall synchronize multiple zones. Daisy chaining two or more synchronization modules together will synchronize all the zones they control. The module shall not operate on a coded power supply.

### Physical/Electrical Specifications

Standard Operating Temperature	32°F to 120°F (0°C to 49°C)
Humidity Range	10 to 93% non-condensing
Strobe Flash Rate	1 flash per second
Nominal Voltage	Regulated 12 DC or regulated 24 DC/FWR <sup>1</sup>
Operating Voltage Range <sup>2</sup>	8 to 17.5 V (12 V nominal) or 16 to 33 V (24 V nominal)
Operating Voltage Range MDL3 Sync Module	8.5 to 17.5 V (12 V nominal) or 16.5 to 33 V (24 V nominal)
Input Terminal Wire Gauge	12 to 18 AWG
Wall-Mount Dimensions (including lens)	5.6" L x 4.7" W x 1.91" D (143 mm L x 119 mm W x 49 mm D)
Compact Wall-Mount Dimensions (including lens)	5.26" L x 3.46" W x 1.91" D (133 mm L x 88 mm W x 49 mm D)
Horn Dimensions	5.6" L x 4.7" W x 1.25" D (143 mm L x 119 mm W x 32 mm D)
Compact Horn Dimensions	5.25" L x 3.45" W x 1.25" D (133 mm L x 88 mm W x 32 mm D)

1. Full Wave Rectified (FWR) voltage is a non-regulated, time-varying power source that is used on some power supply and panel outputs.

2. Strobe products will operate at 12 V nominal only for 15 cd and 30 cd.





## UL Current Draw Data

UL Max. Strobe Current Draw (mA RMS)				
	Candela	8-17.5 Volts		16-33 Volts
		DC	DC	FWR
Candela Range	15	88	43	60
	30	143	63	83
	75	N/A	107	136
	95	N/A	121	155
	110	N/A	148	179
	135	N/A	172	209
	185	N/A	222	257

UL Max. Horn Current Draw (mA RMS)				
Sound Pattern	dB	8-17.5 Volts		16-33 Volts
		DC	DC	FWR
Temporal	High	39	44	54
Temporal	Low	28	32	54
Non-Temporal	High	43	47	54
Non-Temporal	Low	29	32	54
3.1 KHz Temporal	High	39	41	54
3.1 KHz Temporal	Low	29	32	54
3.1 KHz Non-Temporal	High	42	43	54
3.1 KHz Non-Temporal	Low	28	29	54
Coded	High	43	47	54
3.1 KHz Coded	High	42	43	54

UL Max. Current Draw (mA RMS), Wall Horn Strobe, Candela Range (15-185 cd)										
DC Input	8-17.5 Volts			16-33 Volts						
	15cd	30cd		15cd	30cd	75cd	95cd	110cd	135cd	185cd
Temporal High	98	158		54	74	121	142	162	196	245
Temporal Low	93	154		44	65	111	133	157	184	235
Non-Temporal High	106	166		73	94	139	160	182	211	262
Non-Temporal Low	93	156		51	71	119	139	162	190	239
3.1K Temporal High	93	156		53	73	119	140	164	190	242
3.1K Temporal Low	91	154		45	66	112	133	160	185	235
3.1K Non-Temporal High	99	162		69	90	135	157	175	208	261
3.1K Non-Temporal Low	93	156		52	72	119	138	162	192	242
FWR Input	16-33 Volts									
	15cd	30cd		75cd	95cd	110cd	135cd	185cd		
Temporal High	83	107		156	177	198	234	287		
Temporal Low	68	91		145	165	185	223	271		
Non-Temporal High	111	135		185	207	230	264	316		
Non-Temporal Low	79	104		157	175	197	235	283		
3.1K Temporal High	81	105		155	177	196	234	284		
3.1K Temporal Low	68	90		145	166	186	222	276		
3.1K Non-Temporal High	104	131		177	204	230	264	326		
3.1K Non-Temporal Low	77	102		156	177	199	234	291		

## Horn Tones and Sound Output Data

Horn and Horn Strobe Output (dBA)					
Switch Position	Sound Pattern	dB	8-17.5	16-33	
			Volts	Volts	FWR
1	Temporal	High	84	89	89
2	Temporal	Low	75	83	83
3	Non-Temporal	High	85	90	90
4	Non-Temporal	Low	76	84	84
5	3.1 KHz Temporal	High	83	88	88
6	3.1 KHz Temporal	Low	76	82	82
7	3.1 KHz Non-Temporal	High	84	89	89
8	3.1 KHz Non-Temporal	Low	77	83	83
9*	Coded	High	85	90	90
10*	3.1 KHz Coded	High	84	89	89

\* Settings 9 and 10 are not available on 2-wire horn strobes. Temporal coding must be provided by the NAC. If the NAC voltage is held constant, the horn output remains constantly on.



## L-Series Dimensions

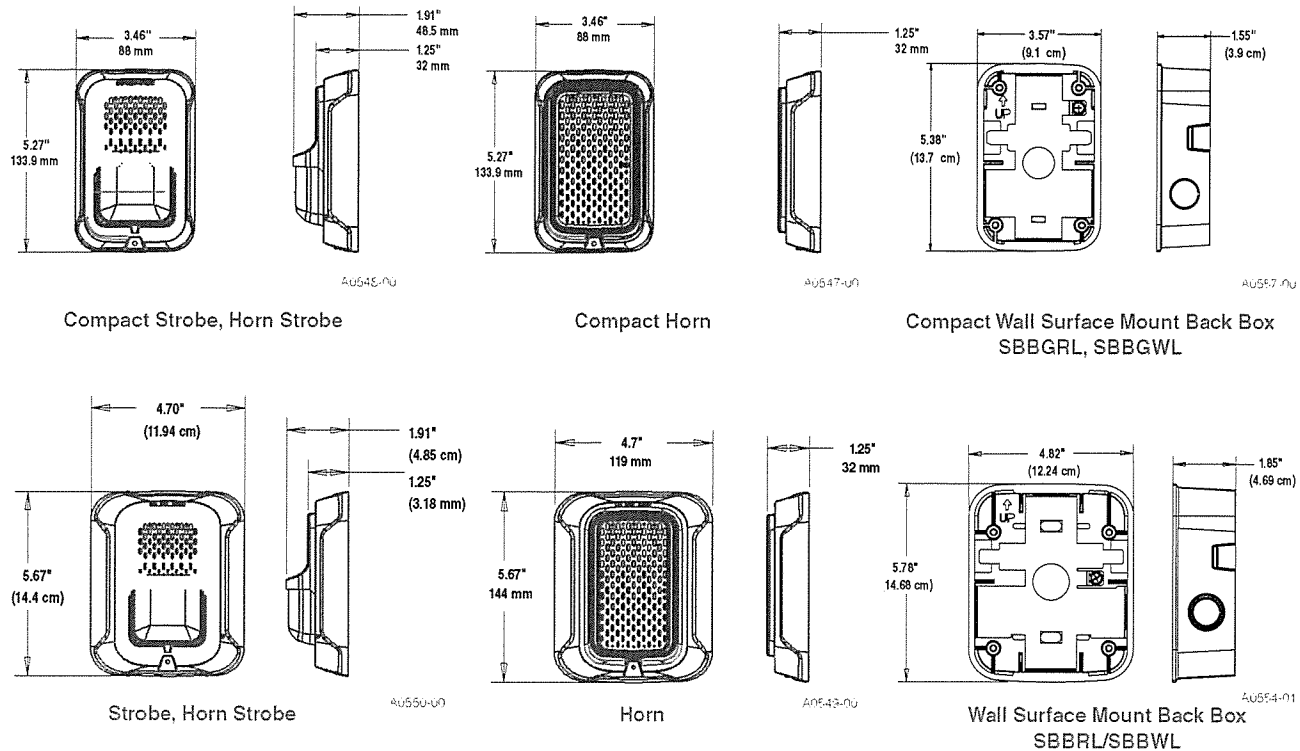

## L-Series Ordering Information

Model	Description
<b>Wall Horn Strobes</b>	
P2RL	2-Wire, Horn Strobe, Red
P2WL	2-Wire, Horn Strobe, White
P2GRL	2-Wire, Compact Horn Strobe, Red
P2GWL	2-Wire, Comp 2 fils act Horn Strobe, White
P2RL-P	2-Wire, Horn Strobe, Red, Plain
P2WL-P	2-Wire, Horn Strobe, White, Plain
P2RL-SP	2-Wire, Horn Strobe, Red, FUEGO
P2WL-SP	2-Wire, Horn Strobe, White, FUEGO
P4RL	4-Wire, Horn Strobe, Red
P4WL	4-Wire, Horn Strobe, White
<b>Wall Strobes</b>	
SRL	Strobe, Red
SWL	Strobe, White
SGRL	Compact Strobe, Red
SGWL	Compact Strobe, White
SRL-P	Strobe, Red, Plain
SWL-P	Strobe, White, Plain
SRL-SP	Strobe, Red, FUEGO
SWL-CLR-ALERT	Strobe, White, ALERT

Model	Description
<b>Horns*</b>	
HRL*	Horn, Red
HWL*	Horn, White
HGRL*	Compact Horn, Red
HGWL*	Compact Horn, White
<b>Accessories</b>	
TR-2	Universal Wall Trim Ring Red
TR-2W	Universal Wall Trim Ring White
SBBRL	Wall Surface Mount Back Box, Red
SBBWL	Wall Surface Mount Back Box, White
SBBGRL	Compact Wall Surface Mount Back Box, Red
SBBGWL	Compact Wall Surface Mount Back Box, White

### Notes:

- All -P models have a plain housing (no "FIRE" marking on cover).
- All -SP models have "FUEGO" marking on cover.
- All -ALERT models have "ALERT" marking on cover.
- \*Horn-only models are listed for wall or ceiling use.



3825 Ohio Avenue • St. Charles, IL 60174  
Phone: 800-SENSOR2 • Fax: 630-377-6495  
www.systemsensor.com

©2018 System Sensor  
Product specifications subject to change without notice. Visit [www.systemsensor.com](http://www.systemsensor.com)  
for current product information, including the latest revision of this data sheet.  
AVD0495-05 • 2/29/2016