

1 BITUMINOUS CONCRETE PAVEMENT SECTION
C-201 NOT TO SCALE

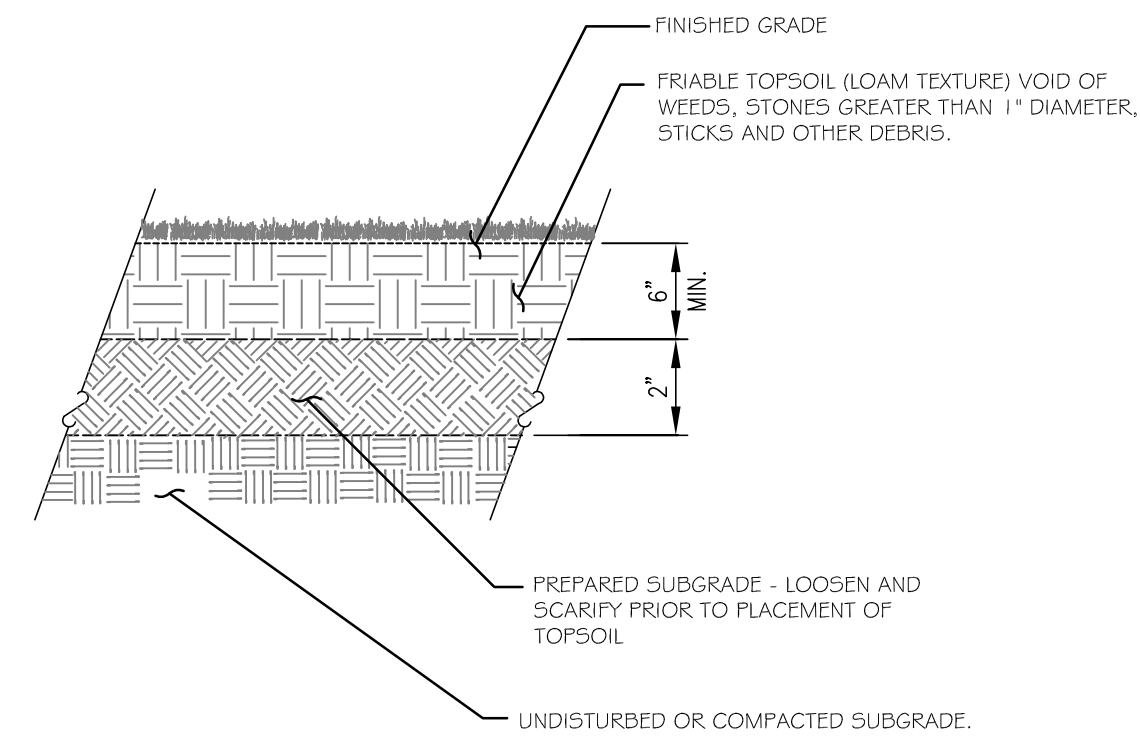

2 LAWN INSTALLATION DETAIL
C-201 NOT TO SCALE

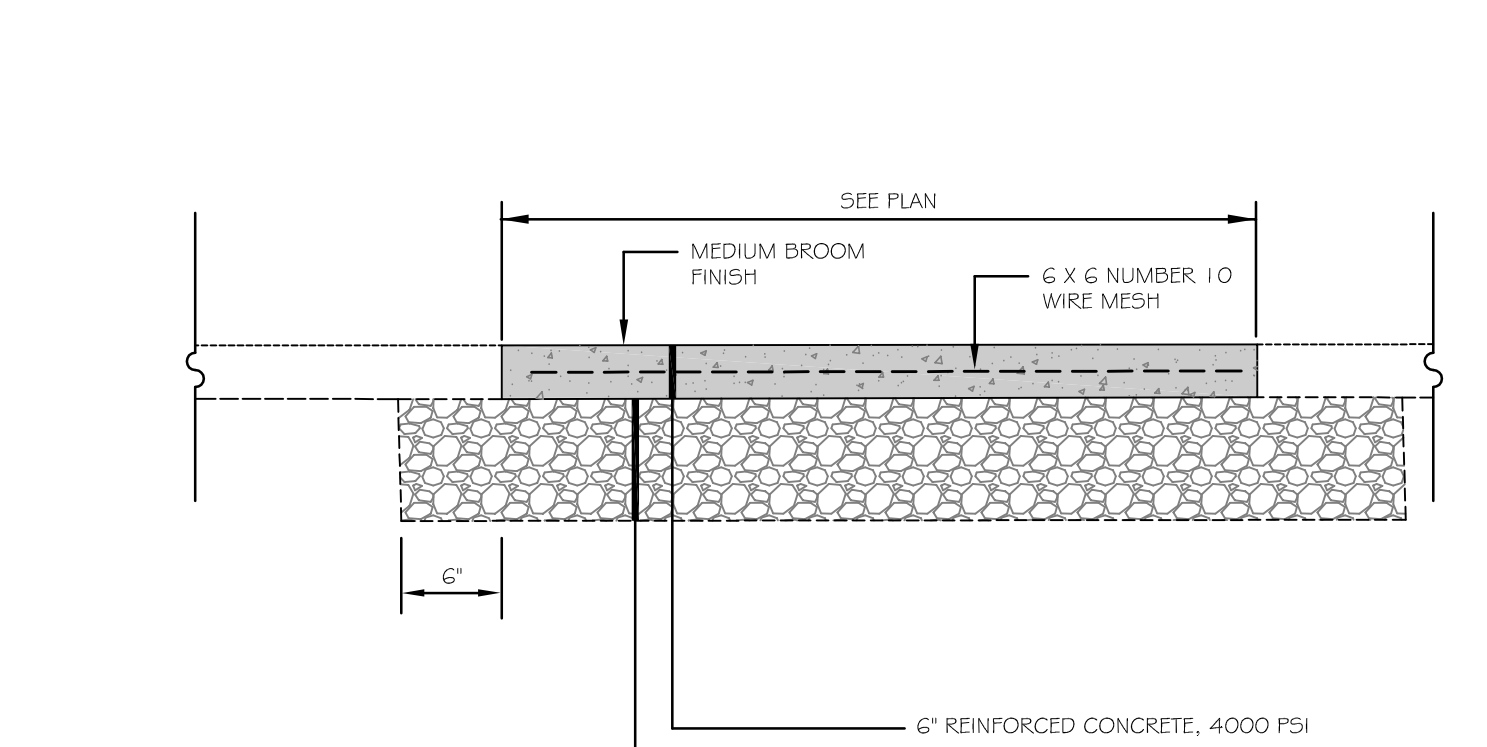

3 CONCRETE PAD
C-201 NOT TO SCALE

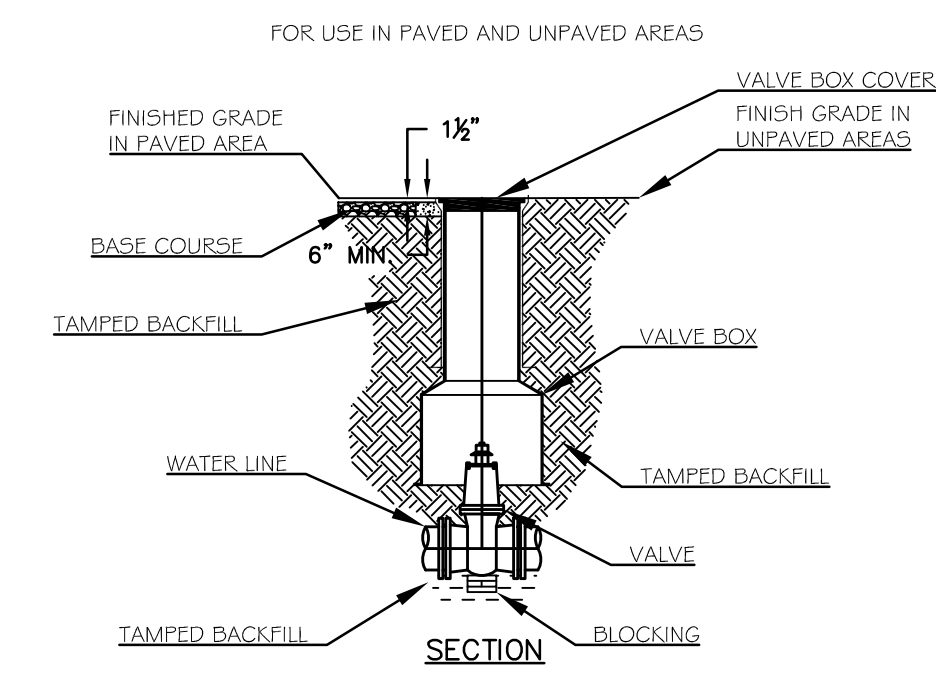

- NOTES:
1. ALL WORK TO CONFORM TO THE PORTLAND WATER DISTRICT STANDARDS AND REQUIREMENTS.
 2. D.I.P. MAY BE USED FOR VALVE BOX EXTENSIONS.
 3. VALVE BOX SHOULD NOT CONTACT WATER MAIN OR VALVE.
 4. CONCRETE PROTECTOR RING SHALL BE USED IN ALL UNPAVED AREAS.

4 VALVE AND VALVE BOX INSTALLATION DETAIL
C-201 NOT TO SCALE

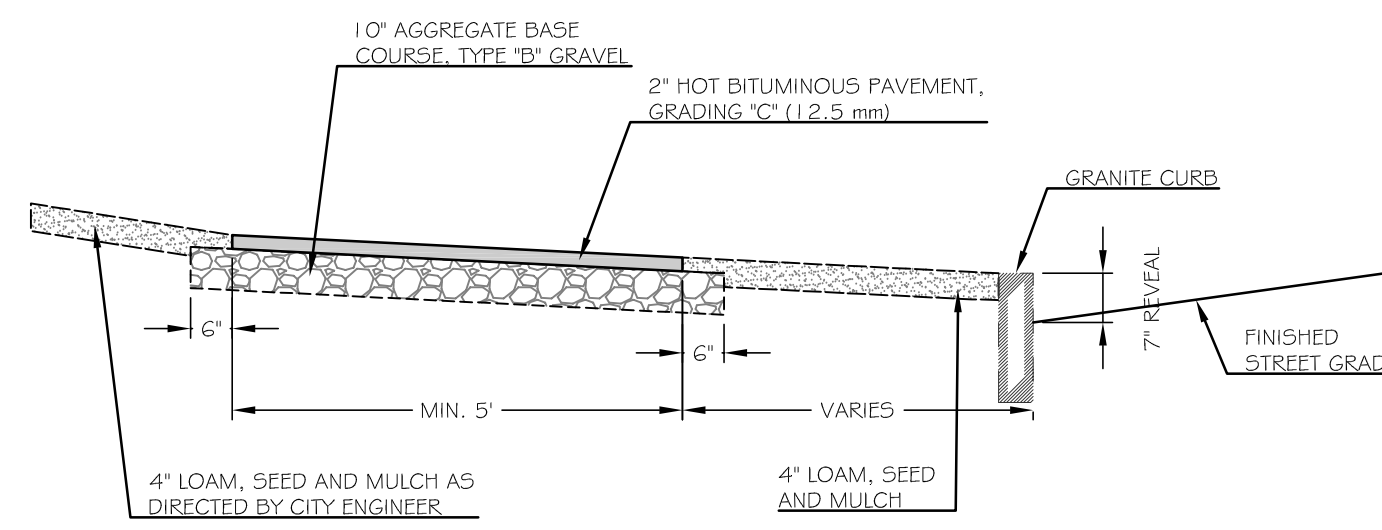

5 BITUMINOUS SIDEWALK
C-201 NOT TO SCALE

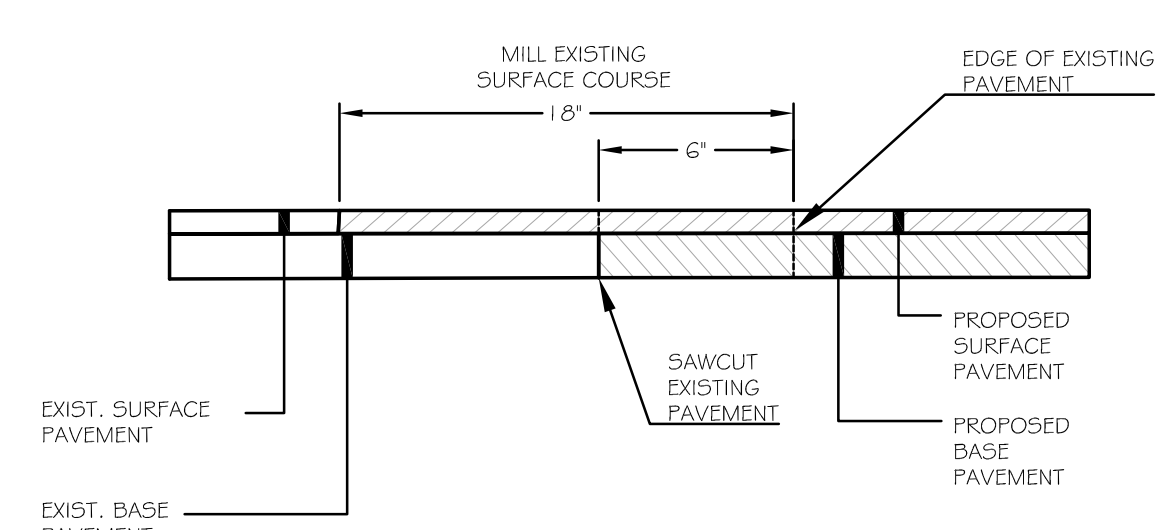

6 HMA PAVEMENT BUTT JOINT DETAIL
C-201 NOT TO SCALE

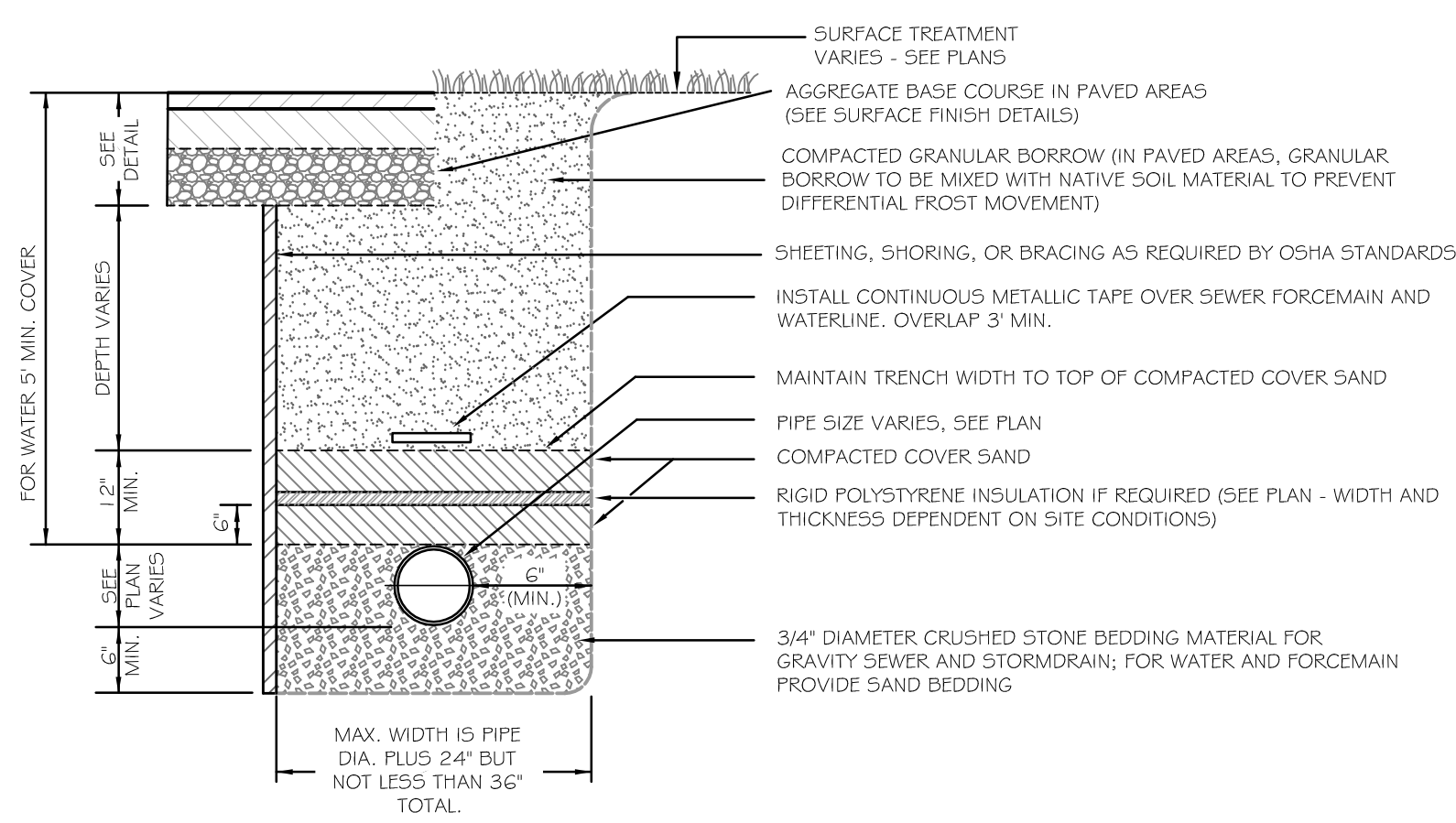

7 TYPICAL PIPE TRENCHING DETAIL
C-201 NOT TO SCALE

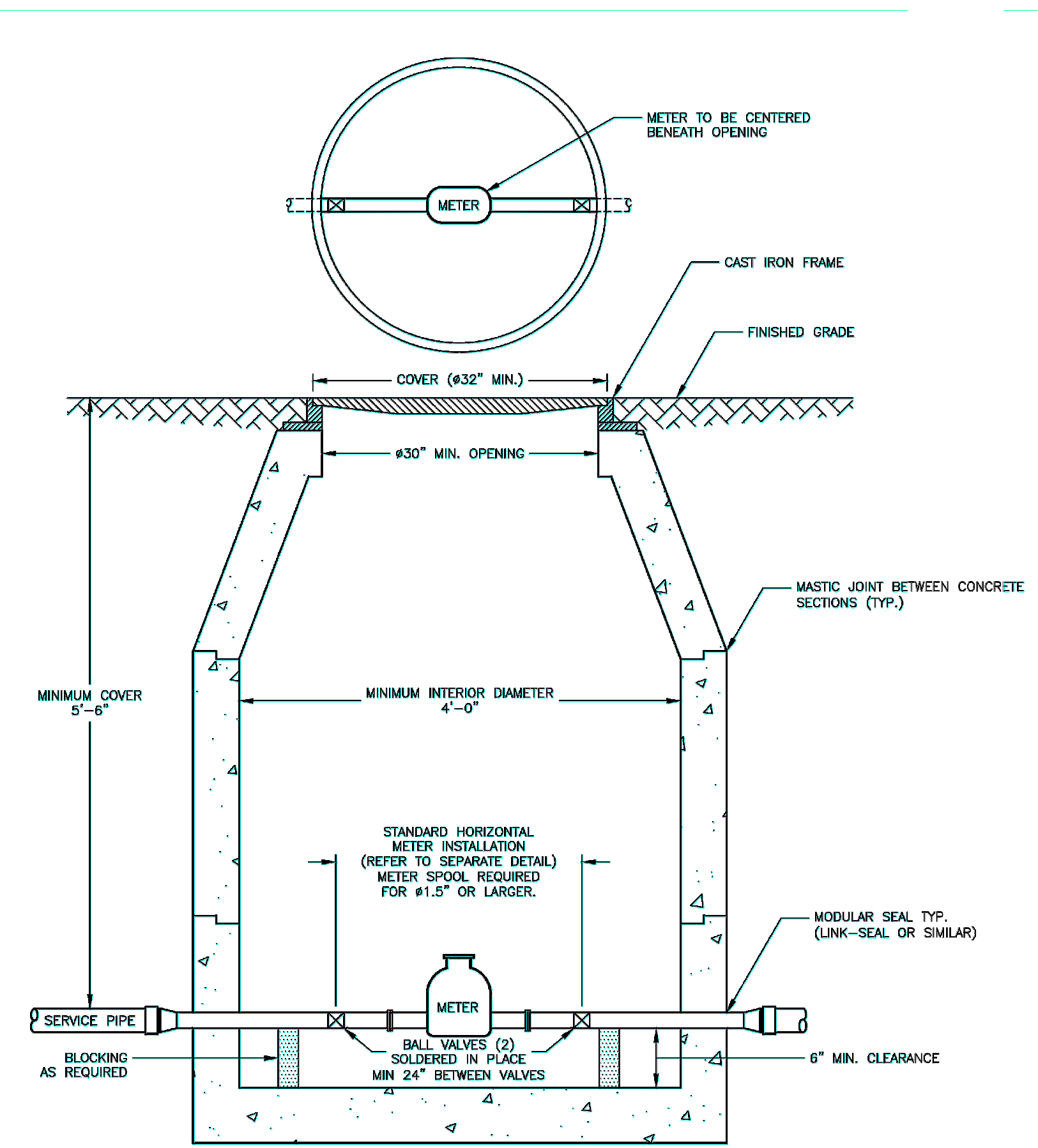

8 WATER METER PIT DETAIL
C-201 NOT TO SCALE

- METER PIT AND COVER NOTES
1. THE METER PIT SHALL BE SUPPLIED AND INSTALLED BY THE CUSTOMER AND LOCATED ON PRIVATE PROPERTY BETWEEN 10' AND 20' FROM THE PROPERTY LINE.
 2. THE METER PIT SHALL BE MADE OF PRECAST CONCRETE OF SUFFICIENT SIZE TO PROVIDE 5.5' MINIMUM GROUND COVER FROM FINISHED GRADE TO THE TOP OF THE SERVICE PIPE. ANY SEAMS BETWEEN CONCRETE SECTIONS SHALL BE SEALED WITH MASTIC JOINT. ALL OPENINGS IN THE CONCRETE FOR SERVICE PIPING SHALL BE SEALED WITH A MODULAR SEAL (LINK-SEAL OR SIMILAR).
 3. THE INTERIOR OF THE METER PIT SHALL BE A MINIMUM OF 4' IN DIAMETER, AND THE METER PIT OPENING SHALL BE A MINIMUM OF 30" IN DIAMETER WITH A CAST IRON FRAME. THE METER PIT COVER SHALL BE CAST IRON, 32" MINIMUM IN DIAMETER, AND BE EITHER PERMANENTLY LABELED "WATER" OR HAVE NO LABEL. ANY STEEL PLATE MATERIAL SHALL BE COATED WITH A RUST INHIBITOR PAINT.
 4. WALL-MOUNTED LADDER RUNGS SHALL NOT BE INSTALLED WITHIN METER PIT.
 5. ALL PIPING INSIDE AND EXTENDING THROUGH THE METER PIT SHALL BE MADE OF COPPER, WITH A MINIMUM OF 8" CLEARANCE FROM THE METER PIT FLOOR. BLOCKING SHALL BE INSTALLED AS REQUIRED TO SUPPORT THE PIPE.
 6. CUSTOMER SHALL ENSURE THE METER PIT AND COVER ARE PROPERLY RATED FOR TRAFFIC FLOW, IF APPLICABLE.
- METER NOTES
7. ONLY PWD PERSONNEL ARE AUTHORIZED TO INSTALL WATER METERS. PWD PERSONNEL ARE ADDITIONALLY AUTHORIZED TO OPERATE METER VALVES AS NEEDED FOR INSTALLATION AND MAINTENANCE.
 8. PWD WILL SUPPLY THE WATER METER. ALL OTHER FITTINGS, INCLUDING A METER RESETTER FOR 1" OR SMALLER METERS, SHALL BE SUPPLIED AND INSTALLED BY CUSTOMER.
 9. FOR 1.5" AND 2" METERS, CUSTOMER SHALL INSTALL A FLANGED METER SPOOL PIECE, SUPPLIED BY PWD AT NO ADDITIONAL CHARGE, PRIOR TO METER SET. THE METER SPOOL WILL BE MADE AVAILABLE FOR CUSTOMER PICKUP AT PWD CUSTOMER SERVICE, 229 DOUGLASS STREET, PORTLAND DURING NORMAL BUSINESS HOURS.
 10. CUSTOMER WILL INSTALL TWO BALL VALVES AT LEAST 24" APART FOR METER INSTALLATION, ALLOWING FOR THE WATER METER TO BE CENTERED UNDER THE METER PIT OPENING. THE BALL VALVES SHALL BE SOLDERED IN PLACE.
 11. THE METER PIT MAY HOUSE UP TO TWO 5/8", 3/4" OR 1" METERS WITH PRIOR APPROVAL FROM PWD.

REV.	DATE	STATUS	BY	CHKD.	APPD.	REV.	DATE	STATUS	BY	CHKD.	APPD.
A	11/30/17	SUBMITTED TO THE CITY OF PORTLAND FOR LEVEL 2 SITE PLAN APPLICATION	DEPT.	SWC	PBB						

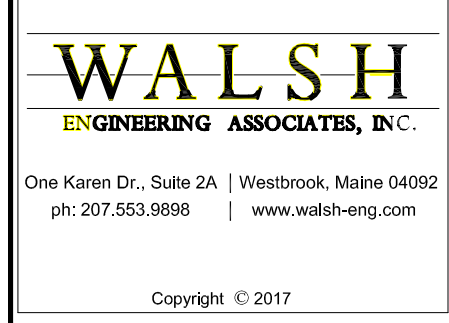
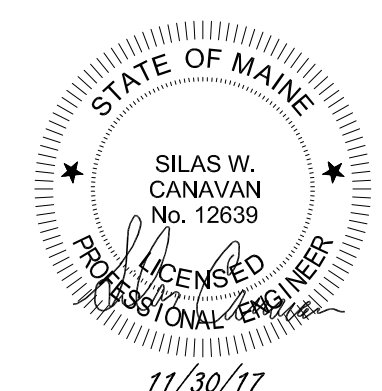

LAND DESIGN SOLUTIONS
LAND PLANNING, SITE PLANNING & LANDSCAPE ARCHITECTURE
P.O. Box 316, 160 Longwoods Road, Cumberland, ME 04012 tel: (207) 494-1111
APPLICANT & OWNER:
JAKE'S DEVELOPMENT, INC.
30 LEDGEWOOD DRIVE, FALMOUTH, MAINE 04105

DESIGN: PBB
DRAWN: DEPT.
CHKD: PBB
DATE: NOV. 2017
SCALE: N.T.S.

PROPOSED PRESUMPSCOT STREET BUSINESS PARK
314-316 PRESUMPSCOT STREET, PORTLAND, MAINE
SITE DETAILS
PROJ. NO. 16-115
DWG. NO. C-201
REV. A