

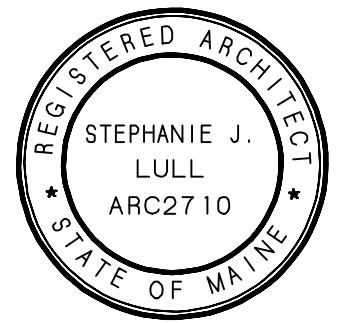

Reviewed for Code Compliance  
Permitting and Inspections Department  
Approved with Conditions

01/29/2019



IBC 2015: CODE DATA

OCCUPANT LOAD - TABLE 1004.1.2	1/1 IND. 1483/100=11 B 1514/100=20
USE GROUP CLASSIFICATION - SECTION 304.2, 304.1	F-1 FACTORY INDUSTRIAL, B BUSINESS
TYPE OF CONSTRUCTION - TABLE 601	V-B
ACTUAL BUILDING AREA	4,000 S.F.
BUILDING AREA LIMITATION - TABLE 504.2	8500 S.F. (NO SPRINKLER)
STREET FRONTAGE INCREASE - 504.3.3	850 S.F. (SEE BELOW)
ALLOWABLE BUILDING AREA	4,350 S.F.
BUILDING HEIGHT LIMITATION - TABLE 504.4	1 STORY
BUILDING HEIGHT	24'-0" 1 STORY
FIRE SUPPRESSION - 403.2.4	NOT REQUIRED
FIRE RESISTANT CONSTRUCTION:	
STRUCTURAL FRAME	NA
EXTERIOR BEARING WALLS	NA
INTERIOR BEARING WALLS	NA
EXTERIOR NONBEARING WALLS	NA
FIRE WALLS & PARTY WALLS - TABLE 508.4	NO SEPARATION REQUIRED
FLOOR CONSTRUCTION	NA
ROOF CONSTRUCTION	NA
STAIR ENCLOSURES	NA
EXIT ACCESS TRAVEL DISTANCE - TABLE 1011.2	200' (NO SPRINKLER SYSTEM)
COMMON PATH OF TRAVEL - SEE NFPA 101-2009 TABLE A14	50' (NO SPRINKLER SYSTEM)
MINIMUM NUMBER OF EXITS - TABLE 1004.3	2
ACCESSORY USE	NA
FIRE EXTINGUISHERS - TABLE 904.3(1)	2-A, 1 AT EACH EXIT
GENERAL NOTES	

STREET FRONTAGE INCREASE 504.3.3  
AREA INCREASE = (50/40-0.25) 30/30  
AREA INCREASE = 0.10 OR 850 S.F.

NFPA 101: CODE DATA - 2009 EDITION

OCCUPANT LOAD - TABLE 13.1.2	1/1 IND. 1483/100=11 B 1514/100=20
USE GROUP CLASSIFICATION - TABLE 401.4(1), 308.1.4	GENERAL INDUSTRIAL, BUSINESS
TYPE OF CONSTRUCTION - TABLE 8.1	V-1000
ACTUAL BUILDING AREA	4,000 S.F.
BUILDING HEIGHT	24'-0" 1 STORY
FIRE SUPPRESSION - 40.3.5, 38.3.5	NOT REQUIRED
FIRE RESISTANT CONSTRUCTION:	
STRUCTURAL FRAME	NA
EXTERIOR BEARING WALLS	NA
INTERIOR BEARING WALLS	NA
EXTERIOR NONBEARING WALLS	NA
FIRE WALLS & PARTY WALLS - 414.3.2 MIXED USE	NO SEPARATION REQUIRED
FLOOR CONSTRUCTION	NA
ROOF CONSTRUCTION	NA
STAIR ENCLOSURES	NA
EXIT ACCESS TRAVEL DISTANCE - TABLE 402.4	200' (NO SPRINKLER SYSTEM)
COMMON PATH OF TRAVEL - TABLE 40.2.5	50' (NO SPRINKLER SYSTEM)
MINIMUM NUMBER OF EXITS - 402.4(1)	2
ACCESSORY USE	NA
FIRE EXTINGUISHERS	2-A, 1 AT EACH EXIT
GENERAL NOTES	

NFPA 1: CODE DATA - 2009 EDITION

OCCUPANT LOAD - TABLE 14.8.1.2	1/1 IND. 1483/100=11 B 1514/100=20
USE GROUP CLASSIFICATION - SECTION 412.4.1	GENERAL INDUSTRIAL, BUSINESS
TYPE OF CONSTRUCTION - TABLE A12.2	V-1000
ACTUAL BUILDING AREA	4,000 S.F.
BUILDING HEIGHT	24'-0" 1 STORY
FIRE SUPPRESSION:	NOT REQUIRED
FIRE WALLS & PARTY WALLS	NA
COMMON PATH OF TRAVEL 1410.11.4	50' (NO SPRINKLER SYSTEM)
MINIMUM NUMBER OF EXITS - 14.9.1	2
FIRE EXTINGUISHERS - TABLE 13.6.2.1	2-A, 1 AT EACH EXIT
GENERAL NOTES	

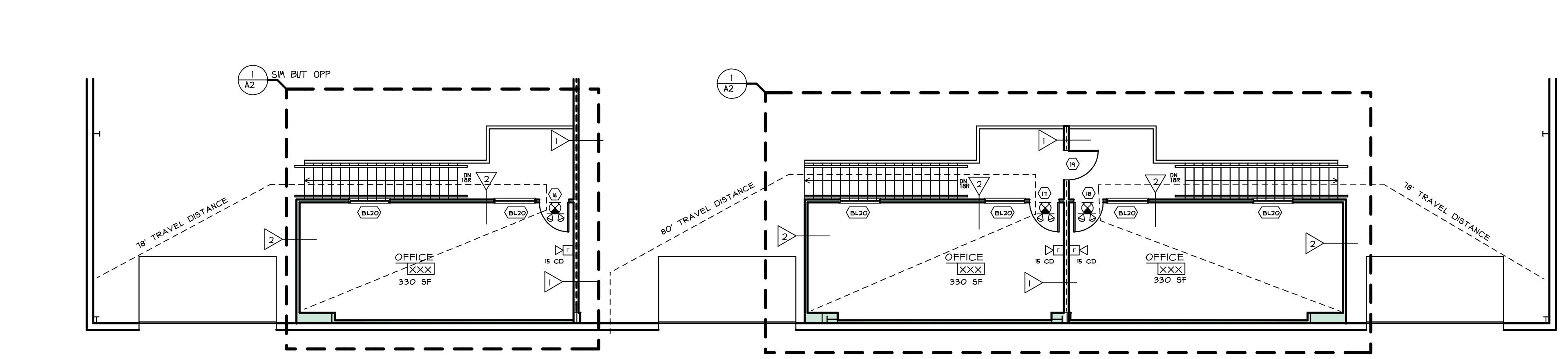
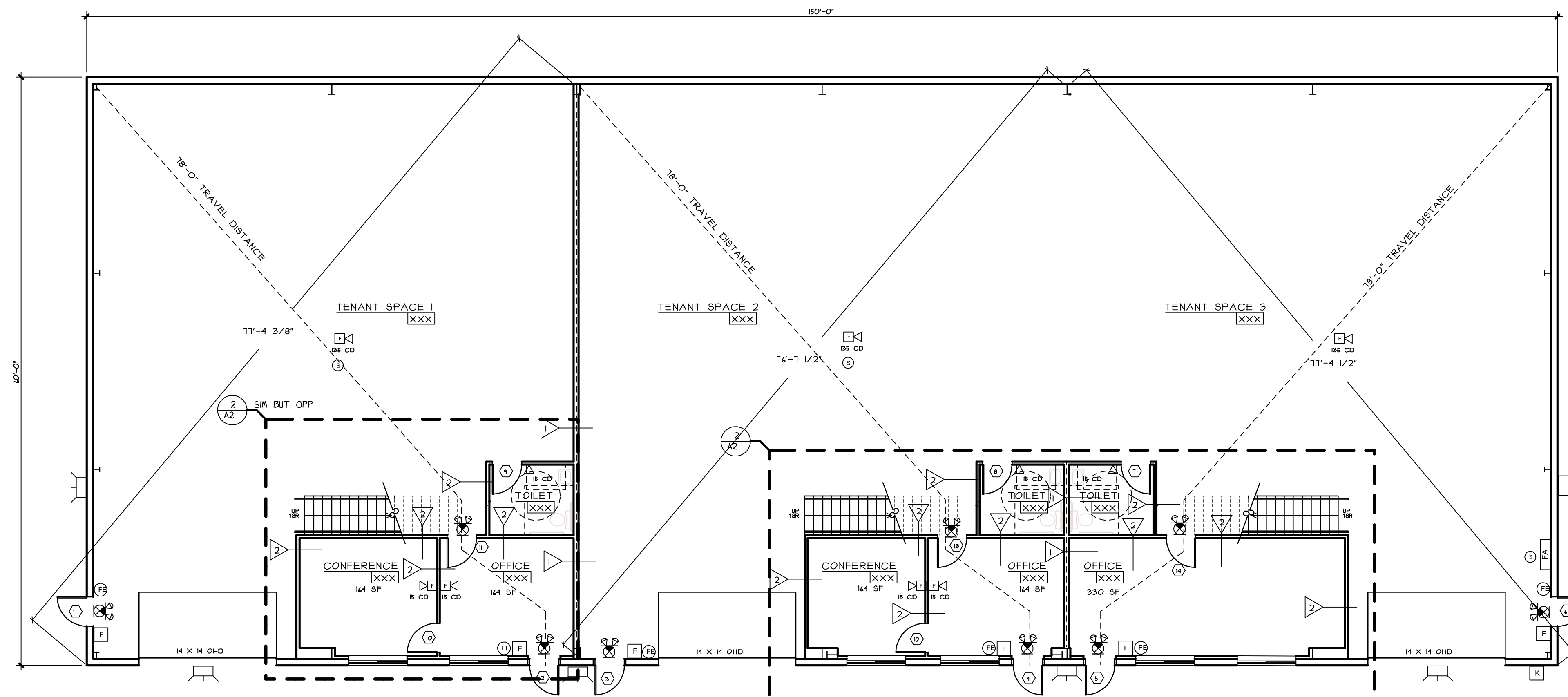
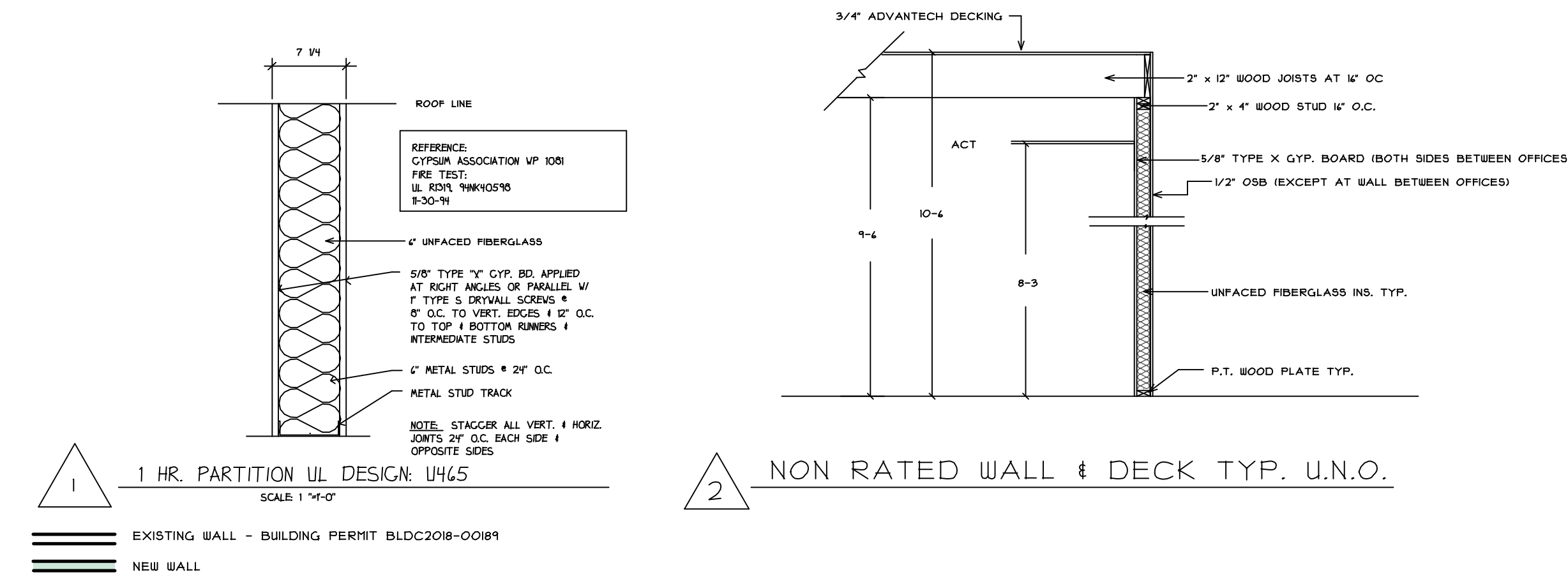

- [F] MANUAL PULL STATION
- [FH] ADA HORN/STROBE
- [FAS] ADA STROBE ONLY
- [FA] ALARM PANEL
- [S] SMOKE DETECTOR
- [ES] EXIT SIGN
- [ELP] EMERGENCY LIGHT PACK
- [K] KNOX BOX
- [FE] FIRE EXTINGUISHER

**WAREHOUSE**  
320 PRESUMPCOT STREET  
PORTLAND, MAINE



93 Pitt Street  
Portland, ME 04103  
207.747-5975 voice  
207.824.7237 voice/fax  
info@smithreuter.com

LIFE SAFETY FLOOR PLANS

295-1

1/10/19

**A1**

FIRST FLOOR PLAN  
1/8" = 1'-0"

SECOND FLOOR PLAN  
1/8" = 1'-0"

