

**PATCO**  
CONSTRUCTION INC

1293 MAIN STREET  
SANFORD, ME 04073  
TEL: (207)324-5574  
FAX: (207)324-1643  
www.patco.com  
or www.patcocommercial.com

**John W. Einsiedler, R.A.**  
Architecture  
148 Sea Road Kennebunk, Maine 04043  
Phone: 207-965-9160 Facsimile: 207-965-9118  
www.jweinsiedler.com

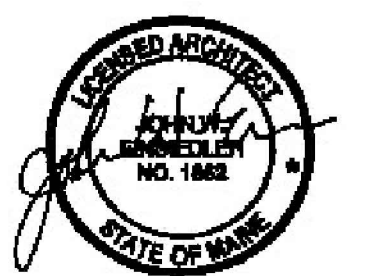

| REV. | DESCRIPTION | DATE | BY |
|------|-------------|------|----|
|      |             |      |    |
|      |             |      |    |
|      |             |      |    |
|      |             |      |    |
|      |             |      |    |
|      |             |      |    |
|      |             |      |    |
|      |             |      |    |
|      |             |      |    |

PROPOSED BUILDING FOR:  
**PACK EDGE**  
352 PRESUMPCOTT STREET  
PORTLAND, ME  
**FLOOR PLAN**

|             |          |
|-------------|----------|
| DATE:       | 3-28-13  |
| SCALE:      | AS SHOWN |
| DRAWN BY:   | RMA/JDB  |
| CHECKED BY: |          |
| JOB NUMBER: |          |
| SHEET:      |          |

A-1

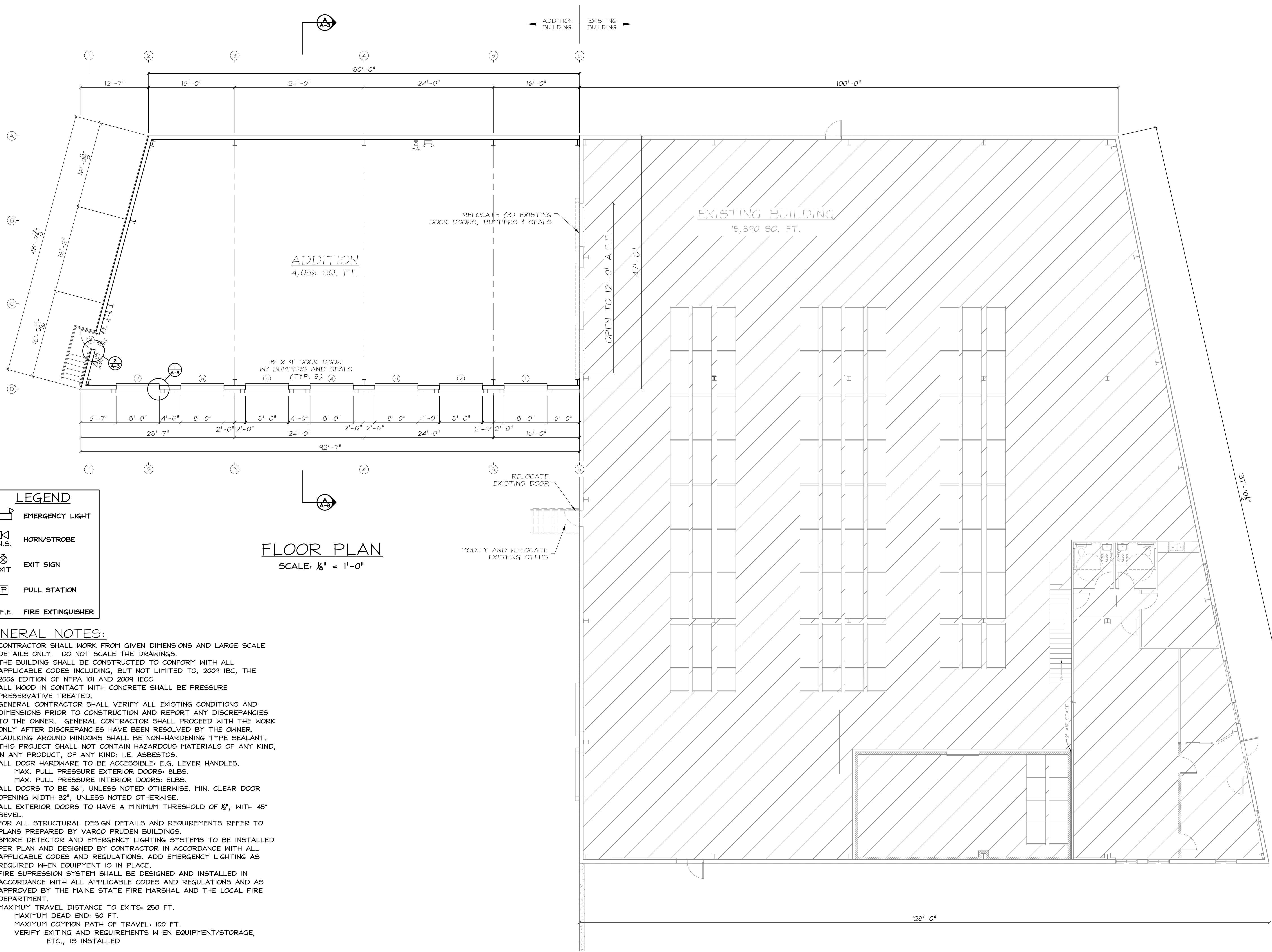

**LEGEND**

|  |                   |
|--|-------------------|
|  | EMERGENCY LIGHT   |
|  | HORN/STROBE       |
|  | EXIT SIGN         |
|  | PULL STATION      |
|  | FIRE EXTINGUISHER |

**FLOOR PLAN**  
SCALE: 1/8" = 1'-0"

**GENERAL NOTES:**

- CONTRACTOR SHALL WORK FROM GIVEN DIMENSIONS AND LARGE SCALE DETAILS ONLY. DO NOT SCALE THE DRAWINGS.
- THE BUILDING SHALL BE CONSTRUCTED TO CONFORM WITH ALL APPLICABLE CODES INCLUDING, BUT NOT LIMITED TO, 2009 IBC, THE 2006 EDITION OF NFPA 101 AND 2009 IECC
- ALL WOOD IN CONTACT WITH CONCRETE SHALL BE PRESSURE PRESERVATIVE TREATED.
- GENERAL CONTRACTOR SHALL VERIFY ALL EXISTING CONDITIONS AND DIMENSIONS PRIOR TO CONSTRUCTION AND REPORT ANY DISCREPANCIES TO THE OWNER. GENERAL CONTRACTOR SHALL PROCEED WITH THE WORK ONLY AFTER DISCREPANCIES HAVE BEEN RESOLVED BY THE OWNER.
- CAULKING AROUND WINDOWS SHALL BE NON-HARDENING TYPE SEALANT.
- THIS PROJECT SHALL NOT CONTAIN HAZARDOUS MATERIALS OF ANY KIND, IN ANY PRODUCT, OF ANY KIND: I.E. ASBESTOS.
- ALL DOOR HARDWARE TO BE ACCESSIBLE: E.G. LEVER HANDLES.  
MAX. PULL PRESSURE EXTERIOR DOORS: 8LBS.  
MAX. PULL PRESSURE INTERIOR DOORS: 5LBS.
- ALL DOORS TO BE 36", UNLESS NOTED OTHERWISE. MIN. CLEAR DOOR OPENING WIDTH 32", UNLESS NOTED OTHERWISE.
- ALL EXTERIOR DOORS TO HAVE A MINIMUM THRESHOLD OF 1/2", WITH 45° BEVEL.
- FOR ALL STRUCTURAL DESIGN DETAILS AND REQUIREMENTS REFER TO PLANS PREPARED BY VARCO PRUDEN BUILDINGS.
- SMOKE DETECTOR AND EMERGENCY LIGHTING SYSTEMS TO BE INSTALLED PER PLAN AND DESIGNED BY CONTRACTOR IN ACCORDANCE WITH ALL APPLICABLE CODES AND REGULATIONS. ADD EMERGENCY LIGHTING AS REQUIRED WHEN EQUIPMENT IS IN PLACE.
- FIRE SUPPRESSION SYSTEM SHALL BE DESIGNED AND INSTALLED IN ACCORDANCE WITH ALL APPLICABLE CODES AND REGULATIONS AND AS APPROVED BY THE MAINE STATE FIRE MARSHAL AND THE LOCAL FIRE DEPARTMENT.
- MAXIMUM TRAVEL DISTANCE TO EXITS: 250 FT.  
MAXIMUM DEAD END: 50 FT.  
MAXIMUM COMMON PATH OF TRAVEL: 100 FT.  
VERIFY EXITING AND REQUIREMENTS WHEN EQUIPMENT/STORAGE, ETC., IS INSTALLED