

### DOOR AND FRAME SCHEDULE

DOOR #	DOOR			MAT'L	ELEV	GLAZ	FRAME		HARDWARE SET	REMARKS
	WIDTH	HEIGHT	THICK				MAT'L	ELEV		
103	3'-0"	7'-0"	0'-1 3/4"	-	SF	TEMPERED	HM	SF-1	2	THIS STOREFRONT SYSTEM IS RELOCATED FROM ITS EXISTING LOCATION
104	3'-0"	7'-0"	0'-1 3/4"	WD	HG	TEMPERED	HM	F1	1	
105	3'-0"	7'-0"	0'-1 3/4"	WD	HG	TEMPERED	HM	F1	1	
107	3'-0"	7'-0"	0'-1 3/4"	WD	F	-	HM	F1	4	
110	6'-1"	6'-8 1/4"	-	-	SF	TEMPERED INSULATED	HM	SF-2	5	COORDINATE HARDWARE REQUIRED FOR SECURITY SYSTEM (IF ANY) WITH OWNER
111	3'-0"	7'-0"	0'-2"	HM	F	-	HM	F1	3	COORDINATE HARDWARE REQUIRED FOR SECURITY SYSTEM (IF ANY) WITH OWNER

**HARDWARE SCHEDULE:**

- HW-1: HINGES, LATCHSET (PASSAGE), CLOSER, KICKPLATE, DOORSTOP.
- HW-2: HINGES, LOCKSET (OFFICE), DOORSTOP.
- HW-3: HINGES, LOCKET (PASSAGE), CLOSER, KICKPLATE, EXIT DEVICE, THRESHOLD, GASKETING.
- HW-4: HARDWARE REMOVED FROM EXISTING DOOR TO BE REUSED.
- HW-5: PROVIDED BY ALUMINUM DOOR MANUFACTURER (FUNCTION TO MATCH HW-3)

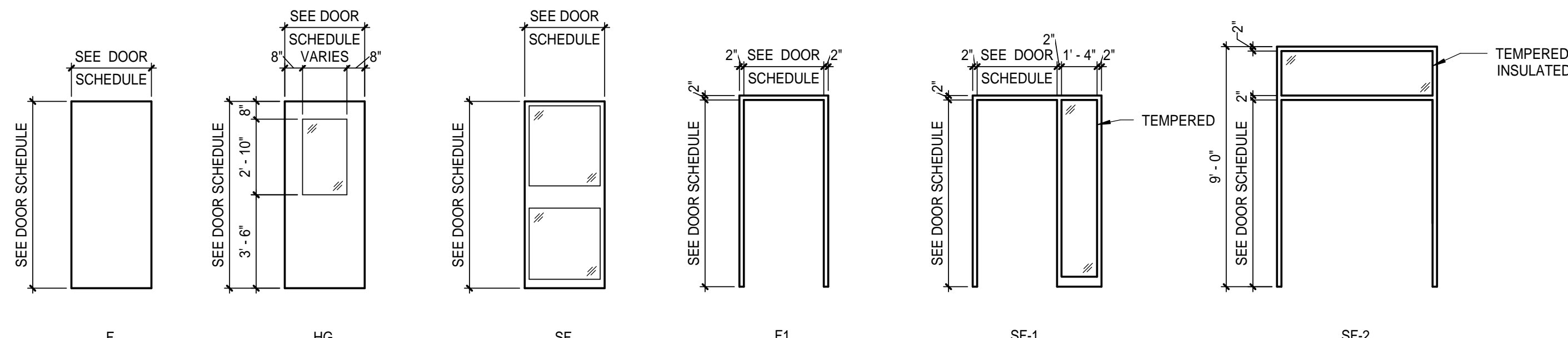

**H4 DOOR LEAF TYPES**  
1/4" = 1'-0"

**H8 DOOR FRAME TYPE**  
1/4" = 1'-0"

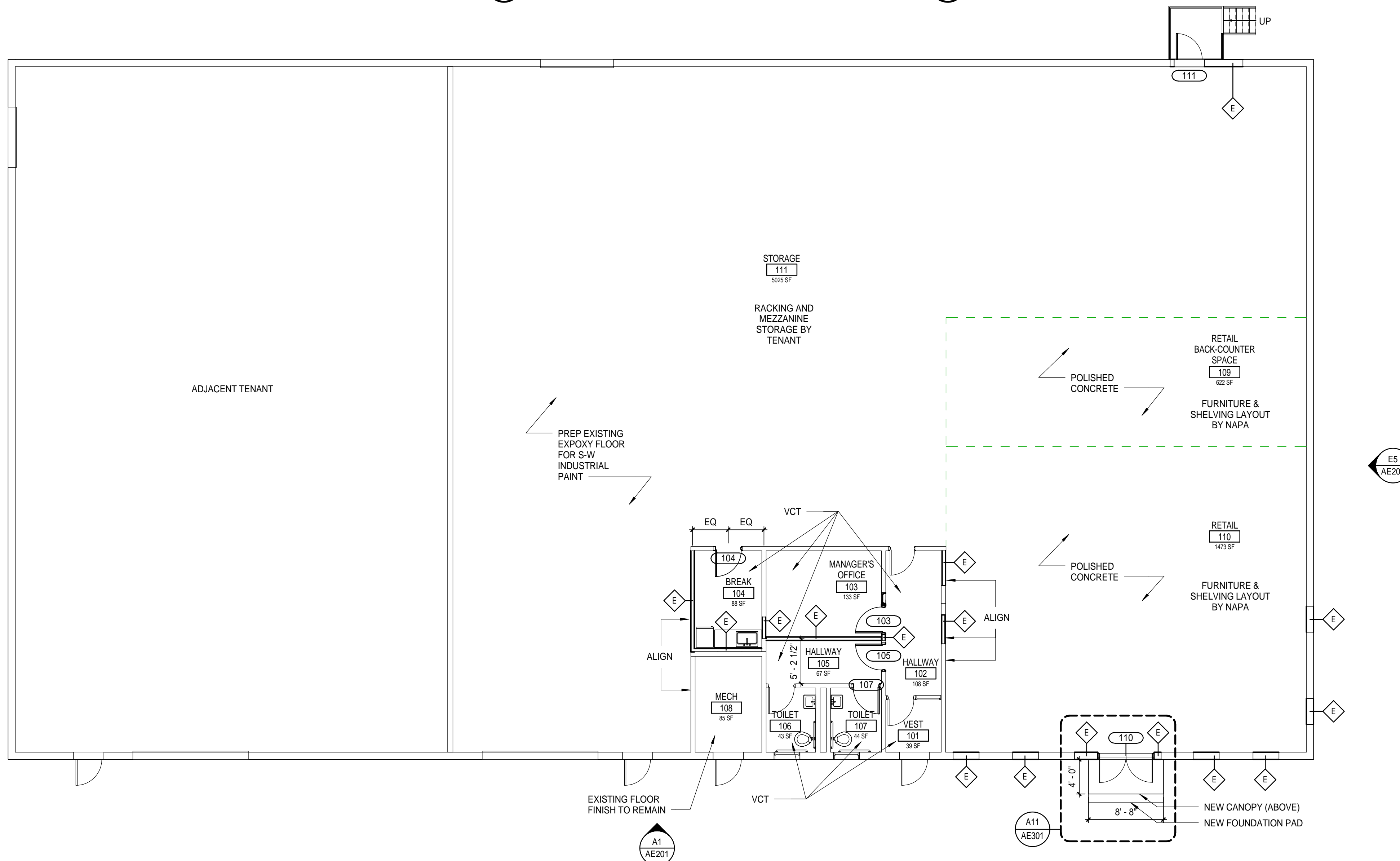

**A1 FIRST FLOOR**  
1/8" = 1'-0"

**PLAN NOTES:**

1. SEE G-001 FOR GENERAL PROJECT NOTES, LEGENDS AND ABBREVIATIONS.
2. CONTRACTOR IS RESPONSIBLE FOR REVIEWING CODE COMPLIANCE PLANS AND NOTIFYING THE ARCHITECT OF CONFLICTS BETWEEN WHAT IS IN THE FIELD AND ON THE CODE DOCUMENTS.
3. DIMENSIONS ARE FACE OF CONCRETE, FACE OF MASONRY AND CENTERLINE OF STUD, UNLESS NOTED OTHERWISE.
4. DOOR JAMBS (HINGE SIDE) SHALL BE 6" FROM CORNER IN STUD PARTITIONS AND 8" FROM CORNER IN MASONRY PARTITIONS UNLESS NOTED OTHERWISE.
5. REFER TO DETAILS FOR ADDITIONAL DIMENSIONING INFORMATION.
6. REFER TO ENLARGED PLANS FOR PARTITION TYPES AND DIMENSIONS IN AREAS WHICH ARE DETAILED AT A LARGER SCALE.
7. FURNITURE AND OWNER PROVIDED EQUIPMENT ARE INDICATED BY DASHED LINE TYPE.
8. CONTRACTOR IS RESPONSIBLE FOR THE COORDINATION OF OWNER PROVIDED EQUIPMENT INCLUDING BUT NOT LIMITED TO DIMENSIONAL INFORMATION, AND MECHANICAL, ELECTRICAL AND PLUMBING REQUIREMENTS.

**PLAN KEY NOTES:**

1. ....

144 Fox Street P.O. Box 618  
Portland, Maine 04104  
tel. (207) 772-3846  
fax. (207) 772-1070  
www.smrtinc.com

ARCHITECTURE  
ENGINEERING  
PLANNING  
INTERIORS  
ENERGY

**SMRT**

LICENSED ARCHITECT  
Andrew R. Wyner  
August 2, 2016  
15747  
STATE OF MAINE

**NAPA AUTOPARTS TENANT FIT-UP**

235 PRESUMPSCOT ST. PORTLAND, MAINE

**PERMIT SET**  
4-12-16

CURRENT ISSUE STATUS:

REV	DESCRIPTION	DATE

GRAPHIC SCALE:  
0' 1'

SCALE: As indicated  
PROJECT MANAGER: JLH  
JC/DRAWN BY: SHK  
A/E OF RECORD: JLH  
PROJECT NO: 15105  
SMRT FILE: AE101-15105  
DATE:  
SHEET TITLE:  
**FLOOR PLAN & DOOR SCHEDULE**  
SHEET No.  
**AE101**  
©COPYRIGHT 2014 SMRT INC