

**J1** CODE COMPLIANCE PLAN - FIRST FLOOR  
1/16" = 1'-0"

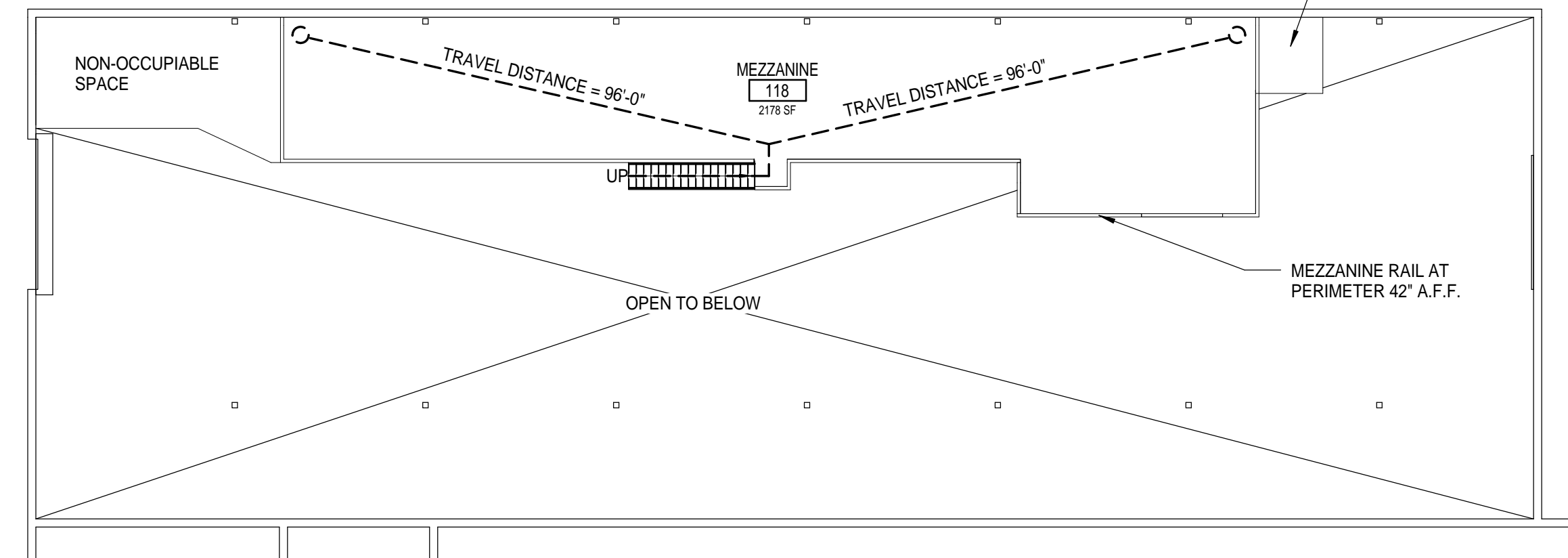

**J7** CODE COMPLIANCE PLAN - MEZZANINE  
1/16" = 1'-0"

**LIFE SAFETY LEGEND**

- EXIT DISCHARGE
- STANDPIPE OR HOSE VALVE CABINET
- TRAVEL DISTANCE
- FIRE EXTINGUISHER CABINET
- FIRE EXTINGUISHER WALL HUNG
- EGRESS DOOR
- FIRE ALARM VISIBLE ONLY NOTIFICATION INDICATOR
- FIRE ALARM AUDIBLE/VISIBLE NOTIFICATION INDICATOR
- EXIT SIGN

**CODE REVIEW SUMMARY**

|   |  |
|---|--|
| <p><b>PROJECT DESCRIPTION:</b></p> <p><b>FIRE:</b></p> <p><b>BUILDING:</b></p> <p><b>ACCESSIBILITY:</b></p> <p><b>PLUMBING:</b></p> <p><b>ELECTRICAL:</b></p> <p><b>USE GROUP CLASSIFICATION(S) IBC:</b></p> <p><b>USE GROUP CLASSIFICATION(S) NFPA:</b></p> <p><b>OCCUPANT LOAD:</b></p> <p><b>MEZZANINES</b></p> <p><b>SPECIFIC OCCUPANCY AREAS/HAZARDOUS AREA PROTECTION:</b></p> <p><b>TYPE OF CONSTRUCTION (EXISTING):</b></p> <p><b>TABLE 503 HEIGHT/AREA LIMITATIONS</b></p> <p><b>MINIMUM NUMBER OF EXITS REQUIRED PER FLOOR LEVEL:</b></p> <p><b>PER ROOM WITH &gt;50 OCCUPANTS:</b></p> <p><b>EGRESS CAPACITY:</b></p> <p><b>EXIT ACCESS CORRIDOR WIDTH:</b></p> <p><b>DOOR WIDTH</b></p> <p><b>ARRANGEMENT:</b></p> <p><b>DEAD-END-CORRIDOR</b></p> <p><b>COMMON PATH OF TRAVEL</b></p> <p><b>TRAVEL DISTANCE TO EXIT</b></p> <p><b>EMERGENCY LIGHTING:</b></p> <p><b>EXIT SIGNAGE:</b></p> <p><b>INTERIOR FINISH:</b></p> <p><b>WALL AND CEILING FINISHES:</b></p> <p><b>VERTICAL EXITS &amp; PASSAGEWAYS:</b></p> <p><b>EXIT ACCESS CORRIDORS:</b></p> <p><b>ROOMS &amp; ENCLOSED SPACES:</b></p> <p><b>FLOOR FINISHES:</b></p> <p><b>DETECTION, ALARM, AND COMMUNICATIONS SYSTEMS:</b></p> <p><b>OCCUPANT:</b></p> <p><b>EXTINGUISHMENT REQUIREMENTS:</b></p> <p><b>AUTOMATIC FIRE SUPPRESSION:</b></p> <p><b>PORTABLE FIRE EXTINGUISHERS:</b></p> <p><b>CORRIDORS:</b></p> | <p>RENOVATIONS OF AN EXISTING STORAGE SPACE TO INCORPORATE OFFICE USE. WORK INCLUDES NEW PARTITIONS, DOORS, PLUMBING FIXTURES, AND A MEZZANINE FOR LIGHT STORAGE.</p> <p>NFPA INCLUDING 101 LIFE SAFETY CODE, 2009 EDITION<br/>INTERNATIONAL BUILDING CODE, 2009 EDITION<br/>ADA, ACCESSIBILITY GUIDELINES FOR BUILDINGS AND FACILITIES.<br/>MAINE STATE PLUMBING CODE, 2009 EDITION<br/>NATIONAL ELECTRICAL CODE, 2014 EDITION</p> <p>MIXED USE / NON-SEPARATED: GROUP B AND MODERATE HAZARD STORAGE GROUP S-1 (PER TABLE 508.4: NO SEPARATION REQUIRED)<br/>GROUP BUSINESS</p> <p>TABLE 1004.1.1<br/>OFFICE: 2512 SF / 100 SF PER OCCUPANT = 25 OCCUPANTS<br/>STORAGE: 8,526 SF / 300 SF PER OCCUPANT = 28 OCCUPANTS<br/>MEZZANINE: UNOCCUPIED<br/>TOTAL OCCUPANT LOAD: 53</p> <p>SECTION 505<br/>ALLOWABLE MEZZANINE OPEN AREA: 8526 SF / (1/3) = 2,842 SF ALLOWABLE<br/>ACTUAL MEZZANINE OPEN AREA: 2,178 SF</p> <p>IBC CHAPTER 3, TABLE 302.1.1<br/>NFPA 101 CHAPTER 38</p> <p>IBC: CHAPTER 6, TABLE 601: NON-COMBUSTABLE - TYPE IIIB</p> <p>TYPE OF CONSTRUCTION IIIB<br/>GROUP B - 19,000 SF AND 3 STORIES - ACTUAL BUILDING IS 11,038 SF<br/>NEW INTERIOR CONSTRUCTION IS WOOD FRAMED WITH BEARING WALLS TO SUPPORT STORAGE MEZZANINE</p> <p>2 (ACTUAL NUMBER OF EXITS: 3)<br/>2</p> <p>MINIMUM ALLOWABLE<br/>44 IN. CLEAR<br/>32 IN. CLEAR</p> <p>MAXIMUM ALLOWABLE<br/>50 FT.<br/>100 FT.<br/>300 FT.</p> <p>EXISTING BATTERY BACK-UP FIXTURES WILL BE RELOCATED AND SUPPLEMENTED AS NECESSARY TO PROVIDE MINIMUM LIGHT LEVELS REQUIRED BY NFPA 101/7.9.2.</p> <p>INTERNALLY ILLUMINATED EXIT SIGNS WITH BATTERY BACK-UP WILL BE RELOCATED AND SUPPLEMENTED AS NECESSARY IN RESPONSE TO THE REQUIREMENTS OF NFPA 101/7.10.</p> <p>IBC - CHAPTER 8, NFPA 101 - CHAPTERS 10 &amp; 19<br/>(IBC TABLE 803.5)<br/>NOT APPLICABLE<br/>CLASS A, B OR C<br/>CLASS A, B OR C<br/>NO REQUIREMENTS</p> <p>EXISTING ZONED FIRE ALARM SYSTEM.</p> <p>NOTIFICATION DEVICES CONFORMING WITH NFPA 9.6 WILL BE RELOCATED AND/OR SUPPLEMENTED AS REQUIRED BY THE PARTITION LAYOUT.</p> <p>EXISTING WATER BASED SPRINKLER SYSTEM WILL HAVE HEAD LOCATIONS MODIFIED AS REQUIRED BY THE PARTITION LAYOUT.<br/>SPRINKLER SYSTEM MEETS REQUIREMENTS OF NFPA 13.<br/>EXISTING PORTABLE FIRE EXTINGUISHERS WILL REMAIN.</p> <p>NO REQUIREMENTS.</p> |
|---|--|

144 Fox Street P.O. Box 618  
Portland, Maine 04104  
tel: (207) 772-3846  
fax: (207) 772-1070  
www.smrtnic.com

ARCHITECTURE  
ENGINEERING  
PLANNING  
INTERIORS  
ENERGY

**SMRTI**



**B.H. MILLIKEN TENANT FIT-UP**  
235 PRESUMPSCOT STREET, PORTLAND, ME

**REVISED**  
**5-27-16**

CURRENT ISSUE STATUS:

| REV | DESCRIPTION | DATE    |
|-----|-------------|---------|
| 1   | REVISED     | 5-27-16 |
| 0   | PERMIT SET  | 4-1-16  |

GRAPHIC SCALE:  
0" 1"

SCALE: As indicated  
PROJECT MANAGER: J.L.H.  
JC/DRAWN BY: SHK  
A/E OF RECORD: J.L.H.  
PROJECT NO: 16030  
SMRT FILE: A-001-16030  
DATE:  
SHEET TITLE:  
**CODE COMPLIANCE PLAN**  
SHEET No.  
**A-001**