

J1 CODE COMPLIANCE PLAN - FIRST FLOOR
1/16" = 1'-0"

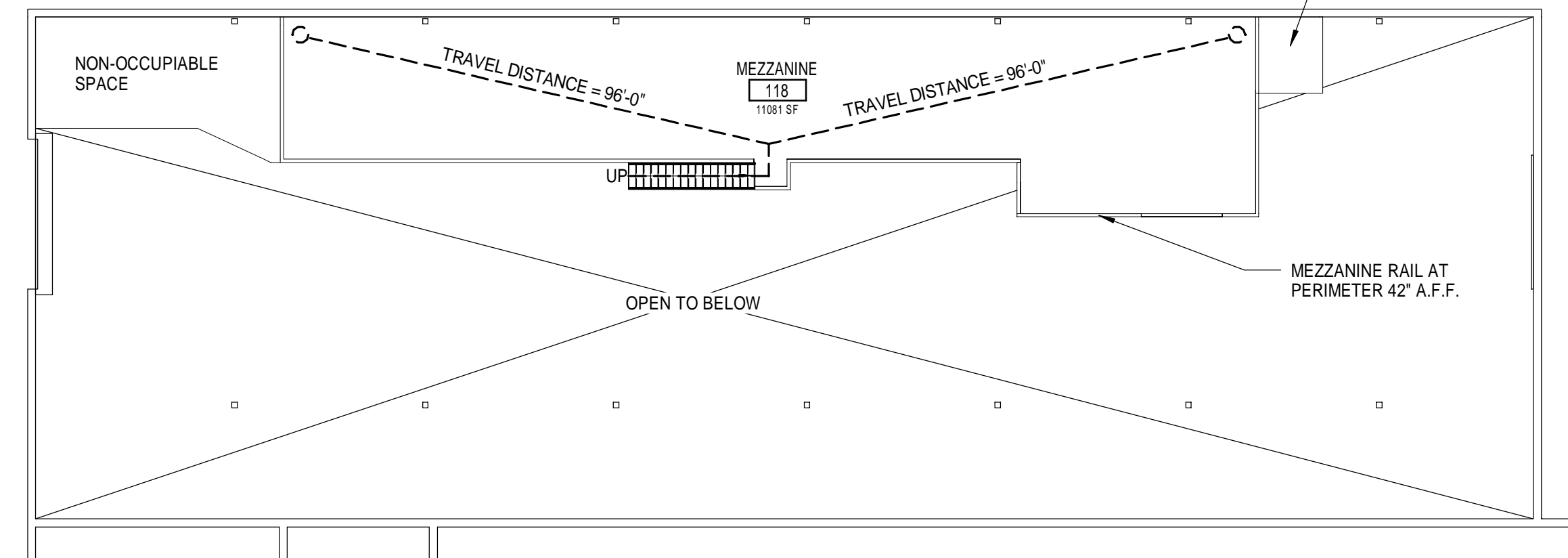

J7 CODE COMPLIANCE PLAN - MEZZANINE
1/16" = 1'-0"

CODE REVIEW SUMMARY

PROJECT DESCRIPTION:	RENOVATIONS OF AN EXISTING STORAGE SPACE TO INCORPORATE OFFICE USE. WORK INCLUDES NEW PARTITIONS, DOORS, PLUMBING FIXTURES, AND A MEZZANINE FOR LIGHT STORAGE.
FIRE:	NFPA INCLUDING 101 LIFE SAFETY CODE, 2009 EDITION
BUILDING:	INTERNATIONAL BUILDING CODE, 2009 EDITION
ACCESSIBILITY:	ADA, ACCESSIBILITY GUIDELINES FOR BUILDINGS AND FACILITIES.
PLUMBING:	MAINE STATE PLUMBING CODE, 2009 EDITION
ELECTRICAL:	NATIONAL ELECTRICAL CODE, 2014 EDITION
USE GROUP CLASSIFICATION(S) IBC:	GROUP B
USE GROUP CLASSIFICATION(S) NFPA:	GROUP BUSINESS
SPECIFIC OCCUPANCY AREAS/HAZARDOUS AREA PROTECTION:	IBC CHAPTER 3, TABLE 302.1.1 NFPA 101 CHAPTER 38
TYPE OF CONSTRUCTION (EXISTING):	IBC: CHAPTER 6, TABLE 601: NON-COMBUSTIBLE - TYPE IIB
TYPE OF CONSTRUCTION (NEW):	IBC: CHAPTER 6, TABLE 601: TYPE VA
HEIGHT/AREA LIMITATIONS:	IBC: TABLE 503: BUSINESS OCCUPANCY / TYPE VA = 18,000 S.F. ACTUAL SF: 2,500 S.F.
MINIMUM NUMBER OF EXITS REQUIRED PER FLOOR LEVEL:	2
PER ROOM WITH >50 OCCUPANTS:	2
EGRESS CAPACITY:	MINIMUM ALLOWABLE
EXIT ACCESS CORRIDOR WIDTH:	44 IN. CLEAR
DOOR WIDTH:	32 IN. CLEAR
ARRANGEMENT:	MAXIMUM ALLOWABLE
DEAD-END-CORRIDOR:	50 FT.
COMMON PATH OF TRAVEL:	100 FT.
TRAVEL DISTANCE TO EXIT:	300 FT.
EMERGENCY LIGHTING:	EXISTING BATTERY BACK-UP FIXTURES WILL BE RELOCATED AND SUPPLEMENTED AS NECESSARY TO PROVIDE MINIMUM LIGHT LEVELS REQUIRED BY NFPA 101/7.9.2.
EXIT SIGNAGE:	INTERNALLY ILLUMINATED EXIT SIGNS WITH BATTERY BACK-UP WILL BE RELOCATED AND SUPPLEMENTED AS NECESSARY IN RESPONSE TO THE REQUIREMENTS OF NFPA 101/7.10.
INTERIOR FINISH:	IBC - CHAPTER 8, NFPA 101 - CHAPTERS 10 & 19
WALL AND CEILING FINISHES:	(IBC TABLE 803.5)
VERTICAL EXITS & PASSAGEWAYS:	NOT APPLICABLE
EXIT ACCESS CORRIDORS:	CLASS A OR B
ROOMS & ENCLOSED SPACES:	CLASS A, B OR C
FLOOR FINISHES:	NO REQUIREMENTS
DETECTION, ALARM, AND COMMUNICATIONS SYSTEMS:	EXISTING ZONED FIRE ALARM SYSTEM.
OCCUPANT:	NOTIFICATION DEVICES CONFORMING WITH NFPA 9.6 WILL BE RELOCATED AND/OR SUPPLEMENTED AS REQUIRED BY THE PARTITION LAYOUT.
EXTINGUISHMENT REQUIREMENTS:	
AUTOMATIC FIRE SUPPRESSION:	EXISTING WATER BASED SPRINKLER SYSTEM WILL HAVE HEAD LOCATIONS MODIFIED AS REQUIRED BY THE PARTITION LAYOUT.
PORTABLE FIRE EXTINGUISHERS:	EXISTING PORTABLE FIRE EXTINGUISHERS WILL REMAIN.
CORRIDORS:	NO REQUIREMENTS.

LIFE SAFETY LEGEND

- EXIT DISCHARGE
- STANDPIPE OR HOSE VALVE CABINET
- TRAVEL DISTANCE
- FIRE EXTINGUISHER CABINET
- FIRE EXTINGUISHER WALL HUNG
- EGRESS DOOR
- FIRE ALARM VISIBLE ONLY NOTIFICATION INDICATOR
- FIRE ALARM AUDIBLE/VISIBLE NOTIFICATION INDICATOR
- EXIT SIGN

144 Fols Street, P.O. Box 818
Portland, Maine 04104
Tel: (207) 772-3846
Fax: (207) 772-1070
www.smrtnic.com

ARCHITECTURE
ENGINEERING
PLANNING
INTERIORS
ENERGY

SMRT

LICENSED ARCHITECT
JANEZ
DE
HANSEN
#1991
4-1-16

B.H. MILLIKEN TENANT FIT-UP
206 PRESUMPSCOT STREET, PORTLAND, ME

PERMIT SET
4-1-16

CURRENT ISSUE STATUS:

REV	DESCRIPTION	DATE

GRAPHIC SCALE:
0" 1"

SCALE: As indicated
PROJECT MANAGER: JLH
JC/DRAWN BY: SHK
A/E OF RECORD: JLH
PROJECT NO: 16030
SMRT FILE: A-001-16030
DATE:
SHEET TITLE:
CODE COMPLIANCE PLAN
SHEET No.
A-001

©COPYRIGHT 2014 SMRT INC