

**CITY OF PORTLAND
MODEL BLASTING PLAN
Removal of over 300 cubic yards of rock material**

The purpose of the Blasting Plan is to describe anticipated rock excavation requirements for the project, and outline proposed blasting operations, vibration control criteria, and monitoring/reporting protocols, and to protect surrounding properties from damage related to proposed blasting activities.

1. **Project:** Drilling & Blasting Services for extended parking
2. **Project Location:** 419 Presumpscot St
3. **Estimated Quantity (cubic yards in-ground measurement) of Rock to be Blasted:** 3000 +/-

4. **Project Description** Drilling & Blasting for parking lot extension
Describe the project for which blasting is required. Include lot size, building construction type, number of units, etc. Refer to site/grading plans. Specify anticipated depth of fills and cuts. See attached

4.95 acres, 2 buildings, commercial/warehouse

5. **Site and Subsurface Conditions**

Provide a detailed description of the site, including but not limited to existing conditions, elevations, terrain character, topography, soil conditions, groundwater depths, depth of bedrock, etc. See attached

6. **Surrounding Properties, Utilities and Wells**

Describe surrounding properties, specifying use and type of construction. Include a vicinity map with the outlines of existing structures located within a site radius equal to the minimum radius required for pre-blast condition surveys. There is a mixture of industrial/commercial & residential

Indicate the location of all utilities in the vicinity, including water, sewer, stormwater, and natural gas. Will be dug & capped

Indicate the location of drinking wells in a 2000ft radius of the property. N/A

7. **Anticipated Project Areas Requiring Blasting**

Indicate on a site plan the areas where blasting is expected to occur. Provide a narrative characterizing the blasting/excavation work, the estimated total number of cubic yards of material to be removed by blasting, and an estimate of the number of blasts required to remove the specified amount of material. 3000 yards +/- 50 blasts +/-

Include a proposed Bedrock Excavation Plan showing approximate bedrock excavation areas, variations in the depth of bedrock excavation requiring blasting, and areas where controlled perimeter blasting methods will be used (if any). See attached

Describe the distance of proposed blasting to the nearest structures and underground utilities.

Nearest structure is the owner's property approximately 50' away. Nearest neighbor is approximately 190' away south & north

Attachments:

- A. Site Plan
- B. Radius Plan
- C. Proposed Bedrock Excavation Plan
- D. Model Notification Letter
- E. Model Offer of Pre-Blast Survey Notice
Blasting Log
- F. Model Blast Monitoring Report

SeaBreeze

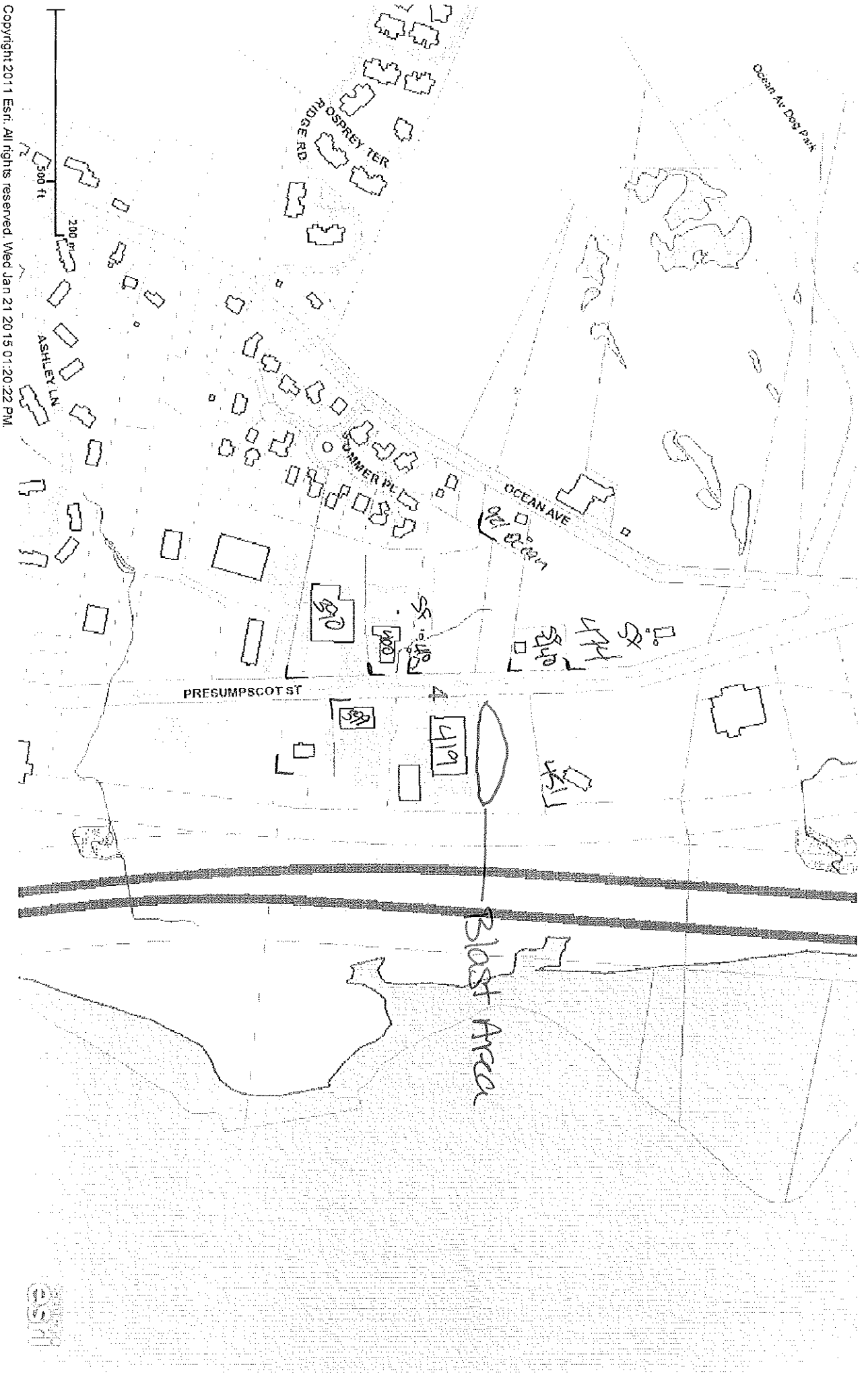

Copyright 2011 Esri. All rights reserved. Wed Jan 21 20:15:01:20:22 PM

ESRI

The following map should
be put together like this:

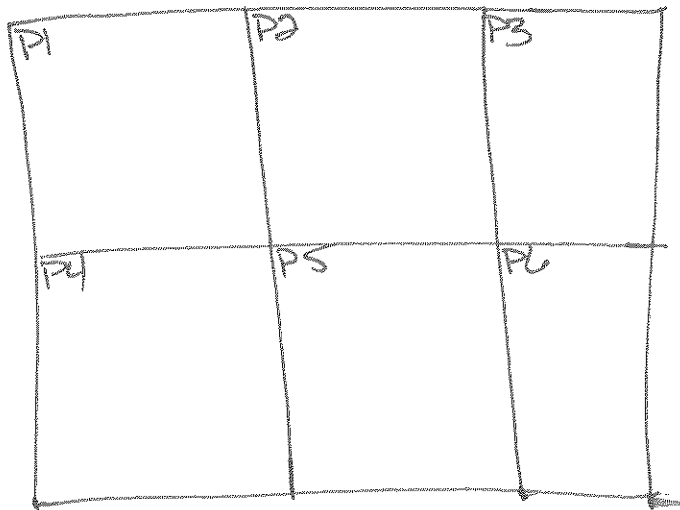

Sorry it's uneven, we don't have a large-scale copier.

P1

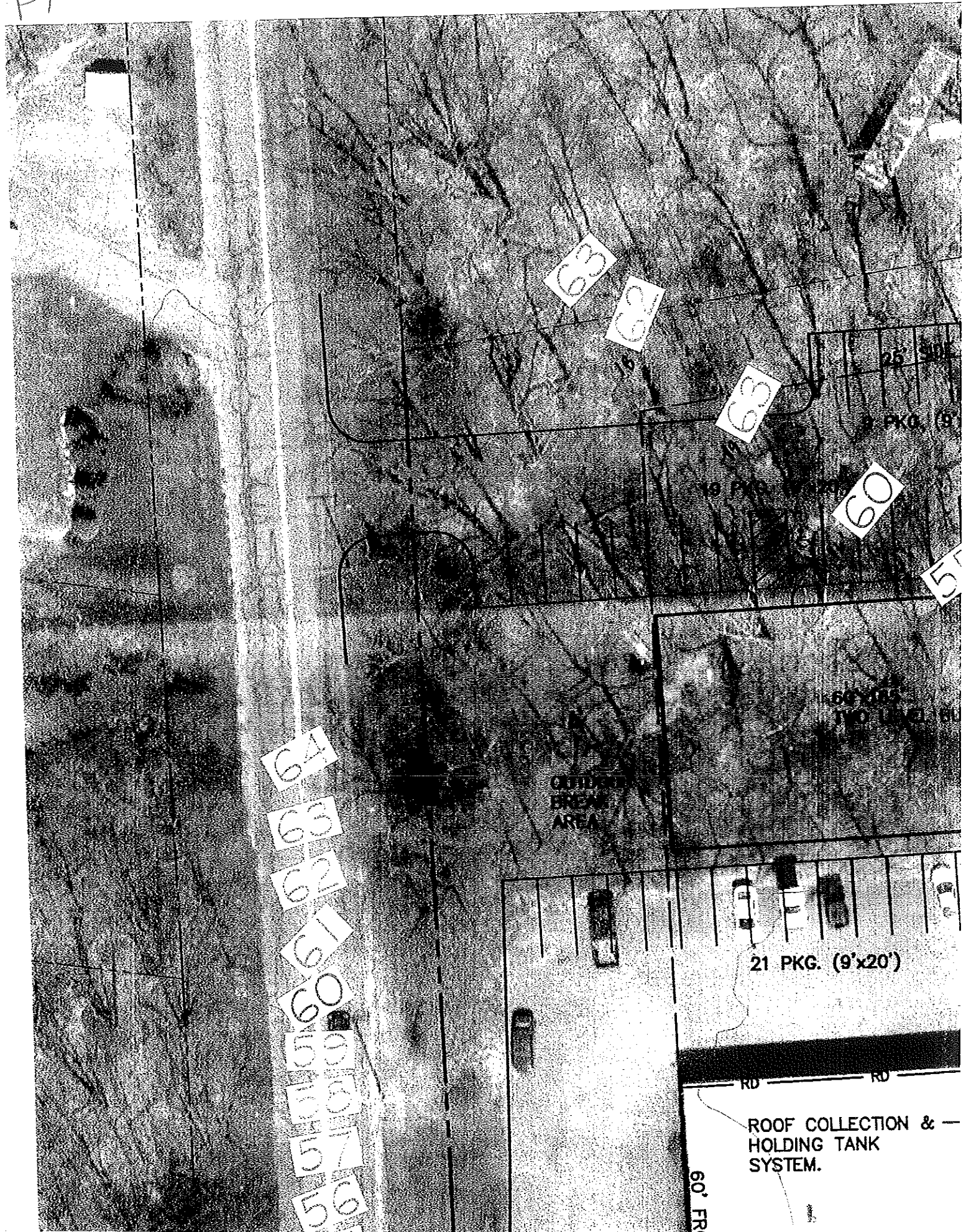

72

DE SETBACK

(9'x20')

EQUIPMENT STORAGE AND PARKING AREA

55

50

549

BUILDING

7 PKG. (10'x20')

S. 6-49

4'

47

46

35'

45

40

10 PKG. (10'x30') TRUCK & TRAILER

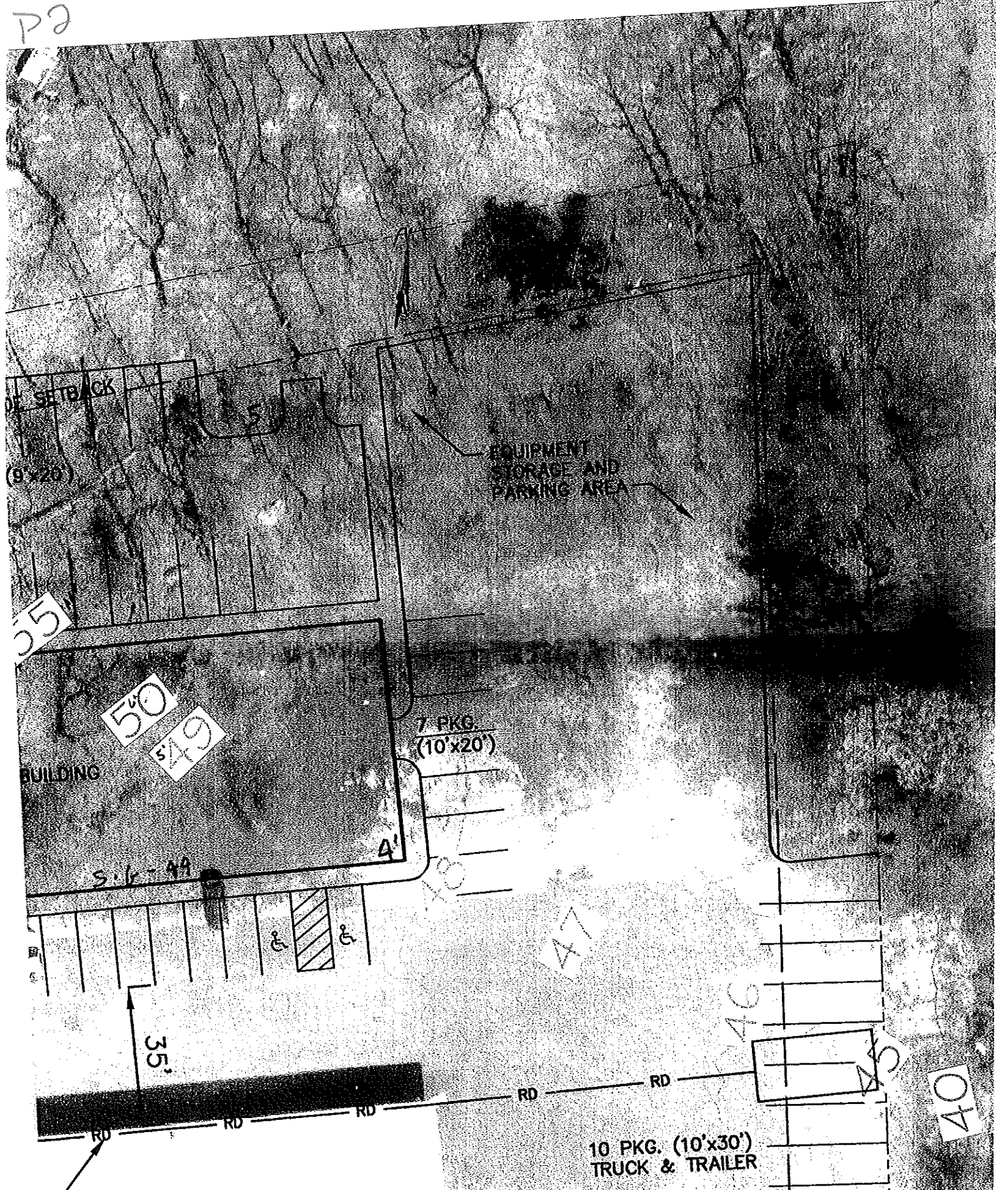

P3



40

38

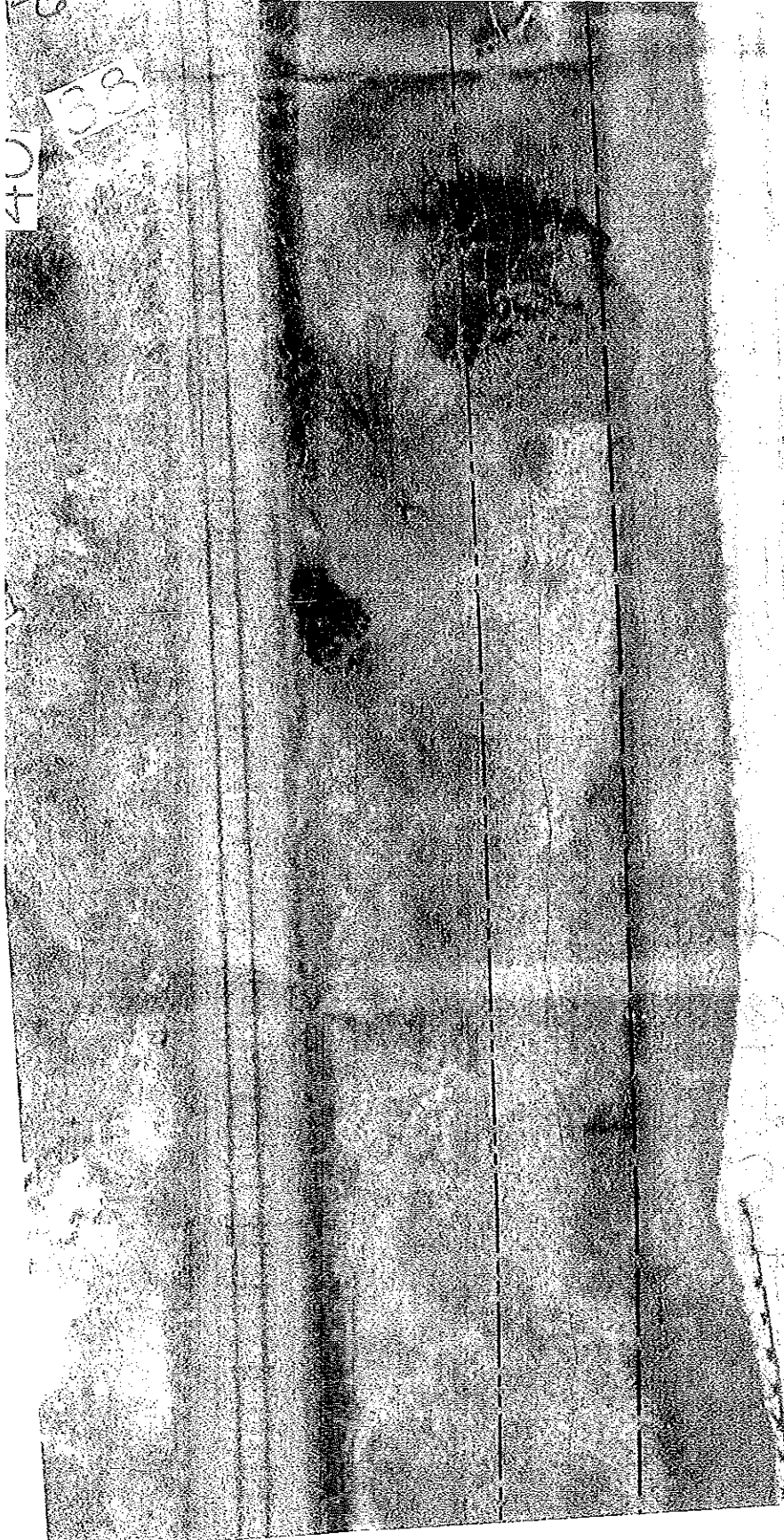

40
26
03



1" = 30'

SYTDesi
CONSULTANTS
CIVIL ENGINEERING & LANDSCAPE AR

CLIENT:

SEABRE

451 PRESUMPSCOT ST

Owner Information

REAL ESTATE HOLDINGS LLC
200 NARRAGANSETT ST
GORHAM ME 04038

399 PRESUMPSCOT ST

Owner Information

COUTURE JON RENE
399 PRESUMPSCOT ST
PORTLAND ME 04103

90 PRESUMPSCOT ST

Owner Information

MKC PROPERTIES INC
PO BOX 10841
PORTLAND ME 04104

400 PRESUMPSCOT ST

Owner Information

MECHANICAL SERVICES INC
400 PRESUMPSCOT ST
PORTLAND ME 04103

410 PRESUMPSCOT ST

Owner Information

BROWN MARGARET B
410 PRESUMPSCOT ST
PORTLAND ME 04103

Single Family

440 PRESUMPSCOT ST

Owner Information

HAMILTON WILLARD P
440 PRESUMPSCOT ST
PORTLAND ME 04103

Single Family

474 PRESUMPSCOT ST

Owner Information DEVITO ELLEN M & ANITA S DEVITO ETALS JTS
474 PRESUMPSCOT ST
PORTLAND ME 04103

Single Family

921 OCEAN AVE

Owner Information

DRAGON PRODUCTS COMPANY THE
34 ATLANTIC PL
SOUTH PORTLAND ME 04106

Single Family

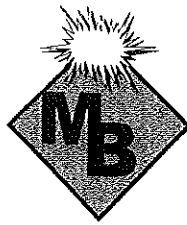

McGoldrick Bros.
BLASTING SERVICES, INC.

Date January 21, 2015

Dear Neighbor:

We are sending you this letter to inform you that we will be blasting ledge in preparation for the parking expansion project on 419 Presumpscot Street.

As required by City Ordinance, prior to any blasting, a pre-blast survey of all structures within 600 feet of the blast area shall be conducted to establish a base line against which any claims of damage caused by this blasting can be judged.

Your property is within the 600ft. radius. A pre-blast survey will be performed at no cost to you if you would like to have it done.

Pre-blast condition surveys for this project will be performed by **BECC Company**. Please call them at **207-846-9268**. A seismologist or a qualified technician working under the direction of a seismologist from **BECC Company** will then make a videotape of the interior and exterior condition of your residence. The pre-blast survey records will be kept in a locked file for a period of 6 years after the completion of blasting at which time they will be destroyed.

If you have any questions, please contact Tara at 207-892-5989

Thank you,

McGoldrick Bros. Blasting Services, Inc.

Date: January 21, 2015

Dear Neighbor:

We are sending you this letter to inform you that we will be blasting ledge in preparation for parking expansion at 419 Presumpscot Street, Portland.

As required by City Ordinance, prior to any blasting, neighbors within (600) feet of the blast area shall be notified in writing prior to the blast.

We will begin blasting on or after the week of February 9, 2015. We expect the blasting to last for approximately 3 weeks. By City Ordinance, blasting will occur between 9:00 am – 4:00 pm, Monday through Friday.

The procedure for the blast will be as follows: Just before the blasting is due to begin a horn will sound to signal people in the immediate area of the upcoming blast. The horn will blow in the following sequence:

- 3 long horns- 5 minutes before the blast**
- 2 long horns- 1 minute before the blast**
- 1 long horn- All clear for the blast to proceed.**

Please note: Toxic gases, including carbon monoxide (CO), are a byproduct of the detonation of explosives. Carbon monoxide is a poisonous, colorless, odorless, and tasteless gas. Exposure to raised levels of carbon monoxide can be hazardous or deadly. It is possible, in instances of incomplete combustion of explosives and where an open pathway is present, for carbon monoxide to travel from the blast site into nearby buildings. The Portland Fire Department encourages all Portland residents to install carbon monoxide detectors in their homes and workplaces to prevent exposure to hazardous levels of carbon monoxide. Carbon monoxide detectors should be installed in the basement or on the first floor of structures.

If you have any questions, please call any of the following numbers:

McGoldrick Brothers Blasting Services:	207-892-5989
City of Portland Fire Prevention Bureau:	207-874-8405
City of Portland Development Review Coordinator:	207-874-8632
City of Portland Inspections Division:	207-874-8703

For damage complaints, please call the Fire Prevention Bureau at (207) 874-8405 to log the complaint and request inspection and documentation of the damage.

Please do not hesitate to call if you have any questions or concerns.

Sincerely,

McGoldrick Brothers Blasting Services, Inc.