

PERMIT ISSUED

City of Portland, Maine - Building or Use Permit Application
 389 Congress Street, 04101 Tel: (207) 874-8703, Fax: (207) 874-8716

Permit No: 03-1206	Issue Date: OCT 14 2003	CBL: 416A A003001
-----------------------	----------------------------	----------------------

Location of Construction: 840 Ocean Ave	Owner Name: Ocean Ridge Realty Llc	Owner Address: 84 Ocean Ave	Phone:
Business Name:	Contractor Name: Fielding's Oil & Propane	Contractor Address: P.O. Box 364 Scarborough	Phone: 2078833194
Lessee/Buyer's Name	Phone:	Permit Type: HVAC	Zone: R3

Past Use: Reidantial / Condominiums	Proposed Use: Condominiums / Install ^{twelve} one 1,000 and one 500 gallon underground propane tank for gas heat	Permit Fee: \$192.00	Cost of Work: \$19,000.00	CEO District: 2	Zone: PRUD
--	--	-------------------------	------------------------------	--------------------	---------------

Proposed Project Description: Install ^{twelve} one 1,000 and one 500 gallon underground propane tank for gas heat.	FIRE DEPT: <input checked="" type="checkbox"/> Approved <input type="checkbox"/> Denied	INSPECTION: Use Group: <i>N/A</i> Type: <i>TANKS</i>
<p><i>total on site units 46 D.U only</i></p>	Signature: <i>[Signature]</i>	Signature: <i>[Signature]</i>
	PEDESTRIAN ACTIVITIES/DISTRICT (P.A.D.) Action: <input type="checkbox"/> Approved <input type="checkbox"/> Approved w/Conditions <input type="checkbox"/> Denied Signature: _____ Date: _____	

Permit Taken By: EG	Date Applied For: 10/02/2003	Zoning Approval	
------------------------	---------------------------------	------------------------	--

1. This permit application does not preclude the Applicant(s) from meeting applicable State and Federal Rules. 2. Building permits do not include plumbing, septic or electrical work. 3. Building permits are void if work is not started within six (6) months of the date of issuance. False information may invalidate a building permit and stop all work..	Special Zone or Reviews <input type="checkbox"/> Shoreland <input type="checkbox"/> Wetland <input type="checkbox"/> Flood Zone <input type="checkbox"/> Subdivision <input type="checkbox"/> Site Plan Maj <input type="checkbox"/> Minor <input type="checkbox"/> MM <input type="checkbox"/>	Zoning Appeal <input type="checkbox"/> Variance <input type="checkbox"/> Miscellaneous <input type="checkbox"/> Conditional Use <input type="checkbox"/> Interpretation <input type="checkbox"/> Approved <input type="checkbox"/> Denied	Historic Preservation <input checked="" type="checkbox"/> Not in District or Landmark <input type="checkbox"/> Does Not Require Review <input type="checkbox"/> Requires Review <input type="checkbox"/> Approved <input type="checkbox"/> Approved w/Conditions <input type="checkbox"/> Denied
	Date: <i>OK 10/2/03</i>	Date: _____	Date: _____

CERTIFICATION

I hereby certify that I am the owner of record of the named property, or that the proposed work is authorized by the owner of record and that I have been authorized by the owner to make this application as his authorized agent and I agree to conform to all applicable laws of this jurisdiction. In addition, if a permit for work described in the application is issued, I certify that the code official's authorized representative shall have the authority to enter all areas covered by such permit at any reasonable hour to enforce the provision of the code(s) applicable to such permit.

SIGNATURE OF APPLICANT	ADDRESS	DATE	PHONE
RESPONSIBLE PERSON IN CHARGE OF WORK, TITLE		DATE	PHONE

12/4/03 Inspected Tanks located between
bldgs 9-12 and 13-16 - Tanks now end to
end, not side by side - meet 10' setback
requirements JB OK to backfill

BUILDING PERMIT INSPECTION PROCEDURES

Please call 874-8703 or 874-8693 to schedule your inspections as agreed upon

Permits expire in 6 months, if the project is not started or ceases for 6 months.

The Owner or their designee is required to notify the inspections office for the following inspections and provide adequate notice. Notice must be called in 48-72 hours in advance in order to schedule an inspection:

By initializing at each inspection time, you are agreeing that you understand the inspection procedure and additional fees from a "Stop Work Order" and "Stop Work Order Release" will be incurred if the procedure is not followed as stated below.

DB **Pre-construction Meeting:** Must be scheduled with your inspection team upon receipt of this permit. Jay Reynolds, Development Review Coordinator at 874-8632 must also be contacted at this time, before any site work begins on any project other than single family additions or alterations.

✓ **Footing/Building Location Inspection:** Prior to pouring concrete

NA **Re-Bar Schedule Inspection:** Prior to pouring concrete

NA **Foundation Inspection:** Prior to placing ANY backfill

NA **Framing/Rough Plumbing/Electrical:** Prior to any insulating or drywalling

✓ **Final/Certificate of Occupancy:** Prior to any occupancy of the structure or use. NOTE: There is a \$75.00 fee per inspection at this point.

Certificate of Occupancy is not required for certain projects. Your inspector can advise you if your project requires a Certificate of Occupancy. All projects DO require a final inspection

 If any of the inspections do not occur, the project cannot go on to the next phase, REGARDLESS OF THE NOTICE OR CIRCUMSTANCES.

 CERTIFICATE OF OCCUPANICES MUST BE ISSUED AND PAID FOR, BEFORE THE SPACE MAY BE OCCUPIED

[Signature]
Signature of applicant/designee

Date

[Signature]
Signature of Inspections Official

11/18/00
Date

CBL: 416A A003 Building Permit #: 03-1206

Ocean Ridge

City of Portland, Maine - Building or Use Permit

389 Congress Street, 04101 Tel: (207) 874-8703, Fax: (207) 874-8716

Permit No: 03-1206	Date Applied For: 10/02/2003	CBL: 416A A003001
------------------------------	--	-----------------------------

Location of Construction: 840 Ocean Ave	Owner Name: Ocean Ridge Realty Llc	Owner Address: 84 Ocean Ave	Phone:
Business Name:	Contractor Name: Fielding's Oil & Propane	Contractor Address: P.O. Box 364 Scarborough	Phone (207) 883-3194
Lessee/Buyer's Name	Phone:	Permit Type: HVAC	

Proposed Use: Condominiums / Install one 1,000 and one 500 gallon underground propane tank for gas heat	Proposed Project Description: Install one 1,000 and one 500 gallon underground propane tank for gas heat.
---	---

Dept: Zoning	Status: Approved	Reviewer: Marge Schmuckal	Approval Date: 10/02/2003	Ok to Issue: <input checked="" type="checkbox"/>
Note:				
Dept: Building	Status: Approved	Reviewer: Mike Nugent	Approval Date: 10/10/2003	Ok to Issue: <input checked="" type="checkbox"/>
Note:				
Dept: Fire	Status: Approved with Conditions	Reviewer: Lt. MacDougal	Approval Date: 10/06/2003	Ok to Issue: <input checked="" type="checkbox"/>
Note:				
1) tanks shall be installed in accordance with NFPA 58 standards				

Comments:
10/6/2003-kwd: permit was input with incorrect number of tanks listed; sent back to zoning and fire for their review. Kwd
10/8/2003-kwd: reviewed and okayed by both zoning and fire for corrected number of tanks. Kwd



FILL IN AND SIGN WITH INK

PERMIT ISSUED

UCL 1003
CITY OF PORTLAND

APPLICATION FOR PERMIT HEATING OR POWER EQUIPMENT

416 AA003

To the INSPECTOR OF BUILDINGS, PORTLAND, ME.

The undersigned hereby applies for a permit to install the following heating, cooking or power equipment in accordance with the Laws of Maine, the Building Code of the City of Portland, and the following specifications:

Location / CBL 852 Ocean Ave. Use of Building Residential Date 9-25-03
Name and address of owner of appliance Ocean Ridge Condominiums
852 Ocean Ave. Portland, ME. 04103
Installer's name and address Fielding's Oil + Propane Inc.
P.O. Box 364 Scarborough, ME. 04070-0364 Telephone (207) 883-3194

Location of appliance:

- Basement
- Attic
- Floor
- Roof

Type of Fuel:

- Gas
- Oil
- Solid

Appliance Name: (12) 1,000 (1) 500 gallon
U.L. Approved Yes No underground propane tanks

Will appliance be installed in accordance with the manufacture's installation instructions? Yes No

IF NO Explain: _____

The Type of License of Installer:

- Master Plumber # _____
- Solid Fuel # _____
- Oil # _____
- Gas # PNT3784
- Other _____

Type of Chimney:

- Masonry Lined
Factory built _____
- Metal
Factory Built U.L. Listing # _____
- Direct Vent
Type _____ UL# _____

Type of Fuel Tank

- Oil
- Gas

Size of Tank 1,000 + 500 Gallon underground propane Tanks

Number of Tanks (12) 1,000 (1) 500

Distance from Tank to Center of Flame 50' + feet.

Cost of Work: \$ 19,000

Permit Fee: \$ 192 (455 Tank Fee)
paid 192, owe 263 perm DN 9/30/03

Approved

Fire: 44417
Ele.: _____
Bldg.: _____

Approved with Conditions

- See attached letter of requirement

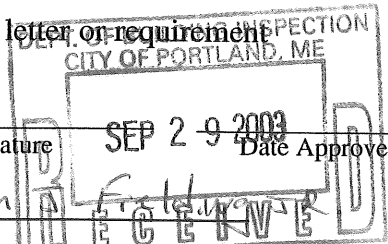

Inspector's Signature William J. Fielding Date Approved _____

Signature of Installer William J. Fielding

White - Inspection Yellow - File Pink - Applicant's Gold - Assessor's Copy



OIL CO., INC.

P. O. BOX 364 • 180 U. S. ROUTE 1
SCARBOROUGH, MAINE 04070-0364
883- 3194 1(800) 491-3194

Ocean Ridge Condominiums

(1) 500 gallon ACME underground propane tank

(12) 1000 gallon ACME underground propane tanks

Each tank will require a hole to be dug approx. 20 feet long, 6 feet wide, 6 feet deep.

Each tank and hole will be covered with fine graded sand supplied by Maietta Const. Inc.. The sand will be placed on the bottom, sides, and top of each tank. Each hole will need approx. 4-5 yards of sand.

The ground support for these tanks throughout this project is very good. The grounds in this area is very hard (ledge), so each tank will have a good foundation.

Each tank will meet minimum distances required under NFPA 58 from buildings, public ways, and other propane tanks. Each tank will be at least 10+ feet away from any buildings, driveways, or any other structures.

Each tank will have a 3/4 inch or 1 inch main gas line running underground from tank to building. This gas line will be at a minimum depth of 18 inches, with a maximum depth of 36 inches. These requirements meet NFPA 58.

The condominiums with 4 units will have 4 meters.



OIL CO., INC.

P. O. BOX 364 • 180 U. S. ROUTE 1
SCARBOROUGH, MAINE 04070-0364
883- 3194 1(800) 491-3194

The condominiums with 3 units will have 3 meters.

The condominium with 2 units will have 2 meters.

These meters will be placed on one side of each building at the end of each gas line. These meters will meet all requirements under NFPA 58.

The plot plan provided shows approx. locations of each and every 1000 gallon and 500 gallon ACME underground propane tanks in the Ocean Ridge Condominium project.

All work will be done according to NFPA 58 rules and regulations. All work will be done by qualified technicians and good sound workmanship.

LP-GAS CODE

1998 Edition

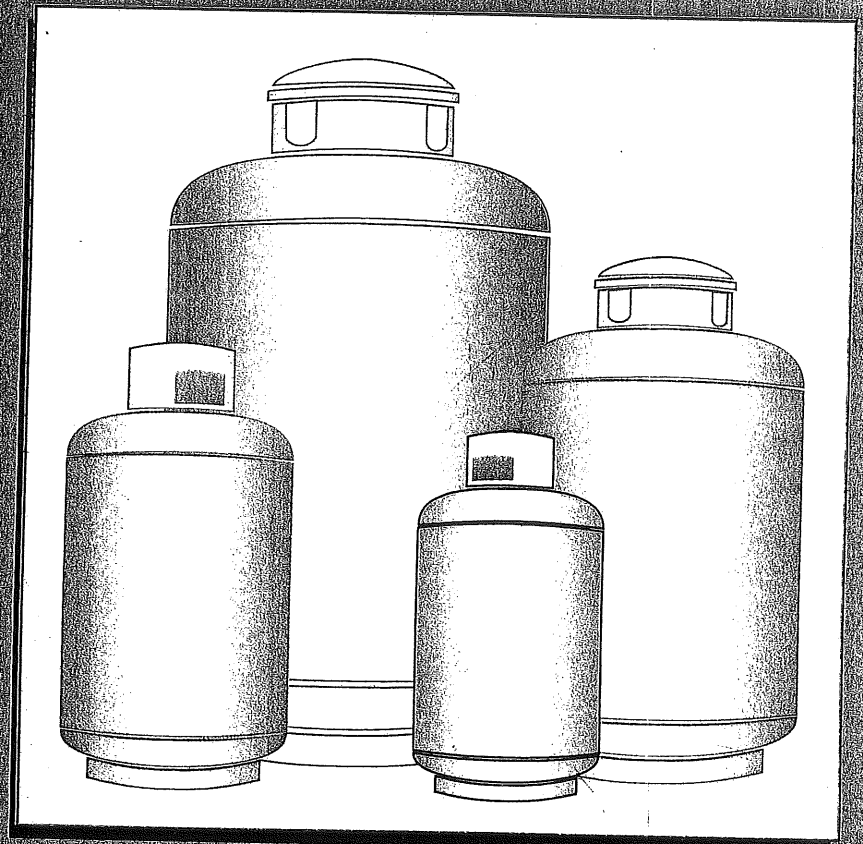

**National Fire Protection
Association**

An International Codes and Standards Organization

Table 3-2.2.2

Water Capacity per Container gallons (m ³)	Minimum Distances ft (m)		
	Mounded or Underground Containers [see 3-2.2.2(f)]	Aboveground Containers [see 3-2.2.2(h)]	Between Containers [see 3-2.2.2(g)]
Less than 125 (0.5) [see 3-2.2.2(a)]	10 (3)	None [see 3-2.2.2(b), (c), and (d)]	None
125 to 250 (0.5 to 1.0)	10 (3)	10 (3)	None
251 to 500 (1.0+ to 1.9)	10 (3)	10 (3)	3 (1)
501 to 2000 (1.9+ to 7.6)	10 (3)	[redacted] [see 3-2.2.2(e)]	3 (1)
2001 to 30,000 (7.6+ to 114)	50 (15)	50 (15)	} ¼ of sum of diameters of adjacent containers
30,001 to 70,000 (114+ to 265)	50 (15)	75 (23)	
70,001 to 90,000 (265+ to 341)	50 (15)	100 (30)	
90,001 to 120,000 (341+ to 454)	50 (15)	125 (38)	
120,001 to 200,000 (454 to 757)	50 (15)	200 (61)	
200,001 to 1,000,000 (757 to 3785)	50 (15)	300 (91)	
Over 1,000,000 (3785)	50 (15)	400 (122)	

Table 3-2.2.2(d)

Container Type	Exchange or Filled on Site	Distance Horizontally from Relief Valve Discharge to Opening Below Discharge ft	Discharge from Relief Valve, Vent Discharge, and Filling Connection to Exterior Source of Ignition, Openings into Direct-Vent Appliances, Mechanical Ventilation Air Intakes ft
Cylinder	Exchange	3	5
Cylinder	Filled on site	3	10
ASME	Filled on site	5	10

125 gal (0.5 m³) or more, such containers shall be installed so as to permit access at their ends or sides to facilitate working with cranes or hoists.

(h) In applying the distance between buildings and ASME containers of 125 gal (0.5 m³) or more water capacity, a minimum of 50 percent of this horizontal distance shall also apply to all portions of the building that project more than 5 ft (1.5 m) from the building wall and that are higher than the relief valve discharge outlet. This horizontal distance shall be measured from a point determined by projecting the outside edge of such overhanging structure vertically downward to grade or other level upon which the container is installed. Under no condition shall the distances to the building wall be less than those specified except when the provisions of 3-11.3 and 3-11.4 are met. These distances shall be permitted to be reduced by one-half for ASME containers of 2001 gal

through 30,000 gal (7.6 m³ through 114 m³) water capacity used in systems complying with Section 3-11.

Exception: Not applicable to installations in which overhanging structure is 50 ft (15 m) or more above the relief valve discharge outlet.

3-2.2.3 Where storage containers having an aggregate water capacity of more than 4000 gal (15.1 m³) are located in heavily populated or congested areas, the siting provisions of 3-2.2.2 and Table 3-2.2.2 shall be permitted to be modified as indicated by the fire safety analysis described in 3-10.2.3.

3-2.2.4 Aboveground multicontainer installations comprised of containers having an individual water capacity of 12,000 gal (45 m³) or more installed for use in a single location shall be limited to the number of containers in one group, and with each group separated from the next group in accordance with the degree of fire protection provided in Table 3-2.2.4.

The separation distance between groups of ASME containers protected by hose stream only shall be permitted to be reduced by one-half when the provisions of 3-11.3 and 3-11.4 are met.

3-2.2.5 Underground or mounded containers shall be located outside of any buildings. Buildings shall not be constructed over any underground or mounded containers. Sides of adjacent containers shall be separated in accordance with Table 3-2.2.2 but not less than 3 ft (1 m).

Where containers are installed parallel with ends in line, any number of containers shall be permitted to be in one group. Where more than one row is installed, the adjacent ends of the tanks in each row shall be separated by not less than 10 ft (3 m).

3-2.2.6 In the case of buildings of other than wood-frame construction devoted exclusively to gas manufacturing and distribution operations, the distances specified in Table 3-2.2.2 shall be permitted to be reduced provided that containers having a water capacity exceeding 500 gal (1.9 m³) shall not

Fieldings & Co. Inc.

Brian Wislley (C)

SUB CONTRACTOR
 FLAG TAX 21%
 + MAKE READY WORK

2ea 2 1/2" CONDUIT FOR PRIMARYS

UNDERGROUND NOTES

1. Electrical installations to conform with Central Maine Powers Handbook of Standard Requirements.
2. Primary Voltage cable will be #2 AL 15 KV URD Type Cable.
3. Conduit is required under all roads, driveways and paved areas for both primary and secondary cables.
4. At each transformer location a level 10 foot by 10 foot area will be provided as shown on illustration #17 in the Handbook of Standard Requirements. The elevation of this area shall be sufficiently high to always be above the highest expected water level and at or above the top of any nearby ditch slope. The transformer foundation shall be installed so the top of the foundation is 6 inches above this elevation. The transformer foundation shall be installed no more than 20 feet from a road surface.
5. This plan is based on the plan titled Grading and Utility Plan of Ocean Ridge Condominiums, 852 Ocean Ave., Portland, Maine, For Marjorie Mortgage, Natick, MA., sheet 5 and 6, Rev. E, 8/8/01, By Sebago Technics, One Chabot, Westbrook, Maine.
6. Conduits shall be properly pitched to drain into transformer foundations, manholes or spliceboxes. Three inches per 100 feet minimum slope.
7. The route of all buried cables shall be kept free of trees and shrubs.
8. A maximum of 8 sets of secondary conductors can be connected to a single transformer.
9. This layout contingent upon obtaining easement for anchor and guy 20' outside Ocean Avenue road limit to the east of Ocean Avenue. Without easement underground electrical crossing of Ocean Avenue will be required.

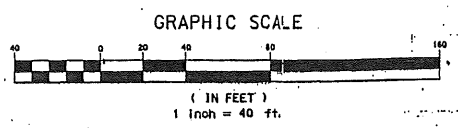
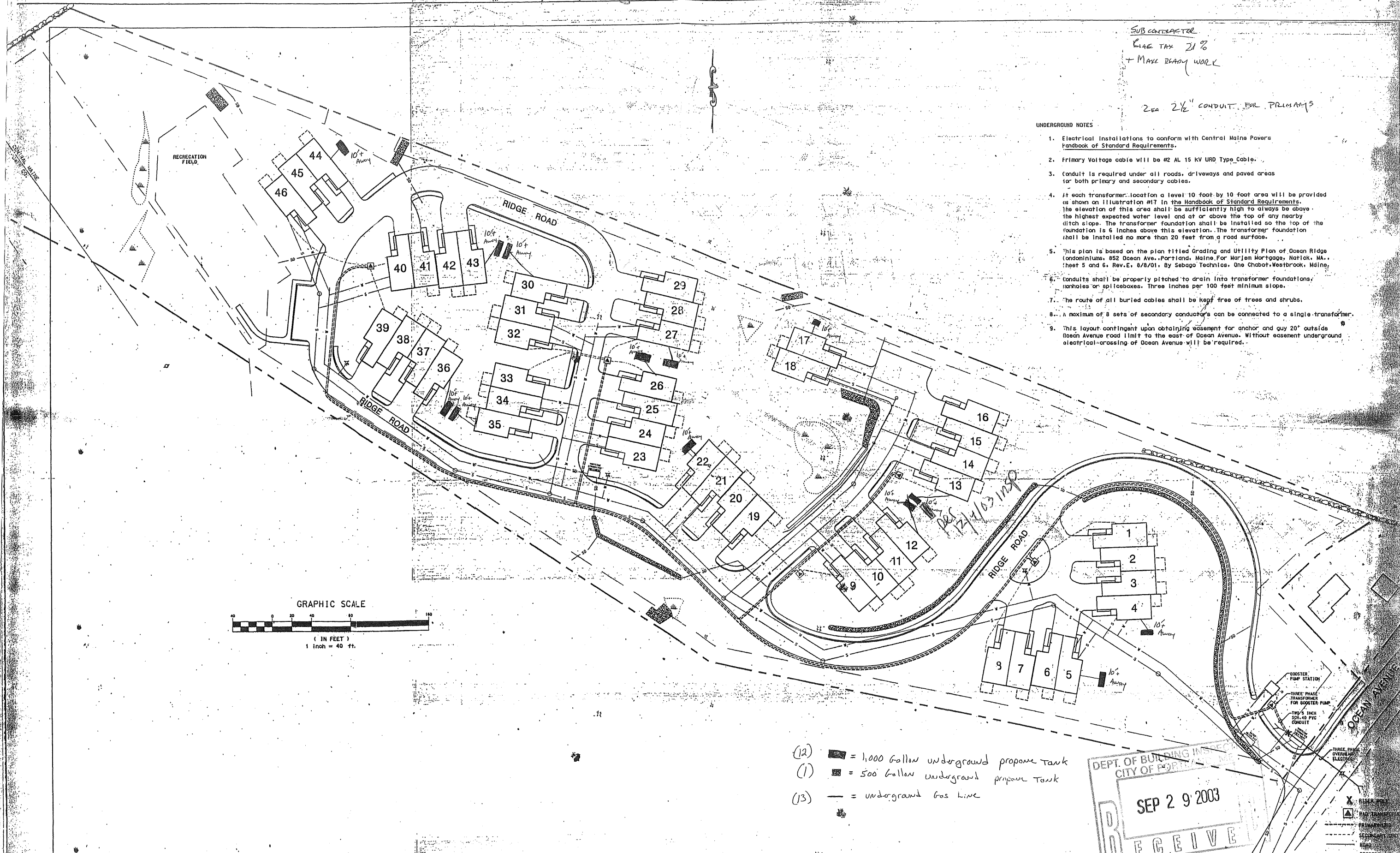

- (12) [Symbol] = 1,000 Gallon underground propane tank
- (1) [Symbol] = 500 Gallon underground propane tank
- (13) [Symbol] = underground gas line

DEPT. OF BUILDING INSPECTION
 CITY OF PORTLAND
RECEIVED
 SEP 29 2003

PROPRIETARY
 Central Maine Power Company provides this information for your use only. It is not to be used for any other purpose without the express written consent of Central Maine Power Company.



NO	REVISION	DATE	BY	CK	NO	REVISION	DATE	BY	CK

OCEAN RIDGE CONDOMINIUMS
 852 OCEAN AVENUE
 PORTLAND, MAINE