

SUBSURFACE WASTEWATER DISPOSAL SYSTEM APPLICATION

Maine Department of Human Services
Division of Health Engineering, Station 10
(207) 287-5672 Fax: (207) 287-3165

Town, City, Plantation
Portland

Street, Road, Subdivision
Ice Pond Drive

Owner or Applicant Name
Tim O'Donovan

SUBSURFACE WASTEWATER DISPOSAL PLAN

Scale: 1" = 20 ft

Existing Grade Elevations
-48" -42"
-55" -51"
FIELD CORNERS

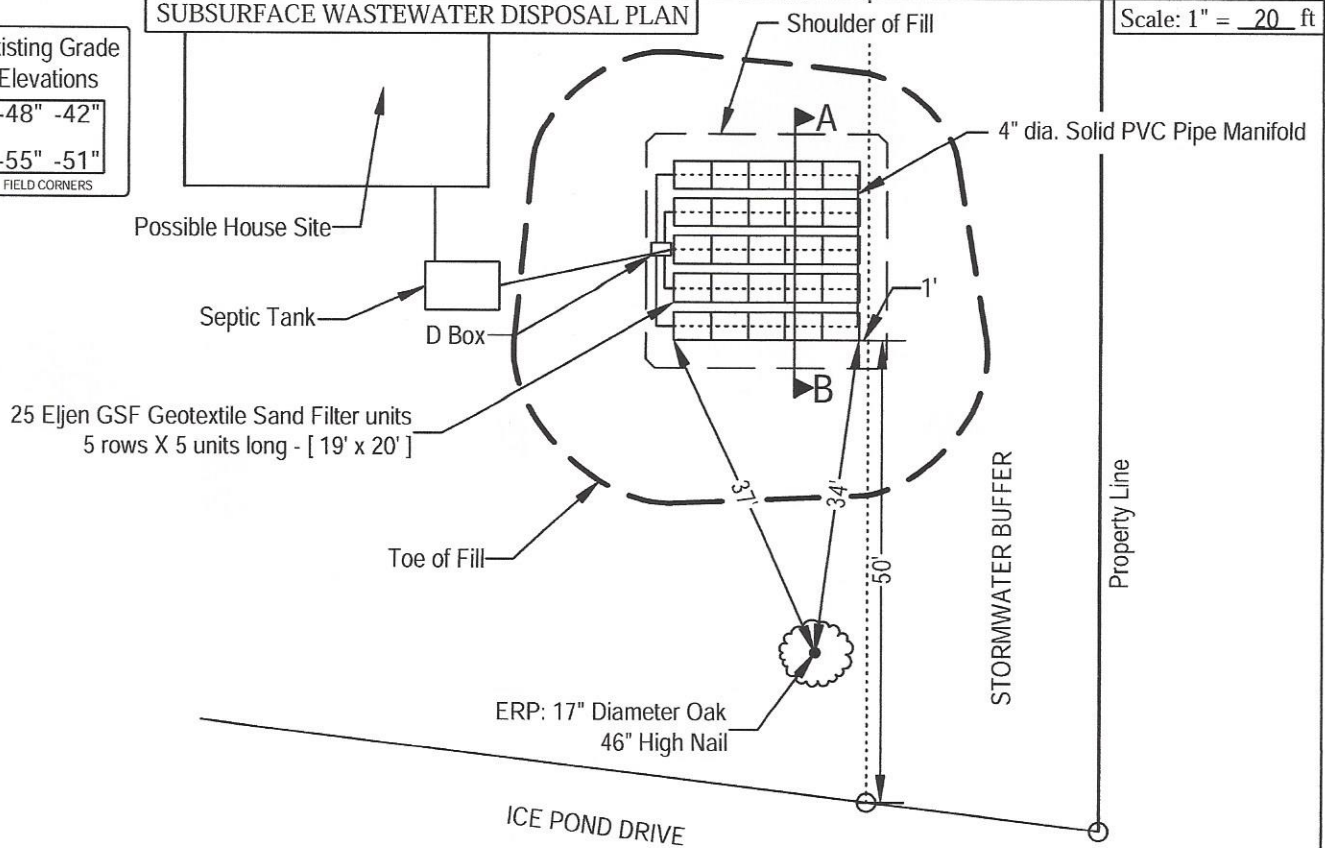

BACKFILL REQUIREMENTS

CONSTRUCTION ELEVATIONS

ELEVATION REFERENCE POINT
Location & Description: 17" Diameter Oak

Depth of Backfill (upslope) 32-26"
Depth of Backfill (downslope) 39-35"

Finished Grade Elevation (at Row 1) -16"
Top of Proprietary Device (at Row 1) -24"
Bottom of Disposal Field (at Row 1) -41"

Reference Elevation is 0.0" or: _____

NOTE: SCARIFY ALL GROUND SURFACE TO BE FILLED. USE GRAVELLY COARSE SAND WITHIN 3' OF ELJENS. REMAINING FILL: LOAMY SAND (no clay)

DISPOSAL FIELD CROSS SECTION

| ROW # | 1 | 2 | 3 | 4 | 5 |
|--------|------|------|------|------|------|
| TOP | -24" | -24" | -24" | -24" | -24" |
| BOTTOM | -35" | -35" | -35" | -35" | -35" |

TOP OF ROW #1 INLET AT -24"

APPROXIMATE ABOVE GRADE FILL REQUIRED
34.2 cubic yards of LOAM
131.8 cubic yards of SAND
Compaction: +20% Loam & +15% Sand
Volume of chambers not considered

Scales:

Vertical: 1" = 5
Horizontal: 1" = 5

A

B

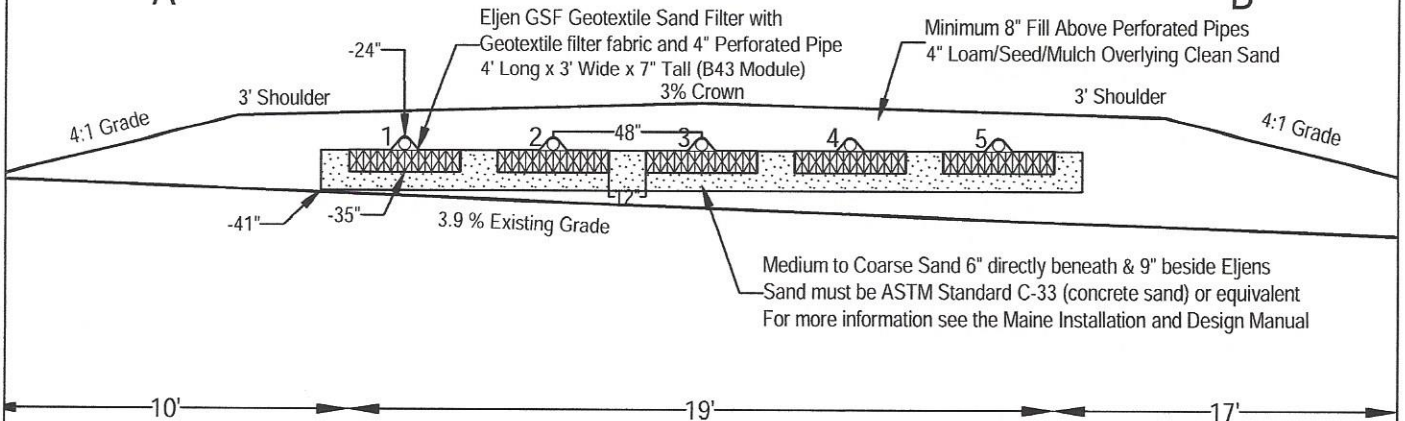

Richard O'Donovan
Site Evaluator Signature

034
SE #

11/30/16
Date

Page 3 of 3
HHE-200 Rev. 10/02