

SUBSURFACE WASTEWATER DISPOSAL SYSTEM APPLICATION

Maine Department of Human Services
 Division of Health Engineering, Station 10
 (207) 287-5672 Fax (207) 287-3165

Town, City, Plantation
Portland

Street, Road, Subdivision
Ice Pond Drive

Owner or Applicant Name
Tim O'Donovan

SITE PLAN Scale 1" = 50 ft.

SITE LOCATION PLAN

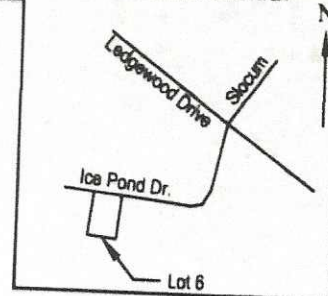
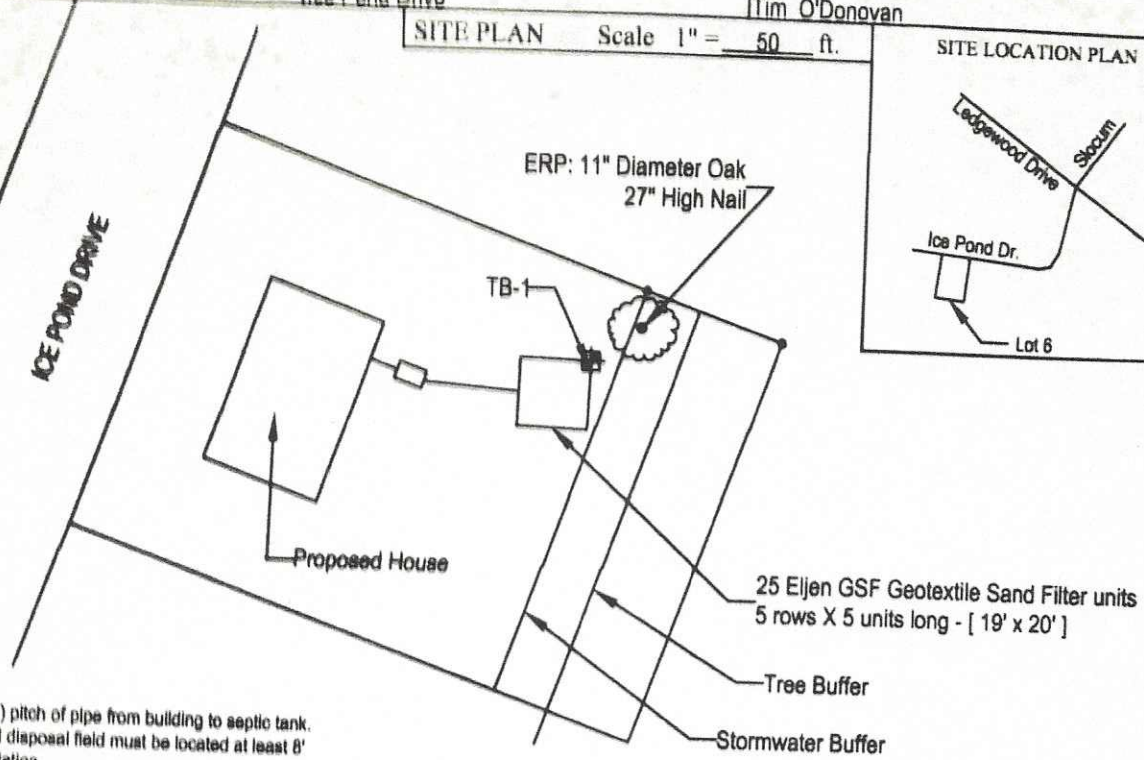

NOTES:

1. Min. 1/4" (2%) pitch of pipe from building to septic tank.
2. Septic tank and disposal field must be located at least 8' and 20' from foundation
3. Scarify all ground to be filled.
4. Insulate the Distribution Box (D-Box).
5. Min. 1/8" (1%) pitch of pipe from septic tank to disposal field.
6. Review the Eljen Geotextile Sand Filter (GSF) Design and Installation Manual before installing this system.

SOIL PROFILE DESCRIPTION AND CLASSIFICATION

(Location of Observation Holes Shown Above)

Observation Hole # TP-1 Test Pit Boring

Observation Hole # _____ Test Pit Boring

_____ " Depth of organic horizon above mineral soil

_____ " Depth of organic horizon above mineral soil

Texture	Consistency	Color	Mottling
Sandy Loam	Friable	Dark Brown	
Sandy Loam	Friable	Reddish Brown	
Loamy Sand	Loose	Yellowish Brown	
Bedrock at 29 inches			

Texture	Consistency	Color	Mottling

Soil Profile	Classification Condition	Slope Percent	Limiting Factor Depth	<input type="checkbox"/> Groundwater	<input type="checkbox"/> Restrictive Layer	<input checked="" type="checkbox"/> Bedrock
2	A	7	29"			

Soil Profile	Classification Condition	Slope Percent	Limiting Factor Depth	<input type="checkbox"/> Groundwater	<input type="checkbox"/> Restrictive Layer	<input type="checkbox"/> Bedrock

Richard O'Donovan
 Site Evaluator Signature

034
 SE #

06/02/15
 Date

SUBSURFACE WASTEWATER DISPOSAL SYSTEM APPLICATION

Maine Department of Human Services
 Division of Health Engineering, Station 10
 (207) 287-5672 Fax: (207) 287-3165

Town, City, Plantation
Portland

Street, Road, Subdivision
Ice Pond Drive

Owner or Applicant Name
Tim O'Donovan

SUBSURFACE WASTEWATER DISPOSAL PLAN

Scale: 1" = 20' ft

Existing Grade Elevations
 -30" -30"
 -46" -40"
 FIELD CORNERS

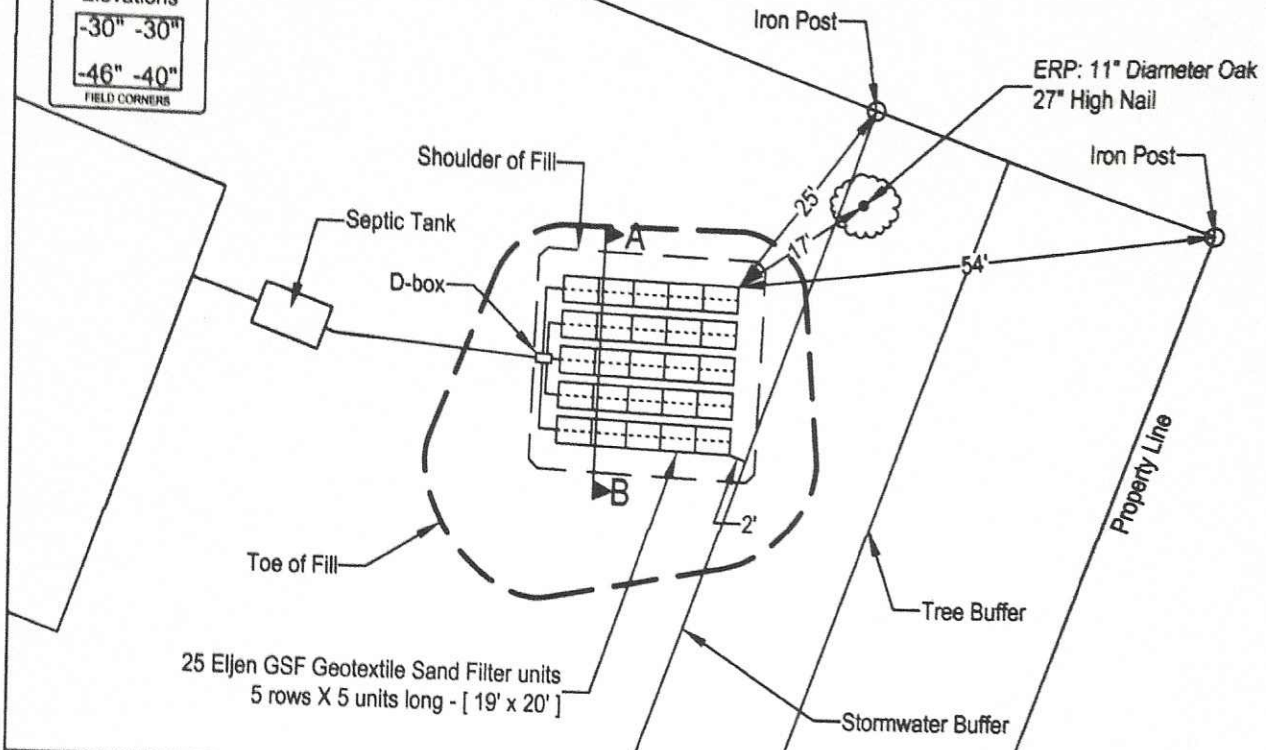

BACKFILL REQUIREMENTS

Depth of Backfill (upslope) 14-14"
 Depth of Backfill (downslope) 30-24"

CONSTRUCTION ELEVATIONS

Finished Grade Elevation (at Row 1) -16"
 Top of Proprietary Device (at Row 1) -24"
 Bottom of Disposal Field (at Row 1) -41"

ELEVATION REFERENCE POINT
 Location & Description: 11" Diameter Oak 27" High Nail

Reference Elevation is 0.0" or: _____

NOTE: SCARIFY ALL GROUND SURFACE TO BE FILLED. USE GRAVELLY COARSE SAND WITHIN 3' OF ELJENS. REMAINING FILL: LOAMY SAND (no clay)

DISPOSAL FIELD CROSS SECTION

ROW #	1	2	3	4	5
TOP	-24"	-24"	-24"	-24"	-24"
BOTTOM	-35"	-35"	-35"	-35"	-35"

TOP OF ROW #1 INLET AT -24"

APPROXIMATE ABOVE GRADE FILL REQUIRED
 25.4 cubic yards of LOAM
 64.6 cubic yards of SAND
 Compaction: +20% Loam & +15% Sand
 Volume of chambers not considered

Scales:
 Vertical: 1" = 5'
 Horizontal: 1" = 5'

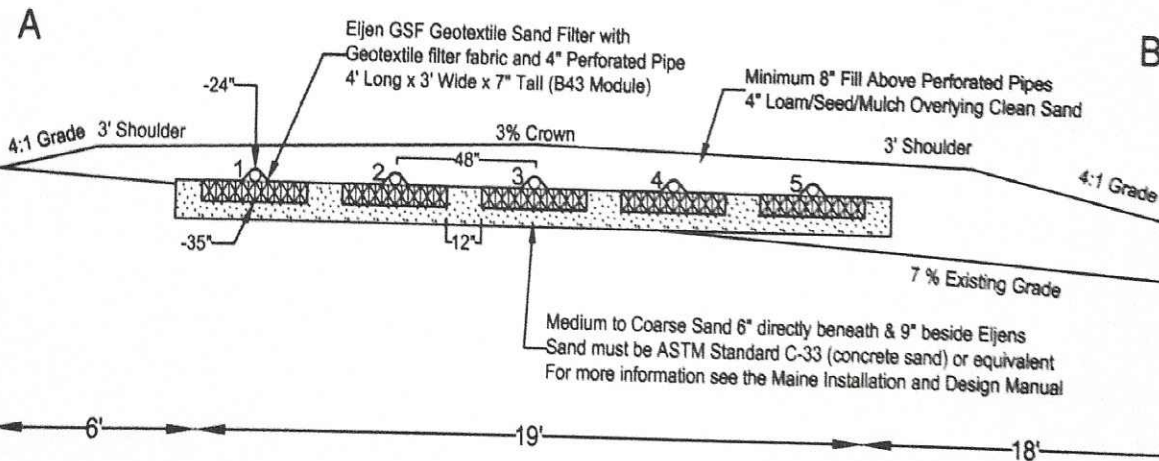

Richard O'Donovan
 Site Evaluator Signature

034
 SE #

06/02/15
 Date

Page 3 of 3
 HHE-200 Rev. 10/02