

T<sub>c</sub> FLOW LINE DATA:

SUBCATCHMENT OS1			
SEGMENT	LENGTH	SLOPE	FLOW TYPE
A-B	150'	0.011	SHEET FLOW
B-C	340'	0.011	SHALLOW CONCENTRATED FLOW
C-D	272'	0.011	SHALLOW CONCENTRATED FLOW
D-E	733'	0.011	SHALLOW CONCENTRATED FLOW
E-F	7,066'	0.011	TRAP FLOW

SUBCATCHMENT OS2			
SEGMENT	LENGTH	SLOPE	FLOW TYPE
A-B	150'	0.010	SHEET FLOW

NOTES

- OFFSITE SOILS ARE ASSUMED TO BE CLASSIFIED AS HYDROLOGIC SOIL GROUP C.
- OFFSITE SUBCATCHMENTS WERE DELINEATED BASED ON A COMBINATION OF USGS TOPOGRAPHICAL MAPS DATED 2011, AERIAL PHOTOGRAPHY DATED 2012, AND FIELD RECONNAISSANCE.

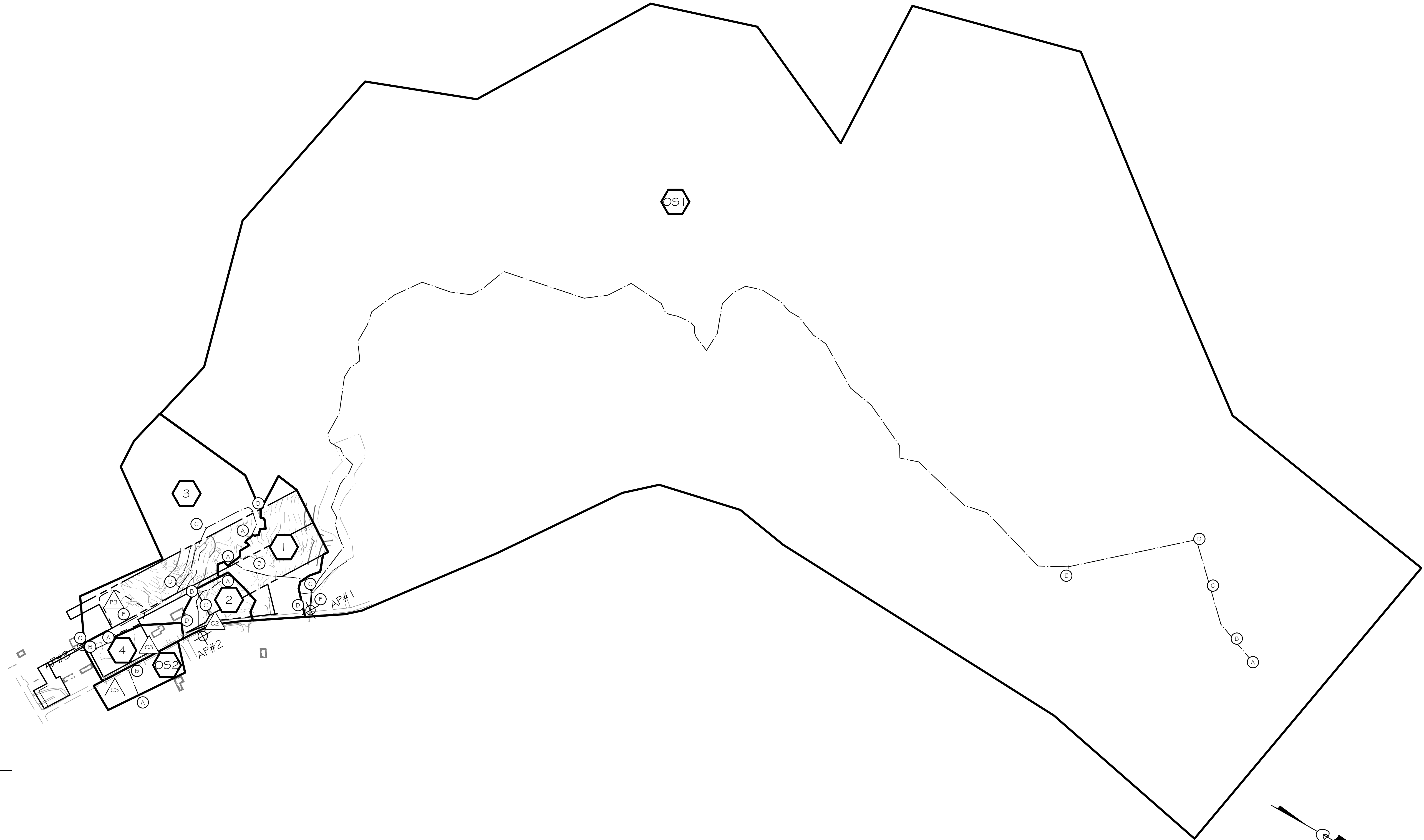

DRAINAGE LEGEND

- SUBCATCHMENT BOUNDARY
- SUBCATCHMENT DESIGNATION
- TIME OF CONCENTRATION FLOW
- REACH
- REACH DESIGNATION
- ANALYSIS POINT
- ANALYSIS POINT
- POND TEXT

GRAPHIC SCALE

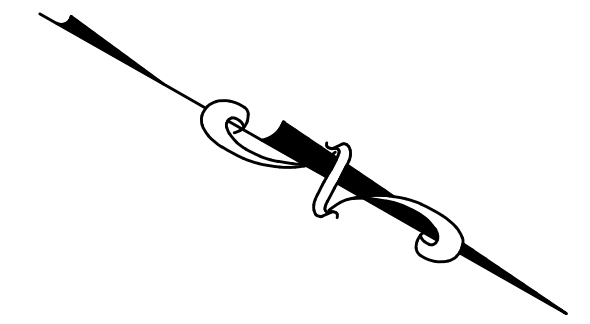
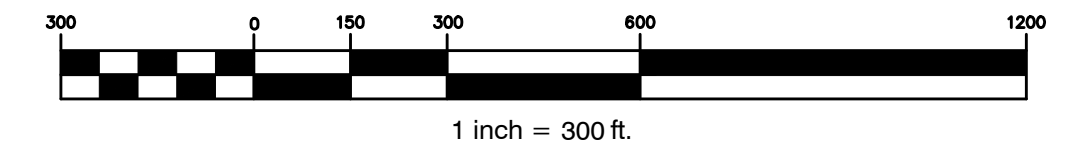

REV.	DATE	STATUS	BY	CHKD.	APPD.	REV.	DATE	STATUS	BY	CHKD.	APPD.
A	1/1/13	ISSUED FOR CITY OF PORTLAND WORKSHOP									

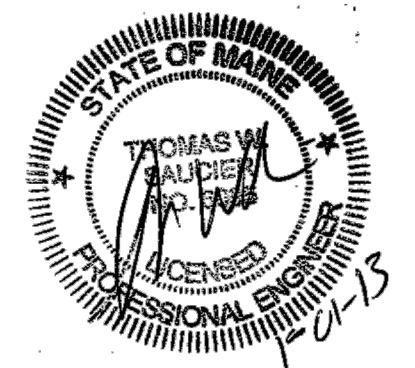

**LAND DESIGN SOLUTIONS**  
 LAND PLANNING, SITE PLANNING & LANDSCAPE ARCHITECTURE  
 P.O. Box 316, 160 Longwoods Road, Cumberland, ME 04081 | tel: (207) 434-1717  
 CLIENT: **TPO PROPERTIES, LLC**  
 30 LEDGEWOOD DRIVE, FALMOUTH, MAINE 04104

DESIGN: PBB  
 DRAWN: DEPT.  
 CHKD: PBB  
 DATE: JAN 2013  
 SCALE: 1" = 300'

**OLD BARN ESTATES**  
 1062 OCEAN AVENUE, PORTLAND, MAINE  
**OFF-SITE SUBCATCHMENT PLAN**  
 PROJ. NO. \_\_\_\_\_  
 DWG. NO. \_\_\_\_\_  
 REV. \_\_\_\_\_  
**D-101** A

Drawing Name: C:\Users\jvank\OneDrive\Documents - Boston\_L\_15294 | Rev: Date / Time: Jan 1, 13 / 12:19 PM