

NOTES:

1. A TURNAROUND EASEMENT SHALL BE CONVEYED TO THE CITY OF PORTLAND.
2. NO DRIVEWAYS SHALL BE LOCATED WITHIN 10 FEET OF THE TURNAROUND OR THE END OF THE STREET.
3. TURNAROUND TO CONFORM TO THE CITY OF PORTLAND TECHNICAL STANDARDS FIGURE 1-5.

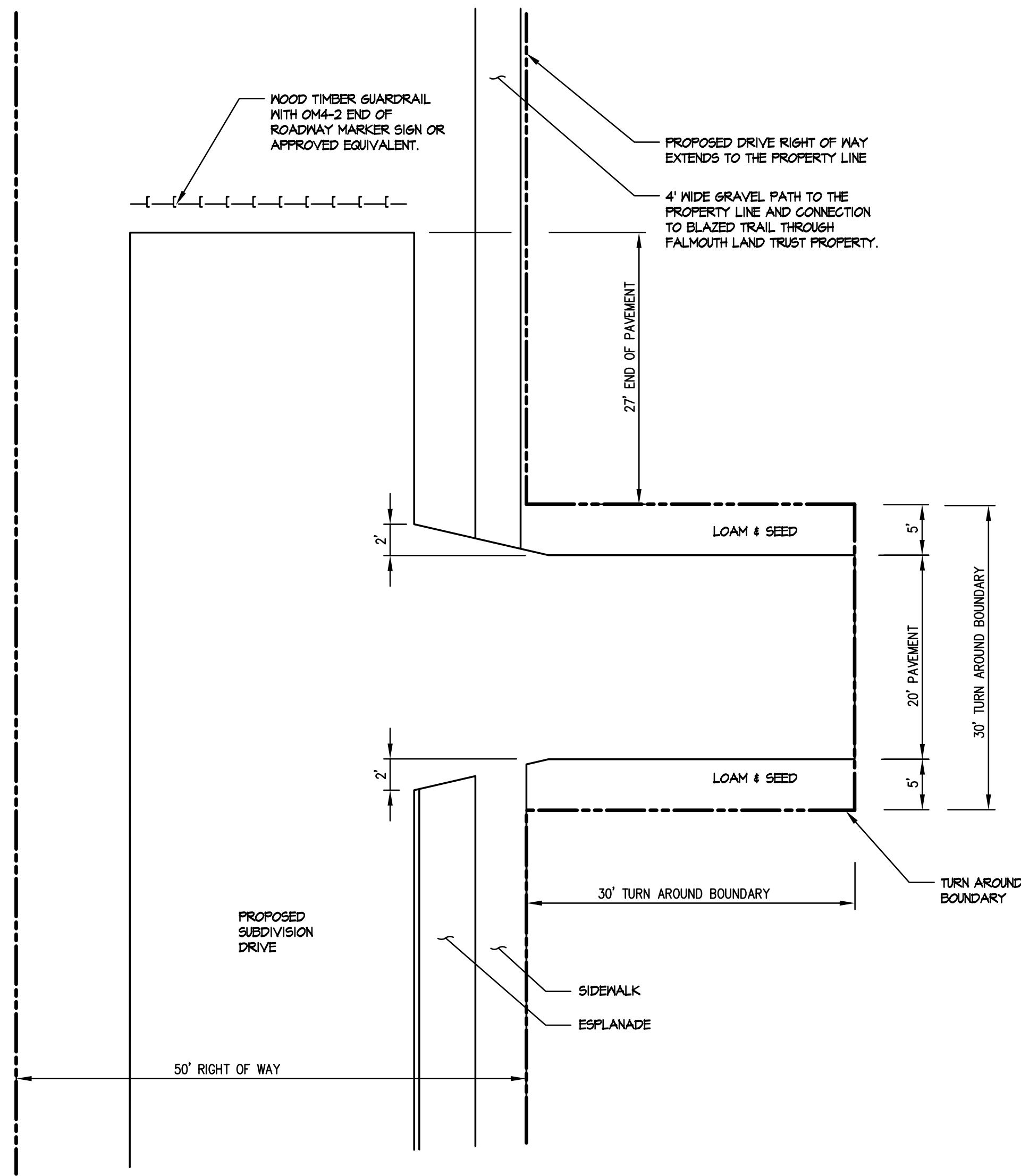

1 SUBDIVISION DRIVE TURNAROUND  
SCALE: N.T.S.

NOTES:

1. CROSSWALKS SHALL CONFORM TO THE REQUIREMENTS OF THE AMERICANS WITH DISABILITIES ACT AND ALL LOCAL CODES AND MUTCD STANDARDS.
2. ALL PAINT SHALL BE LEAD FREE, FAST DRYING, 100% ACRYLIC WATERBORNE TRAFFIC PAINT WITH SILICA SAND FOR SKID RESISTANCE, MEETING THE REQUIREMENTS OF TT-P-1952 TYPE I & II. PAINT SHALL BE APPLIED AS SPECIFIED BY THE MANUFACTURER.
3. TOWN OF FALMOUTH ENGINEER TO APPROVE THE LAYOUT OF CROSSWALKS PRIOR TO PAINTING.

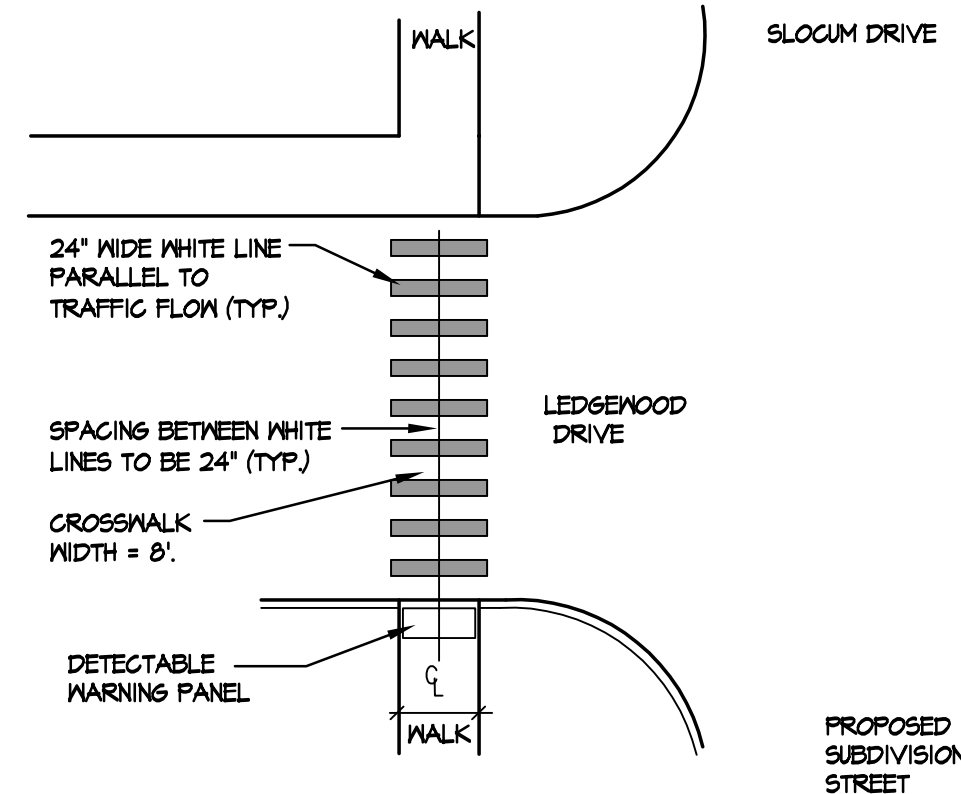

2 PAINTED CROSSWALK  
SCALE: N.T.S.

NOTES:

1. DIMENSIONS ARE SUBJECT TO CHANGE IN FIELD. ALL SLOPES AND DIMENSIONS TO COMPLY WITH A.D.A. REQUIREMENTS.
2. CONTRACTOR TO INSTALL 24" WIDE DETECTABLE WARNING STRIP PER ADA GUIDELINES AND THE TOWN OF FALMOUTH. PANEL TO BE THE DURALAST, CAST IRON PANEL WITH A NATURAL FINISH BY EJI COMPANY, MATCHING PANELS USED IN THE COMPLETED LEDGEWOOD DRIVE RECONSTRUCTION PROJECT.
3. CONCRETE PANELS SHALL BE CAST IN PLACE, 5" THICK AND MEET SPECIFICATIONS FOR MAINE D.O.T. CLASS A STRUCTURAL CONCRETE, MINIMUM COMPRESSIVE STRENGTH 4,000 PSI. CONCRETE SHALL BE SEALED PRIOR TO SETTING PANELS. THE EXPOSED CONCRETE BORDER SHALL RECEIVE A GROOVED EDGE BETWEEN THE PANEL AND THE CONCRETE, ALONG WITH A UNIFORM BROOM FINISH PERPENDICULAR TO TRAFFIC FLOW.

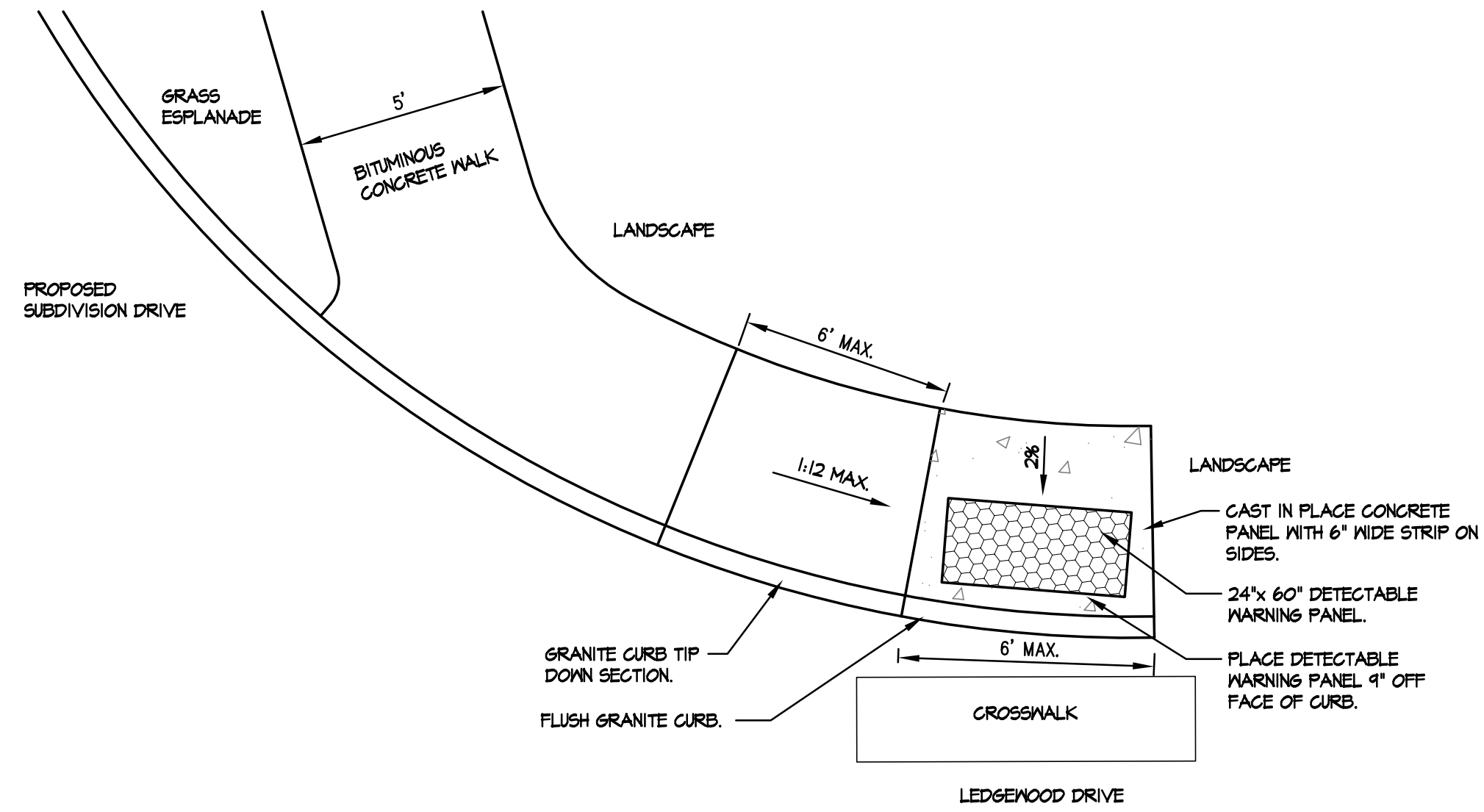

3 SIDEWALK RAMP DETECTABLE WARNING PANEL  
SCALE: N.T.S.

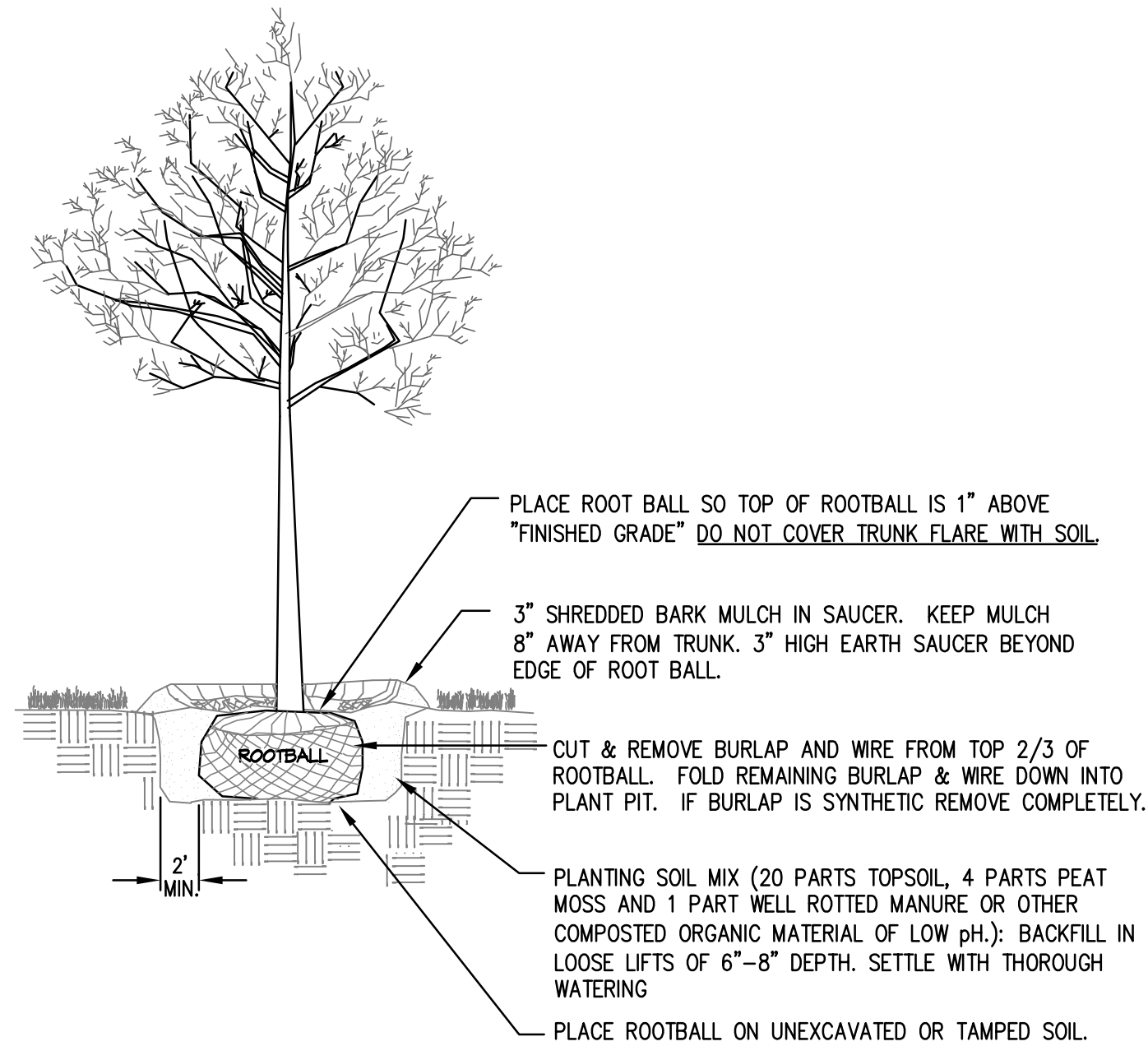

4 DECIDUOUS TREE PLANTING  
SCALE: N.T.S.

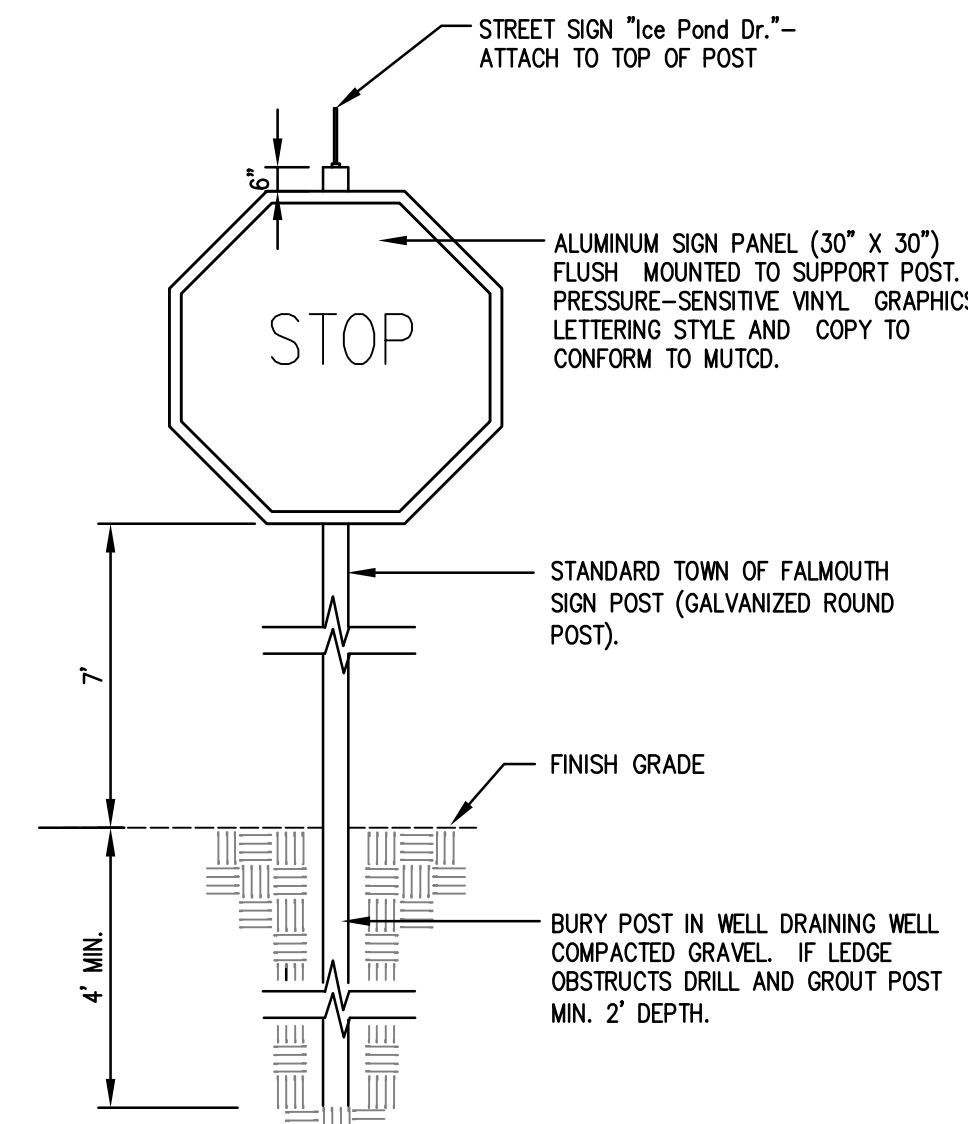

5 STOP SIGN AND STREET SIGN  
SCALE: N.T.S.

NOTE: CONTRACTOR TO VERIFY UTILITY INSTALLATION WITH APPROPRIATE UTILITY COMPANY PRIOR TO INSTALLATION.

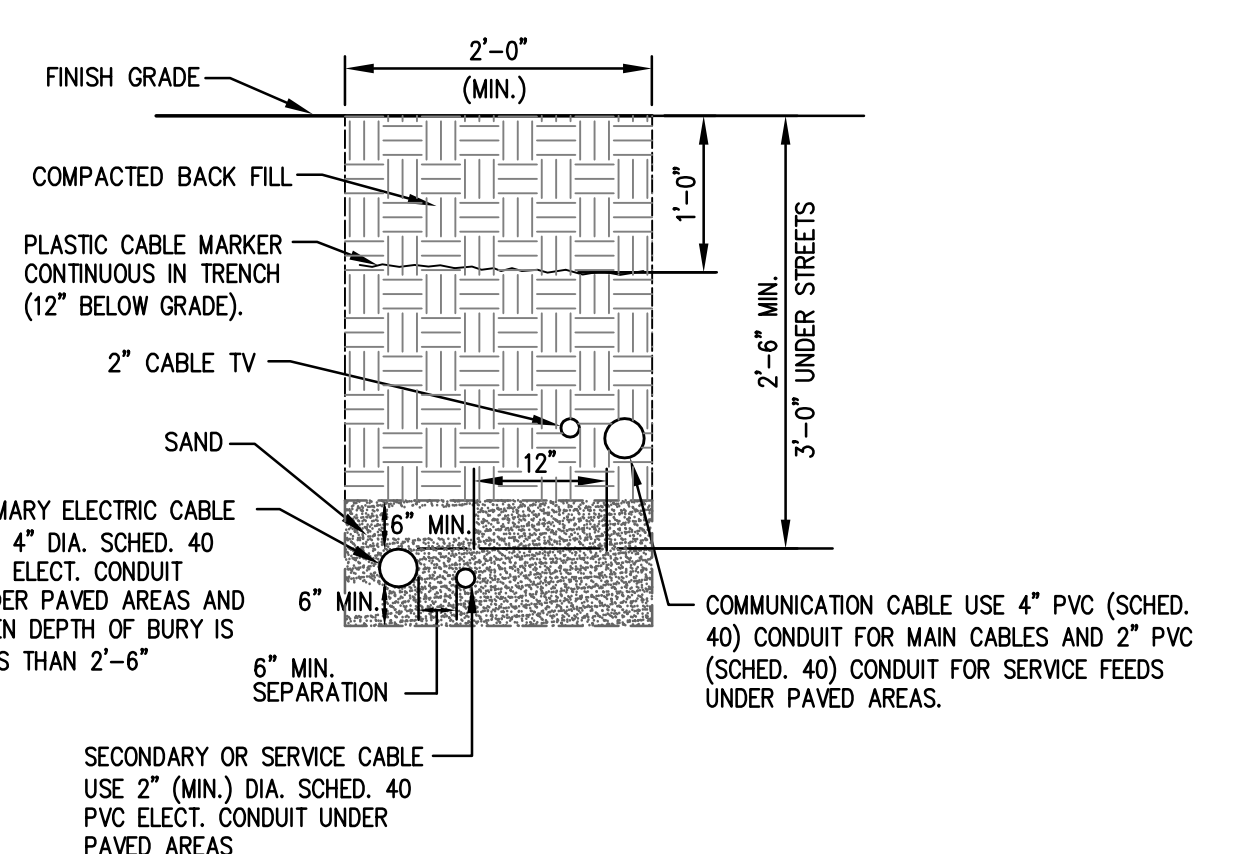

6 TRENCH SECTION - ELECTRIC, TELEPHONE/CABLE  
SCALE: N.T.S.

Drawing Name: K:\D\_Brown\Open\Drawings\1801\1801.dwg / User: jbs, 11/13 / 2:42 PM

REV.	DATE	STATUS	BY	CHKD.	APPD.	REV.	DATE	STATUS	BY	CHKD.	APPD.
A	1/01/13	SUBMITTED TO CITY OF PORTLAND FOR WORKSHOP	DEPT.	PBB	TWS						

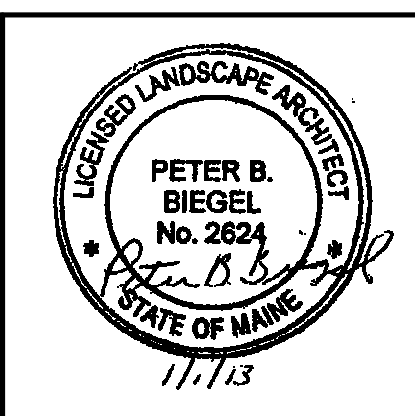

**LAND DESIGN SOLUTIONS**  
LAND PLANNING, SITE PLANNING & LANDSCAPE ARCHITECTURE

P.O. Box 316, 160 Longwoods Road, Cumberland, ME 04081 tel:(207) 494-1717

CLIENT: **TPO PROPERTIES, LLC**  
30 LEDGEWOOD DRIVE, FALMOUTH, MAINE 04104

DESIGN: PBB  
DRAWN: DEPT.  
CHKD: PBB

DATE: MAY 2012  
SCALE: AS NOTED

PROJ. NO.  
DWG. NO.

**OLD BARN ESTATES**  
1062 OCEAN AVENUE, PORTLAND, MAINE

**SITE DETAILS**

REV. A

**C-303**